

F.A.P. RTE.	SECTION	COUNTY	TOTAL SHEETS	SHEET NO.
307	129-R-2	KANE	243	52
STA.		TO STA.		
FED. ROAD DIST. NO. 1		ILLINOIS FED. AID PROJECT		
CONTRACT NO. 62195				

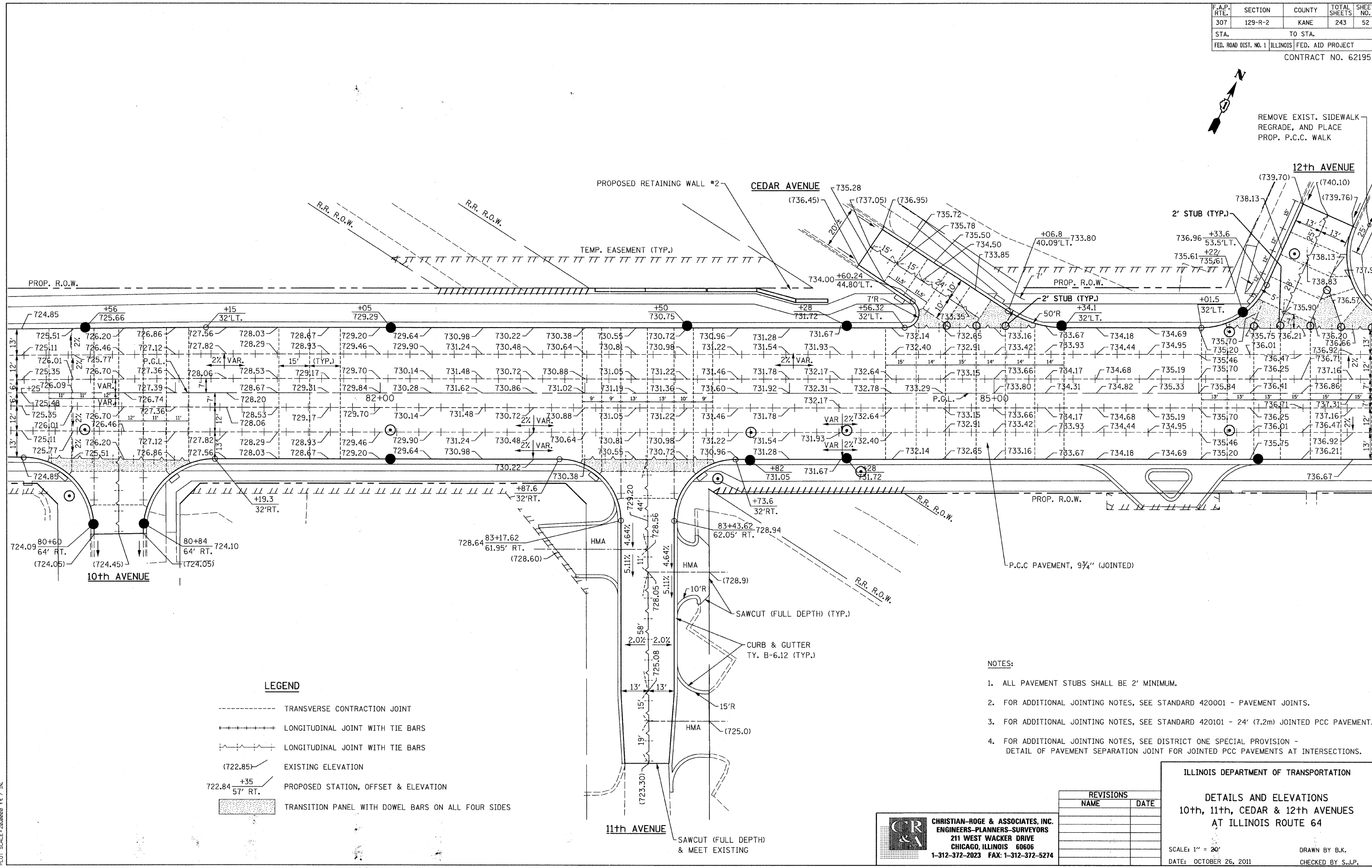

REMOVE EXIST. SIDEWALK
REGRADE, AND PLACE
PROP. P.C.C. WALK



LEGEND

- TRANSVERSE CONTRACTION JOINT
- +++++ LONGITUDINAL JOINT WITH TIE BARS
- ~~~~~ LONGITUDINAL JOINT WITH TIE BARS
- (722.85) EXISTING ELEVATION
- 722.84 +35
57' RT. PROPOSED STATION, OFFSET & ELEVATION
- [Hatched Box] TRANSITION PANEL WITH DOWEL BARS ON ALL FOUR SIDES

NOTES:

1. ALL PAVEMENT STUBS SHALL BE 2' MINIMUM.
2. FOR ADDITIONAL JOINTING NOTES, SEE STANDARD 420001 - PAVEMENT JOINTS.
3. FOR ADDITIONAL JOINTING NOTES, SEE STANDARD 420101 - 24' (7.2m) JOINTED PCC PAVEMENT.
4. FOR ADDITIONAL JOINTING NOTES, SEE DISTRICT ONE SPECIAL PROVISION - DETAIL OF PAVEMENT SEPARATION JOINT FOR JOINTED PCC PAVEMENTS AT INTERSECTIONS.

REVISIONS	
NAME	DATE

CR & A
CHRISTIAN-ROGE & ASSOCIATES, INC.
 ENGINEERS-PLANNERS-SURVEYORS
 211 WEST WACKER DRIVE
 CHICAGO, ILLINOIS 60606
 1-312-372-2023 FAX: 1-312-372-5274

ILLINOIS DEPARTMENT OF TRANSPORTATION
DETAILS AND ELEVATIONS
 10th, 11th, CEDAR & 12th AVENUES
 AT ILLINOIS ROUTE 64

SCALE: 1" = 20'
 DATE: OCTOBER 26, 2011

DRAWN BY B.K.
 CHECKED BY S.J.P.

FILE NAME: r:\6462\6462\6462.dgn
 PLOT DATE: 10/28/2011
 PLOT SCALE: 20X/0.00 FT. / IN.