

F.A.P. RTE.	SECTION	COUNTY	TOTAL SHEETS	SHEET NO.
307	129-R-2	KANE	243	53
STA.		TO STA.		
FED. ROAD DIST. NO. 1		ILLINOIS FED. AID PROJECT		
CONTRACT NO. 62195				

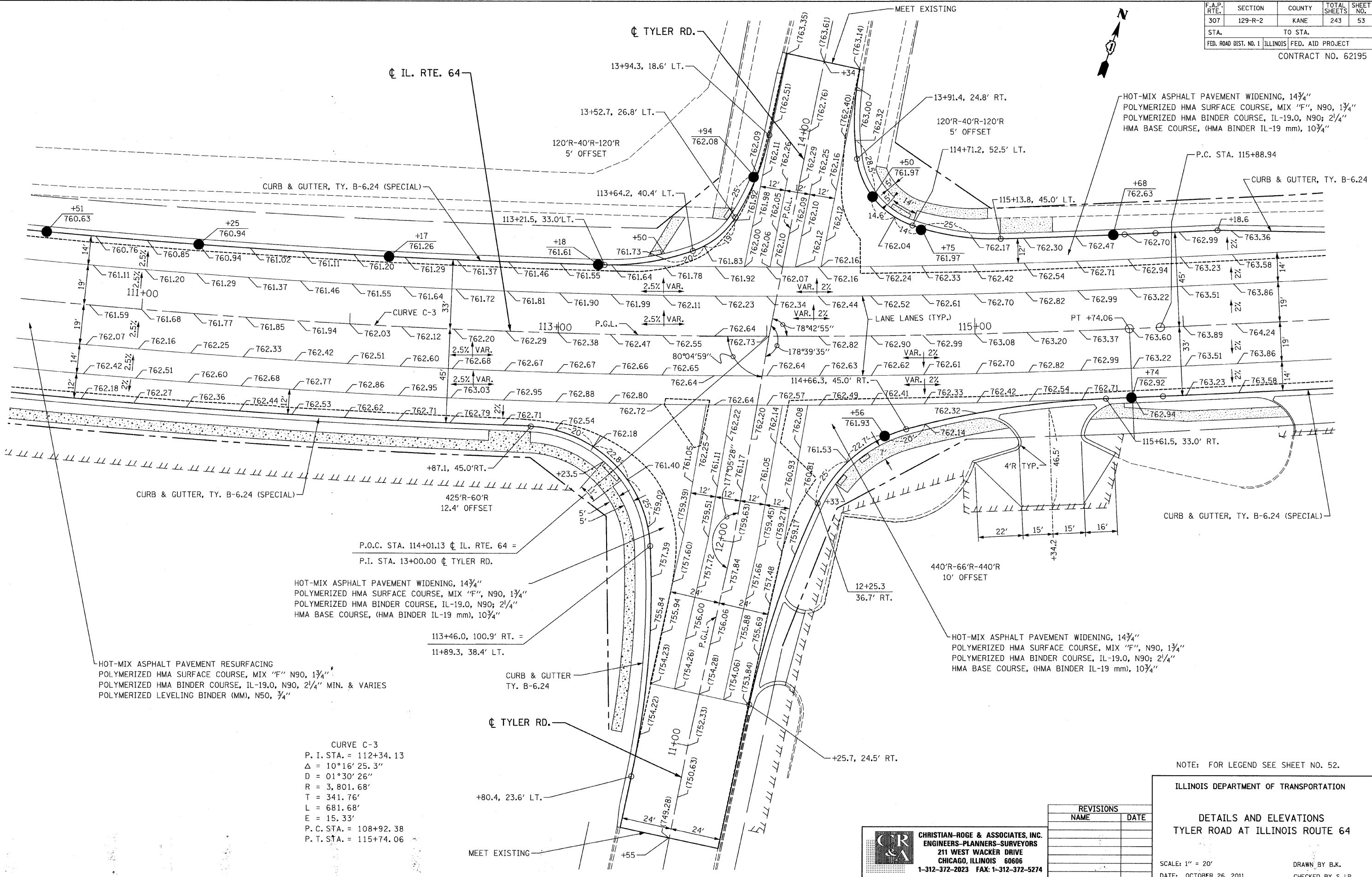

HOT-MIX ASPHALT PAVEMENT WIDENING, 14 3/4"  
 POLYMERIZED HMA SURFACE COURSE, MIX "F", N90, 1 3/4"  
 POLYMERIZED HMA BINDER COURSE, IL-19.0, N90; 2 1/4"  
 HMA BASE COURSE, (HMA BINDER IL-19 mm), 10 3/4"

HOT-MIX ASPHALT PAVEMENT RESURFACING  
 POLYMERIZED HMA SURFACE COURSE, MIX "F" N90, 1 3/4"  
 POLYMERIZED HMA BINDER COURSE, IL-19.0, N90, 2 1/4" MIN. & VARIES  
 POLYMERIZED LEVELING BINDER (MM), N50, 3/4"

CURVE C-3  
 P. I. STA. = 112+34.13  
 $\Delta = 10^\circ 16' 25.3''$   
 $D = 01^\circ 30' 26''$   
 $R = 3,801.68'$   
 $T = 341.76'$   
 $L = 681.68'$   
 $E = 15.33'$   
 P. C. STA. = 108+92.38  
 P. T. STA. = 115+74.06

NOTE: FOR LEGEND SEE SHEET NO. 52.

ILLINOIS DEPARTMENT OF TRANSPORTATION

DETAILS AND ELEVATIONS  
 TYLER ROAD AT ILLINOIS ROUTE 64

DRAWN BY B.K.  
 CHECKED BY S.J.P.

SCALE: 1" = 20'  
 DATE: OCTOBER 26, 2011

REVISIONS	
NAME	DATE

**CR & A**  
 CHRISTIAN-ROGE & ASSOCIATES, INC.  
 ENGINEERS-PLANNERS-SURVEYORS  
 211 WEST WACKER DRIVE  
 CHICAGO, ILLINOIS 60606  
 1-312-372-2023 FAX: 1-312-372-5274

FILE NAME: r6646281jw-0.dgn  
 PLOT DATE: 10/26/2011  
 PLOT SCALE: 20.0000 Ft. / IN.