

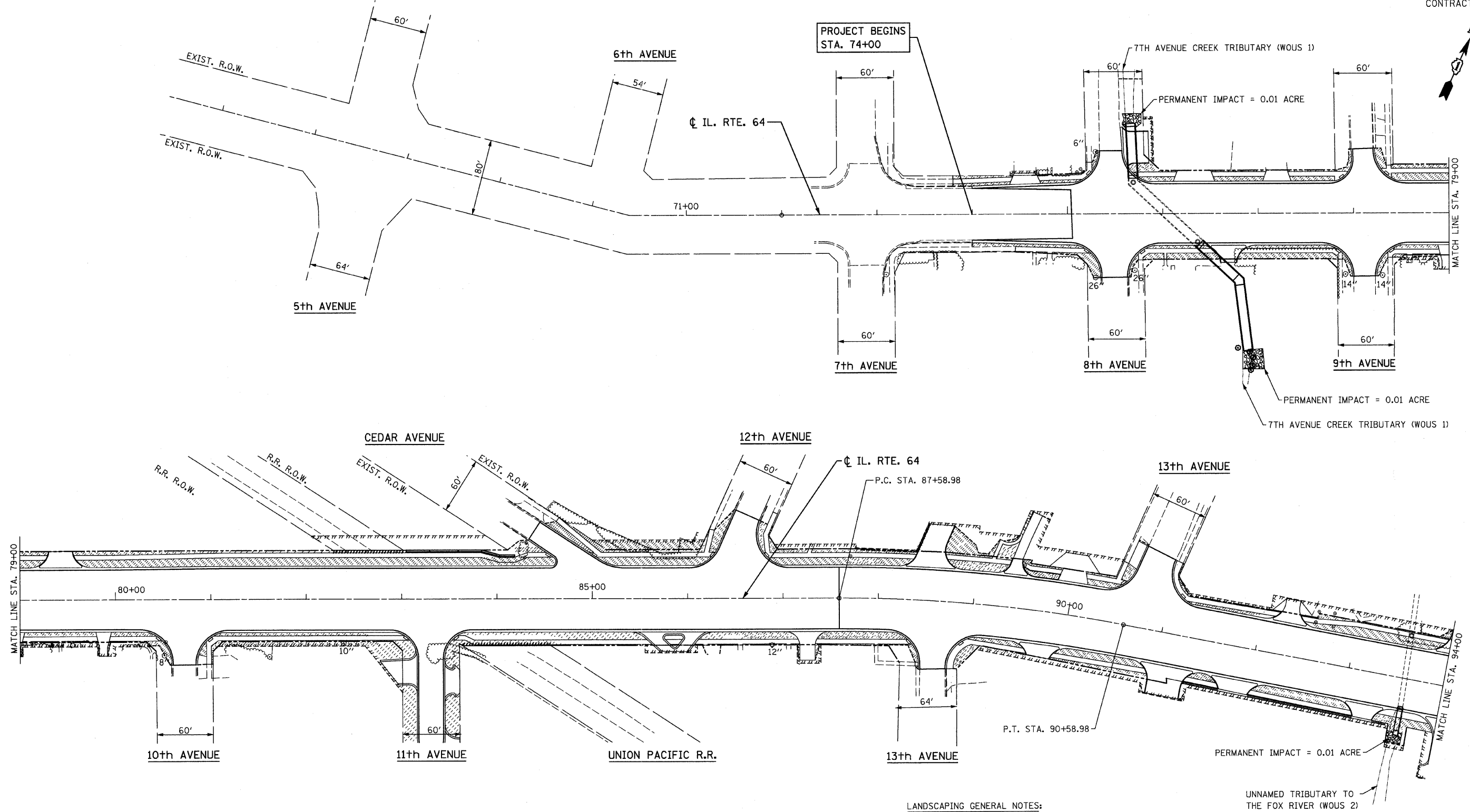



F.A.P. RTE.	SECTION	COUNTY	TOTAL SHEETS	SHEET NO.
307	129-R-2	KANE	243	113
STA.	TO STA.			
FED. ROAD DIST. NO. 1	ILLINOIS	FED. AID PROJECT		

CITY OF ST. CHARLES

CONTRACT NO. 62195



LEGEND

-  SODDING (SALT TOLERANT)
-  6" EXIST. DECIDUOUS TREE (6" OR LARGER)
-  EXIST. TREE OR BUSH (SMALLER THAN 6")
-  EVERGREEN TREE

LANDSCAPING GENERAL NOTES:

1. THE CONTRACTOR SHALL INSTALL TEMPORARY FENCE AT THE DRIP LINE OF ALL TREES TO BE SAVED.
2. TREE ROOT PRUNING SHALL BE PERFORMED ADJACENT TO SIDEWALK AND CURB AND GUTTER INSTALLATION.

**CR & A**  
**CHRISTIAN-ROGE & ASSOCIATES, INC.**  
 ENGINEERS-PLANNERS-SURVEYORS  
 211 WEST WACKER DRIVE  
 CHICAGO, ILLINOIS 60606  
 1-312-372-2023 FAX: 1-312-372-5274

REVISIONS	
NAME	DATE

ILLINOIS DEPARTMENT OF TRANSPORTATION

**LANDSCAPING PLAN**  
 STA. 71+00 TO STA. 94+00  
 ILLINOIS ROUTE 64

SCALE: 1" = 50'  
 DATE: AUGUST 10, 2011  
 DRAWN BY B.K.  
 CHECKED BY S.J.P.