

CIVIL ENGINEERING CONSULTANTS
RWA
 Regina Webster & Associates, Inc.
 8619 W. Bryn Mawr Ave., Suite 602
 Chicago, IL 60631-3551
 773-283-2600 Fax: 773-283-2602
 www.RWAEngineers.com

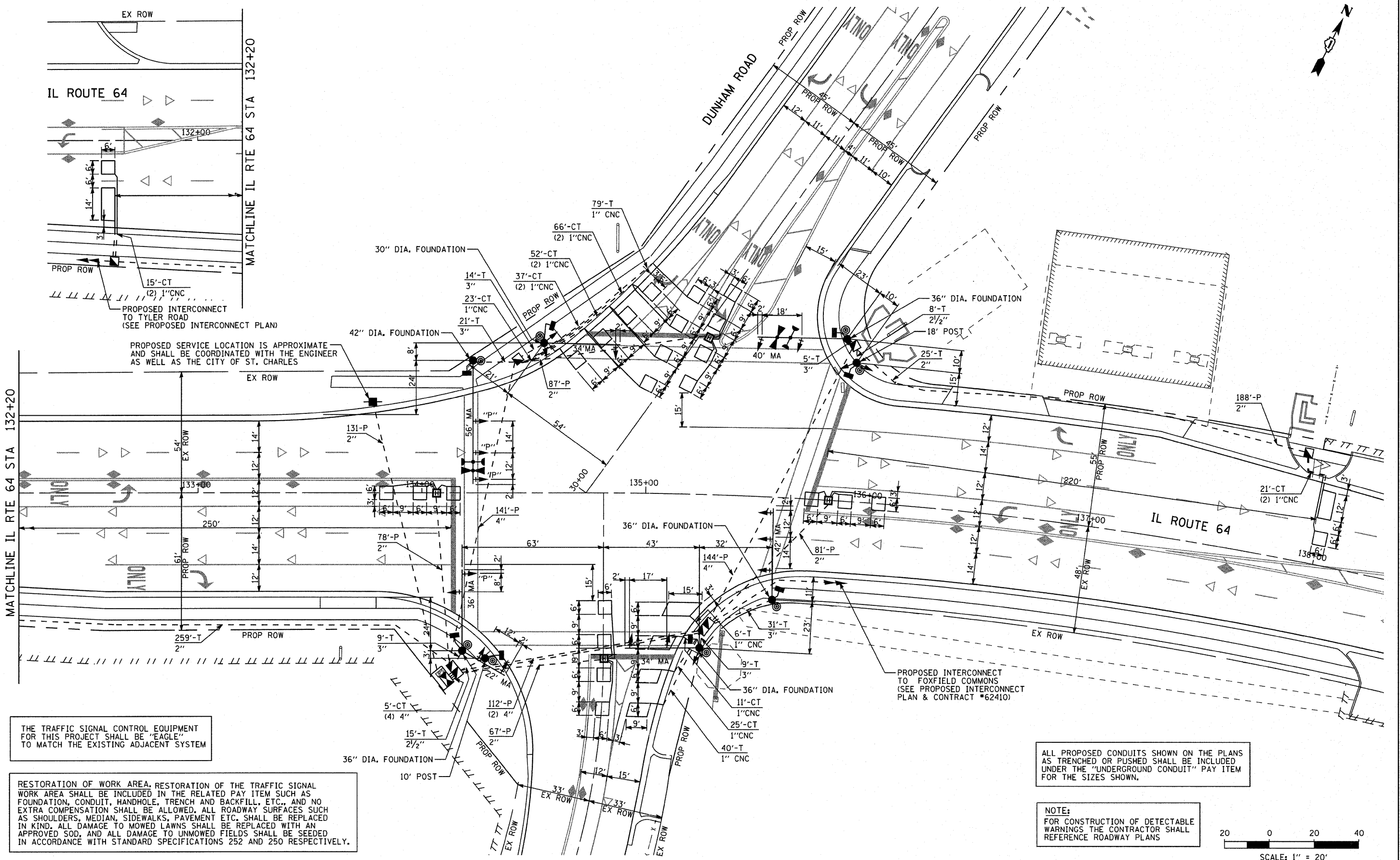
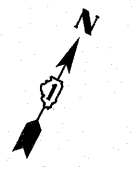

THE TRAFFIC SIGNAL CONTROL EQUIPMENT FOR THIS PROJECT SHALL BE "EAGLE" TO MATCH THE EXISTING ADJACENT SYSTEM

RESTORATION OF WORK AREA: RESTORATION OF THE TRAFFIC SIGNAL WORK AREA SHALL BE INCLUDED IN THE RELATED PAY ITEM SUCH AS FOUNDATION, CONDUIT, HANDHOLE, TRENCH AND BACKFILL, ETC., AND NO EXTRA COMPENSATION SHALL BE ALLOWED. ALL ROADWAY SURFACES SUCH AS SHOULDERS, MEDIAN, SIDEWALKS, PAVEMENT ETC. SHALL BE REPLACED IN KIND. ALL DAMAGE TO MOWED LAWNS SHALL BE REPLACED WITH AN APPROVED SOD, AND ALL DAMAGE TO UNMOWED FIELDS SHALL BE SEED IN ACCORDANCE WITH STANDARD SPECIFICATIONS 252 AND 250 RESPECTIVELY.

PROPOSED INTERCONNECT TO FOXFIELD COMMONS (SEE PROPOSED INTERCONNECT PLAN & CONTRACT #62410)

ALL PROPOSED CONDUITS SHOWN ON THE PLANS AS TRENCHED OR PUSHED SHALL BE INCLUDED UNDER THE "UNDERGROUND CONDUIT" PAY ITEM FOR THE SIZES SHOWN.

NOTE:
 FOR CONSTRUCTION OF DETECTABLE WARNINGS THE CONTRACTOR SHALL REFERENCE ROADWAY PLANS

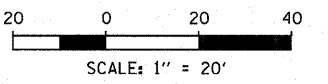

FILE NAME =	USER NAME = #USER#	DESIGNED - DW	REVISED -	STATE OF ILLINOIS DEPARTMENT OF TRANSPORTATION	IL ROUTE 64 AND DUNHAM ROAD TRAFFIC SIGNAL MODERNIZATION PLAN			F.A. RTE.	SECTION	COUNTY	TOTAL SHEET NO.		
#FILE#		DRAWN - DW	REVISED -					307	129 R-2	KANE	243	130	
	PLOT SCALE = #SCALE#	CHECKED - JS	REVISED -					SCALE: 1"=20'-0"			SHEET NO. OF SHEETS STA. TO STA.		
	PLOT DATE = #DATE#	DATE -	REVISED -					CONTRACT NO. 62195			[ILLINOIS] FED. AID PROJECT		