

CIVIL ENGINEERING CONSULTANTS  
**RWA**  
 Regina Webster & Associates, Inc.  
 8619 W. Bryn Mawr Ave., Suite 602  
 Chicago, IL 60631-3551  
 773-283-2600 Fax 773-283-2602  
 www.RWAengineers.com

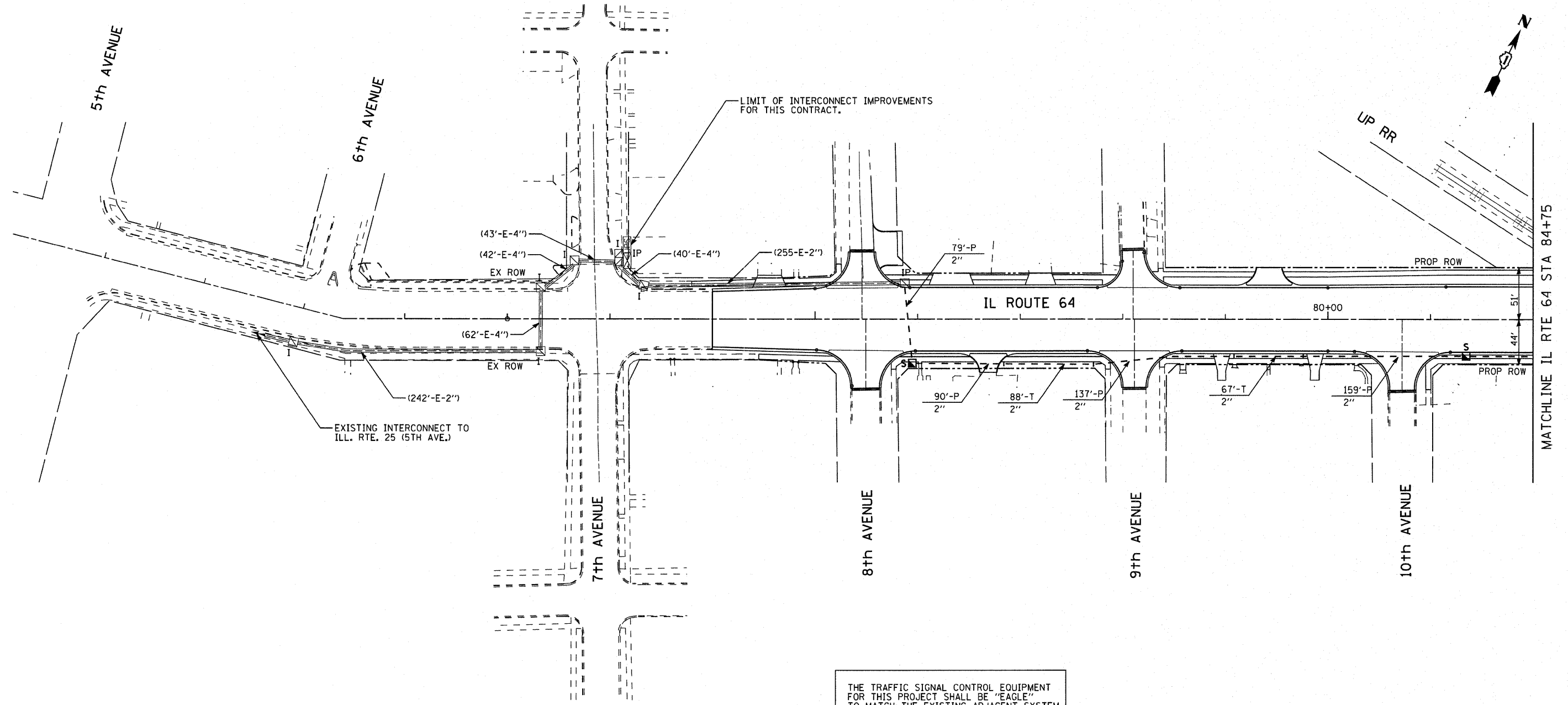

THE TRAFFIC SIGNAL CONTROL EQUIPMENT FOR THIS PROJECT SHALL BE "EAGLE" TO MATCH THE EXISTING ADJACENT SYSTEM

THERE WILL BE NO FIBER OPTIC OR TRACER CABLE INSTALLED AS PART OF CONTRACT #62195

ALL PROPOSED CONDUITS SHOWN ON THE PLANS AS TRENCHED OR PUSHED SHALL BE INCLUDED UNDER THE "UNDERGROUND CONDUIT" PAY ITEM FOR THE SIZES SHOWN.

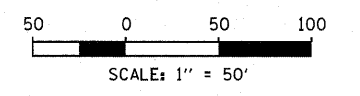

SHEET 1 OF 5

FILE NAME =	USER NAME = #USER#	DESIGNED - DW	REVISED -	<b>STATE OF ILLINOIS DEPARTMENT OF TRANSPORTATION</b>	<b>INTERCONNECT PLAN IL ROUTE 64 5th AVENUE TO EAST OF 11th AVENUE</b>			F.A. RTE. 307	SECTION 129 R-2	COUNTY KANE	TOTAL SHEETS 243	SHEET NO. 136
#FILE#		DRAWN - DW	REVISED -		SCALE: 1"=50'-0"	SHEET NO.	OF	SHEETS	STA.	TO STA.	CONTRACT NO. 62195	
		CHECKED - JS	REVISED -								ILLINOIS FED. AID PROJECT	
		DATE -	REVISED -									