

CIVIL ENGINEERING CONSULTANTS
RWA
 Regina Webster & Associates, Inc.
 8619 W. Bryn Mawr Ave., Suite 602
 Chicago, IL 60631-3551
 773-283-2600 Fax: 773-283-2602
 www.RWAengineers.com

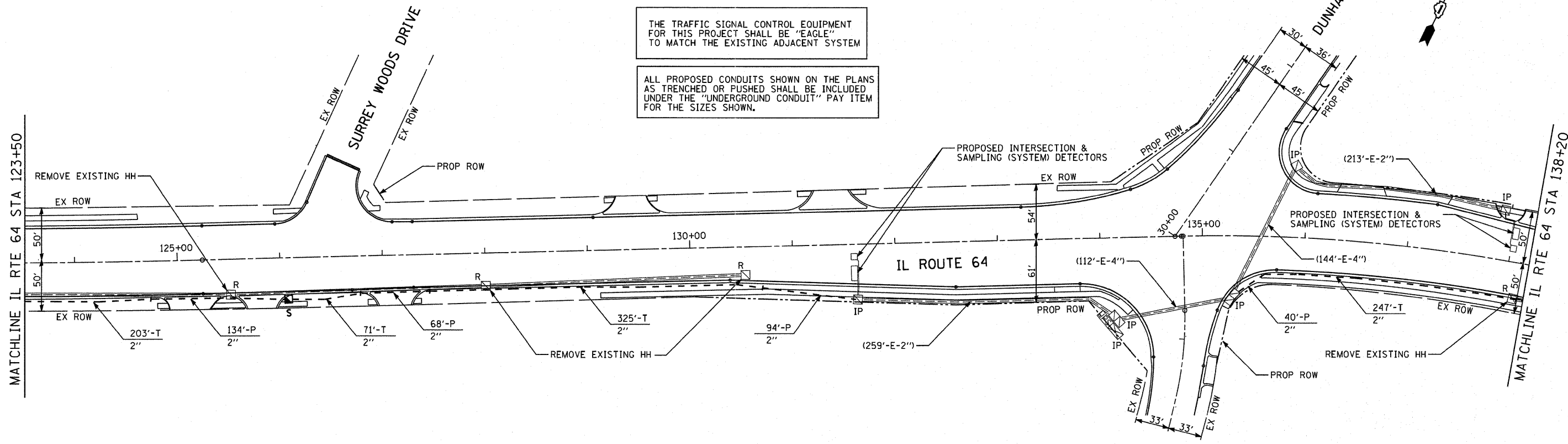

THE TRAFFIC SIGNAL CONTROL EQUIPMENT FOR THIS PROJECT SHALL BE "EAGLE" TO MATCH THE EXISTING ADJACENT SYSTEM

ALL PROPOSED CONDUITS SHOWN ON THE PLANS AS TRENCHED OR PUSHED SHALL BE INCLUDED UNDER THE "UNDERGROUND CONDUIT" PAY ITEM FOR THE SIZES SHOWN.

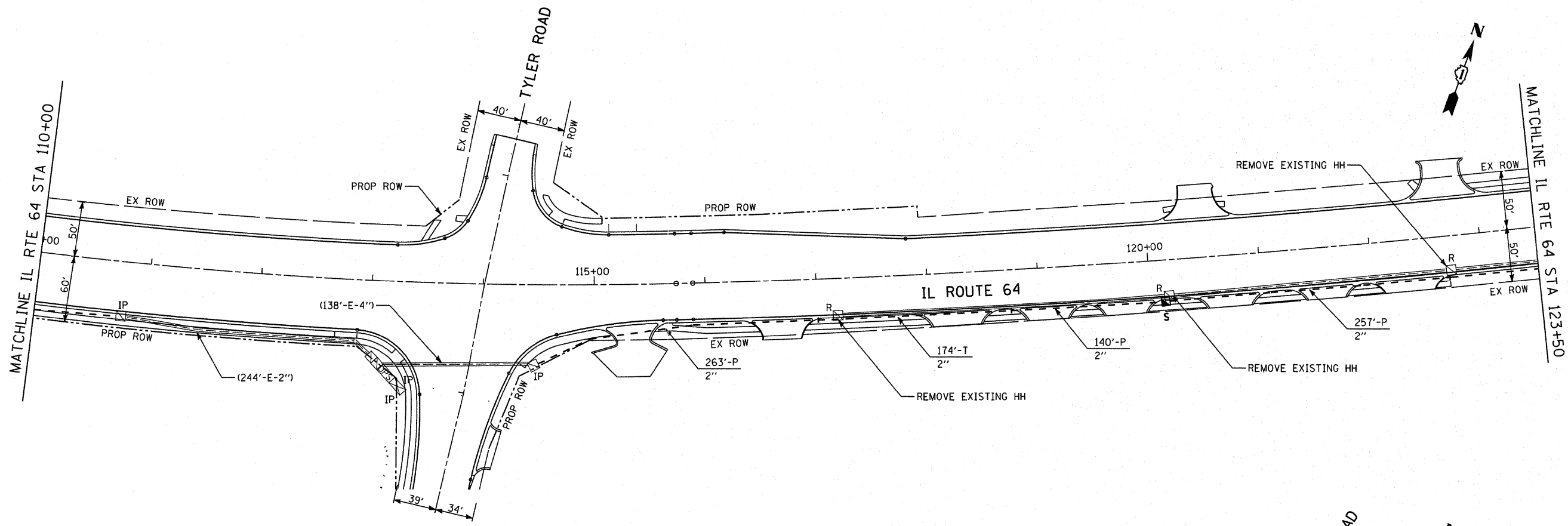
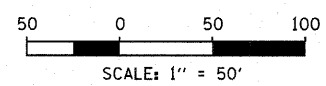

SHEET 3 OF 5

FILE NAME =	USER NAME = #USER#	DESIGNED - DW	REVISED -
#FILE#		DRAWN - DW	REVISED -
	PLOT SCALE = #SCALE#	CHECKED - JS	REVISED -
	PLOT DATE = #DATE#	DATE -	REVISED -

**STATE OF ILLINOIS
 DEPARTMENT OF TRANSPORTATION**

INTERCONNECT PLAN IL ROUTE 64 WEST OF TYLER ROAD TO EAST OF DUNHAM ROAD			
SCALE: 1"=50'-0"	SHEET NO.	OF SHEETS	STA. TO STA.

F.A. RTE.	SECTION	COUNTY	TOTAL SHEETS	SHEET NO.
307	129 R-2	KANE	243	138
CONTRACT NO. 62195				
ILLINOIS FED. AID PROJECT				