

| | | | | |
|-----------------------|---------|----------|------------------|-----------|
| F.A.P. RTE. | SECTION | COUNTY | TOTAL SHEETS | SHEET NO. |
| 307 | 129 R-2 | KANE | 243 | 147 |
| STA. | | TO STA. | | |
| FED. ROAD DIST. NO. 1 | | ILLINOIS | FED. AID PROJECT | |

CITY OF ST. CHARLES

- NOTES**
- 24" DIAMETER CONCRETE OFFSET FOUNDATION.
 - PROVIDE A 3'-0" SETBACK FROM BACK OF CURB TO FACE OF POLE OR POLE BASE FOR ALL PROPOSED POLES, UNO.

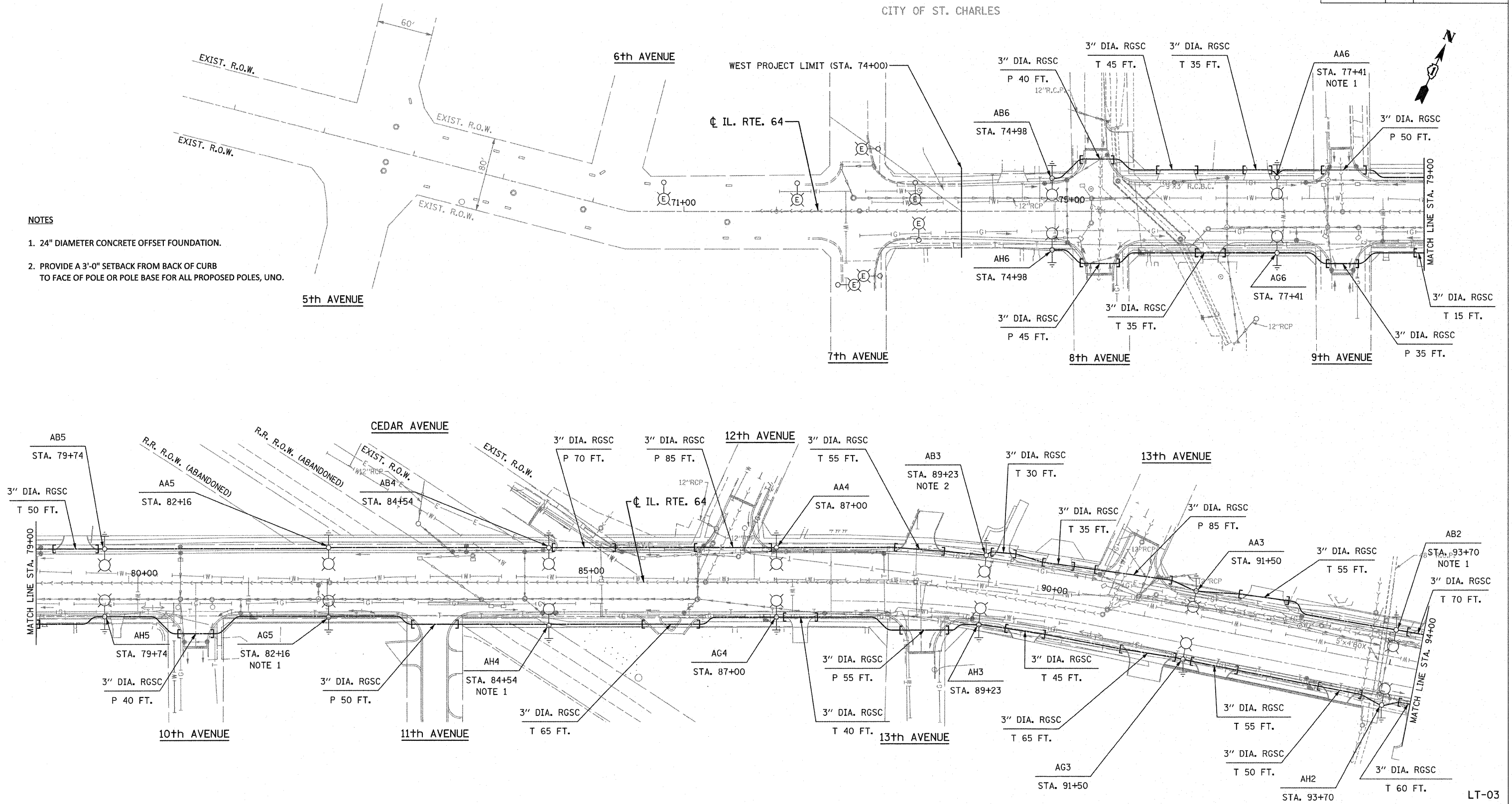

19/26/2011 12:05:08 PM

GRAPHIC SCALE

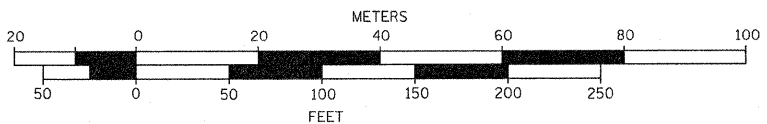

| REVISIONS | |
|-----------|------|
| NAME | DATE |
| | |
| | |
| | |
| | |

ILLINOIS DEPARTMENT OF TRANSPORTATION

**ILLINOIS ROUTE 64
PROPOSED LIGHTING PLAN
STA. 71+00 TO STA. 94+00**

SCALE: VERT.: N.A.
HORIZ.: 1" = 50'
DATE: SEPT. 2010

DRAWN BY: M. J./D. L.
CHECKED BY: I. B.

SPAAN Tech, Inc.
311 South Wacker Drive, Suite 2400
Chicago, IL 60606
phone: 312.277.8800
fax: 312.277.8808
web: www.SpaanTech.com

CHRISTIAN-ROGE & ASSOCIATES, INC.
ENGINEERS-PLANNERS-SURVEYORS
211 WEST WACKER DRIVE
CHICAGO, ILLINOIS 60606
1-312-372-2023 FAX: 1-312-372-5274