

F.A.P. RTE.	SECTION	COUNTY	TOTAL SHEETS	SHEET NO.
307	129 R-2	KANE	243	149
STA.		TO STA.		
FED. ROAD DIST. NO. 1		ILLINOIS		
FED. AID PROJECT				

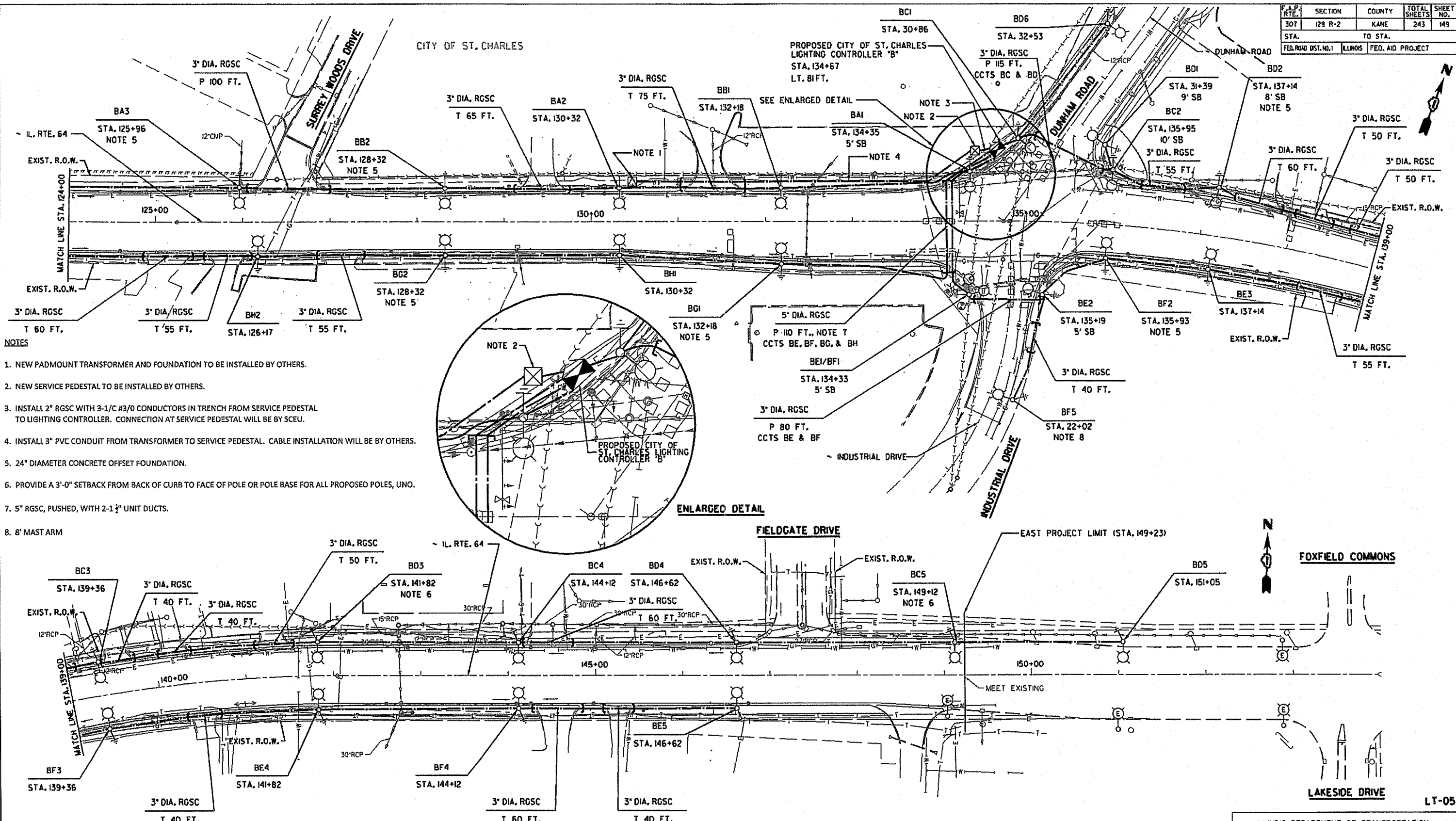

- NOTES**
1. NEW PADMOUNT TRANSFORMER AND FOUNDATION TO BE INSTALLED BY OTHERS.
  2. NEW SERVICE PEDESTAL TO BE INSTALLED BY OTHERS.
  3. INSTALL 2" RGSC WITH 3-1/C #3/0 CONDUCTORS IN TRENCH FROM SERVICE PEDESTAL TO LIGHTING CONTROLLER. CONNECTION AT SERVICE PEDESTAL WILL BE BY SCEU.
  4. INSTALL 3" PVC CONDUIT FROM TRANSFORMER TO SERVICE PEDESTAL. CABLE INSTALLATION WILL BE BY OTHERS.
  5. 24" DIAMETER CONCRETE OFFSET FOUNDATION.
  6. PROVIDE A 3'-0" SETBACK FROM BACK OF CURB TO FACE OF POLE OR POLE BASE FOR ALL PROPOSED POLES, UNO.
  7. 5" RGSC, PUSHED, WITH 2-1 1/4" UNIT DUCTS.
  8. 8' MAST ARM

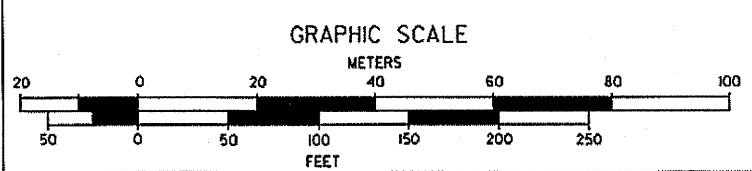
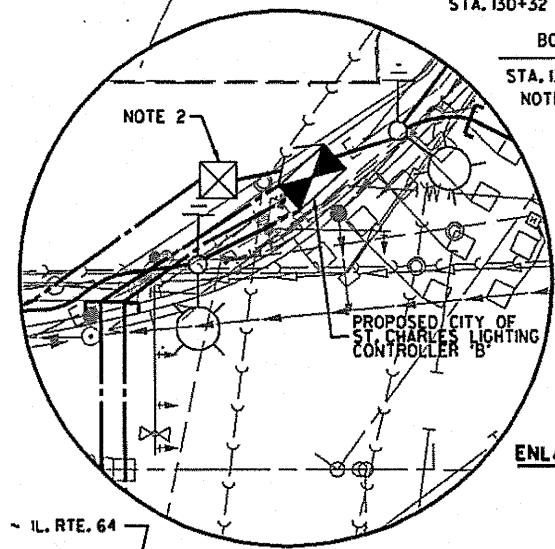

**SPAAN Tech, Inc.**  
 311 South Wacker Drive, Suite 2400  
 Chicago, IL 60605  
 phone: 312.277.8800  
 fax: 312.277.8808  
 web: www.SpaanTech.com

**CHRISTIAN-ROGE & ASSOCIATES, INC.**  
 ENGINEERS-PLANNERS-SURVEYORS  
 211 WEST WACKER DRIVE  
 CHICAGO, ILLINOIS 60606  
 1-312-372-2023 FAX: 1-312-372-5274

REVISIONS	
NAME	DATE

ILLINOIS DEPARTMENT OF TRANSPORTATION  
**ILLINOIS ROUTE 64  
 PROPOSED LIGHTING PLAN  
 STA. 124+00 TO STA. 153+00 &  
 INDUSTRIAL DRIVE / DUNHAM ROAD**  
 SCALE: VERT. 1" = 10'  
 HORIZ. 1" = 50'  
 DATE: SEPT, 2010  
 DRAWN BY: M. J. D. L.  
 CHECKED BY: I. B.

12/16/2010 11:02:25 AM