

BILL OF MATERIAL

BAR NO.	SIZE	LENGTH	SHAPE
h(E)	90	#6	32'-7"
h ₁ (E)	48	#6	29'-8"
h ₂ (E)	22	#6	25'-7"
h ₃ (E)	18	#6	22'-8"
u(E)	226	#6	5'-2"
v(E)	226	#6	4'-3"
v ₁ (E)	30	#6	13'-11"
v ₂ (E)	30	#6	17'-1"
v ₃ (E)	120	#6	10'-3"
v ₄ (E)	120	#6	8'-3"
v ₅ (E)	23	#6	15'-9"
v ₆ (E)	23	#6	13'-0"

Concrete Structures	Cu. Yd.	84.7
Reinforcement Bars, Epoxy Coated	Pound	16,920
Structure Excavation	Cu. Yd.	151
Stud Shear Connectors	Each	740

LEGEND:
 F.F. = Front Face
 B.F. = Back Face
 E.F. = Each Face
 (C) = Construction Jt.
 (E) = Expansion Jt. (1/2")
 (I) = Pile Numbers

MIN. BAR LAP:
 #6 bars = 2'-7"

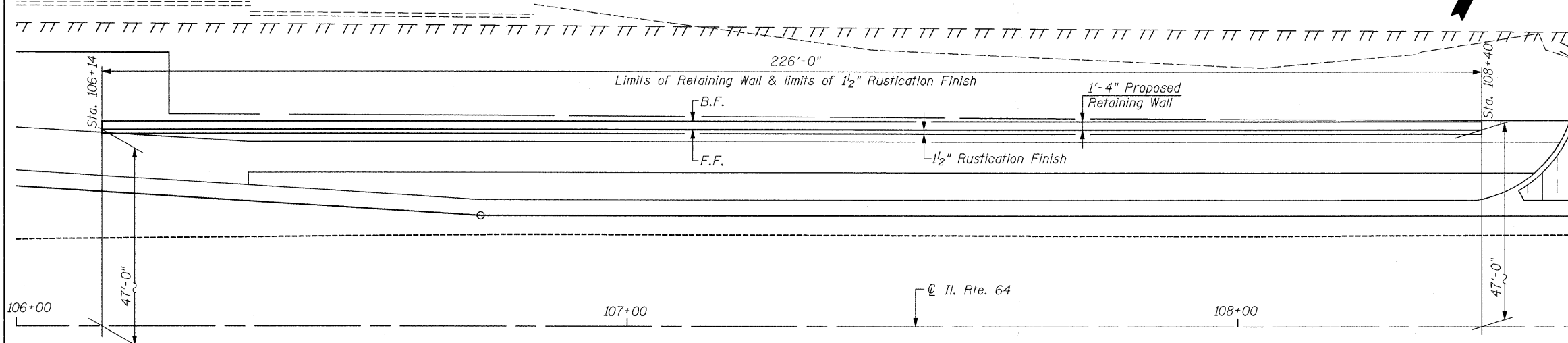
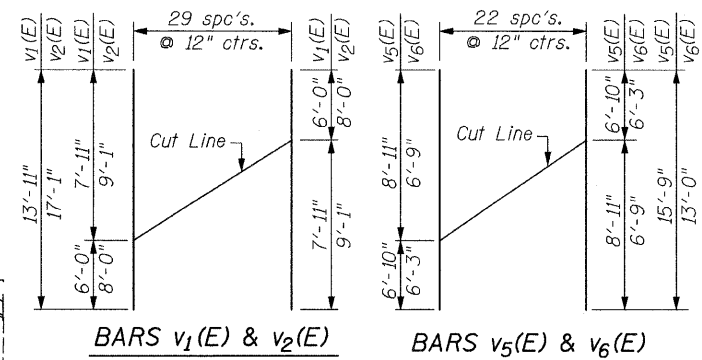

SOLDIER PILE RETAINING WALL (RW-3)

NOTES:
 For Constr. Jt. (C) & Exp. Jt. (E) Details, See Sht. S4.
 Place reinforcement bars to miss Shear Studs while conforming to maximum spacing as indicated.

REVISIONS

NAME	DATE

ILLINOIS DEPARTMENT OF TRANSPORTATION
REINFORCEMENT DETAILS
SOLDIER PILE RETAINING WALL (RW-3)
 F.A.P. RTE. 307 (IL. RTE. 64)
 SECTION 129-R-2
 STA. 106+14.00 TO STA. 108+40.00
 KANE COUNTY
 STRUCTURE NO. 045-W009
 SCALE: 1"=10'
 DATE: AUGUST 10, 2011
 DRAWN BY: F.M.
 CHECKED BY: B.N.S.
CHRISTIAN-ROGE & ASSOC., INC.
 CHICAGO ILLINOIS

FILE NAME = r1064-rm13a.dgn
 PLOT DATE = 9/12/2011
 PLOT SCALE = 1/8" = 1'-0"