

EXISTING LEGEND:

- CURB
- GUTTER
- CENTER LINE OF ROADWAY
- EDGE OF PAVEMENT
- RIGHT OF WAY
- LIGHT POLE
- POWER POLE
- T.S LIGHT POLE
- CATCH BASIN
- S.S MANHOLE
- MANHOLE
- SIGN

- T.S H.H
- GAS M.H
- INLET
- FIRE HYDRANT
- T.S CONTROLLER BOX
- T.S DOUBLE HAND HOLE
- EXISTING TREE
- MAIL BOX
- SHURBS
- CONCRETE WALK

LEGEND ITEM TO BE REMOVED

- ▨ DRIVEWAY PAVEMENT REMOVAL
- ▨ COMBINATION CONCRETE CURB&GUTTER
- ▨ EXCAVATION FOR SIDEWALK

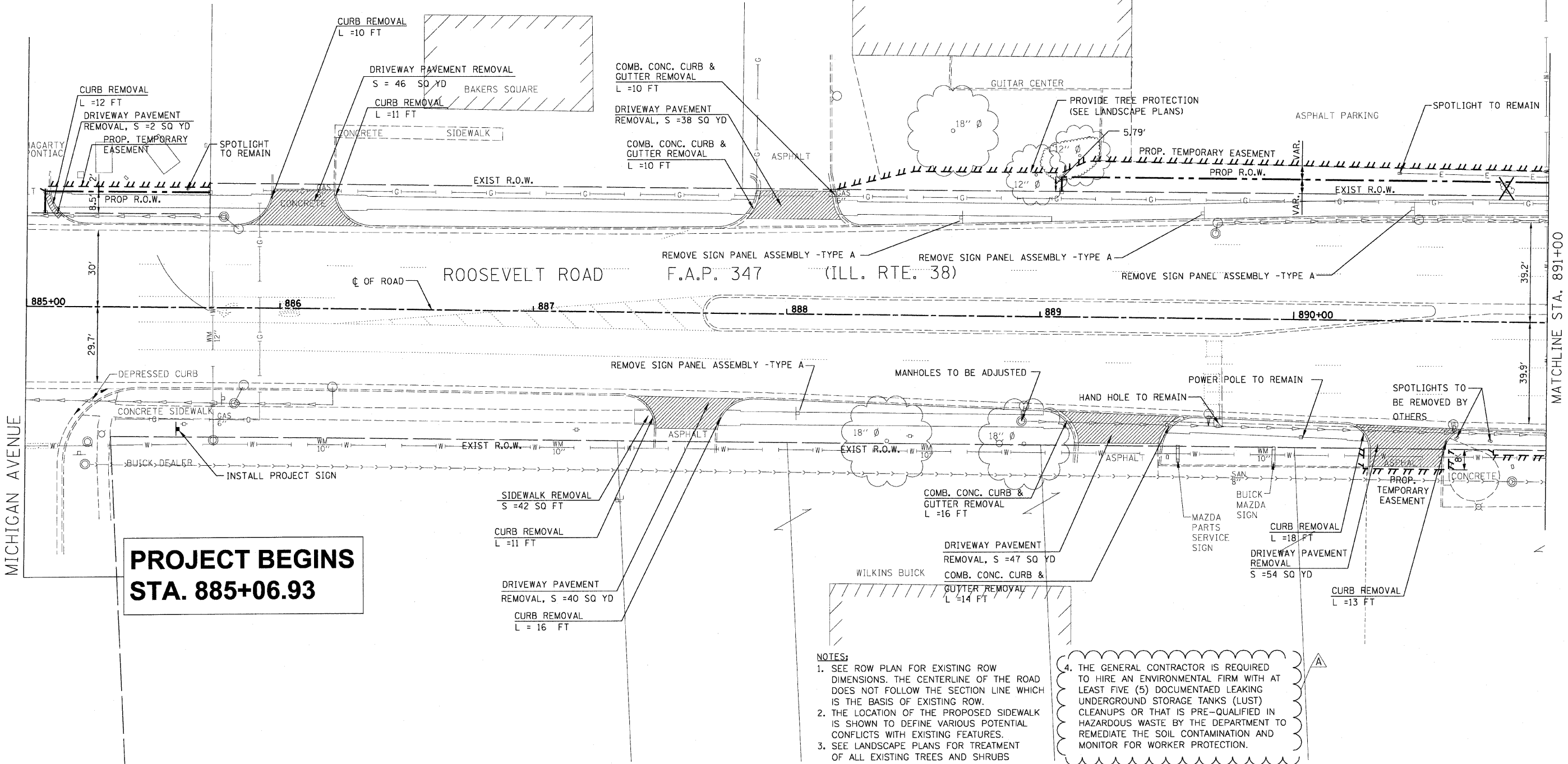

**PROJECT BEGINS
STA. 885+06.93**

- NOTES:**
- SEE ROW PLAN FOR EXISTING ROW DIMENSIONS. THE CENTERLINE OF THE ROAD DOES NOT FOLLOW THE SECTION LINE WHICH IS THE BASIS OF EXISTING ROW.
 - THE LOCATION OF THE PROPOSED SIDEWALK IS SHOWN TO DEFINE VARIOUS POTENTIAL CONFLICTS WITH EXISTING FEATURES.
 - SEE LANDSCAPE PLANS FOR TREATMENT OF ALL EXISTING TREES AND SHRUBS WITHIN WORK AREA.
 - THE GENERAL CONTRACTOR IS REQUIRED TO HIRE AN ENVIRONMENTAL FIRM WITH AT LEAST FIVE (5) DOCUMENTAED LEAKING UNDERGROUND STORAGE TANKS (LUST) CLEANUPS OR THAT IS PRE-QUALIFIED IN HAZARDOUS WASTE BY THE DEPARTMENT TO REMEDIATE THE SOIL CONTAMINATION AND MONITOR FOR WORKER PROTECTION.

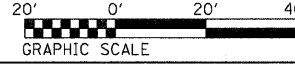

FILE NAME =	USER NAME = #USER#	DESIGNED DA/SC	REVISED 10/24/2011	STATE OF ILLINOIS DEPARTMENT OF TRANSPORTATION	REMOVAL PLAN FROM STA 885+06.93 TO STA 891+00				F.A.P. RTE. 347	SECTION 02-00077-00-SW	COUNTY	TOTAL SHEETS 73	SHEET NO. 11
#FILE#		DRAWN BM/CC/BB	REVISED 01/03/2012 ADDENDUM A		SCALE: AS SHOWN SHEET NO. 1 OF 4 SHEETS STA. 885+07 TO STA. 891+00				CONTRACT NO. 63197				
		CHECKED DA	REVISED										
		DATE 06/08/2011	REVISED										