

INDEX OF SHEETS

- 1 COVER SHEET
- 2 INDEX OF SHEETS, LIST OF ILLINOIS D.O.T. HIGHWAY STANDARDS, GENERAL NOTES AND COMMITMENTS
- 3 SUMMARY OF QUANTITIES
- 4-8 TYPICAL SECTIONS
- 9 SCHEDULES OF QUANTITIES
- 10 ALIGNMENT, TIES AND BENCHMARKS
- 11 REMOVAL PLAN FROM STA 885+06.93 TO STA 891+00
- 12 REMOVAL PLAN FROM STA 891+00 TO STA 897+00
- 13 REMOVAL PLAN FROM STA 897+00 TO STA 902+00
- 14 REMOVAL PLAN FROM STA 902+00 TO STA 905+78.26
- 15 PROPOSED PLAN FROM STA 885+06.93 TO STA 891+00
- 16 PROPOSED PLAN FROM STA 891+00 TO STA 897+00
- 17 PROPOSED PLAN FROM STA 897+00 TO STA 902+00
- 18 PROPOSED PLAN FROM STA 902+00 TO STA 905+78.26
- 19 MAINTENANCE OF TRAFFIC PLAN - ROOSEVELT RD. AND VILLA OAKS DR. INTERSECTION
- 20 EXISTING AND PROPOSED GRADING PLAN FROM STA 885+06.93 TO STA 891+00
- 21 EXISTING AND PROPOSED GRADING PLAN FROM STA 891+00 TO STA 897+00
- 22 EXISTING AND PROPOSED GRADING PLAN FROM STA 897+00 TO STA 902+00
- 23 EXISTING AND PROPOSED GRADING PLAN FROM STA 902+00 TO STA 905+78.26
- 24 EROSION AND SEDIMENT CONTROL PLAN FROM STA 885+06.93 TO STA 897+00
- 25 EROSION AND SEDIMENT CONTROL PLAN FROM STA 897+00 TO STA 905+78.26
- 26 REGULATED SUBSTANCE REMOVAL PLAN FROM STA 885+06.93 TO STA 892+00
- 27 REGULATED SUBSTANCE REMOVAL PLAN FROM STA 892+00 TO STA 905+78.26
- 28 RIGHT OF WAY PLAN FROM STA 877+85.48 TO STA 885+72
- 29 RIGHT OF WAY PLAN FROM STA 885+72 TO STA 892+17
- 30 RIGHT OF WAY PLAN FROM STA 892+02 TO STA 900+05
- 31 RIGHT OF WAY PLAN FROM STA 900+00 TO STA 905+00
- 32 RIGHT OF WAY PLAN FROM STA 900+00 TO STA 905+00
- 33 RIGHT OF WAY PLAN FROM STA 887+20 TO STA 894+10
- 34 RIGHT OF WAY PLAN FROM STA 894+60 TO STA 899+20
- 35 RIGHT OF WAY PLAN FROM STA 896+92 TO STA 897+83
- 36 PAVEMENT MARKING DETAILS
- 37 LANDSCAPE PLAN FROM STA 885+06.93 TO STA 897+00
- 38 LANDSCAPE PLAN FROM STA 897+00 TO STA 905+78.26
- 39 LANDSCAPE PLAN - PLANT SCHEDULE, LEGENDS AND DETAIL
- 40 SUMMARY OF TRAFFIC SIGNAL QUANTITIES
- 41-46 D1 STANDARD TRAFFIC SIGNAL DESIGN DETAILS (6 SHEETS)
- 47 EXISTING TRAFFIC SIGNAL INSTALLATION PLAN ROOSEVELT RD. AT VILLA OAKS DR.
- 48 EXISTING CABLE PLAN - ROOSEVELT RD. AT VILLA OAKS DR. INTERSECTION
- 49 TRAFFIC SIGNAL MODIFICATION PLAN - ROOSEVELT RD AT VILLA OAKS DR. INTERSECTION
- 50 SCHEDULE OF QUANTITIES, CABLE PLAN AND PHASE DESIGNATION DIAGRAM - AT VILLA OAKS DR. INTERSECTION
- 51 TRAFFIC SIGNAL MODIFICATION PLAN - ROOSEVELT RD AT ARDMORE AVE INTERSECTION
- 52 SCHEDULE OF QUANTITIES, CABLE PLAN AND PHASE DESIGNATION DIAGRAM - ROOSEVELT RD AT ARDMORE AVE INTERSECTION
- 53 SEGMENTAL CONCRETE BLOCK WALL - TYPICAL SECTIONS AND ELEVATIONS
- 54 SEGMENTAL CONCRETE BLOCK WALL - WALL CROSS SECTIONS
- 55 CULVERT CROSSING DETAILS
- 56 HANDRAIL MOUNTING DETAILS
- 57-58 PROJECT SPECIFIC DETAILS

DISTRICT ONE STANDARD DETAILS

- 59 BD-36 FIRE HYDRANT TO BE MOVED
- 60 TC-10 TRAFFIC CONTROL AND PROTECTION FOR SIDEROADS, INTERSECTIONS, AND DRIVEWAYS
- 61 TC-13 DISTRICT ONE TYPICAL PAVEMENT MARKINGS
- 62 TC-22 ARTERIAL ROAD INFORMATION SIGN
- 63-73 CROSS SECTIONS

LIST OF ILLINOIS D.O.T. HIGHWAY STANDARDS

- 000001-06 STANDARD SYMBOLS, ABBREVIATIONS AND PATTERNS
- 280001-06 TEMPORARY EROSION CONTROL SYSTEMS
- 424001-06 CURB RAMPS FOR SIDEWALK
- 442201-03 CLASS C AND D PATCHES
- 606001-04 CONCRETE CURB TYPE B AND COMBINATION CONCRETE CURB AND GUTTER
- 701101-02 OFF-RD OPERATIONS, MULTILANE, 15' (4.5 m) TO 24" (600 mm) FROM PAVEMENT EDGE
- 701606-08 URBAN LANE CLOSURE, MULTILANE, 2W WITH MOUNTABLE MEDIAN
- 701701-08 URBAN LANE CLOSURE, MULTILANE INTERSECTION
- 701801-05 LANE CLOSURE MULTILANE 1W OR 2W CROSSWALK OR SIDEWALK CLOSURE
- 701901-02 TRAFFIC CONTROL DEVICES
- 720011-01 METAL POSTS FOR SIGNS, MARKERS & DELINEATORS
- 729001-01 APPLICATIONS OF TYPES A & B METAL POSTS (FOR SIGNS & MARKERS)
- 780001-03 TYPICAL PAVEMENT MARKINGS
- 814001-02 HANDHOLES
- 857001-01 STANDARD PHASE DESIGNATION DIAGRAMS AND PHASE SEQUENCES
- 873001-02 TRAFFIC SIGNAL GROUNDING & BONDING
- 876001-02 PEDESTRIAN PUSH BUTTON POST
- 878001-09 CONCRETE FOUNDATION DETAILS
- 880006-01 TRAFFIC SIGNAL MOUNTING DETAILS
- 886001-01 DETECTOR LOOP INSTALLATIONS
- 886006-01 TYPICAL LAYOUTS FOR DETECTION LOOPS

- 1. BEFORE STARTING ANY EXCAVATION, THE CONTRACTOR SHALL CALL "J.U.L.I.E." AT 800-892-0123 FOR FIELD LOCATIONS OF BURIED ELECTRIC, TELEPHONE, AND GAS FACILITIES. (48 HOURS NOTIFICATION IS REQUIRED).
- 2. THE LOCATIONS OF EXISTING UTILITIES AS SHOWN ON THE PLANS ARE BASED ON THE BEST EXISTING INFORMATION AVAILABLE, BUT THEY ARE NOT GUARANTEED. IT SHALL BE THE CONTRACTOR'S RESPONSIBILITY TO ASCERTAIN THEIR EXACT LOCATION FROM THE UTILITY COMPANIES AND BY FIELD INSPECTION. THE CONTRACTOR SHALL COORDINATE CONSTRUCTION ACTIVITIES WITH UTILITY COMPANIES.
- 3. IT SHALL BE THE CONTRACTOR'S RESPONSIBILITY TO VERIFY ALL DIMENSIONS AND CONDITIONS EXISTING IN THE FIELD PRIOR TO CONSTRUCTION AND ORDERING MATERIALS. VILLAGE WATER AND SEWER MAINS MAY BE LOCATED IN THE LANDSCAPE AREAS. THE CONTRACTOR WILL NOT BE ALLOWED TO PROCEED WITH ANY PLANTING WORK UNTIL ALL UTILITY OWNERS FIELD LOCATE THEIR FACILITIES WHICH MAY INTERFERE WITH CONSTRUCTION OPERATIONS. THE ACTUAL LOCATION OF PROPOSED LANDSCAPING WILL BE ADJUSTED IN THE FIELD TO AVOID UTILITIES.
- 4. THE CONTRACTOR SHALL CONTACT THE DISTRICT ONE TRAFFIC CONTROL SUPERVISOR AT (847)705-4470 A MINIMUM OF 72 HOURS IN ADVANCE OF BEGINNING WORK.
- 5. WHERE SECTION OR SUB-SECTION MONUMENTS ARE ENCOUNTERED, THE ENGINEER SHALL BE NOTIFIED BEFORE SUCH MONUMENTS ARE REMOVED. THE CONTRACTOR SHALL PROTECT AND CAREFULLY PRESERVE ALL PROPERTY MARKERS AND MONUMENTS UNTIL THE OWNER, AN AUTHORIZED SURVEYOR, OR AGENT HAS WITNESSED THEIR LOCATION.
- 6. DO NOT SCALE PLANS FOR CONSTRUCTION DIMENSIONS.
- 7. REMOVAL OF REMAINING UNDER BRUSH, DEBRIS OR OTHER MISCELLANEOUS ITEMS TO ALLOW THE LANDSCAPING ITEMS PLACEMENT SHALL BE INCLUDED IN THE UNIT PRICE OF EARTH EXCAVATION.
- 8. THE CONTRACTOR SHALL USE CARE IN GRADING OR EXCAVATING NEAR ANY AND ALL EXISTING ITEMS WHICH WILL NOT BE REMOVED. ANY DAMAGE DONE TO EXISTING ITEMS BY THE CONTRACTOR SHALL BE REPAIRED BY THE CONTRACTOR AT THE CONTRACTOR'S OWN EXPENSE, OR REPLACED WITH NEW ITEM IF THE ENGINEER DEEMS NECESSARY IN ACCORDANCE WITH ARTICLE 167.20.
- 9. ALL CONSTRUCTION PERSONNEL WILL BE REQUIRED TO WEAR FLUORESCENT ORANGE, FLUORESCENT YELLOW/GREEN OR A COMBINATION OF FLUORESCENT ORANGE AND FLUORESCENT YELLOW/GREEN VEST MEETING THE REQUIREMENTS OF ANSI/ISEA 107-199 FOR CONSPICUITY CLASS 2 GARMENTS. HARD HATS SHALL BE WORN BY ALL CONSTRUCTION PERSONNEL WHO ARE SUBJECT TO MATERIAL DROPPING FROM ABOVE. COMPLIANCE WITH THESE REQUIREMENTS WILL BE INCLUDED IN THE COST OF THIS CONTRACT.
- 10. ABANDONED UNDERGROUND UTILITIES THAT MAY CONFLICT WITH CONSTRUCTION SHALL BE DISPOSED OF OUTSIDE THE LIMITS OF THE RIGHT OF WAY ACCORDING TO ARTICLE 202.03 OF THE STANDARD SPECIFICATIONS AND AS DIRECTED BY THE ENGINEER, THIS WORK WILL NOT BE PAID FOR SEPARATELY BUT SHALL BE INCLUDED IN THE COST OF EARTH EXCAVATION AND NO ADDITIONAL COMPENSATION WILL BE ALLOWED.
- 11. ANY DAMAGE TO UNDERGROUND FACILITIES, CAUSED BY THE CONTRACTOR SHALL BE REPAIRED TO THE SATISFACTION OF THE ENGINEER AT THE CONTRACTOR'S EXPENSE, INCLUDING TEMPORARY REPAIRS WHICH MAY BE REQUIRED TO KEEP THE FACILITY OPERATIONAL WHILE MATERIALS ARE BEING OBTAINED TO MAKE PERMANENT REPAIR IN ACCORDANCE WITH ARTICLES 105.07 AND 107.31.
- 12. THE CONTRACTOR SHALL PROTECT UNDERGROUND UTILITY STRUCTURES IN ACCORDANCE WITH ARTICLE 107.20 OF THE STANDARD SPECIFICATIONS FOR ROAD AND BRIDGE CONSTRUCTION DURING CONSTRUCTION OF THE RELATED ITEMS OF THE PROJECT. THIS WORK WILL NOT BE PAID FOR SEPARATELY BUT SHALL BE INCLUDED IN THE PAY ITEMS ASSOCIATED WITH THE CONSTRUCTION OF THE PROJECT.

- 13. ACCESS MUST BE MAINTAINED TO ALL EXISTING PROPERTIES DURING CONSTRUCTION PER ARTICLE 107.09 UNLESS ARRANGEMENTS ARE MADE IN WRITING BY THE CONTRACTOR WITH THE PROPERTY OWNERS WITH A COPY TO THE ENGINEER FOR SHORT TERM CLOSURES.
- 14. SIGN LOCATIONS MAY VARY FROM THE STATIONS SHOWN ON THE PLANS IN ACCORDANCE WITH DIRECTIONS FROM THE ENGINEER AT THE TIME OF CONSTRUCTION. SIGN LOCATIONS MAY BE ADJUSTED IN THE FIELD TO AVOID EXISTING UTILITIES.
- 15. THE CONTRACTOR SHOULD COORDINATE ANY CONTRACT TREE REMOVAL ACTIVITIES WITH THE UTILITY COMPANIES AND AFFECTED PROPERTY OWNERS TO ELIMINATE CONFLICTS.
- 16. THE CONTRACTOR SHALL BE RESPONSIBLE FOR PROTECTING THE NEWLY POURED CONCRETE FROM VANDALISM, I.E., WRITING, BICYCLE TRACKS, ETC. ANY CONCRETE THAT HAS BEEN DEFACED OR DAMAGED SHALL BE REPLACED BY THE CONTRACTOR AT HIS OWN EXPENSE, AS DIRECTED BY THE ENGINEERS PATCHING OF THE SURFACE WILL NOT BE CONSIDERED AS AN ACCEPTABLE REPAIR METHOD.
- 17. A PROTECTIVE COAT SHALL BE APPLIED TO ALL GUTTER FLAGS, FACE OF CURB, TOP OF CURB, SIDEWALK AND DRIVEWAY SURFACES IN ACCORDANCE WITH THE REQUIREMENTS OF SECTION 420.18.
- 18. SAW CUTTING SHALL BE DONE ALONG THE PERIMETER OF THE AREA TO BE REMOVED OR AS DIRECTED BY THE ENGINEER WHERE ANY PAVEMENT, FRAMES AND GRATES, STRUCTURES, OR DRIVEWAYS ARE TO BE REMOVED, OR ABOUT EXISTING PAVEMENT, CURB AND GUTTER, SIDEWALKS OR DRIVEWAYS THAT SHALL REMAIN. THIS WORK SHALL BE INCLUDED IN THE COST OF THE RESPECTIVE REMOVAL ITEM.
- 19. THE ENGINEER SHALL BE SOLE JUDGE CONCERNING CURING TIME FOR VARIOUS HOT-MIX ASPHALT LIFTS.
- 20. UPON PRIOR TWO WEEK NOTICE BY THE ENGINEER, PROPERTY OWNERS SHALL BE RESPONSIBLE FOR RELOCATING PRIVATELY OWNED ENCROACHMENTS INTO THE HIGHWAY RIGHT-OF-WAY AS IDENTIFIED ON THE PLANS.
- 21. THE HOT-MIX ASPHALT PAVEMENT PRIME COAT QUANTITIES HAVE BEEN DETERMINED USING A RATE OF 0.30 GAL/SQ YD.
- 22. THE GENERAL CONTRACTOR IS REQUIRED TO HIRE AN ENVIRONMENTAL FIRM WITH AT LEAST FIVE (5) DOCUMENTED LEAKING UNDERGROUND STORAGE TANKS (LUST) CLEANUPS OR THAT IS PRE-QUALIFIED IN HAZARDOUS WASTE BY THE DEPARTMENT TO REMEDIATE THE SOIL CONTAMINATION AND MONITOR FOR WORKER PROTECTION.

UTILITY CONTACTS

TELEPHONE #

UTILITY CONTACTS		TELEPHONE #
JOINT UTILITY LOCATION INFORMATION FOR CONTRACTORS (JULIE)		(800) 892-0123
COMED	JOE STACHO	(630) 424-5704
COMCAST	MARTHA GIERAS	(630) 600-6352
NICOR GAS	CONNIE LANE	(630) 388-3830
VILLAGE OF VILLA PARK	VYDAS JUSKELIS	(630) 834-8505
AT&T/DISTRIBUTION	TOM FOLLIN	(630) 573-6477

FILE NAME =	USER NAME #USER#	DESIGNED DA/SC	REVISED 10/24/2011	STATE OF ILLINOIS DEPARTMENT OF TRANSPORTATION	INDEX OF SHEETS, LIST OF ILLINOIS D.O.T. HIGHWAY STANDARDS GENERAL NOTES AND COMMITMENTS, SUMMARY OF QUANTITIES	F.A.P. RTE.	SECTION	COUNTY	TOTAL SHEETS	SHEET NO.	
#FILE#		DRAWN BM/CC/BB	REVISED 01/03/2012 ADDENDUM A			347	02-00077-00-SW	DUPAGE	73	2	
		CHECKED DA	REVISED			CONTRACT NO. 63197					
		DATE 06/08/2011	REVISED			FED. ROAD DIST. NO. ILLINOIS FED. AID PROJECT					

EXISTING LEGEND:

- CURB
- - - GUTTER
- CENTER LINE OF ROADWAY
- EDGE OF PAVEMENT
- RIGHT OF WAY
- LIGHT POLE
- POWER POLE
- T.S LIGHT POLE
- CATCH BASIN
- S.S MANHOLE
- MANHOLE
- SIGN

- GAS M.H
- T.S H.H
- INLET
- FIRE HYDRANT
- T.S CONTROLLER BOX
- T.S DOUBLE HAND HOLE
- EXISTING TREE
- MAIL BOX
- SHURBS
- CONCRETE WALK

LEGEND ITEM TO BE REMOVED

- ▨ DRIVEWAY PAVEMENT REMOVAL
- ▨ COMBINATION CONCRETE CURB&GUTTER
- ▨ EXCAVATION FOR SIDEWALK

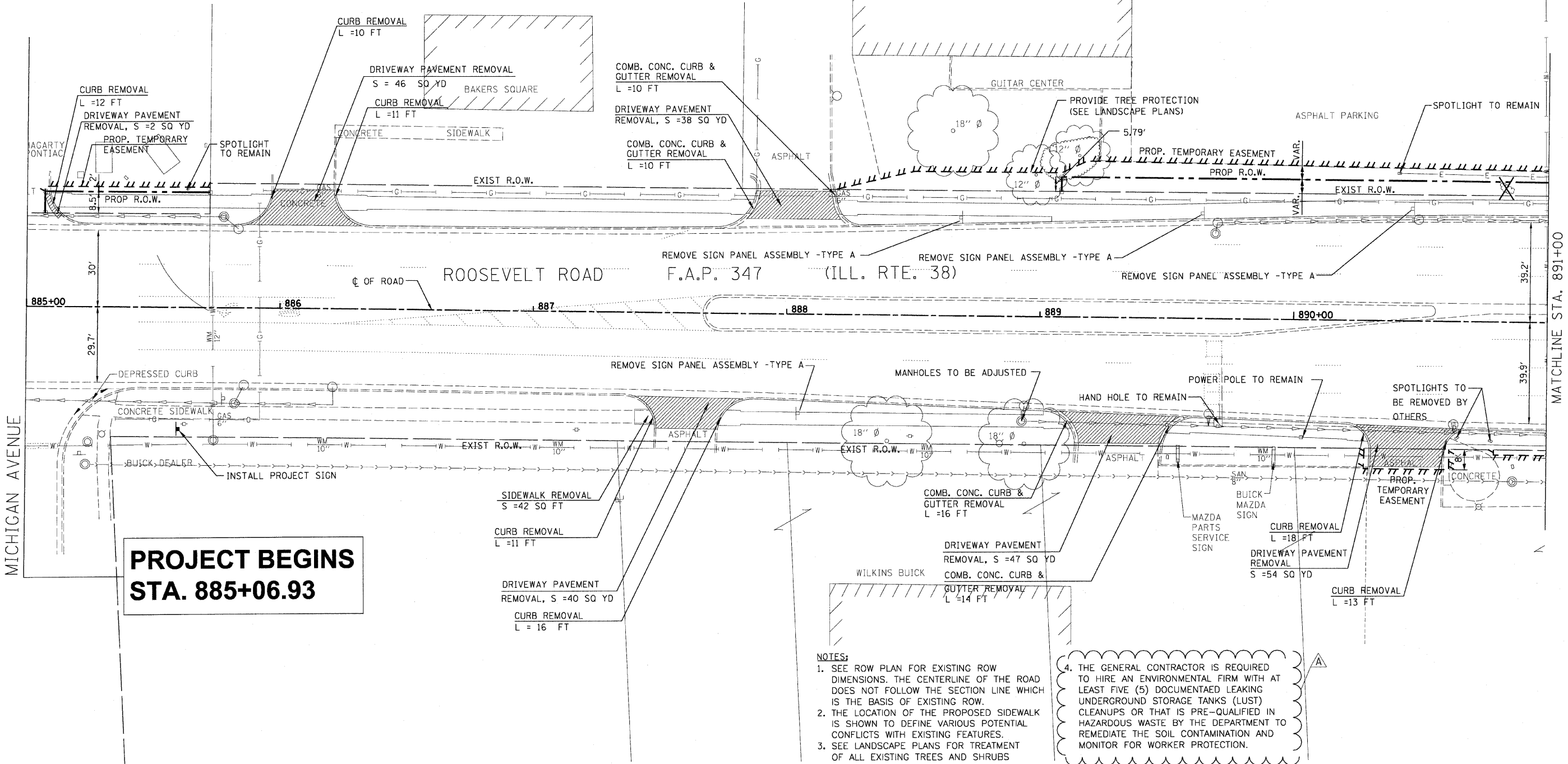

MICHIGAN AVENUE

MATCHLINE STA. 891+00

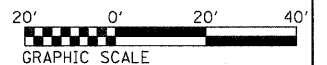

FILE NAME = #FILE#	USER NAME = #USER#	DESIGNED DA/SC	REVISED 10/24/2011	STATE OF ILLINOIS DEPARTMENT OF TRANSPORTATION	REMOVAL PLAN FROM STA 885+06.93 TO STA 891+00				F.A.P. RTE. 347	SECTION 02-00077-00-SW	COUNTY	TOTAL SHEETS 73	SHEET NO. 11
	PLOT SCALE = #SCALE#	DRAWN BM/CC/BB	REVISED 01/03/2012 ADDENDUM A		SCALE: AS SHOWN	SHEET NO. 1 OF 4 SHEETS	STA. 885+07 TO STA. 891+00	DUPAGE	CONTRACT NO. 63197		FED. ROAD DIST. NO. ILLINOIS FED. AID PROJECT		
	PLOT DATE = #DATE#	CHECKED DA	REVISED										
		DATE 06/08/2011	REVISED										

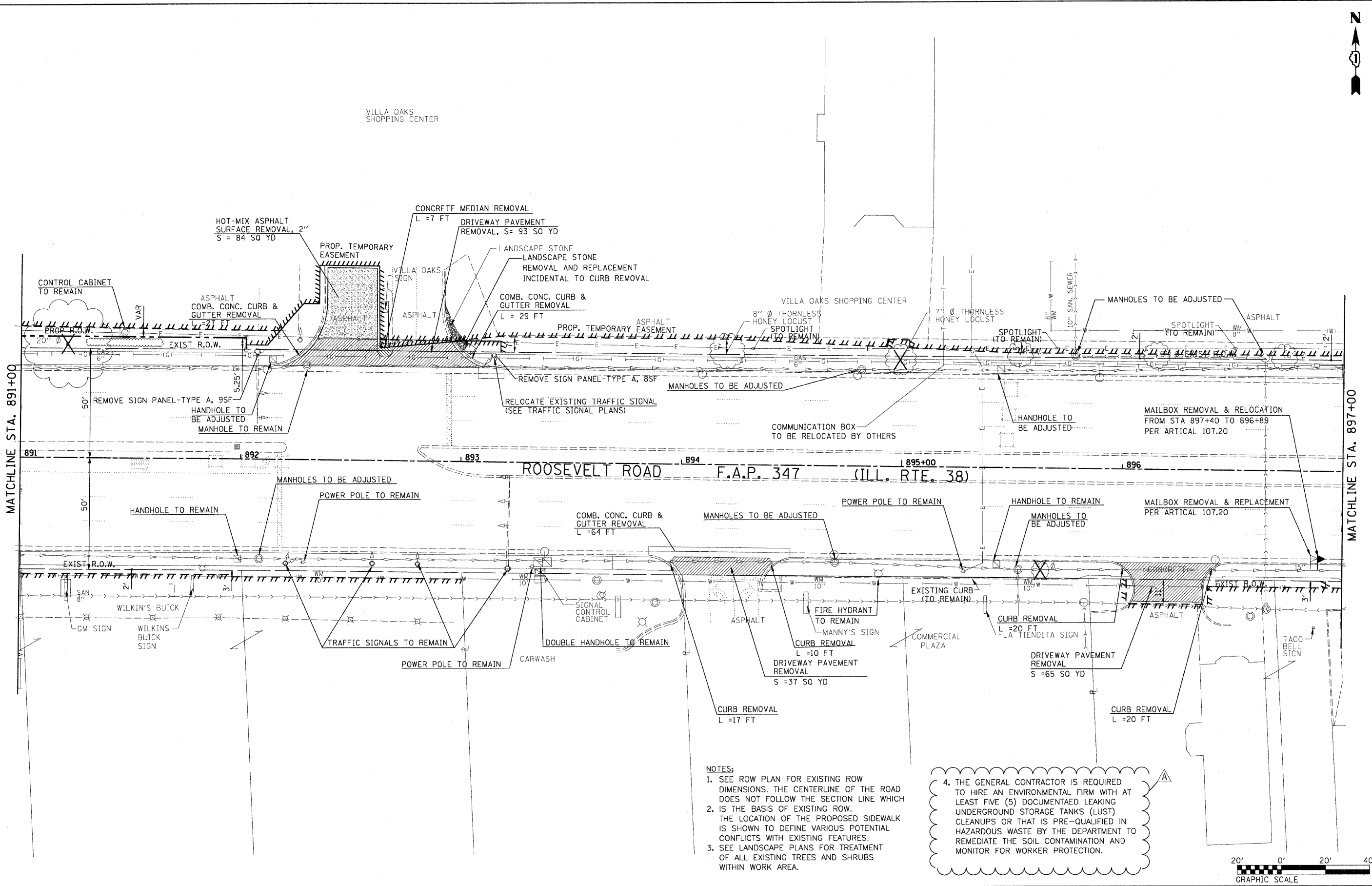

- NOTES:**
1. SEE ROW PLAN FOR EXISTING ROW DIMENSIONS. THE CENTERLINE OF THE ROAD DOES NOT FOLLOW THE SECTION LINE WHICH IS THE BASIS OF EXISTING ROW. THE LOCATION OF THE PROPOSED SIDEWALK IS SHOWN TO DEFINE VARIOUS POTENTIAL CONFLICTS WITH EXISTING FEATURES.
 2. SEE LANDSCAPE PLANS FOR TREATMENT OF ALL EXISTING TREES AND SHRUBS WITHIN WORK AREA.
 3. SEE LANDSCAPE PLANS FOR TREATMENT OF ALL EXISTING TREES AND SHRUBS WITHIN WORK AREA.
 4. THE GENERAL CONTRACTOR IS REQUIRED TO HIRE AN ENVIRONMENTAL FIRM WITH AT LEAST FIVE (5) DOCUMENTAED LEAKING UNDERGROUND STORAGE TANKS (LUST) CLEANUPS OR THAT IS PRE-QUALIFIED IN HAZARDOUS WASTE BY THE DEPARTMENT TO REMEDIATE THE SOIL CONTAMINATION AND MONITOR FOR WORKER PROTECTION.

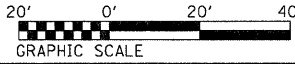

FILE NAME =	USER NAME #USER#	DESIGNED DA/SC	REVISED 10/24/2011	STATE OF ILLINOIS DEPARTMENT OF TRANSPORTATION	REMOVAL PLAN FROM STA 891+00 TO STA 897+00			F.A.P. RTE. 347	SECTION 02-00077-00-SW	COUNTY DUPAGE	TOTAL SHEETS 73	SHEET NO. 12
#FILE#	PLOT SCALE #SCALE#	CHECKED DA	REVISED 01/03/2012 ADDENDUM A		SCALE: AS SHOWN	SHEET NO. 2 OF 4 SHEETS	STA. 891+00 TO STA. 897+00	CONTRACT NO. 63197				
	PLOT DATE #DATE#	DATE 06/08/2011	REVISED		FED. ROAD DIST. NO. ILLINOIS FED. AID PROJECT							

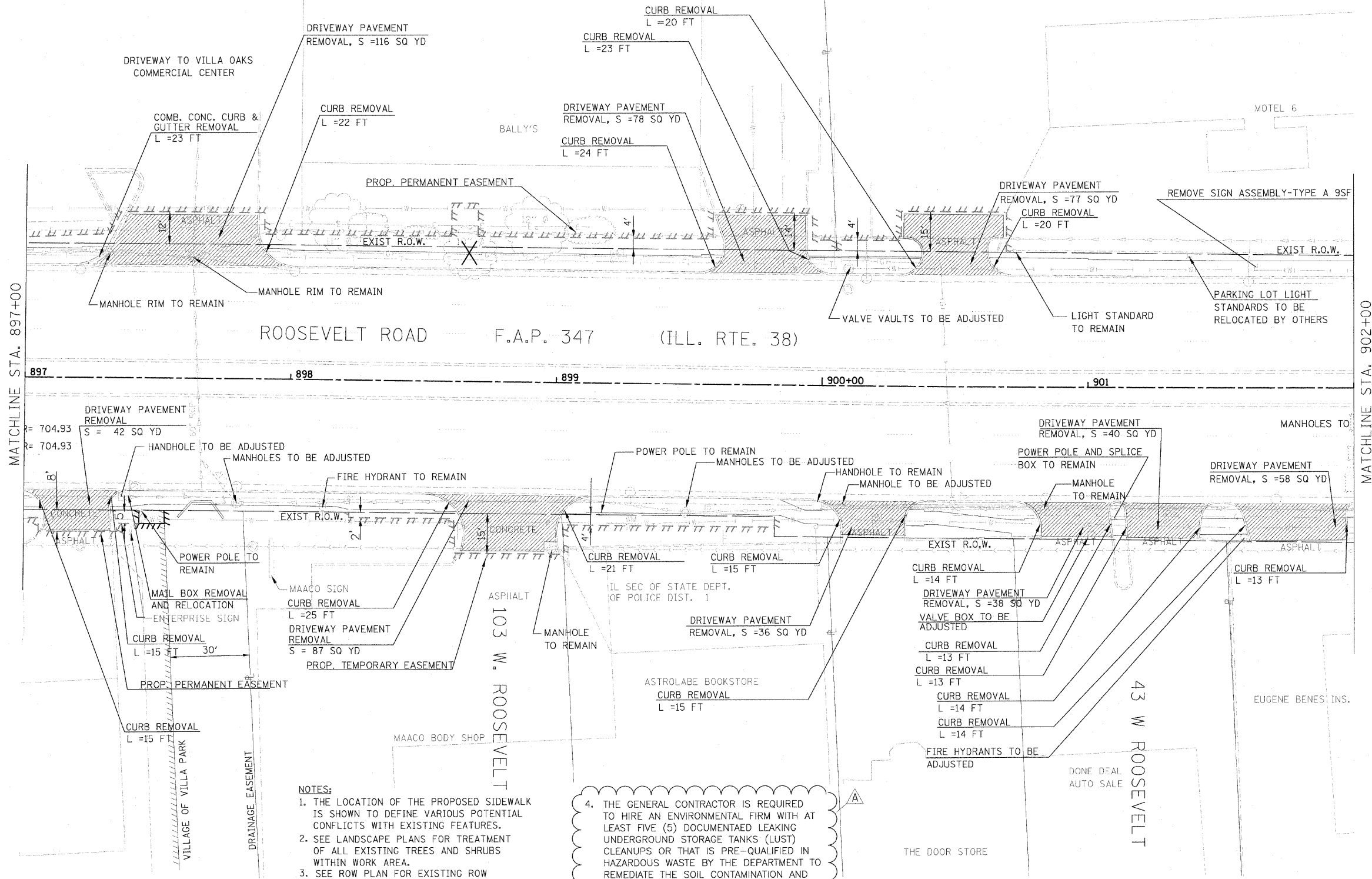

- NOTES:**
1. THE LOCATION OF THE PROPOSED SIDEWALK IS SHOWN TO DEFINE VARIOUS POTENTIAL CONFLICTS WITH EXISTING FEATURES.
 2. SEE LANDSCAPE PLANS FOR TREATMENT OF ALL EXISTING TREES AND SHRUBS WITHIN WORK AREA.
 3. SEE ROW PLAN FOR EXISTING ROW DIMENSIONS. THE CENTERLINE OF THE ROAD DOES NOT FOLLOW THE SECTION LINE WHICH IS THE BASIS OF EXISTING ROW.

4. THE GENERAL CONTRACTOR IS REQUIRED TO HIRE AN ENVIRONMENTAL FIRM WITH AT LEAST FIVE (5) DOCUMENTED LEAKING UNDERGROUND STORAGE TANKS (LUST) CLEANUPS OR THAT IS PRE-QUALIFIED TO HAZARDOUS WASTE BY THE DEPARTMENT TO REMEDIATE THE SOIL CONTAMINATION AND MONITOR FOR WORKER PROTECTION.

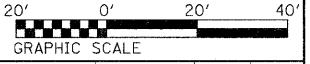

FILE NAME = M:\VILLAPARK\Roosevelt-Rd-Sidewalk\CIVIL	USER NAME = bom	DESIGNED DA/SC	REVISED 10/24/2011	STATE OF ILLINOIS DEPARTMENT OF TRANSPORTATION	REMOVAL PLAN STA 897+00 TO STA 902+00			F.A.P. RTE. 347	SECTION 02-00077-00-SW	COUNTY DUPAGE	TOTAL SHEETS 73	SHEET NO. 13
	CADD Sheets\0163197-shr-rem03.dgn	DRAWN BM/CC/BB	REVISED 01/03/2012 ADDENDUM A		SCALE: AS SHOWN	SHEET NO. 3 OF 4 SHEETS	STA. 897+00 TO STA. 902+00	FED. ROAD DIST. NO.	ILLINOIS FED. AID PROJECT	CONTRACT NO. 63197		
	PLOT SCALE 20,0000' / in.	CHECKED DA	REVISED									
	PLOT DATE 1/4/2012	DATE 06/08/2011	REVISED									

MATCHLINE STA. 902+00

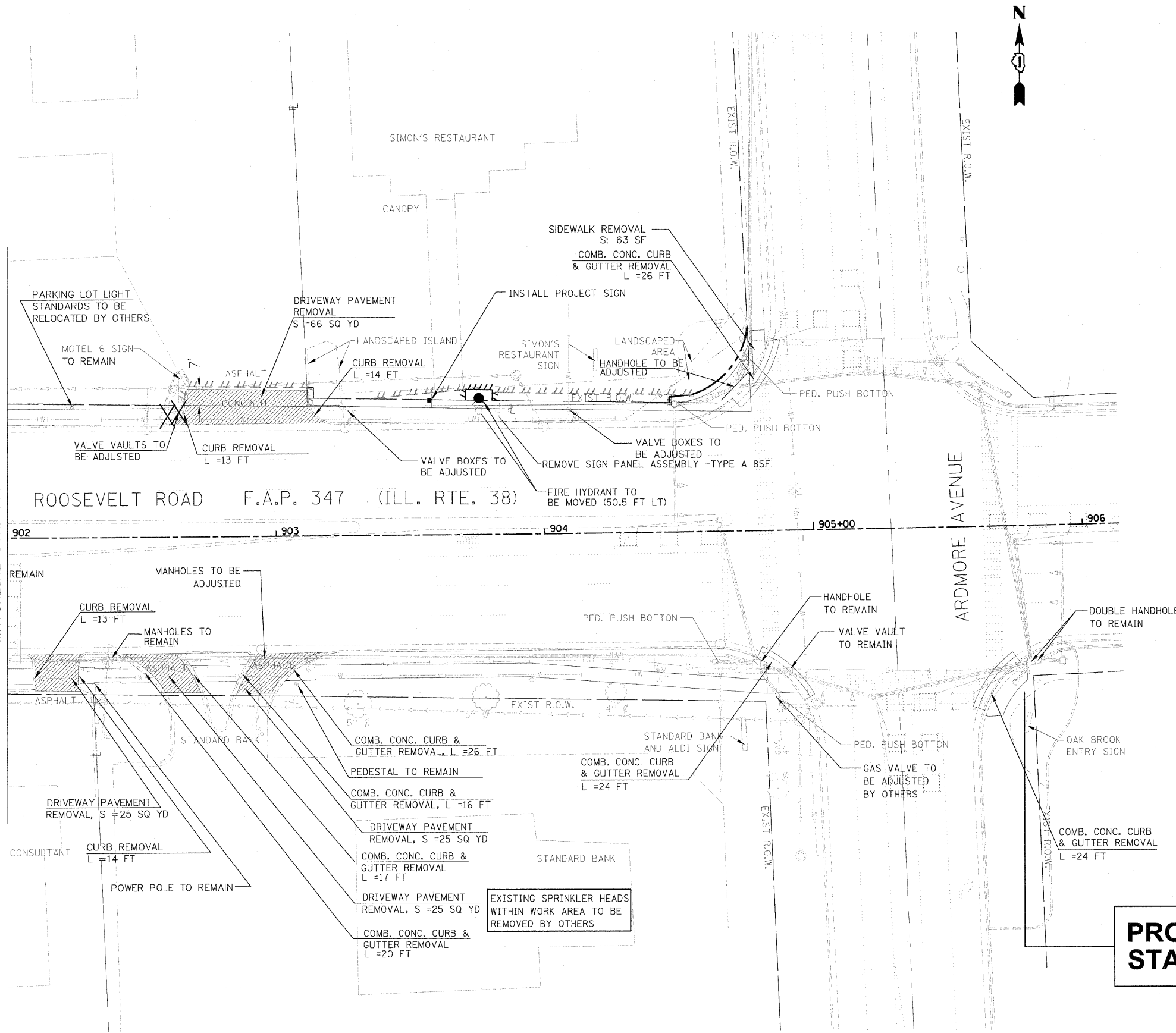

**PROJECT ENDS
STA. 905+78.26**

- NOTES:**
1. THE LOCATION OF THE PROPOSED SIDEWALK IS SHOWN TO DEFINE VARIOUS POTENTIAL CONFLICTS WITH EXISTING FEATURES.
 2. SEE LANDSCAPE PLANS FOR TREATMENT OF ALL EXISTING TREES AND SHRUBS WITHIN WORK AREA.
 3. SEE ROW PLAN FOR EXISTING ROW DIMENSIONS. THE CENTERLINE OF THE ROAD DOES NOT FOLLOW THE SECTION LINE WHICH IS THE BASIS OF EXISTING ROW.
 4. THE GENERAL CONTRACTOR IS REQUIRED TO HIRE AN ENVIRONMENTAL FIRM WITH AT LEAST FIVE (5) DOCUMENTAED LEAKING UNDERGROUND STORAGE TANKS (LUST) CLEANUPS OR THAT IS PRE-QUALIFIED IN HAZARDOUS WASTE BY THE DEPARTMENT TO REMEDIATE THE SOIL CONTAMINATION AND MONITOR FOR WORKER PROTECTION.

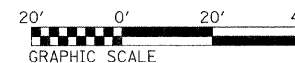

FILE NAME =	USER NAME #USER#	DESIGNED DA/SC	REVISED 10/24/2011
#FILE#		DRAWN BM/CC/BB	REVISED 01/03/2012 ADDENDUM A
	PLOT SCALE #SCALE#	CHECKED DA	REVISED
	PLOT DATE #DATE#	DATE 06/08/2011	REVISED

**STATE OF ILLINOIS
DEPARTMENT OF TRANSPORTATION**

REMOVAL PLAN		
STA 902+00 TO STA 905+78.26		
SCALE: AS SHOWN	SHEET NO. 4 OF 4 SHEETS	STA. 902+00 TO STA. 904+99

F.A.P. RTE.	SECTION	COUNTY	TOTAL SHEETS	SHEET NO.
347	02-00077-00-SW	DUPAGE	73	14
CONTRACT NO. 63197				
FED. ROAD DIST. NO. ILLINOIS FED. AID PROJECT				



EXISTING LEGEND:

- CURB
- GUTTER
- CENTER LINE OF ROADWAY
- EDGE OF PAVEMENT
- RIGHT OF WAY
- LIGHT POLE
- POWER POLE
- T.S LIGHT POLE
- CATCH BASIN
- S.S MANHOLE
- SIGN
- MANHOLE
- T.S H.H
- GAS M.H
- INLET
- FIRE HYDRANT
- T.S CONTROLLER BOX
- T.S DOUBLE HAND HOLE
- EXISTING TREE
- MAIL BOX
- SHURBS

PROPOSED LEGEND:

- [Pattern] H.M.A. DRIVEWAY PAVEMENT
- [Pattern] PCC DRIVEWAY PAVEMENT, 8"
- [Pattern] PCC SIDEWALK PAVEMENT, 8"
- [Pattern] PCC SIDEWALK, 5"
- [Pattern] PCC SIDEWALK, SPECIAL
- [Pattern] PCC SIDEWALK, SPECIAL, WITH RETAINING WALL
- [Pattern] DETECTABLE WARNING
- [Pattern] STONE RIPRAP
- [Pattern] COMBINATION CONC. C&G, TYPE B6,12
- [Pattern] CONC. CURB TYPE B6.0
- [Pattern] RETAINING WALL
- PROPOSED R.O.W.
- PROPOSED TEMPORARY EASEMENT
- EXISTING EASEMENT
- PROPOSED PERMANENT EASEMENT
- PROPOSED / RELOCATE SIGN

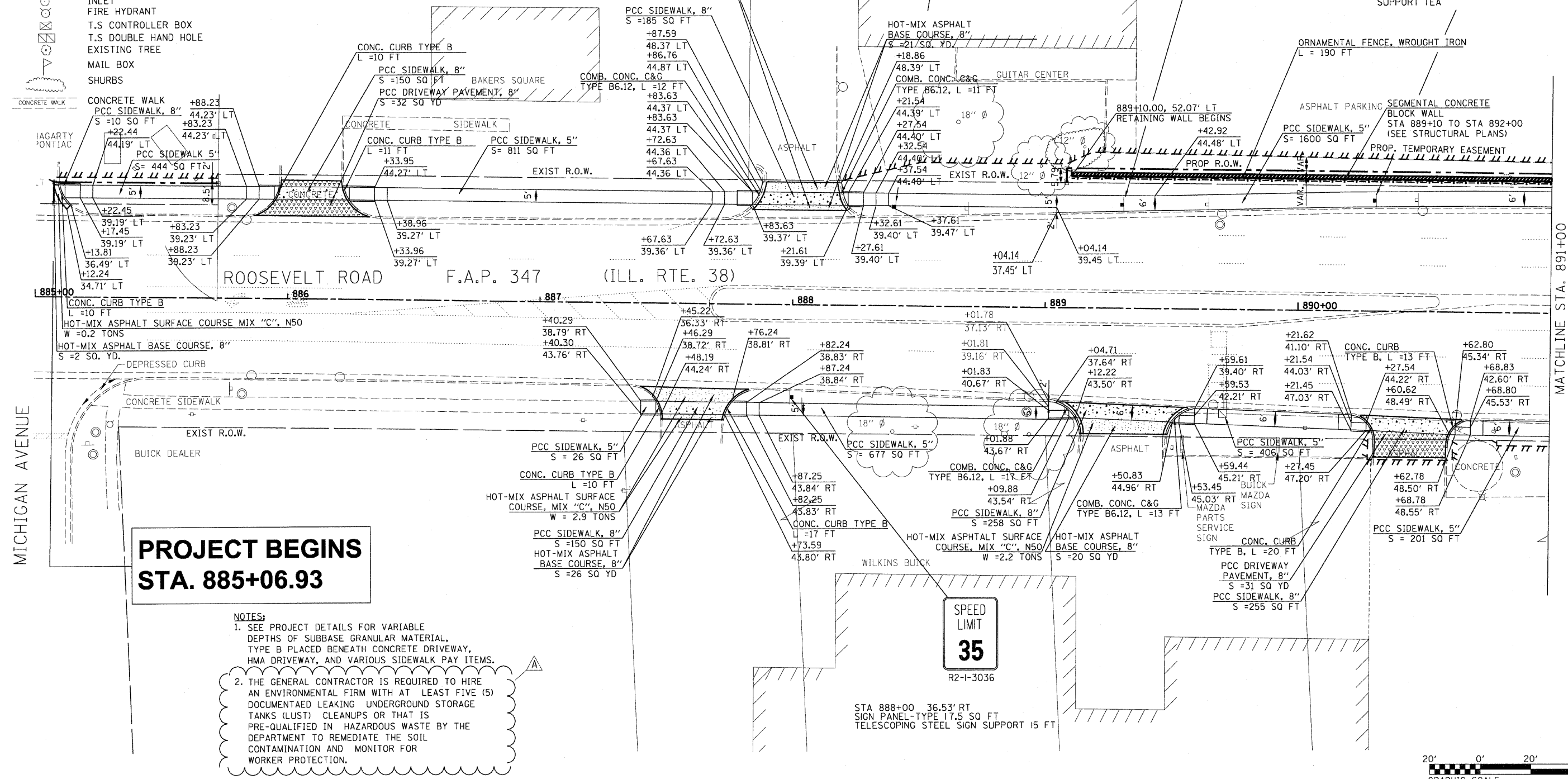

**PROJECT BEGINS
STA. 885+06.93**

NOTES:

1. SEE PROJECT DETAILS FOR VARIABLE DEPTHS OF SUBBASE GRANULAR MATERIAL, TYPE B PLACED BENEATH CONCRETE DRIVEWAY, HMA DRIVEWAY, AND VARIOUS SIDEWALK PAY ITEMS.
2. THE GENERAL CONTRACTOR IS REQUIRED TO HIRE AN ENVIRONMENTAL FIRM WITH AT LEAST FIVE (5) DOCUMENTAED LEAKING UNDERGROUND STORAGE TANKS (LUST) CLEANUPS OR THAT IS PRE-QUALIFIED IN HAZARDOUS WASTE BY THE DEPARTMENT TO REMEDIATE THE SOIL CONTAMINATION AND MONITOR FOR WORKER PROTECTION.

FILE NAME =	USER NAME = #USER#	DESIGNED DA/SC	REVISED 10/24/2011	STATE OF ILLINOIS DEPARTMENT OF TRANSPORTATION	PROPOSED PLAN FROM STA. 885+06.93 TO STA. 891+00	F.A.P. RTE.	SECTION	COUNTY	TOTAL SHEETS	SHEET NO.
#FILE#		DRAWN BM/CC/BB	REVISED 01/03/2012 ADDENDUM A			347	02-00077-00-SW	DUPAGE	73	15
PLOT SCALE = #SCALE#		CHECKED DA	REVISED			CONTRACT NO. 63197				
PLOT DATE = #DATE#		DATE 06/08/2011	REVISED			SCALE: AS SHOWN SHEET NO. 1 OF 4 SHEETS STA. 885+07 TO STA. 891+00			FED. ROAD DIST. NO. ILLINOIS/FED. AID PROJECT	

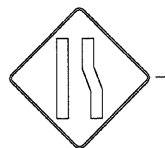
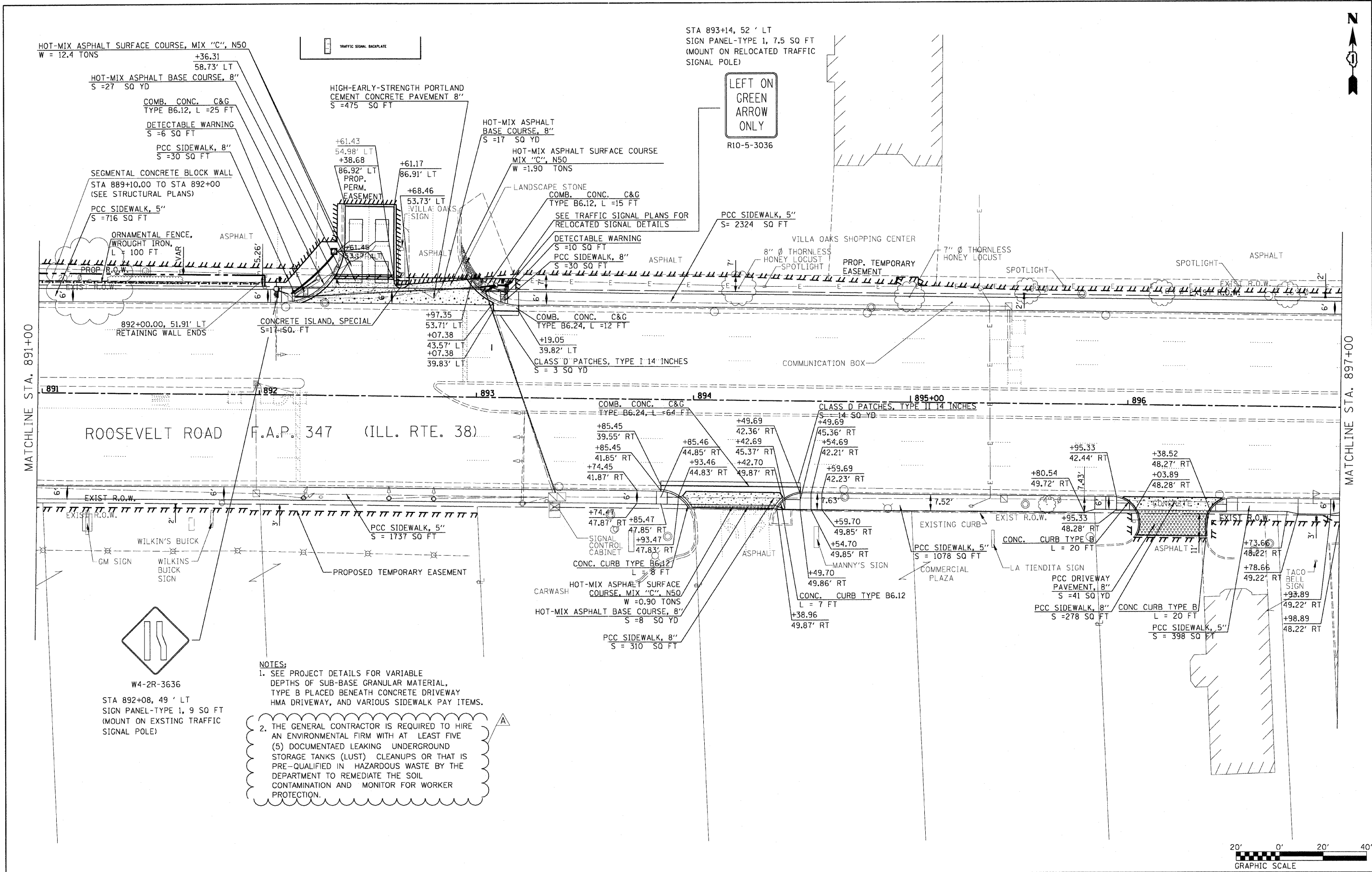

W4-2R-3636
STA 892+08, 49' LT
SIGN PANEL-TYPE 1, 9 SQ FT
(MOUNT ON EXISTING TRAFFIC SIGNAL POLE)

NOTES:
1. SEE PROJECT DETAILS FOR VARIABLE DEPTHS OF SUB-BASE GRANULAR MATERIAL, TYPE B PLACED BENEATH CONCRETE DRIVEWAY HMA DRIVEWAY, AND VARIOUS SIDEWALK PAY ITEMS.
2. THE GENERAL CONTRACTOR IS REQUIRED TO HIRE AN ENVIRONMENTAL FIRM WITH AT LEAST FIVE (5) DOCUMENTAED LEAKING UNDERGROUND STORAGE TANKS (LUST) CLEANUPS OR THAT IS PRE-QUALIFIED IN HAZARDOUS WASTE BY THE DEPARTMENT TO REMEDIATE THE SOIL CONTAMINATION AND MONITOR FOR WORKER PROTECTION.



R10-5-3036

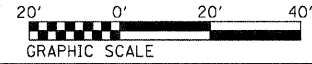

FILE NAME =	USER NAME = *USER*	DESIGNED DA/SC	REVISED 10/24/2011	STATE OF ILLINOIS DEPARTMENT OF TRANSPORTATION	PROPOSED PLAN FROM STA. 891+00 TO STA. 897+00			F.A.P. RTE. 347	SECTION 02-00077-00-SW	COUNTY DUPAGE	TOTAL SHEETS 73	SHEET NO. 16
*FILE#	PLOT SCALE = *SCALE*	DRAWN BM/CC/BB	REVISED 01/03/2012 ADDENDUM A		SCALE: AS SHOWN	SHEET NO. 2 OF 4 SHEETS	STA. 891+00 TO STA. 897+00	CONTRACT NO. 63197				
	PLOT DATE = *DATE*	CHECKED DA	REVISED									
		DATE 06/08/2011	REVISED									
								FED. ROAD DIST. NO. ILLINOIS FED. AID PROJECT				



PIPE HANDRAIL AT CULVERT CROSSING

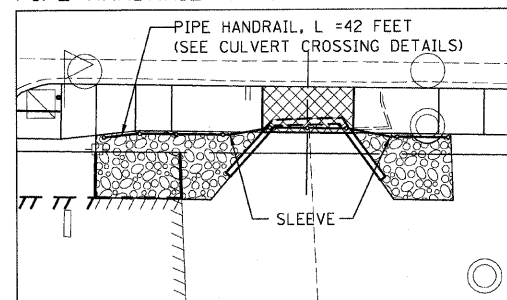

SCALE: 1"=10'

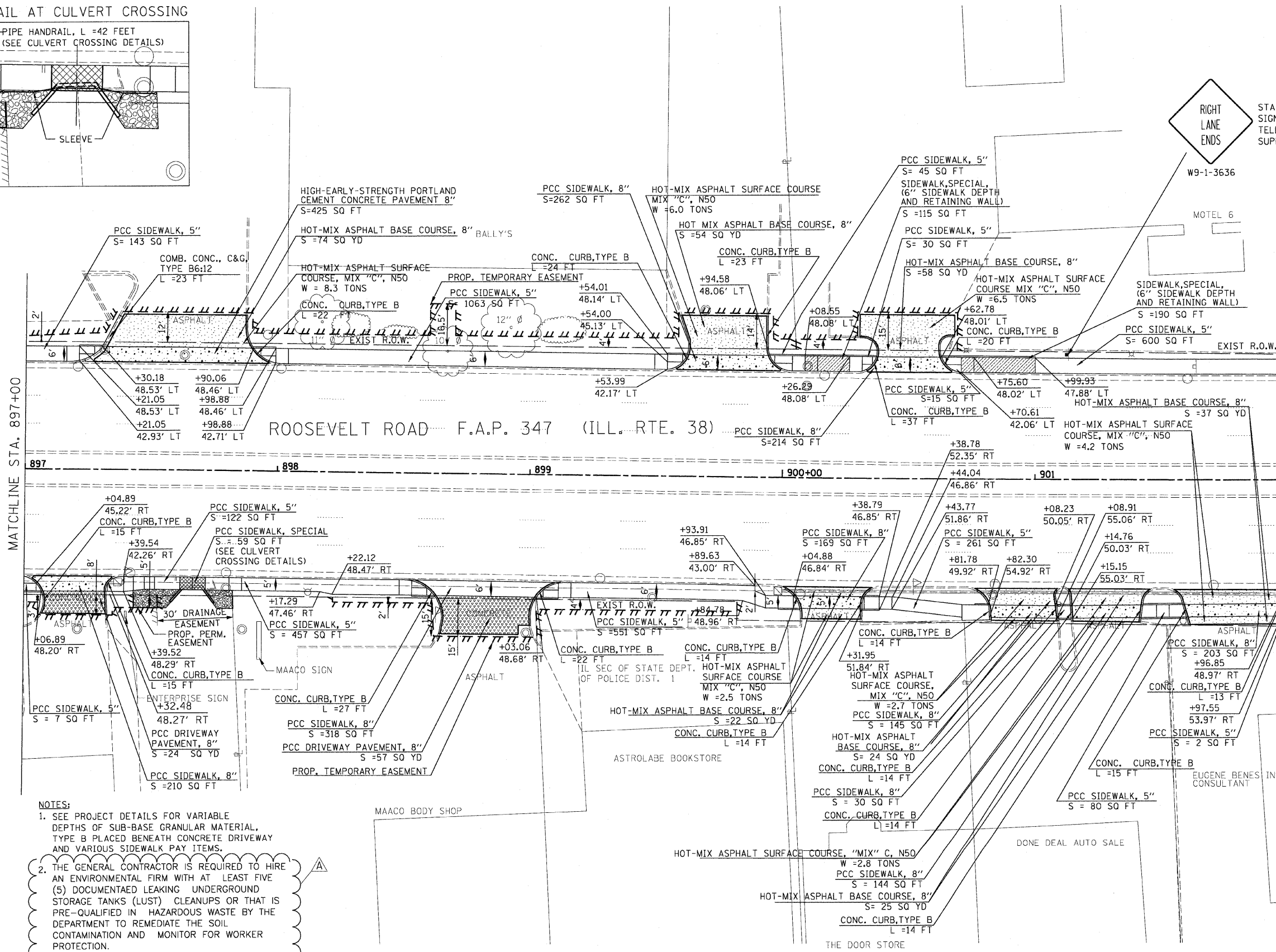

STA 901+13, 48.5' LT
SIGN PANEL-TYPE 1, 9' 50 FT
TELESCOPING STEEL SIGN
SUPPORT, 16 FT

MATCHLINE STA. 897+00

MATCHLINE STA. 902+00

- NOTES:**
- SEE PROJECT DETAILS FOR VARIABLE DEPTHS OF SUB-BASE GRANULAR MATERIAL. TYPE B PLACED BENEATH CONCRETE DRIVEWAY AND VARIOUS SIDEWALK PAY ITEMS.
 - THE GENERAL CONTRACTOR IS REQUIRED TO HIRE AN ENVIRONMENTAL FIRM WITH AT LEAST FIVE (5) DOCUMENTAED LEAKING UNDERGROUND STORAGE TANKS (LUST) CLEANUPS OR THAT IS PRE-QUALIFIED IN HAZARDOUS WASTE BY THE DEPARTMENT TO REMEDIATE THE SOIL CONTAMINATION AND MONITOR FOR WORKER PROTECTION.

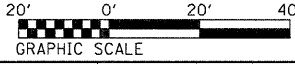

FILE NAME =	USER NAME #USER#	DESIGNED DA/SC	REVISED 10/24/2011	STATE OF ILLINOIS DEPARTMENT OF TRANSPORTATION	PROPOSED PLAN FROM STA. 897+00 TO STA. 902+00	F.A.P. RTE. 347	SECTION 02-00077-00-SW	COUNTY DUPAGE	TOTAL SHEETS 73	SHEET NO. 17		
#FILE#	PLOT SCALE #SCALE#	DRAWN BM/CC/BB	REVISED 01/03/2012 ADDENDUM A			SCALE: AS SHOWN	SHEET NO. 3 OF 4 SHEETS	STA. 897+00 TO STA. 902+00	FED. ROAD DIST. NO. ILLINOIS FED. AID PROJECT	CONTRACT NO. 63197		
	PLOT DATE #DATE#	CHECKED DA	REVISED									
		DATE 06/08/2011	REVISED									



STA 903+47 48.40 'LT
SIGN PANEL-TYPE I, 7.5 SQ FT
TELESCOPING STEEL
SIGN SUPPORT, 15FT

SPEED
LIMIT
35
R2-I-3036

NOTE:

- SEE PROJECT DETAIL SHEETS FOR VARIABLE DEPTHS OF SUBBASE GRANULAR MATERIAL, TYPE B PLACED BENEATH CONCRETE DRIVEWAY, HMA DRIVEWAY AND VARIOUS SIDEWALK PAY ITEMS.
- THE GENERAL CONTRACTOR IS REQUIRED TO HIRE AN ENVIRONMENTAL FIRM WITH AT LEAST FIVE (5) DOCUMENTAED LEAKING UNDERGROUND STORAGE TANKS (LUST) CLEANUPS OR THAT IS PRE-QUALIFIED IN HAZARDOUS WASTE BY THE DEPARTMENT TO REMEDIATE THE SOIL CONTAMINATION AND MONITOR FOR WORKER PROTECTION.

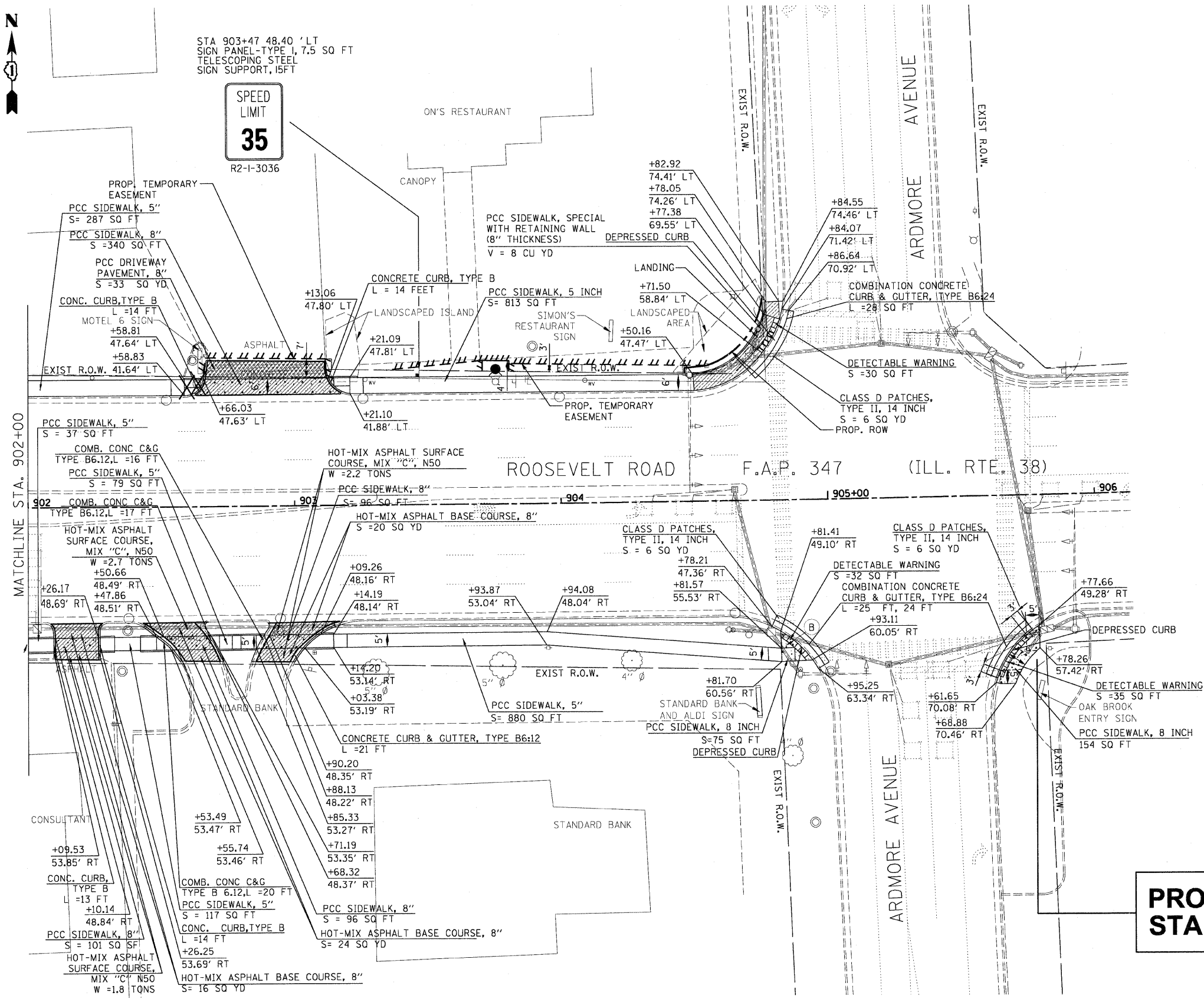

**PROJECT ENDS
STA. 905+78.26**

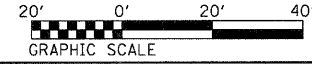

FILE NAME =	USER NAME #USER#	DESIGNED DA/SC	REVISED 10/24/2011	STATE OF ILLINOIS DEPARTMENT OF TRANSPORTATION	PROPOSED PLAN FROM STA. 902+00 TO STA. 904+99.36	F.A.P. RTE. 347	SECTION 02-00077-00-SW	COUNTY	TOTAL SHEETS 73	SHEET NO. 18	
#FILE#	PLOT SCALE #SCALE#	CHECKED DA	REVISED 01/03/2012 ADDENDUM A			SCALE: AS SHOWN	SHEET NO. 4 OF 4 SHEETS	STA. 902+00 TO STA. 904+99.36	CONTRACT NO. 63197		
	PLOT DATE #DATE#	DATE 06/08/2011	REVISED			FED. ROAD DIST. NO.			ILLINOIS FED. AID PROJECT		

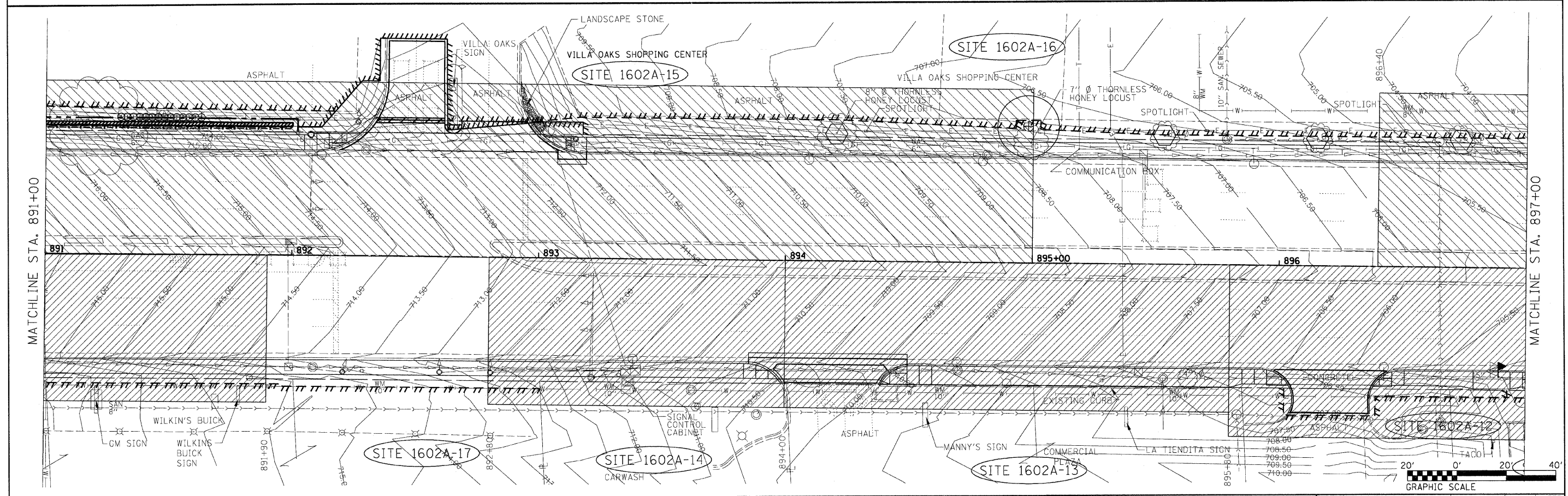
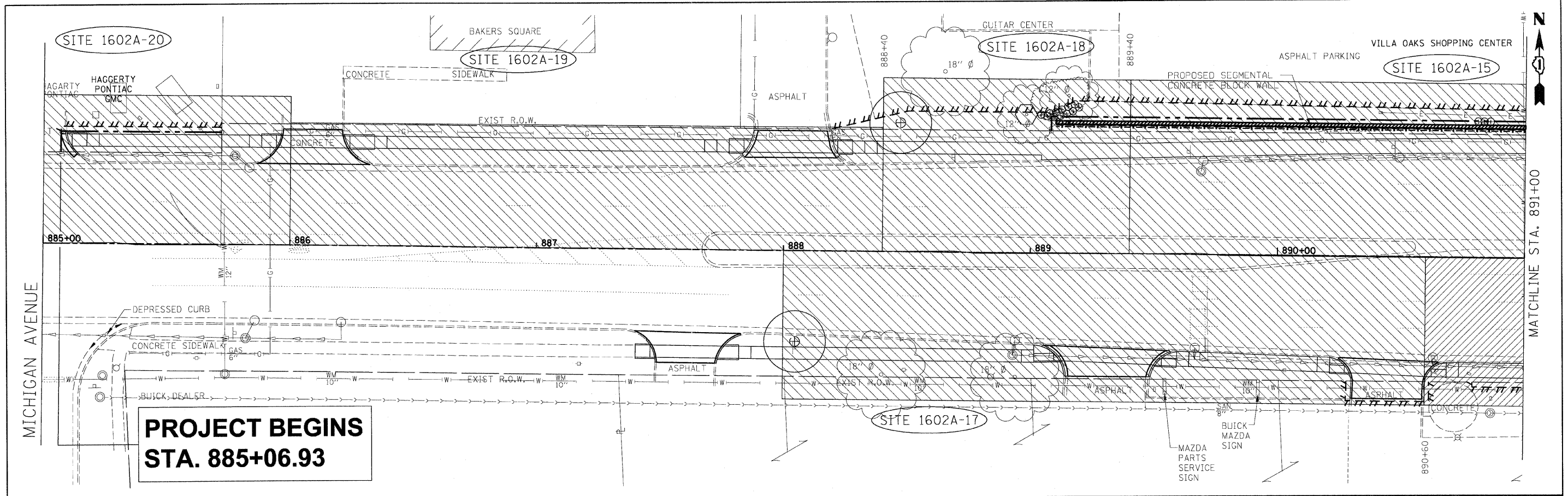

FILE NAME = #FILE#	USER NAME = #USER#	DESIGNED DA/SC	REVISED 10/24/2011	STATE OF ILLINOIS DEPARTMENT OF TRANSPORTATION	REGULATED SUBSTANCE REMOVAL PLAN FROM STA 885+06.93 TO STA 897+00	F.A.P. RTE. 347	SECTION 02-00077-00-SW	COUNTY	TOTAL SHEETS 73	SHEET NO. 26	
	PLOT SCALE = #SCALE#	DRAWN BM/CC/BB	REVISED 01/03/2012 ADDENDUM A			CONTRACT NO. 63197					
	PLOT DATE = #DATE#	CHECKED DA	REVISED			SCALE: AS SHOWN SHEET NO. 1 OF 2 SHEETS STA. 885+07 TO STA. 897+00					
		DATE 06/08/2011	REVISED			FED. ROAD DIST. NO. ILLINOIS FED. AID PROJECT					

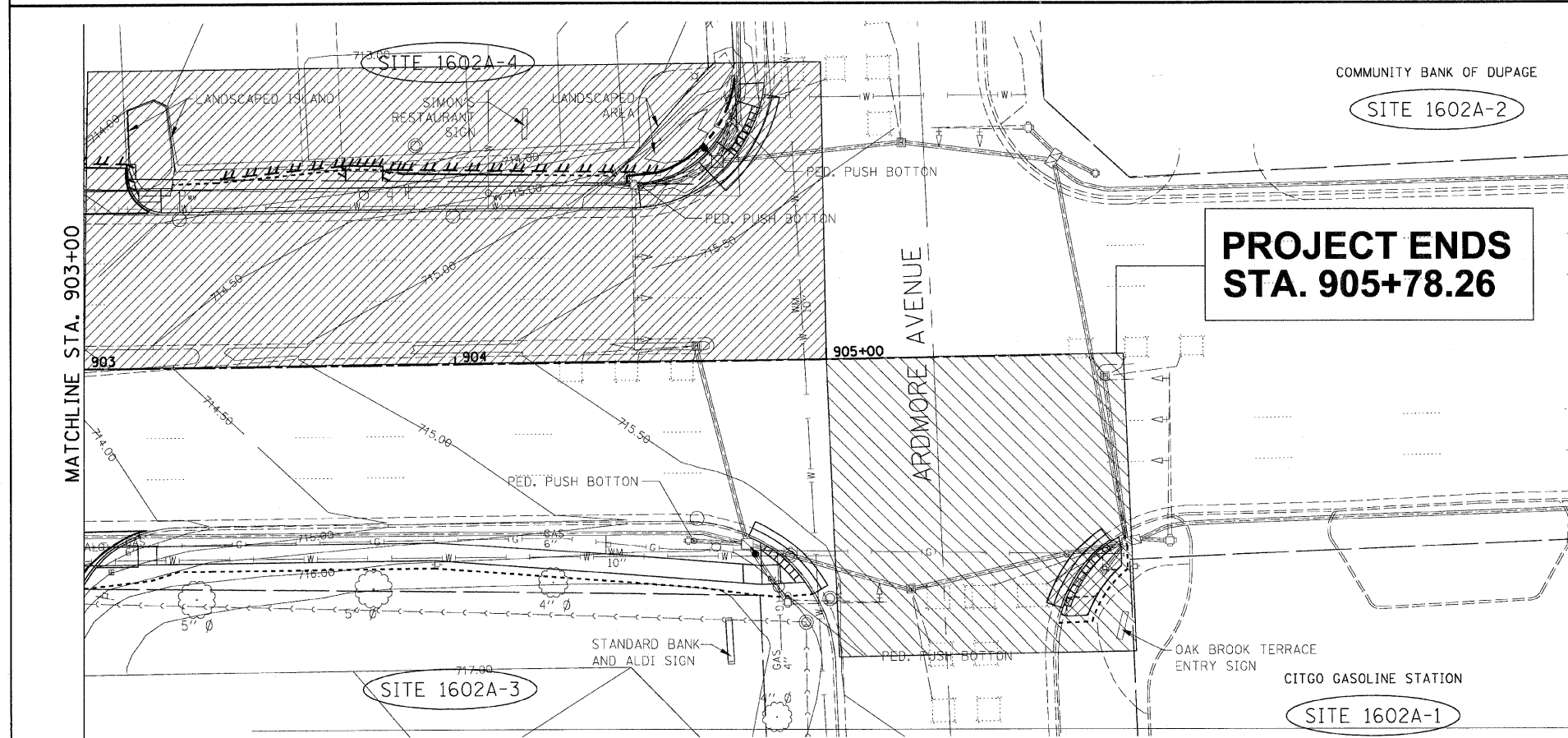
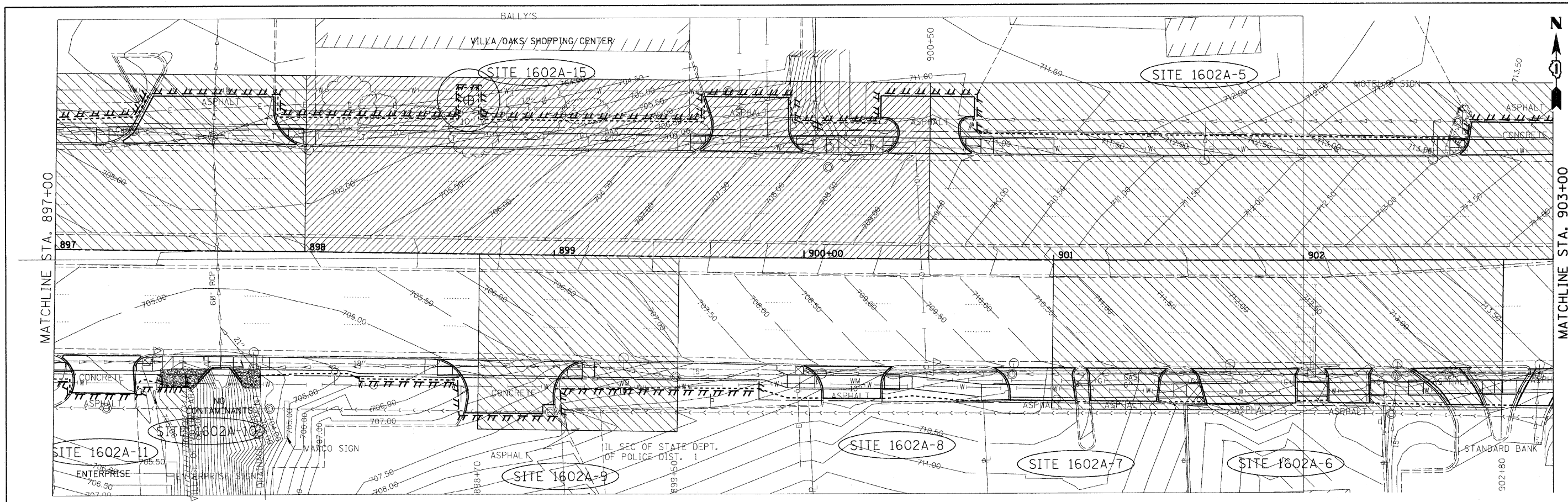

SCHEDULE OF QUANTITIES

ITEM NO	ITEM	UNIT	QUANTITY
66900200	NON-SPECIAL WASTE DISPOSAL	CU YD	1600
66900450	SPECIAL WASTE PLANS AND REPORT	LSUM	1
66900530	SOIL DISPOSAL ANALYSIS	EACH	8

LEGEND

- CATEGORY A - NON-SPECIAL WASTE MANAGEMENT AREAS REQUIRING OFF-SITE DISPOSAL.
- CATEGORY B - NON-SPECIAL WASTE MANAGEMENT AREAS REQUIRING OFF-SITE DISPOSAL UNLESS USED AS ON-SITE FILL.

NOTES

1. SEE SPECIAL PROVISION FOR REMOVAL AND DISPOSAL OF REGULATED SUBSTANCES CONCERNING CATEGORY "A" OR "B" NON-SPECIAL WASTE DESIGNATIONS.
2. THE GENERAL CONTRACTOR IS REQUIRED TO HIRE AN ENVIRONMENTAL FIRM WITH AT LEAST FIVE (5) DOCUMENTED LEAKING UNDERGROUND STORAGE TANK (LUST) CLEANUPS OR THAT IS PRE-QUALIFIED IN HAZARDOUS WASTE BY THE DEPARTMENT TO REMEDIATE THE SOIL CONTAMINATION AND MONITOR FOR WORKER PROTECTION.
3. THE PRELIMINARY SITE INVESTIGATION IS AVAILABLE UPON REQUEST FROM IDOT. CONTACT SAM MEADE @ (847) 705-4101
4. UPON APPROVAL OF THE ENGINEER, TO THE EXTENT FEASIBLE, SUITABLE NON-ORGANIC NON-SPECIAL WASTE SOILS SHOULD BE BURIED BEHIND THE SEGMENTAL CONCRETE BLOCK WALL IN-LIEU OR OFF-SITE DISPOSAL.

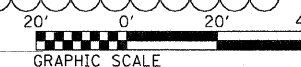

FILE NAME =	USER NAME = #USER#	DESIGNED DA/SC	REVISED 10/24/2011
#FILE#		DRAWN BM/CC/BB	REVISED 01/03/2012 ADDENDUM
	PLOT SCALE = #SCALE#	CHECKED DA	REVISED
	PLOT DATE = #DATE#	DATE 06/08/2011	REVISED

**STATE OF ILLINOIS
DEPARTMENT OF TRANSPORTATION**

**REGULATED SUBSTANCE REMOVAL PLAN
FROM STA 897+00 TO STA 905+78.26**

F.A.P. RTE.	SECTION	COUNTY	TOTAL SHEETS	SHEET NO.
347	02-00077-00-SW	DUPAGE	73	27
CONTRACT NO. 63197				
FED. ROAD DIST. NO. ILLINOIS FED. AID PROJECT				

SCALE: AS SHOWN SHEET NO. 2 OF 2 SHEETS STA. 897+00 TO STA. 904+99

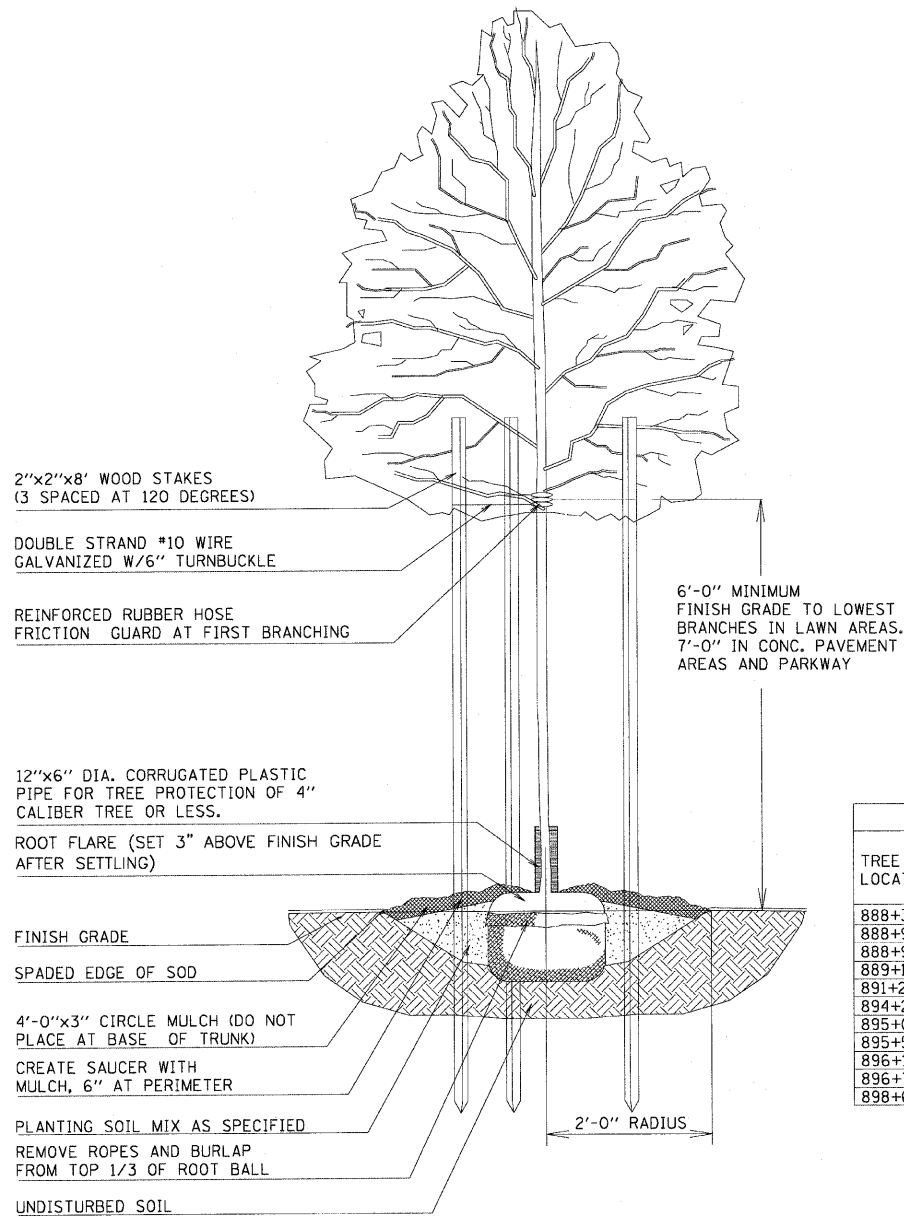

1 TREE PLANTING DETAIL
N.T.S.

PLANT SCHEDULE

PAY ITEM	QUANT.	KEY	BOTANICAL NAME	COMMON NAME	SIZE	STATION AND OFFSET		REMARKS
						FROM	TO	
SHADE TREES								
A2004620	1	GT	TREE, GLEDISTIA TRIACANTHOS INFIRMIS	THORNLESS COMMON HONEYLOCUST	2 1/2" CAL.	888+05, 36.6' RT		BALLED AND BURLAPPED
A2004620	1	GT	TREE, GLEDISTIA TRIACANTHOS INFIRMIS	THORNLESS COMMON HONEYLOCUST	2 1/2" CAL.	888+47, 52' LT		BALLED AND BURLAPPED
A2004620	1	GT	TREE, GLEDISTIA TRIACANTHOS INFIRMIS	THORNLESS COMMON HONEYLOCUST	2 1/2" CAL.	894+98, 55' LT		BALLED AND BURLAPPED
A2004620	1	GT	TREE, GLEDISTIA TRIACANTHOS INFIRMIS	THORNLESS COMMON HONEYLOCUST	2 1/2" CAL.	898+65, 61' LT		BALLED AND BURLAPPED
SHRUBS								
C2C05824	15	RA	SHRUB, RHUS AROMATICA GRO-L0	GRO-L0 FRAGRANT SUMAC, CONTAINER	2' WIDTH			3' O.C
C2011036	14	SP	SHRUB, SYRINGA PATULA MISS KIM	MISS KIM MANCHURIAN LILAC	3' HEIGHT			BALLED AND BURLAPPED, 2.5' O.C.

NOTE:
1. IN THE EVENT OF DISCREPANCY IN PLANT QUANTITY BETWEEN PLAN AND PLANT SCHEDULE, LARGER QUANTITY TO BE PROVIDED AND INSTALLED.

NOTE:
2. THE CONTRACTOR WILL NOT BE ALLOWED TO PROCEED WITH ANY PLANTING WORK UNTIL ALL UTILITY OWNERS FIELD LOCATE THEIR FACILITIES WHICH MAY INTERFERE WITH CONSTRUCTION OPERATIONS. THE ACTUAL LOCATIONS OF PROPOSED LANDSCAPING WILL BE ADJUSTED IN THE FIELD TO AVOID UNDERGROUND AND OVERHEAD UTILITIES.

• ALL PLANT MATERIAL SHALL BE SPECIMEN QUALITY
• ALL PLANT MATERIALS SHALL BE B & B
• LANDSCAPE ARCHITECT SHALL SELECT (TAG) ALL PLANT MATERIALS AT LOCAL NURSERIES

• SHRUBS ON A SINGLE STEM WILL NOT BE PERMITTED. ALL SHRUBS SHALL BE MULTI STEM, AND HEAVILY BRANCHED FROM THE ROOT BALL.

2. THE GENERAL CONTRACTOR IS REQUIRED TO HIRE AN ENVIRONMENTAL FIRM WITH AT LEAST FIVE (5) DOCUMENTAED LEAKING UNDERGROUND STORAGE TANKS (LUST) CLEANUPS OR THAT IS PRE-QUALIFIED IN HAZARDOUS WASTE BY THE DEPARTMENT TO REMEDIATE THE SOIL CONTAMINATION AND MONITOR FOR WORKER PROTECTION.

EXISTING LEGEND:

- CURB
- GUTTER
- CENTER LINE OF ROADWAY
- EDGE OF PAVEMENT
- RIGHT OF WAY
- ⊗ LIGHT POLE
- ⊕ POWER POLE
- ⊙ T.S LIGHT POLE
- ⊖ CATCH BASIN
- ⊘ S.S MANHOLE
- ⊙ SIGN
- ⊙ MANHOLE
- ⊙ T.S H.H
- ⊙ GAS M.H
- ⊙ INLET
- ⊙ FIRE HYDRANT
- ⊙ T.S CONTROLLER BOX
- ⊙ T.S DOUBLE HAND HOLE
- ⊙ EXISTING TREE
- ⊙ MAIL BOX
- ⊙ SHRUBS
- ⊙ CONCRETE WALK

PROPOSED LEGEND:

- ▨ RETAINING WALL
- PROPOSED R.O.W.
- ⊕ PROPOSED TREE
- ⊙ SHRUB
- ⊙ TREE TRUNK PROTECTION
- LIMITS OF SODDING
- ▨ RIPRAP

TREE REMOVAL AND PROTECTION SCHEDULE

TREE LOCATION	TREE SIZE	20100110 TREE REM (6-15 IN)	20101200 TREE REMOVAL (>15 IN)	20101200 TREE ROOT PRUNING	20101300 TREE PRUN (1-10 IN)	20101350 TREE PRUN (OVER 10 IN)	20101100 TREE TRUNK PROTECT
888+39 RT	18"			1		1	
888+90 RT	18"			1		1	
888+97 LT	12"			1			
889+16 LT	12"			1			1
891+20 LT	20"		20				
894+20 LT	8"			1	1		1
895+00 LT	7"	7					
895+53 LT	8"			1	1		1
896+15 LT	6"			1	1		1
896+71 LT	6"			1	1		1
898+66 LT	10"	10	20	8	4	3	5

LANDSCAPE RESTORATION SCHEDULE

PAY ITEM NO	DESCRIPTION	QUANTITY	UNIT
21101505	TOPSOIL EXCAVATION AND PLACEMENT	308	CU YD
25000400	NITROGEN FERTILIZER NUTRIENT	25	POUND
25000500	PHOSPHORUS FERTILIZER NUTRIENT	25	POUND
25000600	POTASSIUM FERTILIZER NUTRIENT	25	POUND
25200110	SODDING, SALT TOLERANT	1863	SQ YD
25200200	SUPPLEMENTAL WATERING	14	UNITS
28100105	FILTER FABRIC	20	SQ YD
28200200	STONE RIPRAP, CLASS A3	20	SQ YD
K0036120	MULCH PLACEMENT, 4"	43	SQ YD
K0029634	WEED CONTROL, PRE-EMERGENT GRANULAR HERBICIDE	1	POUND

- EACH FERTILIZER NUTRIENT SHALL BE APPLIED TO THE TOPSOIL AT A RATE OF 60 POUNDS PER ACRE.
- FERTILIZER APPLIED TO PROTECTED AND NEWLY PLANTED TREES AND SHRUBS SHALL BE MEASURED SEPERATELY.
- MULCH BEDS SHALL BE CREATED SURROUNDING ALL SHRUBS.
- WEED CONTROL, PRE-EMERGENT GRANULAR HERBICIDE SHALL PLACED IN ALL MULCH PLACEMENT LOCATIONS.

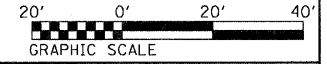

225 W. OHIO ST., FOURTH FL.
CHICAGO, IL 60654
(312)467-0123



CONSTRUCTION NOTES:

- 1 RELOCATE EXISTING SIGNAL POST AND SIGNAL HEAD, 1-FACE, 3-SECTION. INSTALL NEW PEDESTRIAN SIGNAL HEAD, 1-FACE, BRACKET MOUNTED WITH COUNTDOWN TIMER AND PEDESTRIAN PUSHBUTTON ON RELOCATED POST. INSTALL NEW TYPE A CONCRETE FOUNDATION AND REMOVE EXISTING CONCRETE FOUNDATION. REMOVE EXISTING 5C CABLE AND INSTALL NEW 2C, 3C, AND 5C CABLES.
- 2 SAWCUT NEW DETECTOR LOOPS. REMOVE EXISTING LEAD-IN CABLE FROM CONDUIT AND INSTALL NEW LEAD-IN CABLE.
- 3 INSTALL NEW PEDESTRIAN SIGNAL HEAD, 1-FACE, BRACKET MOUNTED WITH COUNTDOWN TIMER AND PEDESTRIAN PUSHBUTTON ON EXISTING MAST ARM. INSTALL NEW 2C AND 3C CABLES.

4 THE GENERAL CONTRACTOR IS REQUIRED TO HIRE AN ENVIRONMENTAL FIRM WITH AT LEAST FIVE (5) DOCUMENTAED LEAKING UNDERGROUND STORAGE TANKS (LUST) CLEANUPS OR THAT IS PRE-QUALIFIED IN HAZARDOUS WASTE BY THE DEPARTMENT TO REMEDIATE THE SOIL CONTAMINATION AND MONITOR FOR WORKER PROTECTION.

RESTORATION OF WORK AREA:

RESTORATION OF THE TRAFFIC SIGNAL WORK AREA SHALL BE INCIDENTAL TO THE RELATED PAY ITEM SUCH AS FOUNDATION, CONDUIT, HANDHOLE, TRENCH AND BACKFILL, ETC. AND NO EXTRA COMPENSATION SHALL BE ALLOWED. ALL ROADWAY SURFACES SUCH AS SHOULDERS, MEDIANS, SIDEWALKS, PAVEMENT, ETC. SHALL BE REPLACED IN KIND. ALL DAMAGE TO MOWED LAWNS SHALL BE REPLACED WITH AN APPROVED SOD, AND ALL DAMAGE TO UNMOWED FIELDS SHALL BE SEEDED IN ACCORDANCE WITH STANDARD SPECIFICATIONS 252 AND 250 RESPECTIVELY.

ALL SIGNAL FOUNDATIONS AND UNDERGROUND WORK SHALL BE COMPLETED PRIOR TO THE REMOVAL OF THE EXISTING SIGNAL POST OR EXISTING FOUNDATIONS.

TRAFFIC SIGNAL LEGEND

	PROPOSED	EXISTING
CONTROLLER		
SERVICE INSTALLATION		
SIGNAL HEAD		
SIGNAL HEAD WITH BACKPLATE		
SIGNAL HEAD, PEDESTRIAN		
SIGNAL POST		
MAST ARM ASSEMBLY AND POLE, STEEL		
MAST ARM ASSEMBLY AND POLE, ALUMINUM		
COMBINATION MAST ARM ASSEMBLY AND POLE, STEEL WITH LUMINAIRE		
UNIT DUCT		
COMMON TRENCH		
HANDHOLE		
HEAVY DUTY HANDHOLE		
DOUBLE HANDHOLE		
UNDERGROUND CONDUIT		
PEDESTRIAN PUSHBUTTON DETECTOR		
DETECTOR LOOP		
CAST IRON JUNCTION BOX		
EMERGENCY VEHICLE LIGHT DETECTOR		
CONFIRMATION BEACON		
SIGNAL HEAD OPTICALLY PROGRAMMED		
CONDUIT SPLICE		
WOOD POLE		
RACEWAY FOR MAGNETIC DETECTOR, TYPE I OR TYPE II		
VEHICLE DETECTOR, NON COMPENSATED MAGNETIC TYPE		
RAILROAD CONTROL CABINET		
TELEPHONE CONNECTION		
ILLUMINATED SIGN - "NO LEFT TURN"		
ILLUMINATED SIGN - "NO RIGHT TURN"		

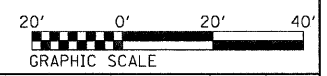
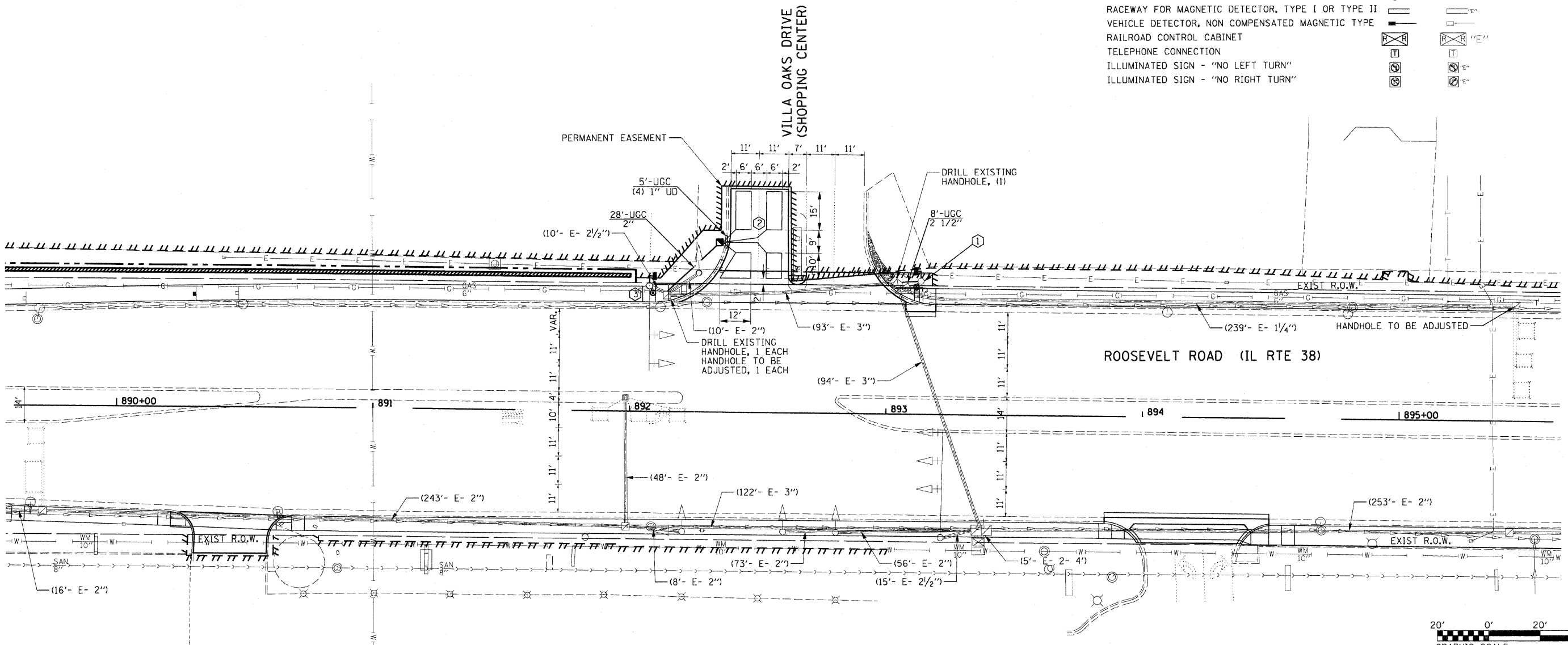
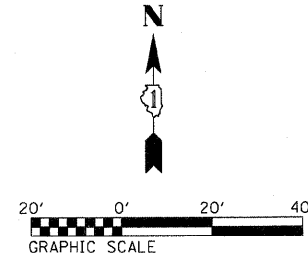

FILE NAME =	USER NAME #USER#	DESIGNED TM	REVISED 10/24/2011	STATE OF ILLINOIS DEPARTMENT OF TRANSPORTATION	TRAFFIC SIGNAL MODIFICATION PLAN ROOSEVELT RD. AT VILLA OAKS DR. INTERSECTION			F.A.P. RTE. 347	SECTION 02-00077-00-SW	COUNTY DUPAGE	TOTAL SHEETS 73	SHEET NO. 49
#FILE#	PLOT SCALE #SCALE#	DRAWN BM/CC/BB	REVISED 01/03/2012 ADDENDUM A		SCALE: AS SHOWN	SHEET NO. 3 OF 6 SHEETS	CONTRACT NO. 63197					
	PLOT DATE #DATE#	CHECKED DA	REVISED									
		DATE 06/08/2011	REVISED									

CONSTRUCTION NOTES:

- ① RELOCATE EXISTING PEDESTRIAN SIGNAL HEAD TO NEW LOCATION. REMOVE AND REINSTALL ELECTRICAL CABLE IN CONDUIT.
- ② RELOCATE EXISTING PEDESTRIAN PUSH BUTTON TO NEW POST. INSTALL NEW 10' POST AND TYPE A CONCRETE FOUNDATION. REMOVE AND REINSTALL ELECTRICAL CABLE IN CONDUIT.
- ③ ROTATE EXISTING PEDESTRIAN PUSHBUTTON TO FACE CROSSWALK.
- ④ RELOCATE EXISTING PUSHBUTTON TO EXISTING POST. REMOVE EXISTING ELECTRICAL CABLE FROM CONDUIT AND INSTALL NEW 20' CABLE.
- ⑤ THE GENERAL CONTRACTOR IS REQUIRED TO HIRE AN ENVIRONMENTAL FIRM WITH AT LEAST FIVE (5) DOCUMENTAED LEAKING UNDERGROUND STORAGE TANKS (LUST) CLEANUPS OR THAT IS PRE-QUALIFIED IN HAZARDOUS WASTE BY THE DEPARTMENT TO REMEDIATE THE SOIL CONTAMINATION AND MONITOR FOR WORKER PROTECTION.

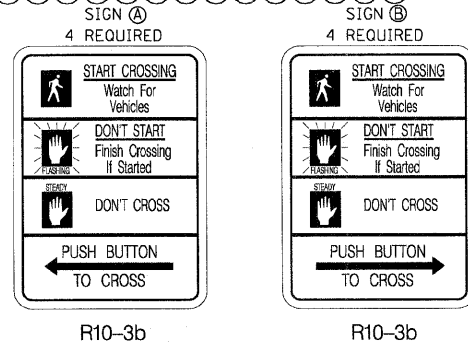

TRAFFIC SIGNAL LEGEND

PROPOSED	EXISTING

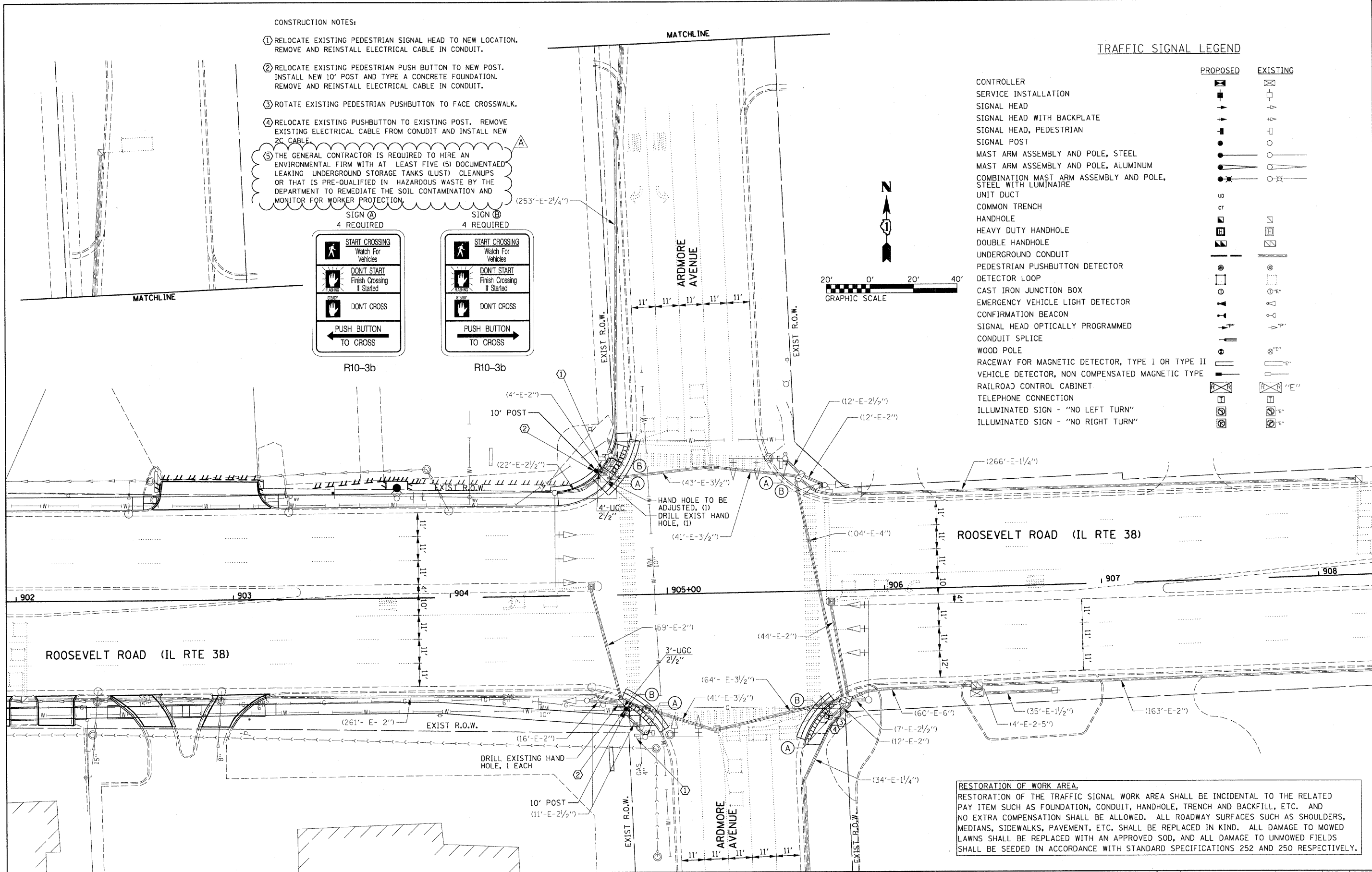

RESTORATION OF WORK AREA.
RESTORATION OF THE TRAFFIC SIGNAL WORK AREA SHALL BE INCIDENTAL TO THE RELATED PAY ITEM SUCH AS FOUNDATION, CONDUIT, HANDHOLE, TRENCH AND BACKFILL, ETC. AND NO EXTRA COMPENSATION SHALL BE ALLOWED. ALL ROADWAY SURFACES SUCH AS SHOULDERS, MEDIANS, SIDEWALKS, PAVEMENT, ETC. SHALL BE REPLACED IN KIND. ALL DAMAGE TO MOWED LAWNS SHALL BE REPLACED WITH AN APPROVED SOD, AND ALL DAMAGE TO UNMOWED FIELDS SHALL BE SEEDED IN ACCORDANCE WITH STANDARD SPECIFICATIONS 252 AND 250 RESPECTIVELY.

FILE NAME =	USER NAME = #USER#	DESIGNED TM	REVISED 10/24/2011	STATE OF ILLINOIS DEPARTMENT OF TRANSPORTATION	TRAFFIC SIGNAL MODIFICATION PLAN ROOSEVELT RD. AT ARDMORE AVE. INTERSECTION	F.A.P. RTE. 347	SECTION 02-00077-00-SW	COUNTY DUPAGE	TOTAL SHEETS 73	SHEET NO. 51
#FILE#	PLOT SCALE = #SCALE#	DRAWN BM/CC/BB	REVISED 01/03/2012 ADDENDUM A			CONTRACT NO. 63197				
	PLOT DATE = #DATE#	CHECKED DA	REVISED			ILLINOIS FED. AID PROJECT				
		DATE 06/08/2011	REVISED			FED. ROAD DIST. NO. ILLINOIS FED. AID PROJECT				

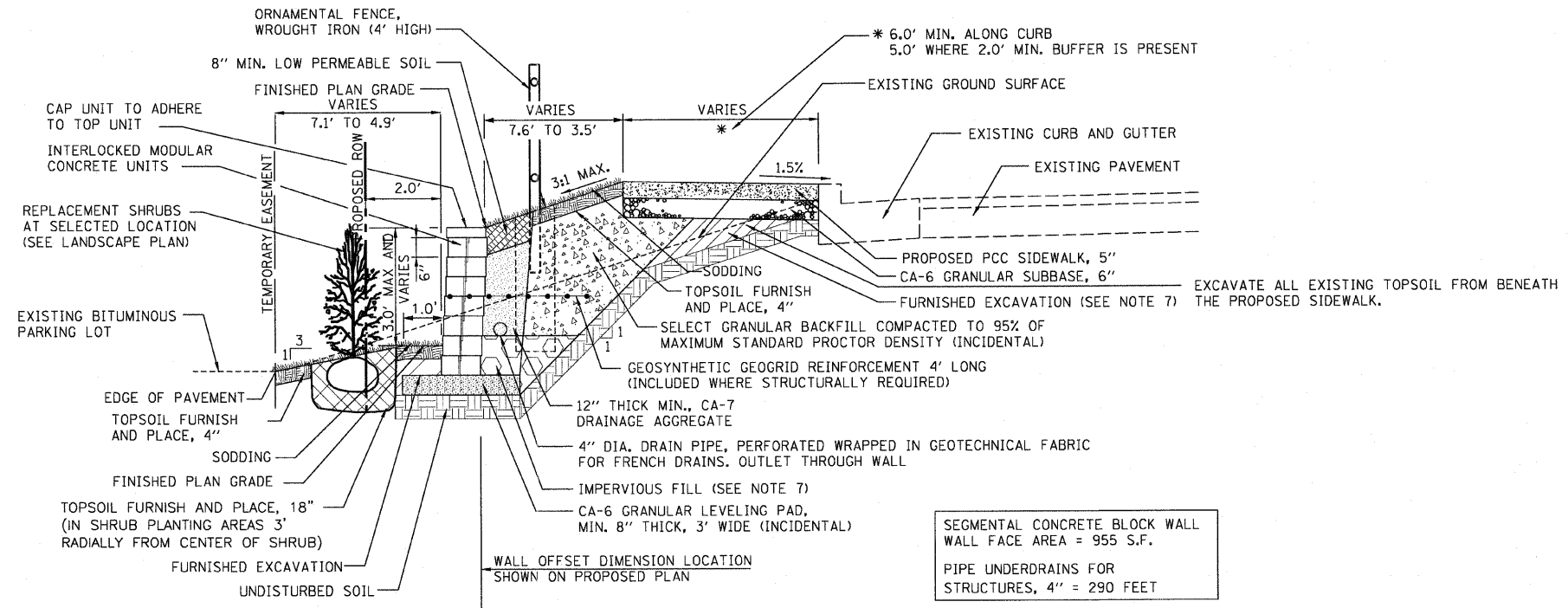

TYPICAL SECTION A - 3.0' SEGMENTAL CONCRETE BLOCK WALL
NTS

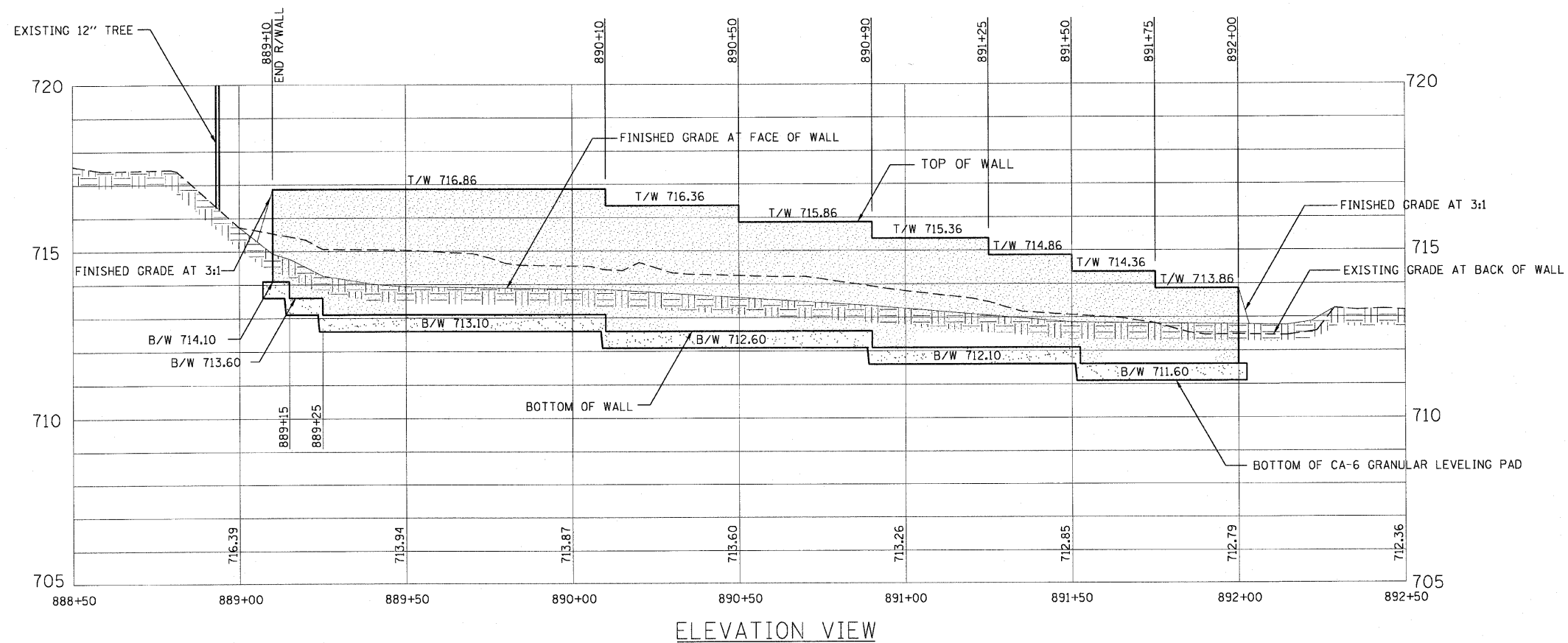

- NOTES:
- IT IS THE CONTRACTOR'S RESPONSIBILITY TO VERIFY EXISTING CONDITIONS AND DIMENSIONS BEFORE START OF THE WORK OR ORDERING MATERIALS.
 - SEE GRADING PLANS FOR LOCATIONS, GRADING, LENGTH AND ELEVATIONS
 - THE BASE FOUNDATION FOR THE GRANULAR LEVELING PAD SHALL BE APPROVED BY THE RESIDENT ENGINEER PRIOR TO PLACEMENT OF THE LEVELING PAD. MINIMUM SOIL PRESSURE UNDER PAD=2000 PSF.
 - EACH COURSE OF THE MODULAR BLOCKS TO BE SET BACK 3/4" FROM THE COURSE BELOW.
 - SEE SPECIAL PROVISION FOR SEGMENTAL CONCRETE BLOCK WALL.
 - PIPE UNDERDRAINS FOR STRUCTURES SHALL INCLUDE THE 4" DIA. PERFORATED PIPE DRAIN, GEOTECHNICAL FABRIC FOR FRENCH DRAINS, CA-2 DRAINAGE AGGREGATE. PIPES SHALL OUTLET THROUGH WALL.
 - USE SUITABLE NON-SPECIAL WASTE FROM DEMINIMUS SITES IN-LIEU OF FURNISHED EXCAVATION IN LOCATIONS THAT 2" COVER IS PRESENT.
 - THE GENERAL CONTRACTOR IS REQUIRED TO HIRE AN ENVIRONMENTAL FIRM WITH AT LEAST FIVE (5) DOCUMENTED LEAKING UNDERGROUND STORAGE TANKS (LUST) CLEANUPS OR THAT IS PRE-QUALIFIED IN HAZARDOUS WASTE BY THE DEPARTMENT TO REMEDIATE THE SOIL CONTAMINATION AND MONITOR FOR WORKER PROTECTION.

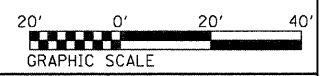

FILE NAME =	USER NAME = #USER#	DESIGNED DA	REVISED 10/24/2011	STATE OF ILLINOIS DEPARTMENT OF TRANSPORTATION	SEGMENTAL CONCRETE BLOCK WALL TYPICAL SECTION AND ELEVATION	F.A.P. RTE.	SECTION	COUNTY	TOTAL SHEETS	SHEET NO.	
#FILE#	DRAWN JR/BB	REVISOR JJ	REVISION 01/03/2012 ADDENDUM A			347	02-00077-00-SW	DUPAGE	73	53	
PLOT SCALE = #SCALE#	CHECKED JJ	DATE 06/08/2011	REVISED			CONTRACT NO. 63197					
PLOT DATE = #DATE#	DATE					FED. ROAD DIST. NO. ILLINOIS FED. AID PROJECT					

SCALE: AS SHOWN SHEET NO. 1 OF 2 SHEETS STA. 888+50.00 TO STA. 892+50.00