

EXISTING

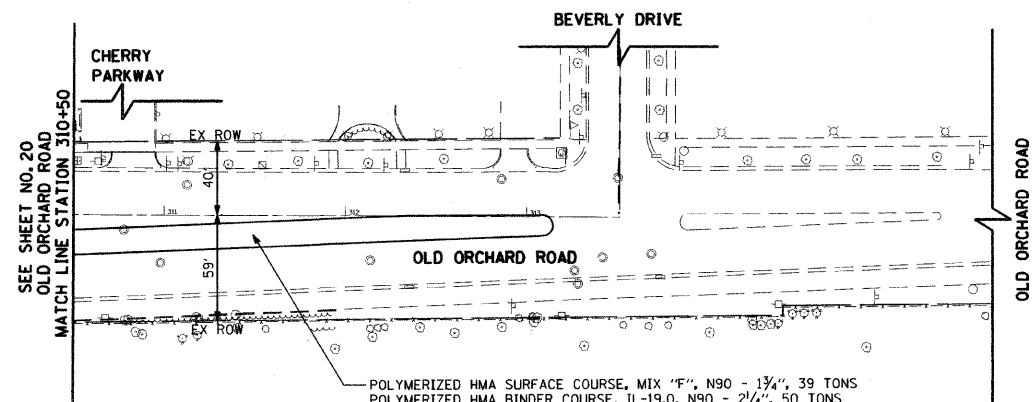

- LEGEND**
- PAVEMENT REMOVAL
 - MEDIAN REMOVAL
 - SIDEWALK REMOVAL
 - DRIVEWAY PAVEMENT REMOVAL
 - HMA SURFACE REMOVAL, VARIABLE DEPTH OVER PATCHES (TO TOP OF EXIST PCC BASE COURSE)
 - HOT-MIX ASPHALT SURFACE REMOVAL, 2 1/2"
 - TREE REMOVAL
 - RELOCATE UTILITY POLE (BY OTHERS)
 - COMBINATION CURB AND GUTTER REMOVAL
 - HOT-MIX ASPHALT SURFACE REMOVAL, VARIABLE DEPTH (SEE TABLES ON SHEET NO. 54)

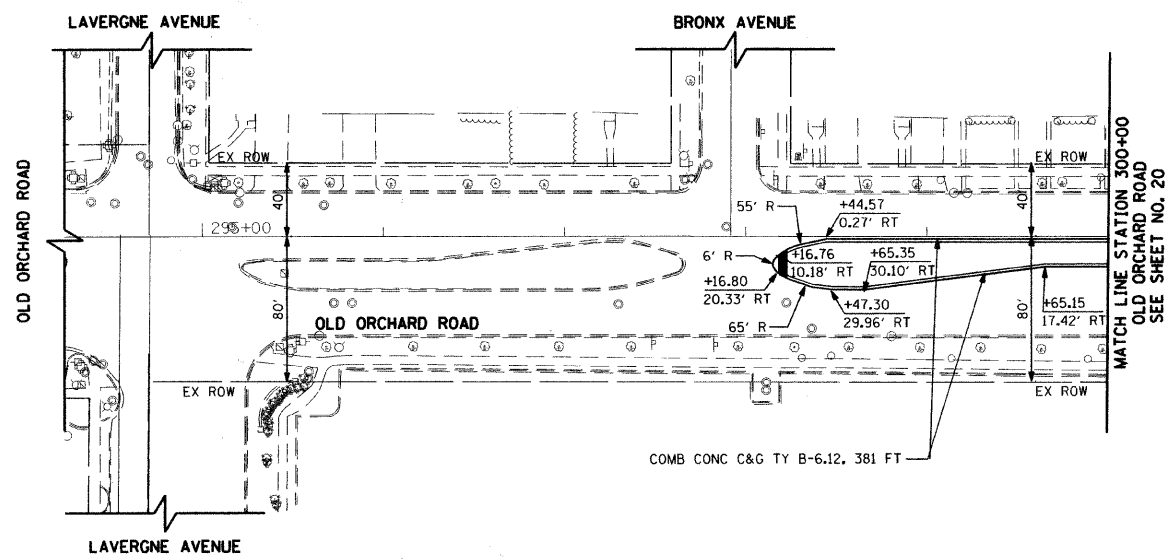
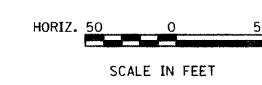

PROPOSED

TranSystems
 1475 EAST WOODFIELD ROAD, SUITE 600
 SCHALMIBURG, ILLINOIS 60173
 (847) 605-9800

FILE NAME = g:\ch08\0845\road\sheet\0845-r1-302.dwg	USER NAME = CEComin	DESIGNED CEC	REVISED -	STATE OF ILLINOIS DEPARTMENT OF TRANSPORTATION	U.S. ROUTE 41 (SKOKIE BOULEVARD) PLAN		F.A.P. RTE. 350	SECTION 00-00243-00-CH	COUNTY COOK	TOTAL SHEETS 142	SHEET NO. 21	
PLOT SCALE = 50,000 ' / IN.	CHECKED DWB	DATE 06/03/2011	REVISED -		SCALE: 1"=50'	SHEET NO. 5 OF 5 SHEETS	STA. 295,310+50 TO STA. 300,313+51	CONTRACT NO. 63566				
PLOT DATE = 6/3/2011	DATE 06/03/2011	REVISED -	REVISED -		FED. ROAD DIST. NO. 7 ILLINOIS FED. AID PROJECT							