

- LEGEND**
- CONE, DRUM OR BARRICADE (NOT REQUIRED FOR MOVING OPERATION)
 - TEMPORARY CONCRETE BARRIER
 - ↑ SIGN ON PORTABLE OR PERMANENT SUPPORT
 - ⊥ TYPE III BARRICADE WITH FLASHING LIGHTS
 - ↑ ARROW BOARD
 - ▨ WORK AREA
 - ▨ TEMPORARY PAVEMENT
 - ☀ FLASHING BEACON

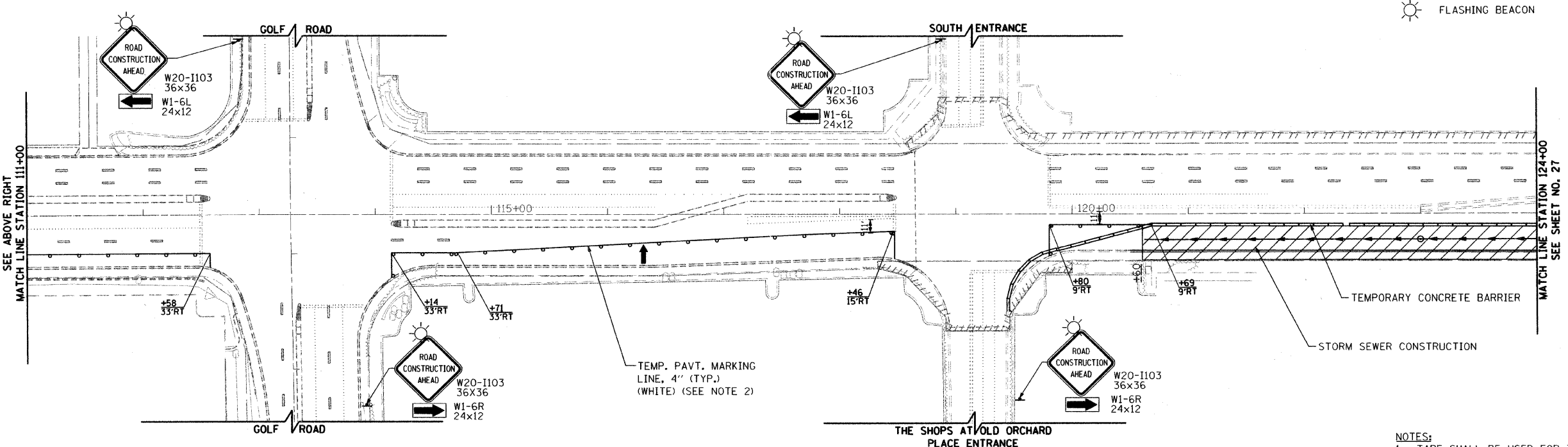

NOTES:
 1. TAPE SHALL BE USED FOR THE TEMPORARY PAVEMENT MARKINGS BETWEEN FOSTER STREET AND THE SOUTH MALL ENTRANCE.

TranSystems
 1475 EAST WOODFIELD ROAD, SUITE 600
 SCHAMBURG, ILLINOIS 60173
 (847) 605-9800

FILE NAME = g:\ch\08\0815\road\shes\145-11-007-Pre-Stage.plt	USER NAME = CEComin	DESIGNED FA	REVISED -	STATE OF ILLINOIS DEPARTMENT OF TRANSPORTATION	U.S. ROUTE 41 (SKOKIE BOULEVARD) SUGGESTED TRAFFIC CONTROL PLAN (PRE-STAGE)	F.A.P. RTE.	SECTION	COUNTY	TOTAL SHEETS	SHEET NO.	
PLOT SCALE = 5/8"=20' / IN.	PLOT DATE = 6/3/2011	DRAWN FA	REVISED -			350	00-00243-00-CH	COOK	142	26	
CHECKED DWB	DATE 06/03/2011	CHECKED DWB	REVISED -			CONTRACT NO. 63566					
		DATE 06/03/2011	REVISED -			FED. ROAD DIST. NO. 7 ILLINOIS FED. AID PROJECT					
					SCALE: 1"=50'	SHEET NO. 5 OF 21 SHEETS		STA. 107+00 TO STA. 125+00			