

MATCH LINE STA. 212 + 00

MATCH LINE STA. 218 + 00

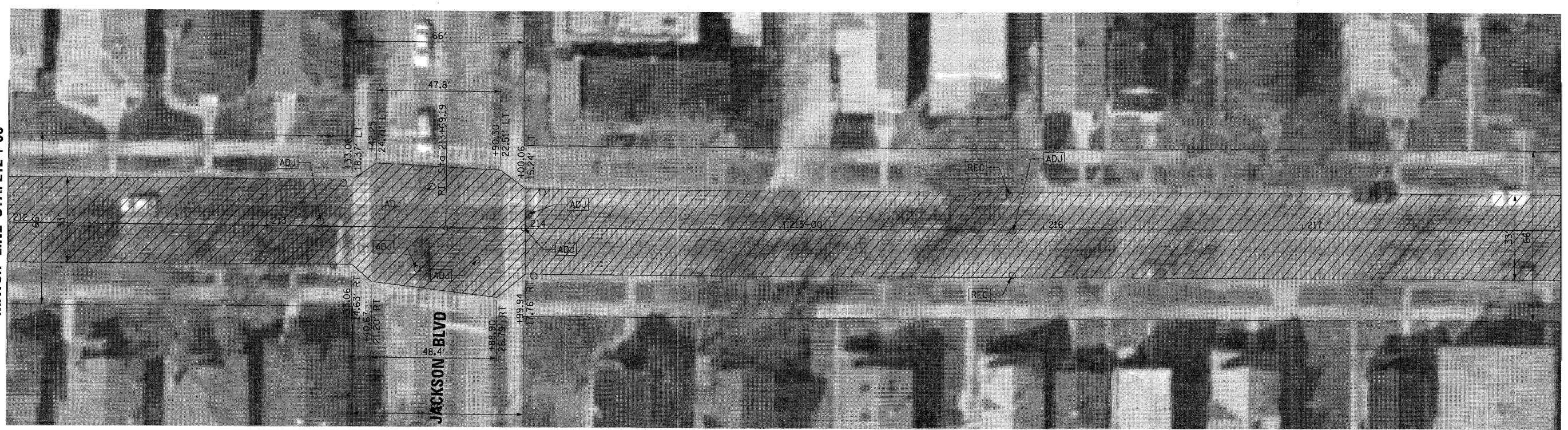

MATCH LINE STA. 218 + 00

MATCH LINE STA. 224 + 00

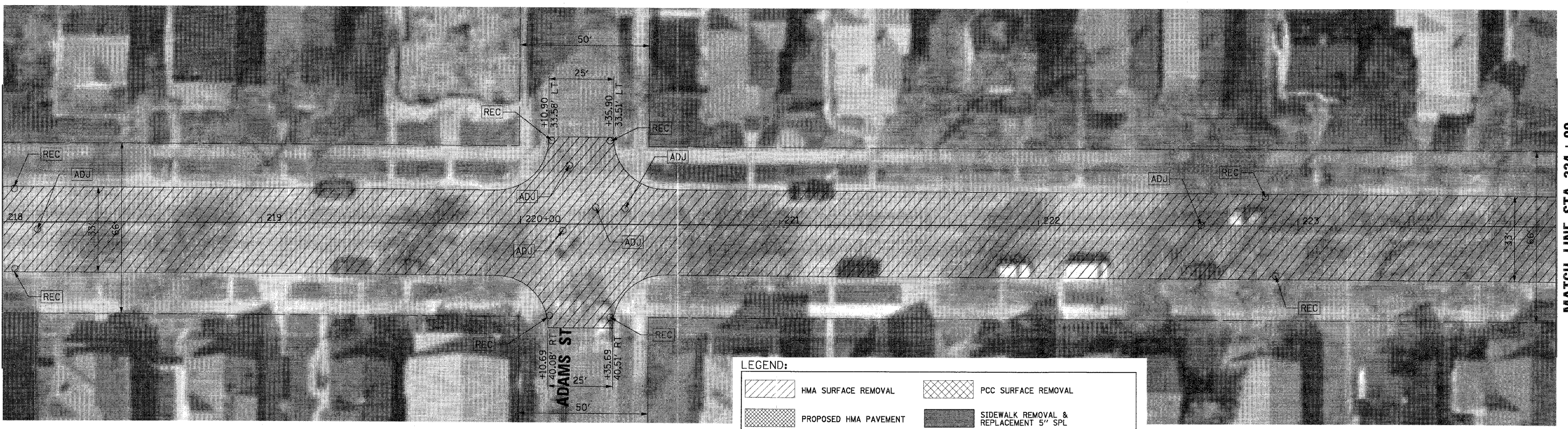

**LEGEND:**

HMA SURFACE REMOVAL	PCC SURFACE REMOVAL
PROPOSED HMA PAVEMENT	SIDEWALK REMOVAL & REPLACEMENT 5" SPL
CURB & GUTTER REMOVAL AND REPLACEMENT	STRUCTURE TO BE ADJUSTED
STRUCTURE TO BE RECONSTRUCTED	STRUCTURE TO BE REMOVED

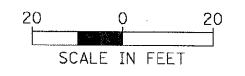

FILE NAME =	USER NAME = tworman	DESIGNED -	REVISED -
N:\FORESTPARK\0223\B036\Civil\REM2_0223\36.dwg		DRAWN -	REVISED -
PLOT SCALE = 20'		CHECKED -	REVISED -
PLOT DATE = 12/22/2011		DATE -	REVISED -

**STATE OF ILLINOIS  
DEPARTMENT OF TRANSPORTATION**

**EXISTING CONDITIONS & REMOVAL PLAN**

SCALE: SHEET NO. OF SHEETS STA. TO STA.

F.A.U. RTE.	SECTION	COUNTY	TOTAL SHEETS	SHEET NO.
1047	11-00110-00-RS	COOK	25	6
CONTRACT NO. 63603			ILLINOIS FED. AID PROJECT	