

MATCH LINE - STA. 95+50
SEE SHEET 8

ISHNALA DRIVE
MATCH LINE - STA. 9+50
SEE BELOW RIGHT

MATCH LINE - STA. 99+50
SEE SHEET 10

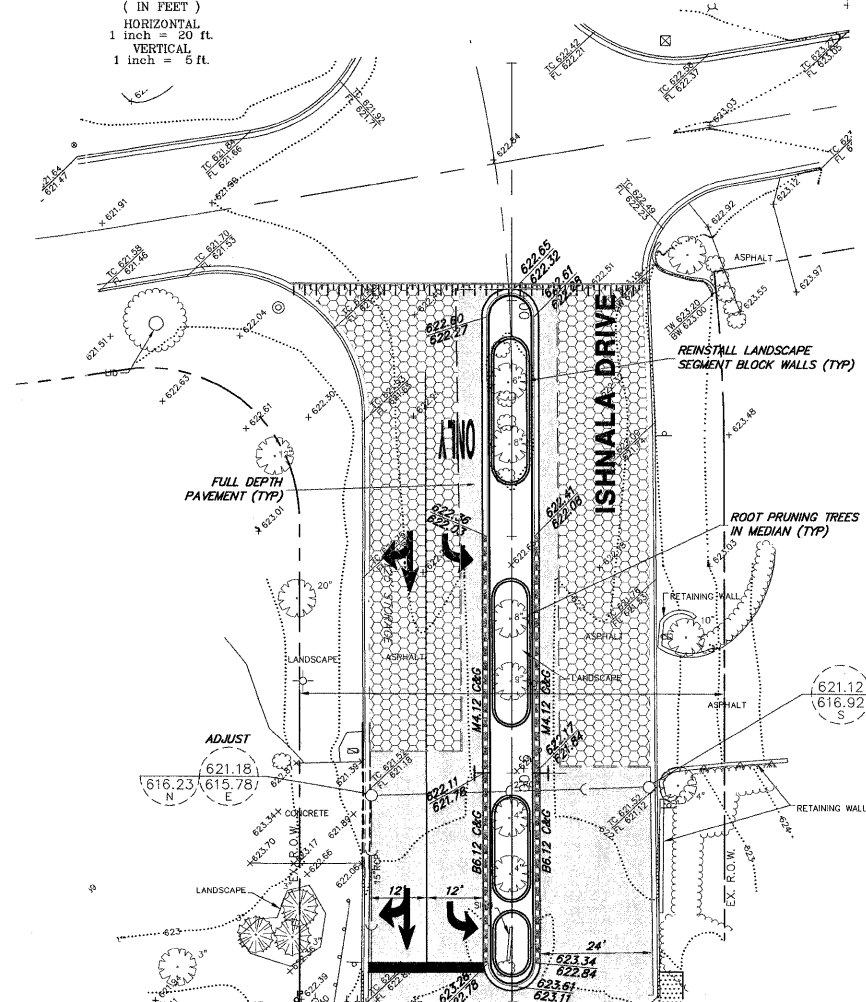
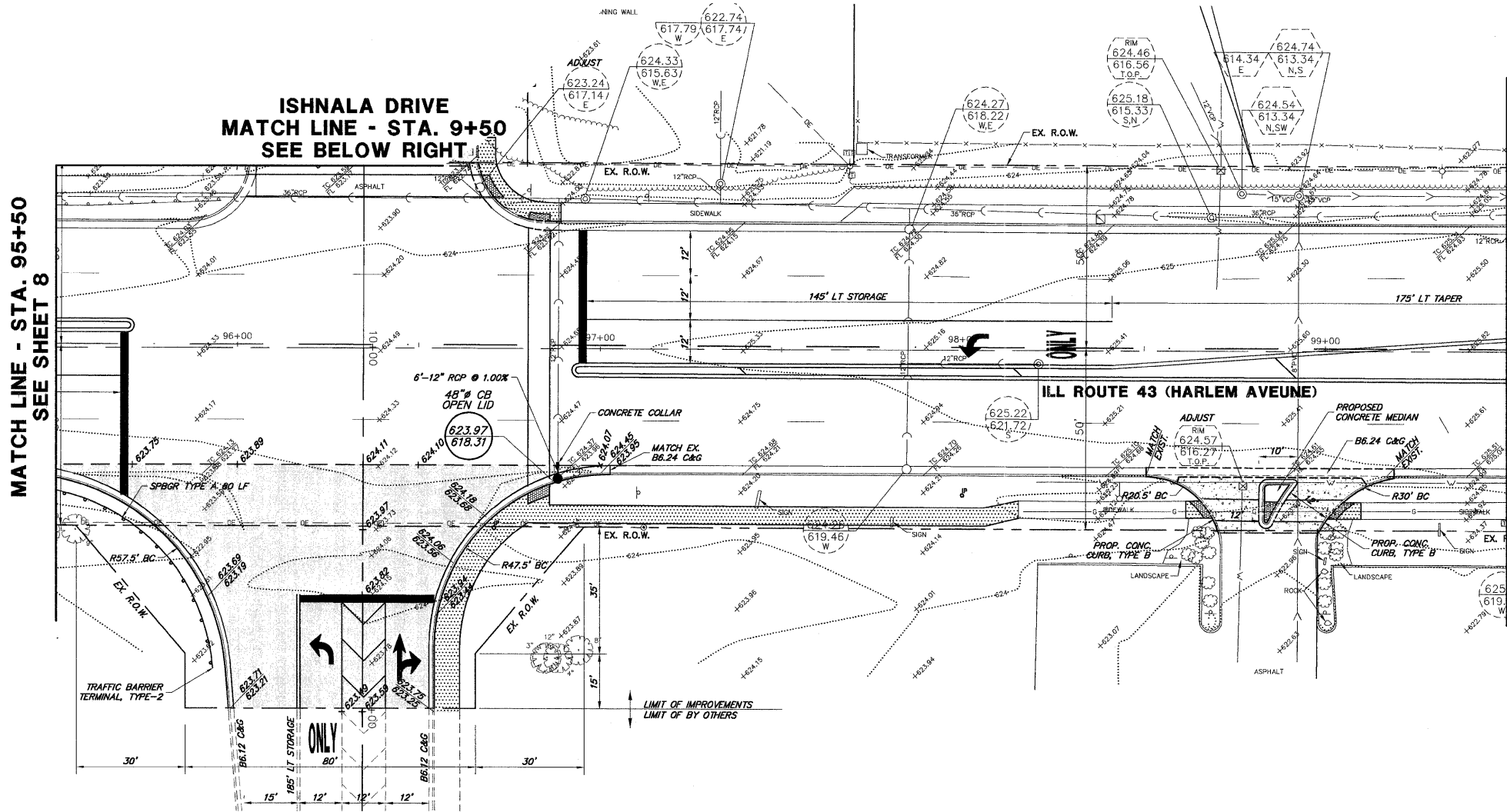
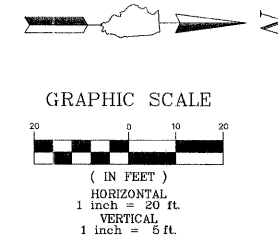

MATCH LINE - STA. 9+50
SEE ABOVE LEFT

ILL ROUTE 43 (HARLEM AVENUE)

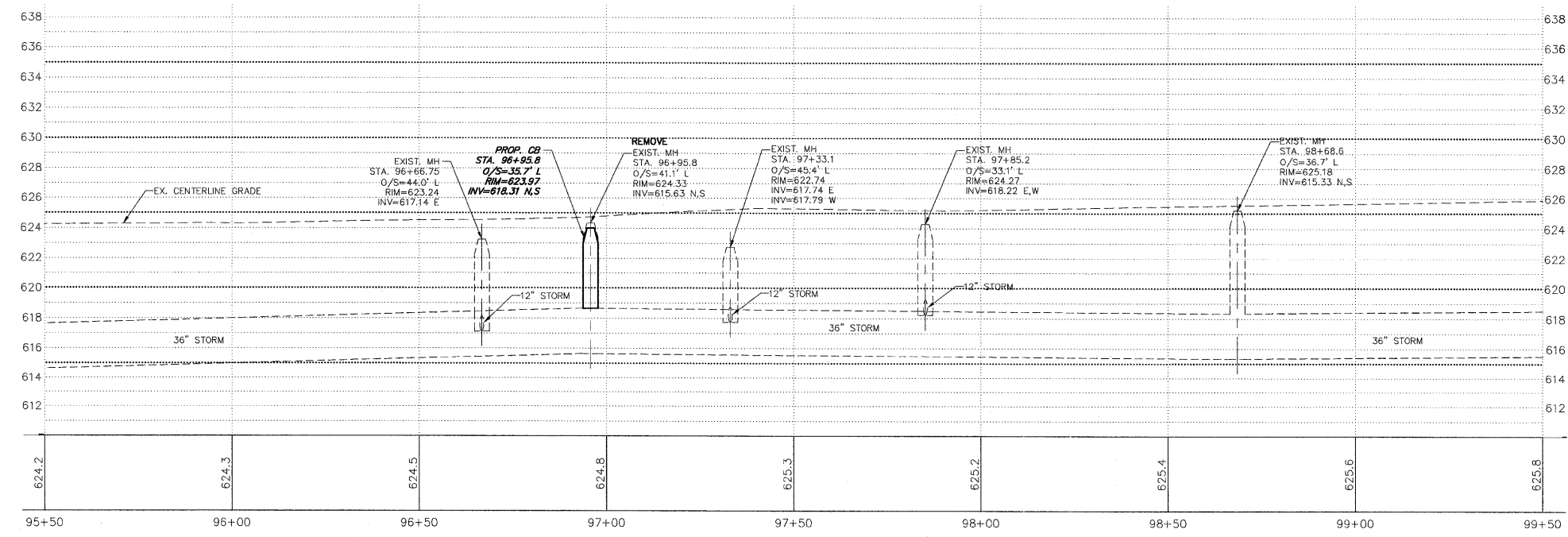

PROPOSED CONDITIONS LEGEND

- HOT-MIX ASPHALT PAVEMENT (SEE TYPICAL SECTION)
- HOT-MIX ASPHALT SURFACE COURSE, MIX 'D', N70
- PORTLAND CEMENT CONCRETE DRIVEWAY PAVEMENT, 8 INCH
- PORTLAND CEMENT CONCRETE SIDEWALK, 5 INCH
- COMBINATION CONCRETE CURB AND GUTTER
- COMBINATION CONCRETE CURB AND GUTTER (DEPRESSED)
- COMBINATION CONCRETE CURB AND GUTTER (REVERSE PITCH)
- DETECTABLE WARNINGS (SEE CURB RAMP DETAIL SHEET)

FILE NAME =	USER NAME = GHA
2806-240-PR6.dwg	

DESIGNED - BVS	REVISED -
DRAWN - BVS	REVISED -
CHECKED - WCG	REVISED -
DATE - 11/10/2011	REVISED -

EXIST. MH STA. 96+95.8 O/S=44.0' L RIM=623.24 INV=617.14 E	REMOVE EXIST. MH STA. 96+95.8 O/S=41.1' L RIM=624.33 INV=615.63 N.S	EXIST. MH STA. 97+33.1 O/S=45.4' L RIM=622.74 INV=617.74 E	EXIST. MH STA. 97+85.2 O/S=33.1' L RIM=624.27 INV=618.22 E,W	EXIST. MH STA. 98+68.8 O/S=36.7' L RIM=625.18 INV=615.33 N.S
---	--	---	---	---

PROF. CB STA. 96+85.8 O/S=35.7' L RIM=623.97 INV=618.31 N,S
--

STATE OF ILLINOIS
DEPARTMENT OF TRANSPORTATION

PLAN AND PROFILE
ILL RTE 43 (HARLEM AVENUE) ROAD IMPROVEMENTS

F&P RTE. 348	SECTION 10-00047-00-TL	COUNTY COOK	TOTAL SHEETS 30	SHEET NO. 9	CONTRACT # 63626
--------------	------------------------	-------------	-----------------	-------------	------------------

GHA #2806.242

SCALE: 1"=20' SHEET NO. OF SHEETS STA. 95+50 TO STA. 99+50

ILLINOIS FED. AID PROJECT