

PROP. CURVE ORCHARD-15
 PI STA. = 208+55.08
 $\Delta = 16^\circ 54' 39''$ (LT)
 $D = 6^\circ 39' 44''$
 $R = 860.00'$
 $T = 127.84'$
 $L = 253.83'$
 $E = 9.45'$
 $e = NC$
 T.R. = -----
 S.E. RUN = -----
 P.C. STA = 207+27.24
 P.T. STA = 209+81.07

NOTE:
 ALL DIMENSIONS AND ELEVATIONS
 ARE TO THE EDGE OF PAVEMENT
 UNLESS OTHERWISE NOTED.

ORCHARD DRIVE

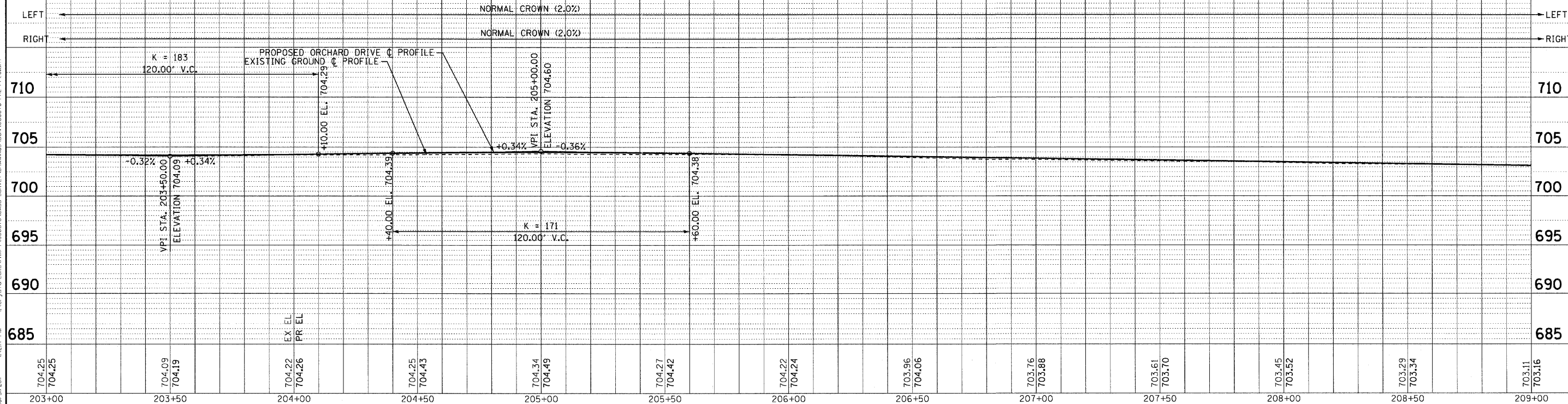

COPYRIGHT © 2011 BY BAXTER & WOODMAN, INC.
 STATE OF ILLINOIS - PROFESSIONAL DESIGN FIRM
 111 WEST WASHINGTON STREET, SUITE 1000, CHICAGO, IL 60601
 312.467.1000 FAX 312.467.1001
 07/27/2011

	DESIGNED - TLH	REVISED -	STATE OF ILLINOIS ORCHARD DRIVE IMPROVEMENTS	GEOMETRIC PLAN AND PROFILE ORCHARD DRIVE		F.A.U. RTE. 2836	SECTION 06-00090-00-FP	COUNTY COOK	TOTAL SHEETS 200	SHEET NO. 47
	DRAWN - LKB	REVISED -		SCALE: HORIZ. 1"=20' / VERT. 1"=5'		STA. 203+00 TO STA. 209+00	FED. ROAD DIST. NO. 1	ILLINOIS FED. AID PROJECT	M-8003(666)	CONTRACT NO. 63635
	CHECKED - TAO	REVISED -								
	DATE - 10/24/11	FILE - 060670-PH2-PP20.sht								