

PROP. CURVE ORCHARD-17  
 PI STA. = 219+91.12  
 $\Delta = 22^\circ 54' 24''$  (LT)  
 $D = 22^\circ 55' 06''$   
 $R = 250.00'$   
 $T = 50.65'$   
 $L = 99.95'$   
 $E = 5.08'$   
 $e =$  -----  
 $T.R. =$  -----  
 $S.E. RUN =$  -----  
 $P.C. STA = 219+40.47$   
 $P.T. STA = 220+40.42$

PROP. CURVE ORCHARD-16  
 PI STA. = 215+69.40  
 $\Delta = 22^\circ 07' 56''$  (RT)  
 $D = 10^\circ 03' 07''$   
 $R = 570.00'$   
 $T = 111.48'$   
 $L = 220.18'$   
 $E = 10.80'$   
 $e =$  NA  
 $T.R. =$  -----  
 $S.E. RUN =$  -----  
 $P.C. STA = 214+57.92$   
 $P.T. STA = 216+78.10$

NOTE:  
 ALL DIMENSIONS AND ELEVATIONS  
 ARE TO THE EDGE OF PAVEMENT  
 UNLESS OTHERWISE NOTED.

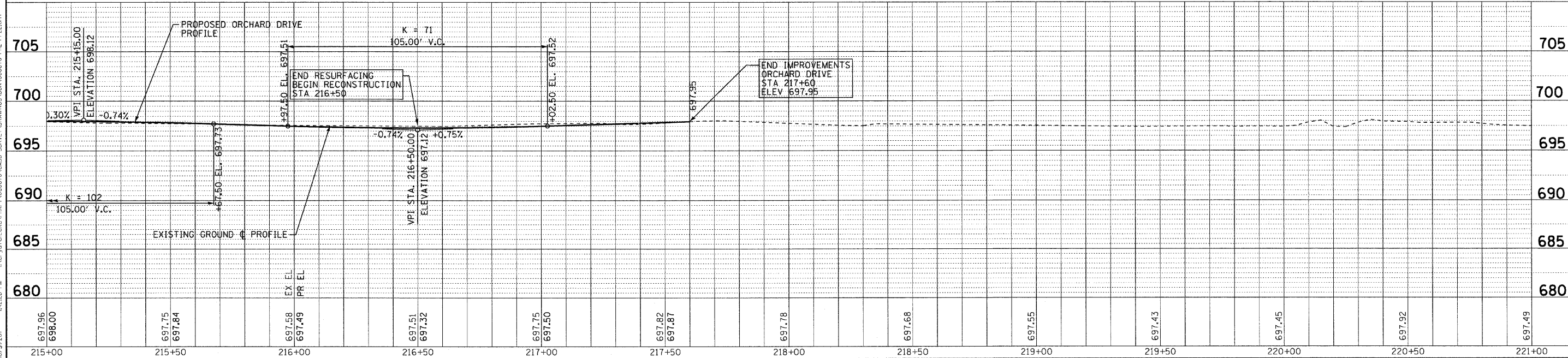

697.96	698.00	697.75	697.84	697.58	697.49	697.51	697.32	697.75	697.50	697.82	697.87	697.78	697.68	697.55	697.43	697.45	697.92	697.49
215+00	215+50	216+00	216+50	217+00	217+50	218+00	218+50	219+00	219+50	220+00	220+50	221+00						



DESIGNED - TLH  
 DRAWN - UKB  
 CHECKED - TAO  
 DATE - 10/31/11

REVISED -  
 REVISED -  
 REVISED -  
 FILE - 060670-PH2-PP22.shx

**STATE OF ILLINOIS**  
**ORCHARD DRIVE IMPROVEMENTS**

**GEOMETRIC PLAN AND PROFILE**  
**ORCHARD DRIVE**

SCALE: HORIZ. 1"=20' / VERT. 1"=5'  
 STA. 215+00 TO STA. 217+38.09

F.A.U. RTE.	SECTION	COUNTY	TOTAL SHEETS	SHEET NO.
2836	06-00090-00-FP	COOK	200	49
FED. ROAD DIST. NO. 1 (ILLINOIS) FED. AID PROJECT			CONTRACT NO. 63635	
			W-8003661	

CONTRACT NO. 63635  
 STATE OF ILLINOIS  
 LICENSE NO. 84-0021 - EXPIRES 4/30/2013  
 DATE 10/31/2011