

### ORCHARD DRIVE

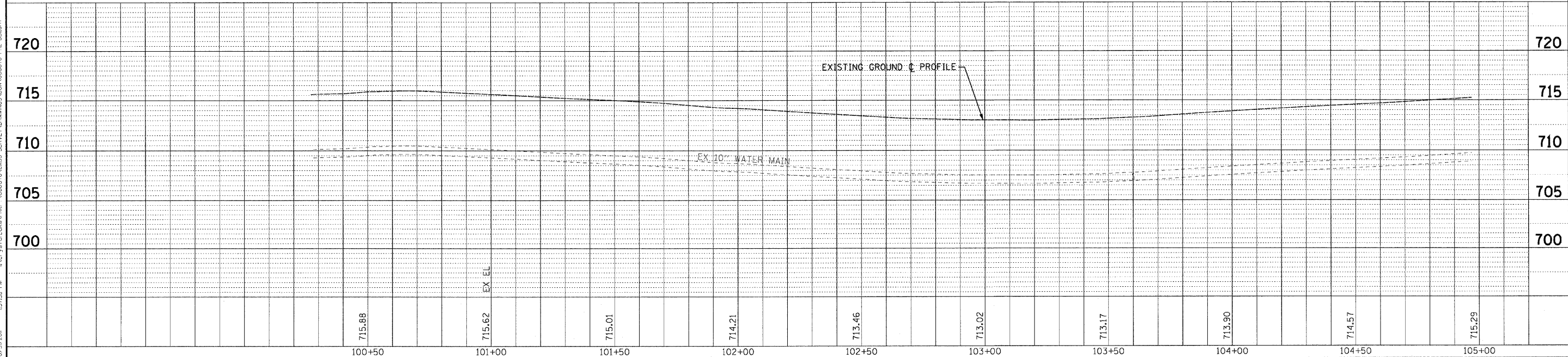

COPYRIGHT © 2011 BY BAXTER & WOODMAN, INC.  
 STATE OF ILLINOIS - PROFESSIONAL DESIGN FIRM  
 LICENSE NO. - 06-00090-00-FP  
 PROJECT NO. - 060670-PH2-DU1  
 DATE - 10/24/11  
 FILE - 060670-PH2-DU1.shx

	DESIGNED - AMM	REVISIONS	<b>STATE OF ILLINOIS</b> <b>ORCHARD DRIVE IMPROVEMENTS</b>		<b>DRAINAGE AND UTILITY</b> <b>ORCHARD DRIVE</b>		F.A.U. RTE. 2836 SECTION 06-00090-00-FP COUNTY COOK TOTAL SHEETS 200 SHEET NO. 61 CONTRACT NO. 63635
	DRAWN - MAC	REVISIONS			SCALE: HORIZ. 1"=20' / VERT. 1"=5'	STA. 100+66 TO STA. 105+00	
	CHECKED - TAO	REVISIONS					
	DATE - 10/24/11	FILE - 060670-PH2-DU1.shx					