

* COST INCLUDES PLACEMENT OF STRUCTURE OVER EXISTING STORM SEWER AND RECONNECTION

STORM STRUCTURES

LABEL	STATION	OFFSET (FT)	TYPE	FRAME	ELEVATION	RIM/EP	INVERT
S-28	170+77	20.3	RT CATCH BASIN, TYPE A, 4' DIA.	T-24 F&G	699.00	EP	695.20 15"W(ex)
S-29	170+77	20.3	LT CATCH BASIN, TYPE A, 4' DIA.	T-24 F&G	699.07	EP	694.87 15"E(ex)
S-30	172+62	18.0	RT CATCH BASIN, TYPE A, 4' DIA.	T-24 F&G	693.04	EP	689.40 15"W
* S-31	172+62	1.5	LT MANHOLE, TYPE A, 4' DIA.	T-1 F, C.L.	693.36	RIM	688.95 15"E,W; 688.70 18"N(ex),S(ex)
S-32	172+62	18.0	LT CATCH BASIN, TYPE A, 4' DIA.	T-24 F&G	693.04	EP	689.40 15"E
S-33	173+27	18.0	RT INLET, TYPE A	T-24 F&G	692.24	EP	688.80 15"N
S-34	173+37	18.0	RT CATCH BASIN, TYPE A, 4' DIA.	T-24 F&G	692.23	EP	688.63 15"S,N; 688.63 15"W(ex)
S-35	173+47	18.0	RT INLET, TYPE A	T-24 F&G	692.24	EP	688.80 15"S
* S-35A	174+91	18.0	LT CATCH BASIN, TYPE A, 5' DIA.	T-24 F&G	693.24	EP	686.70 30"SW(ex),NE(ex)
S-36	173+28	18.0	LT INLET, TYPE A	T-24 F&G	692.35	EP	688.90 15"N
* S-36A	175+22	18.0	RT MANHOLE, TYPE A, 6' DIA.	T-24 F&G	693.44	EP	686.25 36"SW(ex),NE(ex)
S-37	173+38	18.0	LT CATCH BASIN, TYPE A, 4' DIA.	T-24 F&G	692.34	EP	688.74 15"S,N; 688.74 15"E(ex)
S-38	173+48	18.0	LT INLET, TYPE A	T-24 F&G	692.35	EP	688.90 15"S

PIPES

NO.		TY	DIA. (IN)	LENGTH (LF)	SLOPE	TBF (CY)
P-22	STORM SEWERS, CLASS A	1	15	19	2.37%	7
P-23	STORM SEWERS, CLASS A	1	15	16	2.81%	6
P-24	STORM SEWERS, CLASS A	1	15	8	2.12%	3
P-25	STORM SEWERS, CLASS A	1	15	8	2.12%	3
P-26	STORM SEWERS, CLASS A	1	15	8	2.00%	3
P-27	STORM SEWERS, CLASS A	1	15	8	2.00%	3

CANADIAN NATIONAL RAILROAD

ORCHARD DRIVE

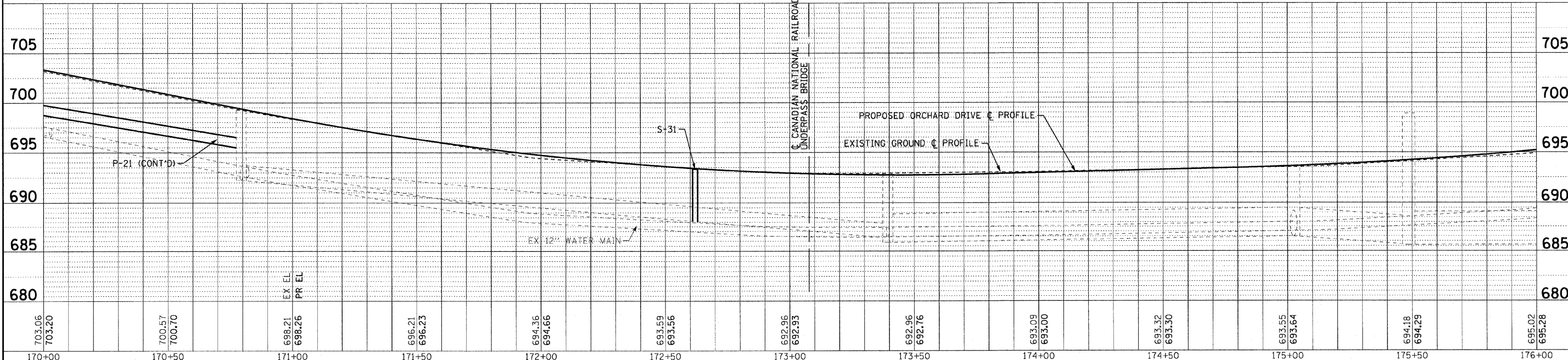

DESIGNED - AMM	REVISED -
DRAWN - LKB	REVISED -
CHECKED - TAO	REVISED -
DATE - 10/24/11	FILE - 060670-Ph2-Du14.sht

STATE OF ILLINOIS
ORCHARD DRIVE IMPROVEMENTS

DRAINAGE AND UTILITY
ORCHARD DRIVE

SCALE: HORIZ. 1"=20' / VERT. 1"=5'

STA.170+00 TO STA.176+00

F.A.U. RTE. 2836	SECTION 06-00090-00-FP	COUNTY COOK	TOTAL SHEETS 200	SHEET NO. 74
FED. ROAD DIST. NO. 1 ILLINOIS FED. AID PROJECT			CONTRACT NO. 63635	
M-8003(661)				

COPYRIGHT © 2011 BY BAXTER & WOODMAN, INC.
 STATE OF ILLINOIS - PROFESSIONAL DESIGN FIRM
 2635 S. W. 11TH ST., SUITE 100, MIAMI, FL 33155
 TEL: 305-444-1111 FAX: 305-444-1112
 WWW.BAXTERANDWOODMAN.COM