

COPYRIGHT © 2011 BY BAXTER & WOODMAN, INC.
 ALL RIGHTS RESERVED. THIS DRAWING IS THE PROPERTY OF BAXTER & WOODMAN, INC. AND IS NOT TO BE REPRODUCED OR TRANSMITTED IN ANY FORM OR BY ANY MEANS, ELECTRONIC OR MECHANICAL, INCLUDING PHOTOCOPYING, RECORDING, OR BY ANY INFORMATION STORAGE AND RETRIEVAL SYSTEM.
 LICENSE NO. 184-00321 - EXPIRES 4/30/2013
 10/21/2011 10:45:39 PM

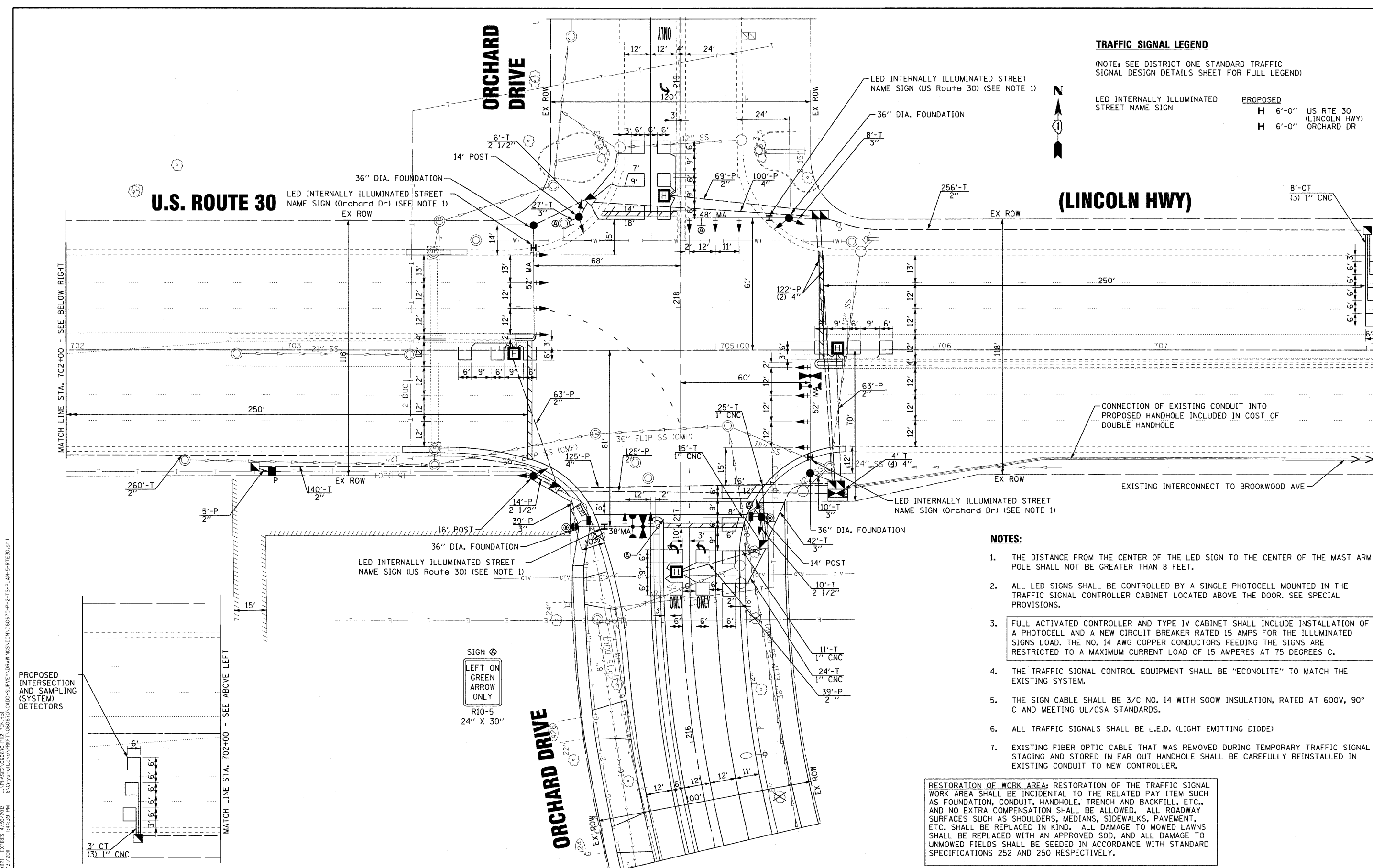

TRAFFIC SIGNAL LEGEND

(NOTE: SEE DISTRICT ONE STANDARD TRAFFIC SIGNAL DESIGN DETAILS SHEET FOR FULL LEGEND)

LED INTERNALLY ILLUMINATED STREET NAME SIGN	PROPOSED	US RTE 30 (LINCOLN HWY)	ORCHARD DR
H	6'-0"	US RTE 30 (LINCOLN HWY)	
H	6'-0"		ORCHARD DR

MATCH LINE STA. 702+00 - SEE BELOW RIGHT

MATCH LINE STA. 702+00 - SEE ABOVE LEFT

PROPOSED INTERSECTION AND SAMPLING (SYSTEM) DETECTORS

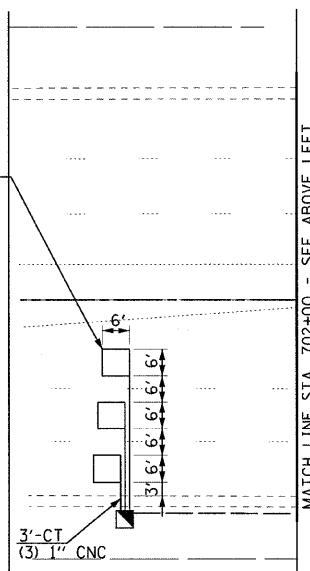

SIGN @
LEFT ON GREEN
ARROW ONLY
R10-5
24" X 30"

NOTES:

1. THE DISTANCE FROM THE CENTER OF THE LED SIGN TO THE CENTER OF THE MAST ARM POLE SHALL NOT BE GREATER THAN 8 FEET.
2. ALL LED SIGNS SHALL BE CONTROLLED BY A SINGLE PHOTOCELL MOUNTED IN THE TRAFFIC SIGNAL CONTROLLER CABINET LOCATED ABOVE THE DOOR. SEE SPECIAL PROVISIONS.
3. FULL ACTIVATED CONTROLLER AND TYPE IV CABINET SHALL INCLUDE INSTALLATION OF A PHOTOCELL AND A NEW CIRCUIT BREAKER RATED 15 AMPS FOR THE ILLUMINATED SIGNS LOAD. THE NO. 14 AWG COPPER CONDUCTORS FEEDING THE SIGNS ARE RESTRICTED TO A MAXIMUM CURRENT LOAD OF 15 AMPERES AT 75 DEGREES C.
4. THE TRAFFIC SIGNAL CONTROL EQUIPMENT SHALL BE "ECONOLITE" TO MATCH THE EXISTING SYSTEM.
5. THE SIGN CABLE SHALL BE 3/C NO. 14 WITH SOOW INSULATION, RATED AT 600V, 90° C AND MEETING UL/CSA STANDARDS.
6. ALL TRAFFIC SIGNALS SHALL BE L.E.D. (LIGHT EMITTING DIODE)
7. EXISTING FIBER OPTIC CABLE THAT WAS REMOVED DURING TEMPORARY TRAFFIC SIGNAL STAGING AND STORED IN FAR OUT HANDHOLE SHALL BE CAREFULLY REINSTALLED IN EXISTING CONDUIT TO NEW CONTROLLER.

RESTORATION OF WORK AREA: RESTORATION OF THE TRAFFIC SIGNAL WORK AREA SHALL BE INCIDENTAL TO THE RELATED PAY ITEM SUCH AS FOUNDATION, CONDUIT, HANDHOLE, TRENCH AND BACKFILL, ETC., AND NO EXTRA COMPENSATION SHALL BE ALLOWED. ALL ROADWAY SURFACES SUCH AS SHOULDERS, MEDIANS, SIDEWALKS, PAVEMENT, ETC. SHALL BE REPLACED IN KIND. ALL DAMAGE TO MOWED LAWNS SHALL BE REPLACED WITH AN APPROVED SOD, AND ALL DAMAGE TO UNMOWED FIELDS SHALL BE SEEDED IN ACCORDANCE WITH STANDARD SPECIFICATIONS 252 AND 250 RESPECTIVELY.



DESIGNED - JUF	REVISIONS
DRAWN - MAC	REVISIONS
CHECKED - TAO	REVISIONS
DATE - 10/24/11	FILE - 060670-PH2-TS-PLAN-5-RTE30.sht

**STATE OF ILLINOIS
ORCHARD DRIVE IMPROVEMENTS**

**TRAFFIC SIGNAL MODERNIZATION PLAN
U.S. ROUTE 30 (LINCOLN HWY) AND ORCHARD DRIVE**

SCALE: 1"=20'

STA. TO STA.

F.A.U. RTE.	SECTION	COUNTY	TOTAL SHEETS	SHEET NO.
2836	06-00090-00-FP	COOK	200	138
FED. ROAD DIST. NO. 1 ILLINOIS FED. AID PROJECT				CONTRACT NO. 63635
				M-80031661