

Notes:  
 See sheet 10 of 20 for Detail A.  
 Approach slab concrete shall be paid for as Concrete Superstructure.  
 Approach footing concrete shall be paid for as Concrete Structures.  
 Reinforcement shall be paid for as Reinforcement Bars, Epoxy Coated.  
 For v(E) bar details, see sheet 9 of 20.  
 The approach footing maximum applied service bearing pressure (Qmax) = 2.0 ksf.  
 For bar splicer details, see sheet 18 of 20.  
 Cost of excavation for approach footing included with Concrete Structures.  
 For Porous Granular Embankment (Special) and drainage treatment details, see sheet 2 of 20.

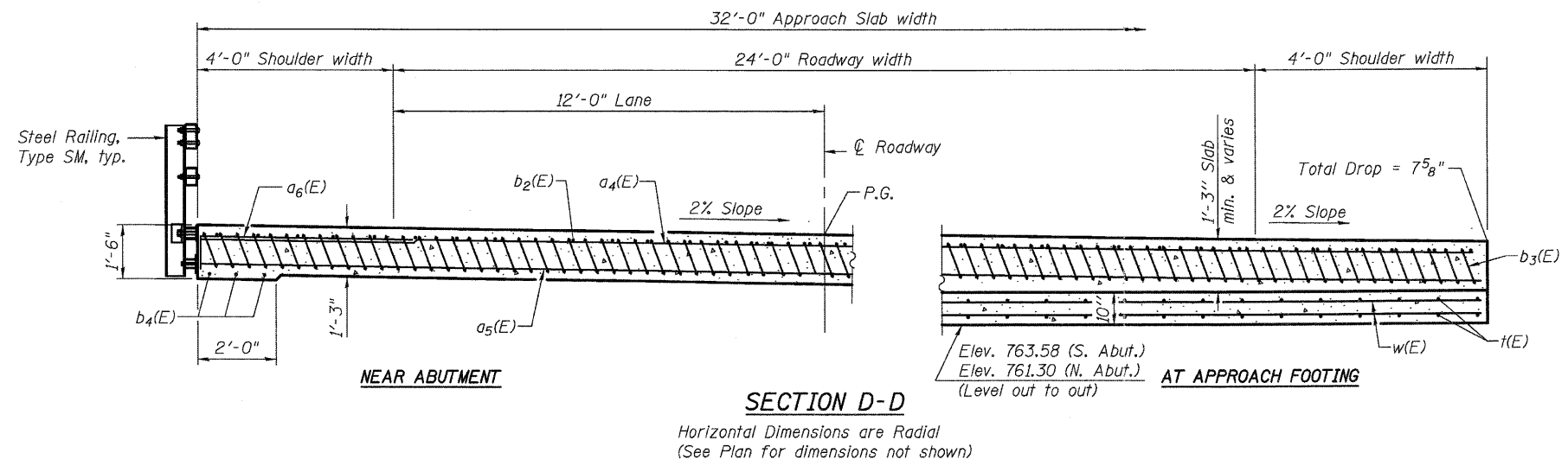

\* Tilt #9 b3(E) bars as required to maintain clearance.  
 \*\*\* Cost included with Concrete Superstructure.

**TWO APPROACHES  
 BILL OF MATERIAL**

Bar	No.	Size	Length	Shape
a4(E)	50	#4	31'-8"	—
a5(E)	92	#5	31'-8"	—
a6(E)	48	#5	7'-6"	—
b2(E)	54	#4	29'-8"	—
b3(E)	156	#9	29'-9"	—
b4(E)	12	#5	14'-8"	—
k(E)	132	#4	9'-8"	—
w(E)	80	#5	31'-8"	—
Concrete Superstructure		Cu. Yd.		97
Concrete Structures		Cu. Yd.		19.8
Bridge Deck Grooving		Sq. Yd.		213
Protective Coat		Sq. Yd.		213
Reinforcement Bars, Epoxy Coated		Pound		25,000

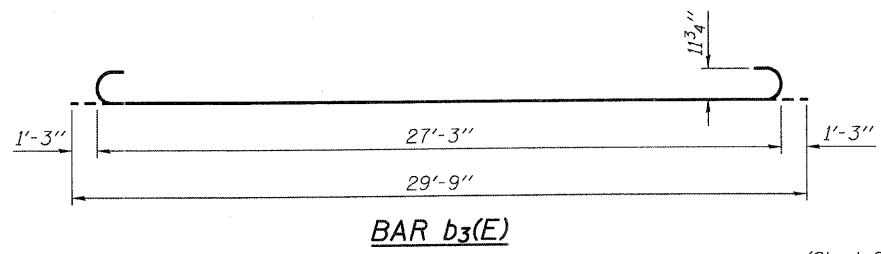
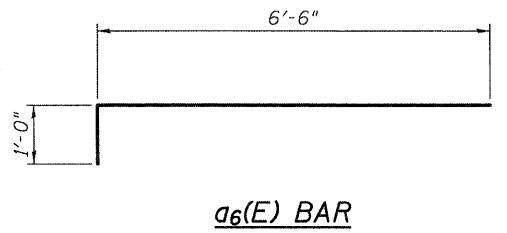

(Sheet 2 of 2)

FILE NAME = W:\Projects\2010\080225 BurrFerguson\1\Road\Structural\Draw\0453080-011-Appr\Slab2.dgn

**WILLIS BURKE KELSEY ASSOCIATES LTD.**  
 116 West Main Street, Suite 201  
 St. Charles, Illinois 60174

USER NAME = nparris	DESIGNED - HLF	REVISED -
PLOT SCALE =	CHECKED - AEU	REVISED -
PLOT DATE = 10/19/2011	DRAWN - HLF	REVISED -
	CHECKED - AEU	REVISED -

**STATE OF ILLINOIS  
 DEPARTMENT OF TRANSPORTATION**

**BRIDGE APPROACH SLAB DETAILS  
 STRUCTURE NO. 045-3080**

SHEET NO. 11 OF 20 SHEETS

T.R. RTE.	SECTION	COUNTY	TOTAL SHEETS	SHEET NO.
0194	08-14117-00-BR	KANE	76	44
FED. ROAD DIST. NO.			ILLINOIS FED. AID PROJECT	
CONTRACT NO. 63645				