

DEMOLITION PLAN NOTES

1. ALL MAILBOXES WITHIN PROJECT SHALL BE PROTECTED DURING CONSTRUCTION.
2. ALL FIRE HYDRANTS SHOWN SHALL BE PROTECTED DURING CONSTRUCTION.
3. CONTRACTOR SHALL PROVIDE AND MAINTAIN POSITIVE DRAINAGE AWAY FROM THE PROPOSED AGGREGATE SUBGRADE DURING CONSTRUCTION. THIS WORK IS CONSIDERED INCIDENTAL TO THE CONTRACT.



GRAPHIC SCALE



(IN FEET)
1 inch = 20 ft.

MATCH LINE STATION 110+50 (SEE SHEET 7)

MATCH LINE STATION 116+00 (SEE BELOW)

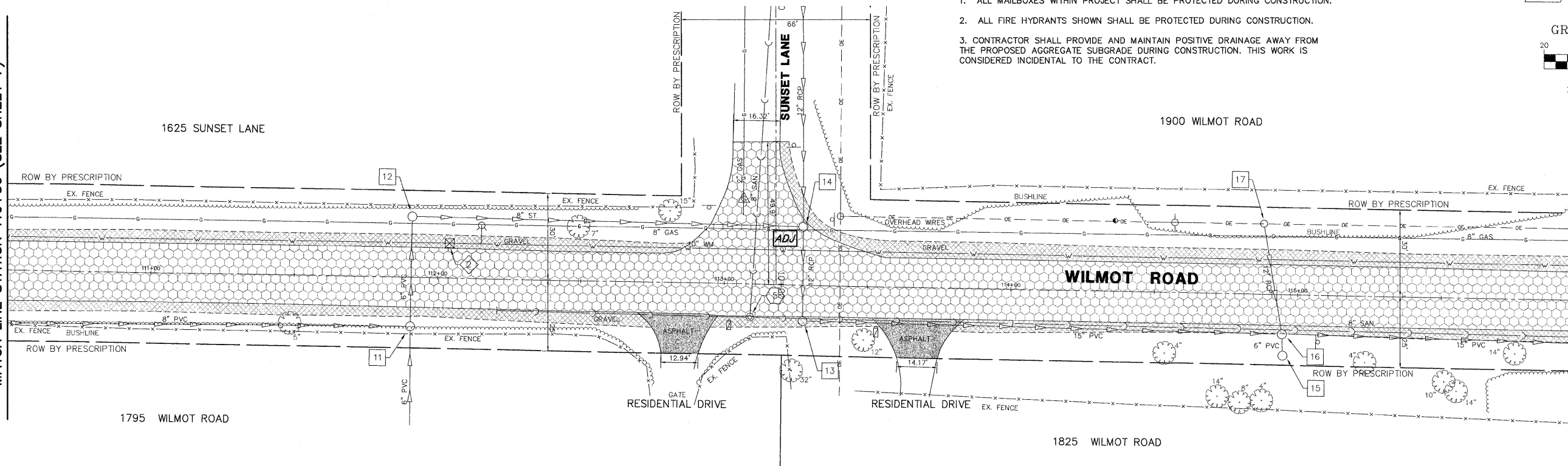

DEMOLITION CONDITIONS LEGEND

- HOT-MIX ASPHALT SURFACE REMOVAL, 2.4" 1
- DRIVEWAY PAVEMENT REMOVAL
- BRICK DRIVEWAY REMOVAL & REPLACEMENT (SPECIAL)
- EARTH EXCAVATION
- STORM STRUCTURE TO BE REMOVED
- STORM SEWER TO BE REMOVED
- PERIMETER EROSION BARRIER

MATCH LINE STATION 116+00 (SEE ABOVE)

MATCH LINE STATION 121+50 (SEE SHEET 9)

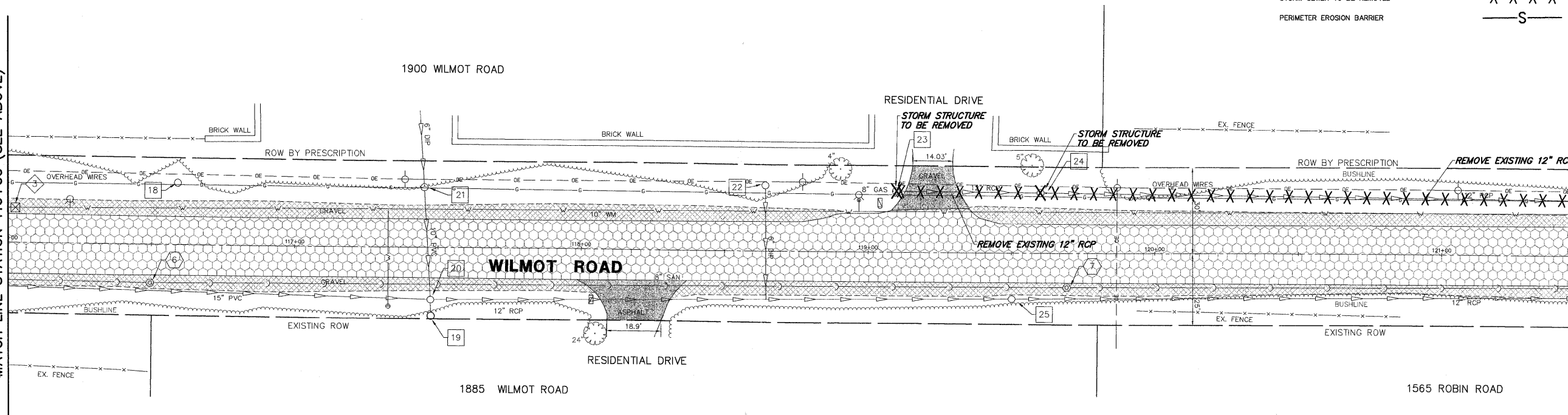

FILE NAME = 8101-055 PR4.DWG

USER NAME = GW3
PLOT SCALE = 1:1
PLOT DATE = 8/24/2011

DESIGNED - DJG
DRAWN - GW3
CHECKED - DJG
DATE - 08.24.2011

REVISED - 10.14.2011
REVISED - 10.28.2011
REVISED -
REVISED -

**STATE OF ILLINOIS
DEPARTMENT OF TRANSPORTATION**

DEMOLITION PLAN

SCALE 1"=20' SHEET NO. 8 OF 40 SHEETS STA. 110+50 TO STA. 121+50

FAU. RTE.	SECTION	COUNTY	TOTAL SHEETS	SHEET NO.
2718	11-00012-00-RS	LAKE	40	8
CONTRACT #:			63646	
ILLINOIS FED. AID PROJECT				