

MATCH LINE STATION 110+50 (SEE SHEET 12)

MATCH LINE STATION 116+00 (SEE SHEET 14)

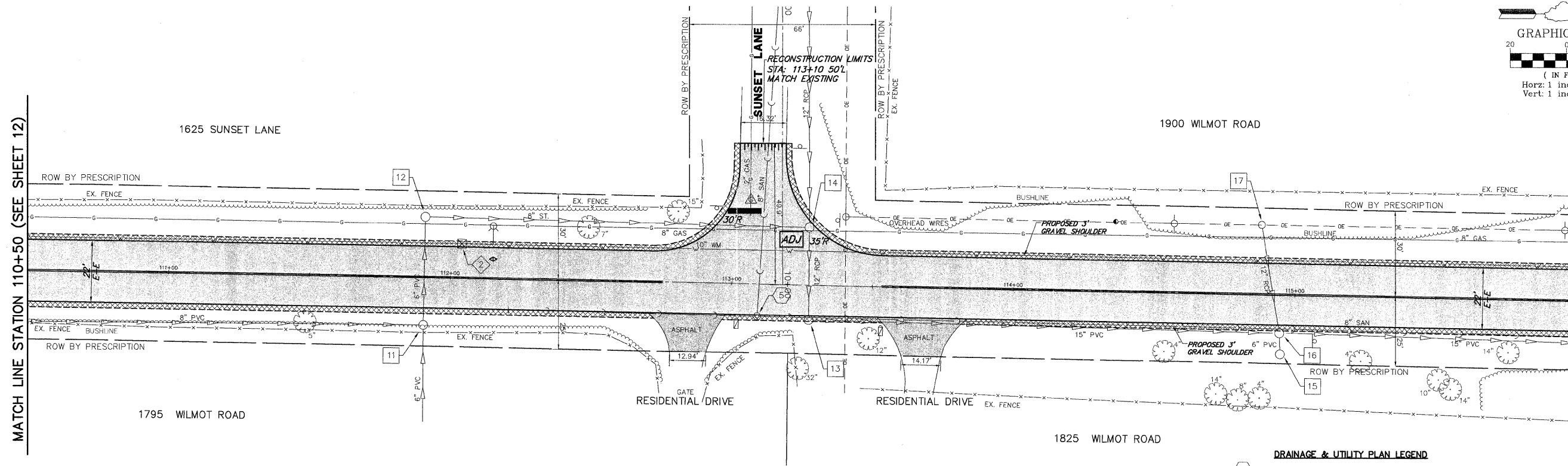

- |  |   |  |
|--|---|--|
| <p>11 EX. STORM CATCHBASIN<br/>RIM: 688.52 INV: 687.22<br/>STA: 111+91 O/S: 17.1'R</p> <p>12 EX. STORM CATCHBASIN<br/>RIM: 688.53 INV: 686.93<br/>STA: 111+91 O/S: 21.2'L</p> <p>13 EX. STORM CATCHBASIN<br/>RIM: 690.16 INV: 684.46<br/>W 12" INV: 684.96<br/>STA: 113+28 O/S: 12.5'R</p> <p>14 EX. STORM CATCHBASIN<br/>RIM: 689.71 BTM: 686.51<br/>STA: 113+27 O/S: 20.4'L<br/><b>ADJUST RIM TO: 690.10</b></p> | <p>15 EX. STORM CATCHBASIN<br/>RIM: 687.86 INV: 686.86<br/>STA: 114+95 O/S: 21.2'R</p> <p>16 EX. STORM CATCHBASIN<br/>RIM: 689.45 INV: 683.85<br/>W 12" INV: 684.10<br/>E 6" INV: 686.45<br/>STA: 114+95 O/S: 13.8'R</p> <p>17 EX. STORM CATCHBASIN<br/>RIM: 688.29 INV: 686.39<br/>STA: 114+88 O/S: 24.7'L</p> | <p>5 EXISTING SANITARY MANHOLE<br/>RIM: 690.21 INV: 678.26<br/>STA: 113+09 O/S: 11.6'R</p> <p>2 EX. W/M VALVE VAULT<br/>RIM: 689.78 T/P: UNKWN<br/>STA: 112+04 O/S: 12.2'L</p> |
|--|---|--|

- PLAN & PROFILE LEGEND**
- HOT-MIX ASPHALT SURFACE COURSE, MIX "D", N50
  - HOT-MIX DRIVEWAY PAVEMENT, 3"
  - BRICK DRIVEWAY REMOVAL & REPLACEMENT
  - AGGREGATE SHOULDERS (SPECIAL)
  - HOT-MIX ASPHALT SURFACE REMOVAL - BUTT JOINT
  - PERIMETER EROSION BARRIER

- DRAINAGE & UTILITY PLAN LEGEND**
- EXISTING SANITARY STRUCTURE
  - EXISTING SANITARY SEWER
  - EXISTING WATERMAIN STRUCTURE
  - EXISTING WATERMAIN
  - EXISTING STORM SEWER STRUCTURE
  - EXISTING STORM SEWER
  - PROPOSED STORM SEWER STRUCTURE
  - PROPOSED STORM SEWER
  - PROPOSED STORM SEWER PIPE
  - PROPOSED STORM SEWER FLARED END SECTION
  - PROPOSED STORM SEWER CATCHBASIN
  - PROPOSED STORM SEWER INLET
  - PROPOSED UTILITY CROSSING

**WILMOT ROAD**

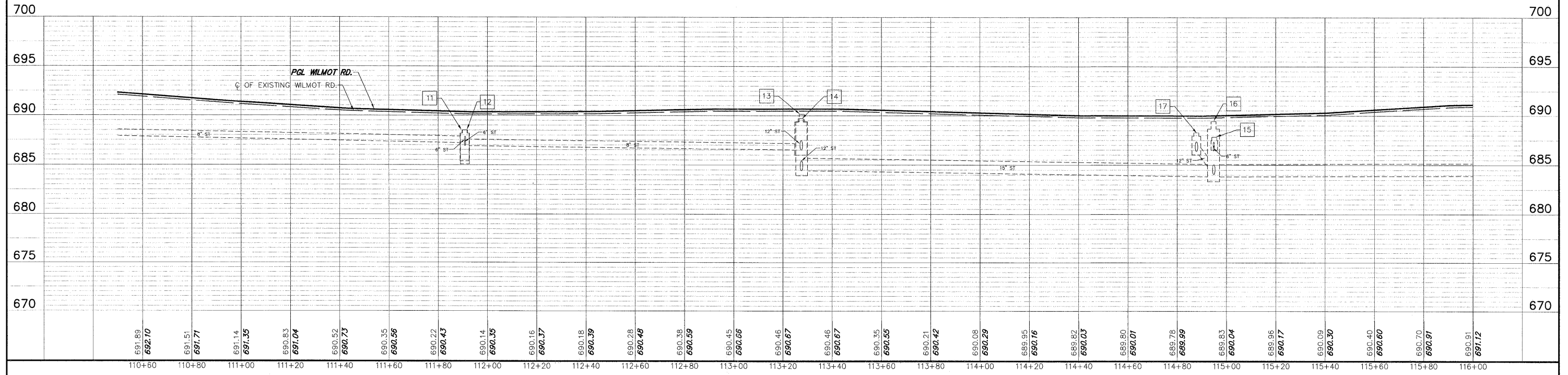

FILE NAME = 8101-055 PR4.DWG	USER NAME = GW3	DESIGNED - DJG	REVISED - 10.14.2011	<b>STATE OF ILLINOIS DEPARTMENT OF TRANSPORTATION</b>	<b>PROPOSED PLAN &amp; PROFILE</b>			FAU. RTE. 2718	SECTION 11-00012-00-RS	COUNTY LAKE	TOTAL SHEETS 40	SHEET NO. 13	
PLOT SCALE = 1:1		CHECKED - DJG	REVISED - 10.28.2011		SCALE: 1"=20'	SHEET NO. 13 OF 40 SHEETS	STA. 110+50 TO STA. 116+00	CONTRACT #: 63646		ILLINOIS FED. AID PROJECT			
PLOT DATE = 8/24/2011		DATE - 08.24.2011	REVISED -										