

- 33 EX. STORM CATCHBASIN
RIM: 684.56 INV: 682.46
STA: 127+38 O/S: 21.1'L
- 34 EX. 12" FLARED END SECTION
INV: 679.76
STA: 128+49 O/S: 25.8'R
- 35 EX. STORM CATCHBASIN
RIM: 682.56 INV: 679.96
STA: 128+48 O/S: 18.5'R
TO BE REMOVED
- 36 EX. STORM CATCHBASIN
RIM: 684.85 INV: 680.96
STA: 128+50 O/S: 17.4'L
E 15" INV: 680.96
- 37 EX. 12" FLARED END SECTION
INV: 683.37
STA: 128+51 O/S: 31.1'L

- 11 EXISTING SANITARY MANHOLE
RIM: 688.03 INV: 670.73
8" W INV: 678.63
STA: 132+05 O/S: 11.6'R
RIM TO BE ADJUSTED
- 5 EX. W/M VALVE VAULT
RIM: 686.58 T/P: 680.08
STA: 132+46 O/S: 18.3'L

- 11 STORM SEWER CATCHBASIN
TY "C" 48" TY B GRATE
WITH 9" FLAT TOP
RIM: 682.50 INV: 677.96
15" W INV: 679.88
15" S INV: 679.96
STA: 128+48 O/S: 18.5'R

- 8 36 LF 15" SS. CL. A. TY 2, @ 3.01% TBF 3.51 CY
- x8 STORM OVER SANITARY
B/STORM = 680.15
T/SANITARY = 672.85
- x9 STORM OVER WATER
B/STORM = 680.90
T/WATER = 679.50

- DRAINAGE & UTILITY PLAN LEGEND**
- 10 EXISTING SANITARY STRUCTURE
 - 10 EXISTING SANITARY SEWER
 - 10 EXISTING WATERMAIN STRUCTURE
 - 10 EXISTING WATERMAIN
 - 10 EXISTING STORM SEWER STRUCTURE
 - 10 EXISTING STORM SEWER
 - 10 PROPOSED STORM SEWER STRUCTURE
 - 10 PROPOSED STORM SEWER
 - 10 PROPOSED STORM SEWER PIPE
 - 10 PROPOSED STORM SEWER FLARED END SECTION
 - 10 PROPOSED STORM SEWER CATCHBASIN
 - 10 PROPOSED STORM SEWER INLET
 - x1 PROPOSED UTILITY CROSSING

- PLAN & PROFILE LEGEND**
- HOT-MIX ASPHALT SURFACE COURSE, MIX "D", N50
 - HOT-MIX DRIVEWAY PAVEMENT, 3"
 - BRICK DRIVEWAY REMOVAL & REPLACEMENT
 - AGGREGATE SHOULDERS (SPECIAL)
 - HOT-MIX ASPHALT SURFACE REMOVAL - BUTT JOINT
 - PERIMETER EROSION BARRIER

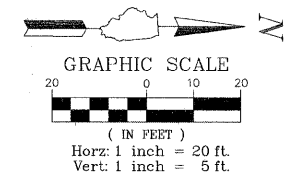

MATCH LINE STATION 127+00 (SEE SHEET 15)

MATCH LINE STATION 132+50 (SEE SHEET 17)

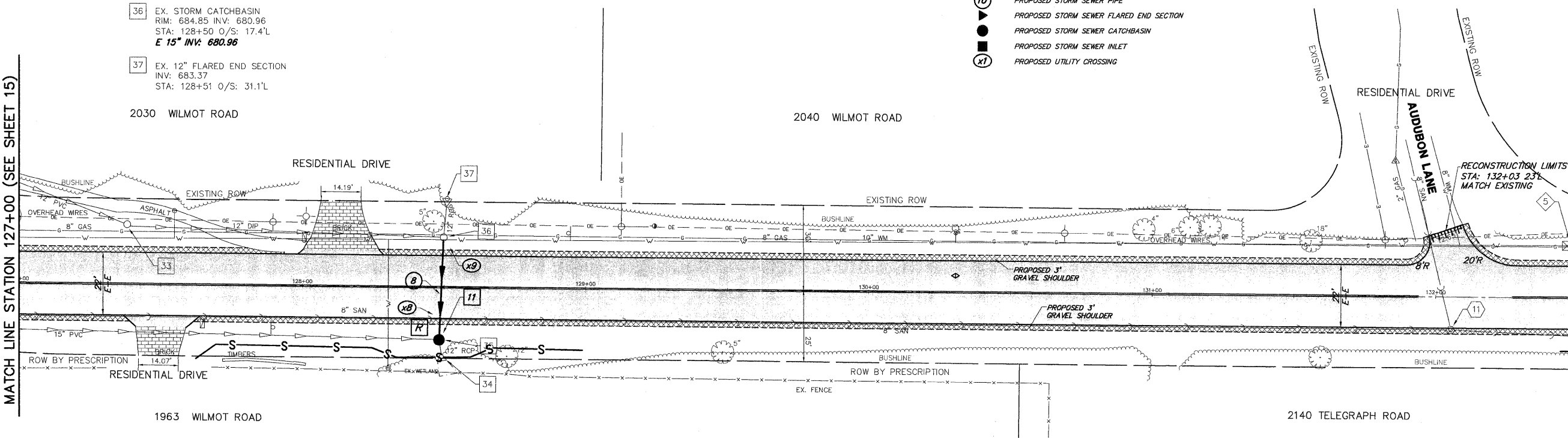

WILMOT ROAD

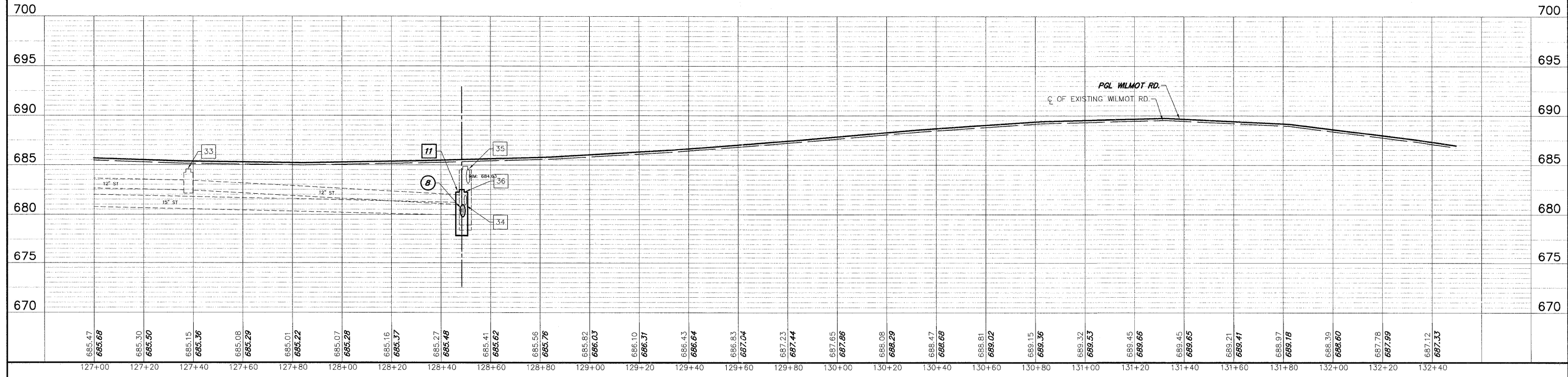

FILE NAME = 8101-055 PR4.DWG	USER NAME = GW3	DESIGNED - DJG	REVISED - 10.14.2011	STATE OF ILLINOIS DEPARTMENT OF TRANSPORTATION	PROPOSED PLAN & PROFILE			FAJ. RTE 2718	SECTION 11-00012-00-RS	COUNTY LAKE	TOTAL SHEETS 40	SHEET NO. 16
PLOT SCALE = 1:1		CHECKED - DJG	REVISED - 10.28.2011		SCALE 1"=20'			SHEET NO. 16 OF 40 SHEETS			CONTRACT # 63646	
PLOT DATE = 8/24/2011		DATE - 08.24.2011	REVISED -		STA. 127+00 TO STA. 132+50			ILLINOIS FED. AID PROJECT				
IL												