

MATCH LINE STATION 132+50 (SEE SHEET 16)

MATCH LINE STATION 138+00 (SEE SHEET 18)

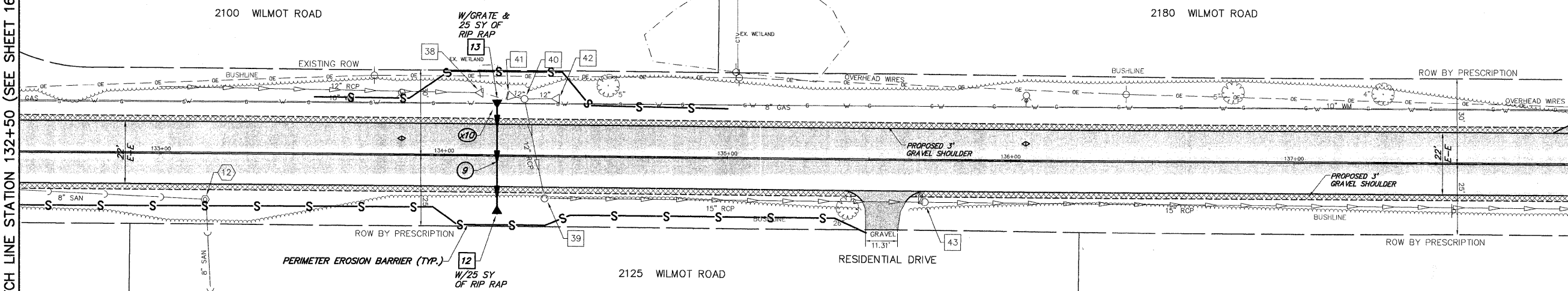

- 38 EX. 12" FLARED END SECTION  
INV: 679.85  
STA: 134+14 O/S: 22.1'L
- 39 EX. STORM CATCHBASIN  
RIM: 681.31 INV: 678.11  
STA: 134+36 O/S: 15.0'R
- 40 EX. STORM CATCHBASIN  
RIM: 680.39 INV: 678.59  
STA: 134+28 O/S: 20.0'L
- 41 EX. 12" FLARED END SECTION  
INV: 679.46  
STA: 134+22 O/S: 21.2'L
- 42 EX. 12" FLARED END SECTION  
INV: 679.60  
STA: 134+40 O/S: 20.2'L
- 43 EX. STORM CATCHBASIN  
RIM: 682.65 INV: 677.65  
STA: 135+70 O/S: 14.9'R
- 12 EXISTING SANITARY MANHOLE  
RIM: 684.03 INV: 670.33  
STA: 133+16 O/S: 16.2'R
- 12 FLARED END SECTION  
24" RCP INV: 678.60  
STA: 134+19 O/S: 20.5'R
- 13 FLARED END SECTION  
24" RCP INV: 679.00  
STA: 134+19 O/S: 19.5'R
- 9 40 LF 24" SS, CL. A, TY 2, @ 1.00%, TBF 13.24 CY
- x10 STORM OVER WATER  
B/STORM = 679.00  
T/WATER = 675.80

### WILMOT ROAD

- DRAINAGE & UTILITY PLAN LEGEND**

  - (10) EXISTING SANITARY STRUCTURE
  - (10) EXISTING SANITARY SEWER
  - (10) EXISTING WATERMAIN STRUCTURE
  - W EXISTING WATERMAIN
  - (10) EXISTING STORM SEWER STRUCTURE
  - (10) EXISTING STORM SEWER
  - (10) PROPOSED STORM SEWER STRUCTURE
  - (10) PROPOSED STORM SEWER
  - (10) PROPOSED STORM SEWER PIPE
  - (10) PROPOSED STORM SEWER FLARED END SECTION
  - (10) PROPOSED STORM SEWER CATCHBASIN
  - (10) PROPOSED STORM SEWER INLET
  - (x1) PROPOSED UTILITY CROSSING

**PLAN & PROFILE LEGEND**

  - [Pattern] HOT-MIX ASPHALT SURFACE COURSE, MIX "D", N50
  - [Pattern] HOT-MIX DRIVEWAY PAVEMENT, 3"
  - [Pattern] BRICK DRIVEWAY REMOVAL & REPLACEMENT
  - [Pattern] AGGREGATE SHOULDERS (SPECIAL)
  - [Pattern] HOT-MIX ASPHALT SURFACE REMOVAL - BUTT JOINT
  - [Symbol] PERIMETER EROSION BARRIER

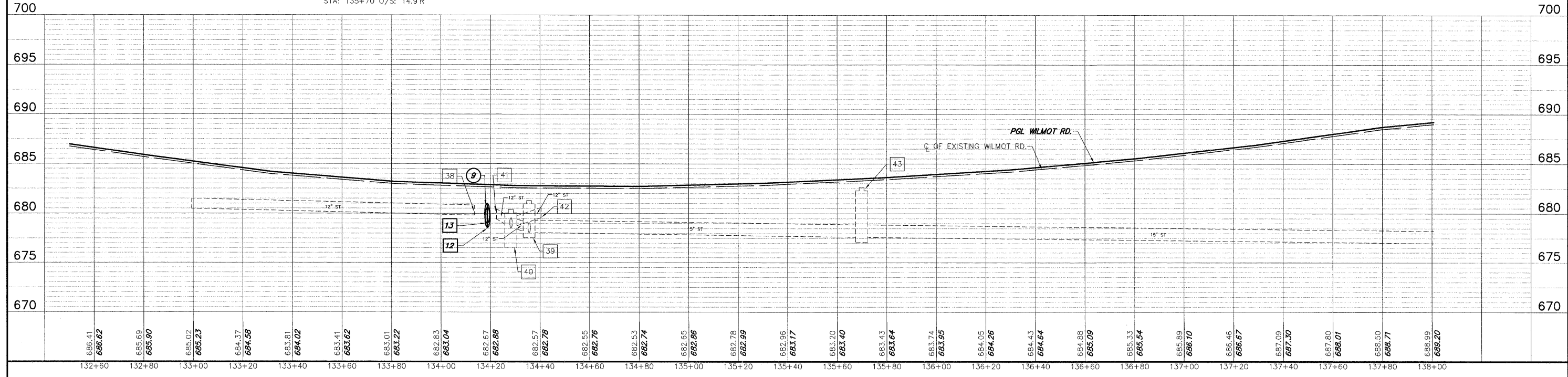

FILE NAME = 8101-055 PR4.DWG	USER NAME = GW3	DESIGNED - DJG	REVISED - 10.14.2011	<b>STATE OF ILLINOIS DEPARTMENT OF TRANSPORTATION</b>	<b>PROPOSED PLAN &amp; PROFILE</b>			FAU RTE 2718	SECTION 11-00012-00-RS	COUNTY LAKE	TOTAL SHEETS 40	SHEET NO. 17
PLOT SCALE = 1:1		DRAWN - GW3	REVISED - 10.28.2011		SCALE 1"=20'			SHEET NO. 17 OF 40 SHEETS			CONTRACT # 63646	
PLOT DATE = 8/24/2011		CHECKED - DJG	REVISED -		STA. 132+50 TO STA. 138+00			ILLINOIS FED. AID PROJECT				
		DATE - 08.24.2011	REVISED -									