

MATCH LINE STATION 138+00 (SEE SHEET 17)

- 44 EX. STORM CATCHBASIN  
RIM: 688.48 INV: 676.98  
STA: 138+09 O/S: 15.7'R
- 45 EX. STORM CATCHBASIN  
RIM: 685.55 INV: 683.75  
SW 10" INV: 684.25  
STA: 140+21 O/S: 16.7'L
- 46 EX. 15" END SECTION  
INV: 683.23  
STA: 141+28 O/S: 17.5'L
- 47 EX. 15" END SECTION  
INV: 682.99
- 48 EX. STORM CATCHBASIN  
RIM: 683.87 INV: 681.02
- 49 EX. STORM MANHOLE  
RIM: 684.68 INV: 675.50  
SE 12" INV: 679.63
- 13 EXISTING SANITARY MANHOLE  
RIM: 684.50 INV: 672.90
- 14 EXISTING SANITARY MANHOLE  
RIM: 683.90 INV: 667.31
- 15 EXISTING SANITARY MANHOLE  
RIM: 684.83 INV: 667.03  
8" SW INV: 667.13  
8" NW INV: 668.68
- 16 EXISTING SANITARY MANHOLE  
RIM: 681.64 INV: 667.54
- 17 EXISTING SANITARY MANHOLE  
RIM: 682.52 INV: 667.37
- 18 EXISTING SANITARY MANHOLE  
RIM: 684.53 INV: 676.38

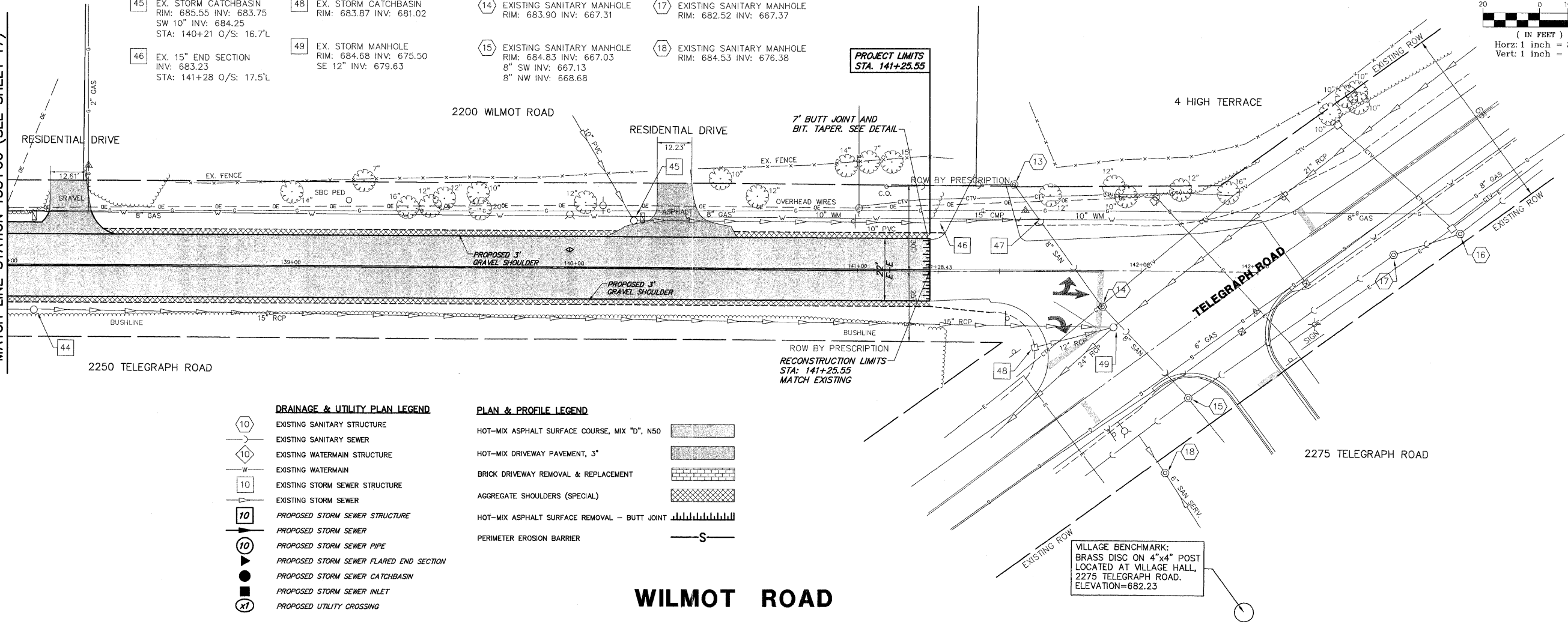
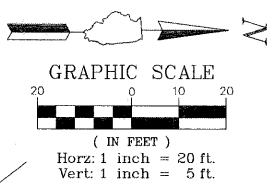

- | DRAINAGE & UTILITY PLAN LEGEND |   | PLAN & PROFILE LEGEND |  |
|--------------------------------|---|-----------------------|--|
|                                | EXISTING SANITARY STRUCTURE             |                       | HOT-MIX ASPHALT SURFACE COURSE, MIX "D", N50 |
|                                | EXISTING SANITARY SEWER                 |                       | HOT-MIX DRIVEWAY PAVEMENT, 3"                |
|                                | EXISTING WATERMAIN                      |                       | BRICK DRIVEWAY REMOVAL & REPLACEMENT         |
|                                | EXISTING STORM SEWER STRUCTURE          |                       | AGGREGATE SHOULDERS (SPECIAL)                |
|                                | EXISTING STORM SEWER                    |                       | HOT-MIX ASPHALT SURFACE REMOVAL - BUTT JOINT |
|                                | PROPOSED STORM SEWER STRUCTURE          |                       | PERIMETER EROSION BARRIER                    |
|                                | PROPOSED STORM SEWER PIPE               |                       |  |
|                                | PROPOSED STORM SEWER FLARED END SECTION |                       |  |
|                                | PROPOSED STORM SEWER CATCHBASIN         |                       |  |
|                                | PROPOSED STORM SEWER INLET              |                       |  |
|                                | PROPOSED UTILITY CROSSING               |                       |  |

**WILMOT ROAD**

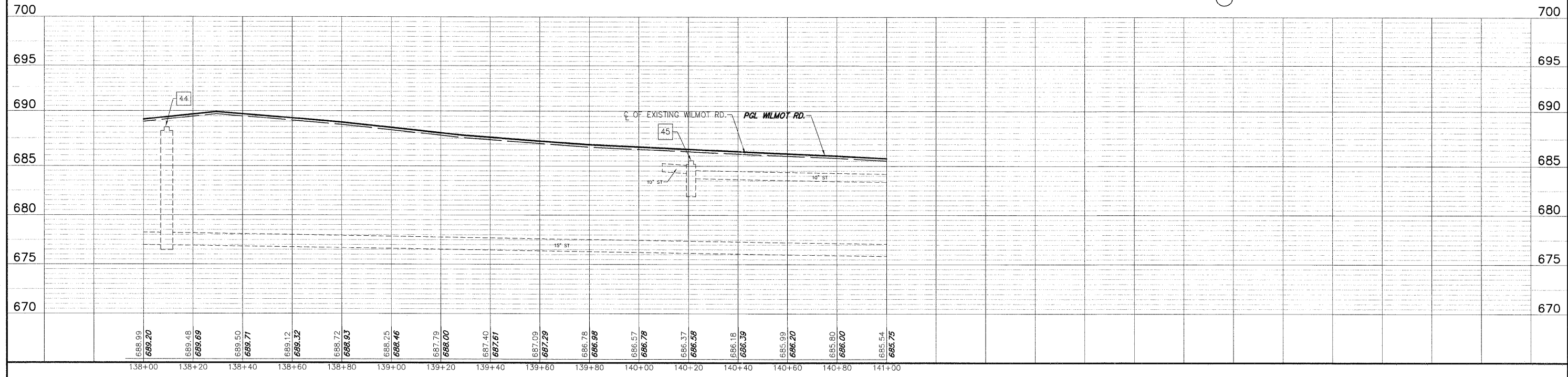

FILE NAME = 8101-055 PR4.DWG	USER NAME = GW3	DESIGNED - DJG	REVISED - 10.14.2011	<b>STATE OF ILLINOIS DEPARTMENT OF TRANSPORTATION</b>	<b>PROPOSED PLAN &amp; PROFILE</b>			FAU. RTE	SECTION	COUNTY	TOTAL SHEETS	SHEET NO.	
	PLOT SCALE = 1:1	DRAWN - GW3	REVISED - 10.28.2011		SCALE: 1"=20'	SHEET NO. 18 OF 40 SHEETS	STA. 138+00 TO STA. 141+25.55	2718	11-00012-00-RS	LAKE	40	18	
	PLOT DATE = 8/24/2011	CHECKED - DJG	REVISED -										
		DATE - 08.24.2011	REVISED -										CONTRACT #: 63646
ILLINOIS FED. AID PROJECT													