

I-90 INSIDE SHOULDER WARPING				
STATION	EOS ELEVATION AT BARRIER	SHOULDER CROSS SLOPE	LONGITUDINAL EOS SLOPE	DESCRIPTION
LOCATION 1 - EB & WB SHOULDERS				
65+88.00	774.56	0.04	-0.0035	BEGIN WARPING
66+00.00	774.51	0.0417		
66+44.25	774.36	0.05		LOW POINT
67+00.00	774.55	0.0409		
67+10.00	774.59	0.04	0.0035	END WARPING
LOCATION 2 - EB & WB SHOULDERS				
80+00.00	780.96	0.04	0.0046	BEGIN WARPING
80+73.05	781.29	0.02		HIGH POINT
81+00.00	781.17	0.0296		
81+55.00	780.93	0.04	-0.0044	END WARPING
LOCATION 3 - EB & WB SHOULDERS				
91+90.00	777.62	0.04	-0.0035	BEGIN WARPING
92+00.00	777.58	0.0409		
92+50.95	777.41	0.05		LOW POINT
93+00.00	777.58	0.04		
93+10.00	777.61	0.04	0.0035	END WARPING
LOCATION 4 - WB SHOULDERS				
119+35.00	785.75	0.04	0.0037	BEGIN WARPING
120+00.00	785.99	0.0313		
120+42.03	786.15	0.02		HIGH POINT
121+00.00	785.93	0.0348		
121+45.00	785.76	0.04	-0.0037	END WARPING
LOCATION 4 - WB SHOULDERS				
119+35.00	785.75	0.04	0.0037	BEGIN WARPING
120+42.03	786.14	0.02		HIGH POINT
121+00.00	785.92	0.0348		
121+45.00	785.75	0.04	-0.0038	END WARPING

DEE DEE PLANKEY

DEE DEE PLANKEY

SN 101-0001 & SN 101-0002 TO BE REMOVED AND REPLACED

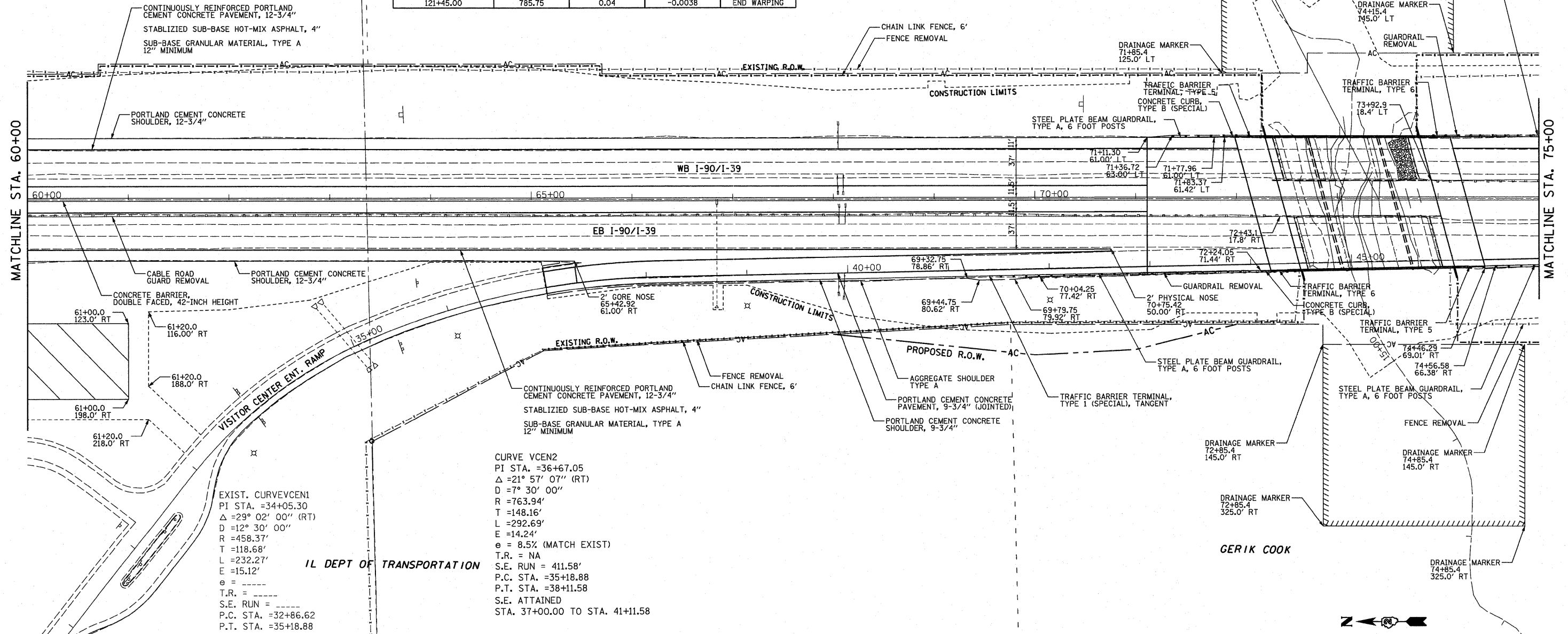

CURVE VCEN2  
 PI STA. =36+67.05  
 $\Delta = 21^\circ 57' 07''$  (RT)  
 $D = 7^\circ 30' 00''$   
 $R = 763.94'$   
 $T = 148.16'$   
 $L = 292.69'$   
 $E = 14.24'$   
 $e = 8.5\%$  (MATCH EXIST)  
 $T.R. = NA$   
 $S.E. RUN = 411.58'$   
 $P.C. STA. = 35+18.88$   
 $P.T. STA. = 38+11.58$   
 $S.E. ATTAINED$   
 STA. 37+00.00 TO STA. 41+11.58

EXIST. CURVE VCEN1  
 PI STA. =34+05.30  
 $\Delta = 29^\circ 02' 00''$  (RT)  
 $D = 12^\circ 30' 00''$   
 $R = 458.37'$   
 $T = 118.68'$   
 $L = 232.27'$   
 $E = 15.12'$   
 $e =$   
 $T.R. =$   
 $S.E. RUN =$   
 $P.C. STA. = 32+86.62$   
 $P.T. STA. = 35+18.88$

IL DEPT OF TRANSPORTATION

EMBANKMENT STORAGE AREA  
 (EMBANKMENT MATERIAL GENERATED FROM STAGE 1 WORK TO BE USED IN STAGE 2)

GERIK COOK

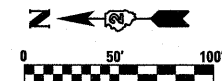

Rev. 1-9-12 1" = 50'



USER NAME = USERNAME  
 FILE NAME = #FILE#  
 PLOT SCALE = 50.0000' / IN.  
 PLOT DATE = 12/9/2011

DESIGNED -  
 DRAWN - BSL  
 CHECKED - PDS  
 DATE - 10-21-2011

REVISED -  
 REVISED -  
 REVISED -  
 REVISED -

STATE OF ILLINOIS  
 DEPARTMENT OF TRANSPORTATION

PLAN SHEETS - I-90

SCALE: N/A SHEET NO. OF SHEETS STA. 60+00 TO STA. 75+00

F.A. RTE.	SECTION	COUNTY	TOTAL SHEETS	SHEET NO.
90	(X2-1) R	WINNEBAGO	510	83
CONTRACT NO. 64C29				
ILLINOIS FED. AID PROJECT				