

DATE	
BY	
FINAL SURVEY	
PLOTTED	
NOTE BOOK	
AREAS CHECKED	

DATE	
BY	
ORIGINAL SURVEY	
PLOTTED	
NOTE BOOK	
AREAS CHECKED	

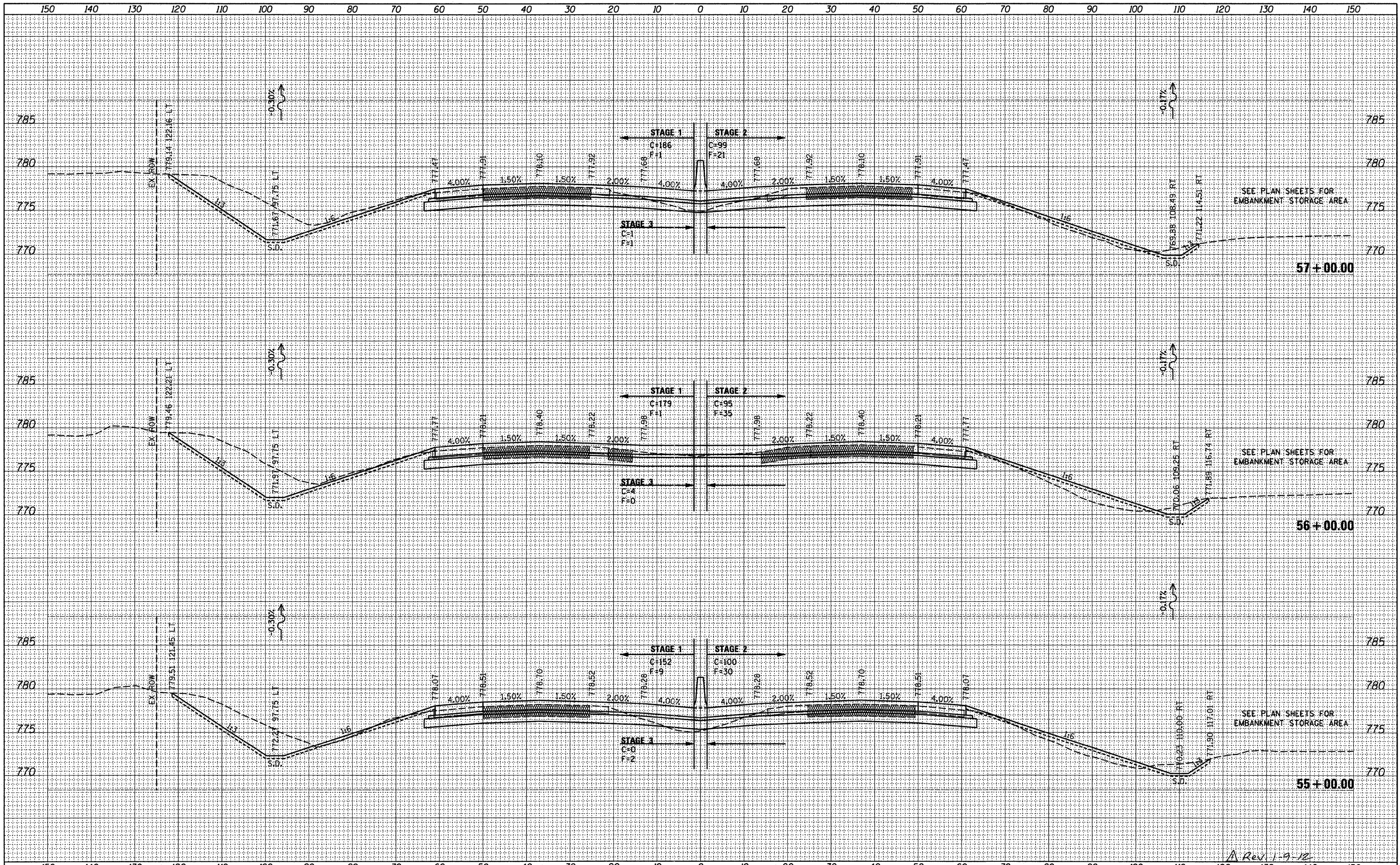

A Rev. 1-9-12

**McClure**  
Engineering & Consultants  
INCORPORATED, A CORP. OF ILLINOIS

**LOCHNER**  
Engineering & Consultants  
INCORPORATED, A CORP. OF ILLINOIS

**RWA**  
Engineering & Consultants  
INCORPORATED, A CORP. OF ILLINOIS

**QEI**  
Engineering & Consultants  
INCORPORATED, A CORP. OF ILLINOIS

USER NAME =	USERNAME	DESIGNED -	REVISED -
FILE NAME =	FILE	DRAWN -	REVISED -
PLLOT SCALE =	10.0000' / IN.	CHECKED -	REVISED -
PLLOT DATE =	12/27/2011	DATE -	10-21-2011

**STATE OF ILLINOIS**  
**DEPARTMENT OF TRANSPORTATION**

<b>I-90 CROSS SECTIONS</b>			
SCALE: H <sub>v</sub> 1"=10'	SHEET NO.	OF	SHEETS
			STA. 55+00.00 TO STA. 57+00.00

F.A. RTE.	SECTION	COUNTY	TOTAL SHEETS	SHEET NO.
90	(X2-1) R	WINNEBAGO	510	433
				CONTRACT NO. 64C29
				ILLINOIS FED. AID PROJECT