

DATE	
BY	
FINAL SURVEY	
PLOTTED	
NOTE BOOK	
AREAS CHECKED	

DATE	
BY	
ORIGINAL SURVEY	
PLOTTED	
NOTE BOOK	
AREAS CHECKED	

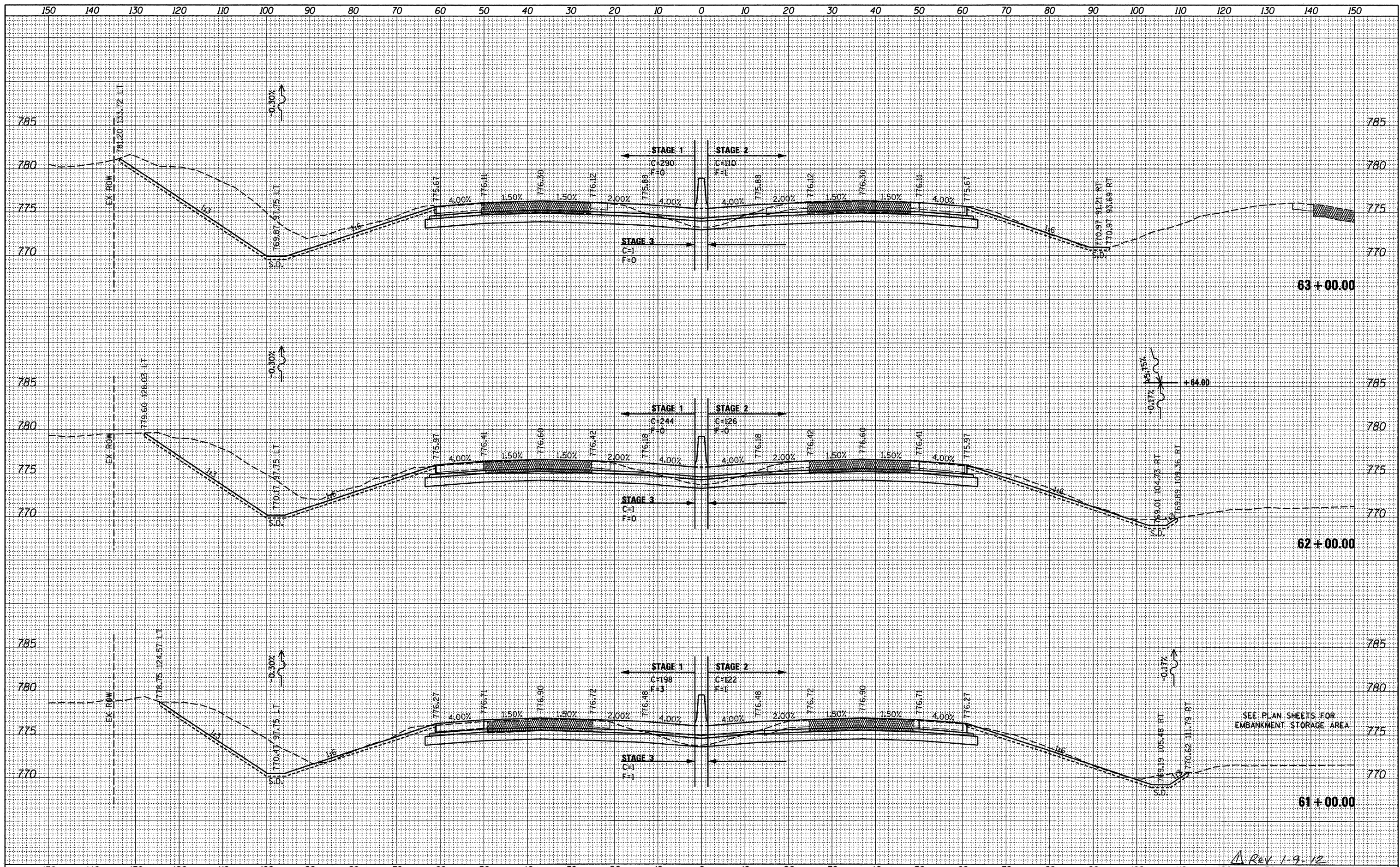

McClure
Engineering Associates, Inc.

LOCHNER
INCORPORATED, INC. CIVIL ENGINEERS

RWA
REGISTERED PROFESSIONAL ENGINEER

QEI
QUALITY ENGINEERING INC.

USER NAME = USERNAME	DESIGNED -	REVISED -
FILE NAME = *FILE*	DRAWN - BSL	REVISED -
PLOT SCALE = 10.0000' / IN.	CHECKED - PDS	REVISED -
PLOT DATE = 12/27/2011	DATE - 10-21-2011	REVISED -

STATE OF ILLINOIS
DEPARTMENT OF TRANSPORTATION

I-90 CROSS SECTIONS	
SCALE: H: 1"=10'	V: 1"=2'
SHEET NO. OF SHEETS	STA. 61+00.00 TO STA. 63+00.00

F.A. RTE.	SECTION	COUNTY	TOTAL SHEETS	SHEET NO.
90	(X2-1) R	WINNEBAGO	510	435
CONTRACT NO. 64C29			ILLINOIS FED. AID PROJECT	

A Rev 1-9-12