

Notes:  
See sheet 15 of 26 for Sections C-C & D-D and View E-E.  
a<sub>50</sub>(E), a<sub>51</sub>(E), a<sub>53</sub>(E) and a<sub>54</sub>(E) bar spacings measured along  
℄ Rdwy.

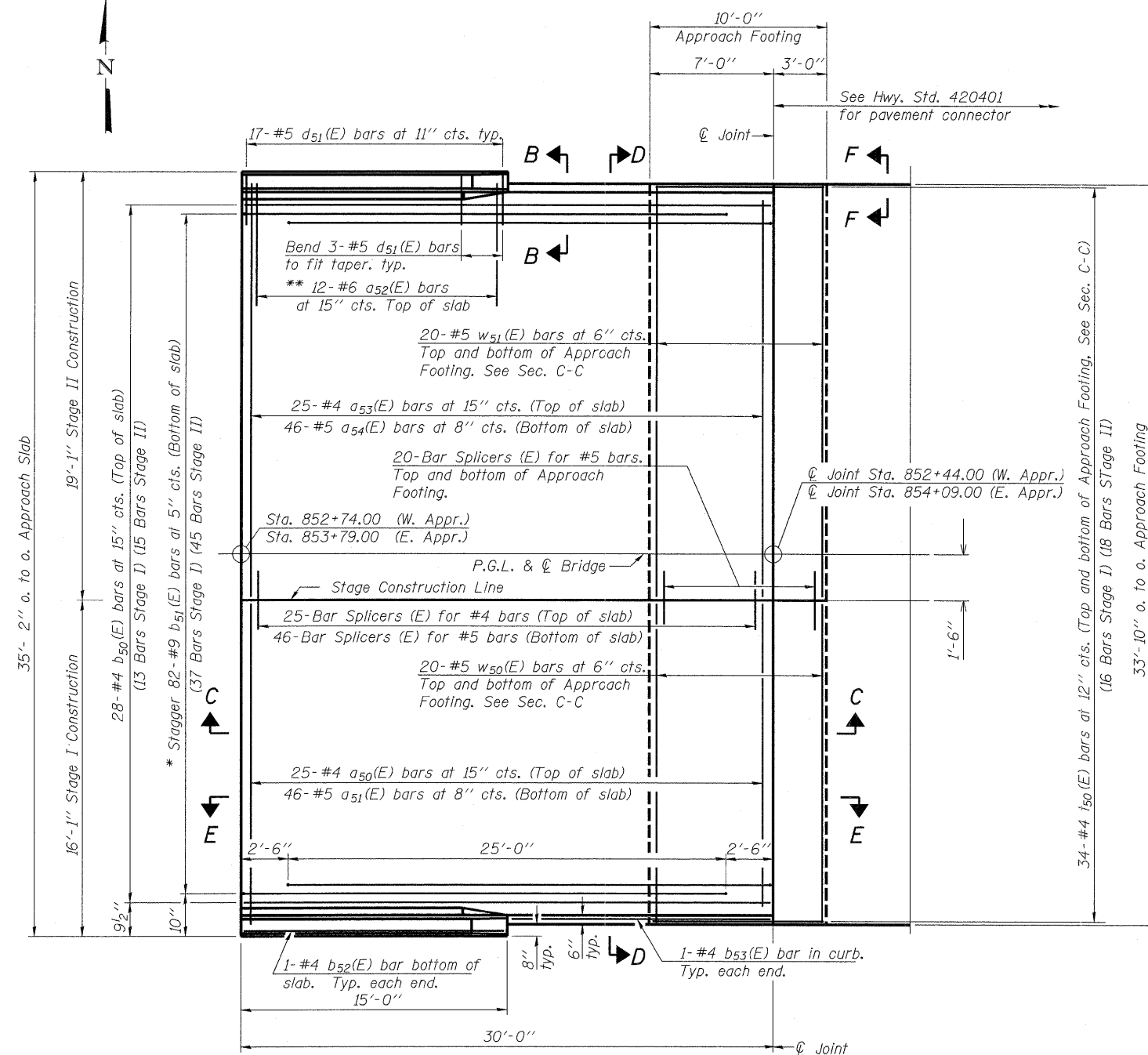

**PLAN**

East approach shown.  
West approach similar, opposite hand.

\* Tilt #9 b<sub>51</sub>(E) bars as required to maintain clearance.  
\*\* Space between a<sub>50</sub>(E) and a<sub>53</sub>(E) bars, typ. ea. parapet.

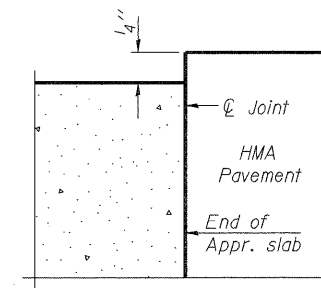

**FLEXIBLE PAVEMENT**

**DETAIL A**

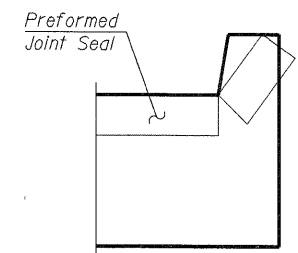

**VIEW F-F**

Angle Preformed Joint Seal at 45°  
at curbs when req'd for drainage.

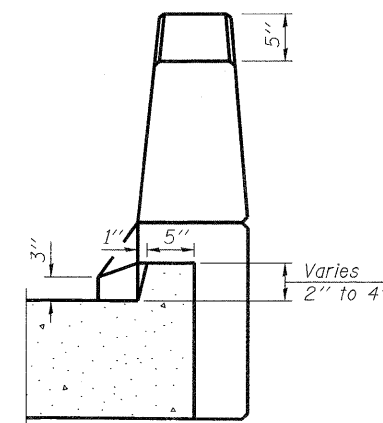

**VIEW B-B**

BA-0

7-1-10

(Sheet 1 of 2)

	USER NAME = kkhan	DESIGNED - SK	REVISED -	<b>STATE OF ILLINOIS DEPARTMENT OF TRANSPORTATION</b>	<b>BRIDGE APPROACH SLAB DETAILS-1 STRUCTURE NO. 006-0183</b>	F.A.P. RTE. 587	SECTION (22 BRIBR)	COUNTY	TOTAL SHEETS 61	SHEET NO. 30
	PLOT SCALE =	CHECKED - GBC/SMK	REVISED -			BUREAU	CONTRACT NO. 66995			
	PLOT DATE = 10/11/2011	DRAWN - SK	REVISED -	SHEET NO. 14 OF 26 SHEETS		ILLINOIS FED. AID PROJECT				