

INDEX OF SHEETS

1. COVER SHEET
2. GENERAL NOTES
3. SUMMARY OF QUANTITIES
- 4.-10. INTERSECTION LOCATION MAPS
- 11-12. SCHEDULE OF QUANTITIES
13. CABLE PLAN (US 6 (FOURTH ST.) & PEORIA ST.)
14. CABLE PLAN (US 6 (FOURTH ST.) & WEST ST.)

HIGHWAY STANDARDS

- 00001-06 STANDARD SYMBOLS, ABBREVIATIONS AND PATTERNS
- 701001-02 OFF-ROAD OPERATIONS, 2L, 2W, MORE THAN 15' (4.5 m) AWAY
- 701006-03 OFF-ROAD OPERATIONS, 2L, 2W, 15' (4.5 m) TO 24" (600 mm) FROM PAVEMENT EDGE
- 701011-02 OFF-ROAD MOVING OPERATIONS, 2L, 2W, DAY ONLY
- 701101-02 OFF-ROAD OPERATIONS, MULTILANE, 15' (4.5 m) TO 24" (600 mm) FROM PAVEMENT EDGE
- 701106-02 OFF-ROAD OPERATIONS, MULTILANE, MORE THAN 15' (4.5 m) AWAY
- 701501-06 URBAN LANE CLOSURE, 2L, 2W, UNDIVIDED
- 701502-04 URBAN LANE CLOSURE, 2L, 2W, WITH BIDIRECTIONAL LEFT TURN LANE
- 701601-07 URBAN LANE CLOSURE, MULTILANE, 1W OR 2W WITH NONTRAVERSABLE MEDIAN
- 701901-02 TRAFFIC CONTROL DEVICES
- 862001-01 UNINTERRUPTABLE POWER SUPPLY (UPS)
- 880006-01 TRAFFIC SIGNAL MOUNTING DETAILS

STATE OF ILLINOIS
DEPARTMENT OF TRANSPORTATION
DIVISION OF HIGHWAYS

PROPOSED
HIGHWAY PLANS

VARIOUS ROUTES
SECTION D-3 LED RETROFIT 2012-2

BUREAU & LASALLE COUNTIES
C-93-140-11

F.A. RTE.	SECTION	COUNTY	TOTAL SHEETS	SHEET NO.
D-3	LED RETROFIT 2012-2	ILLINOIS	14	1
FED. ROAD DIST. NO. ...		CONTRACT NO. 66B55		

BUREAU & LASALLE

D-93-090-11

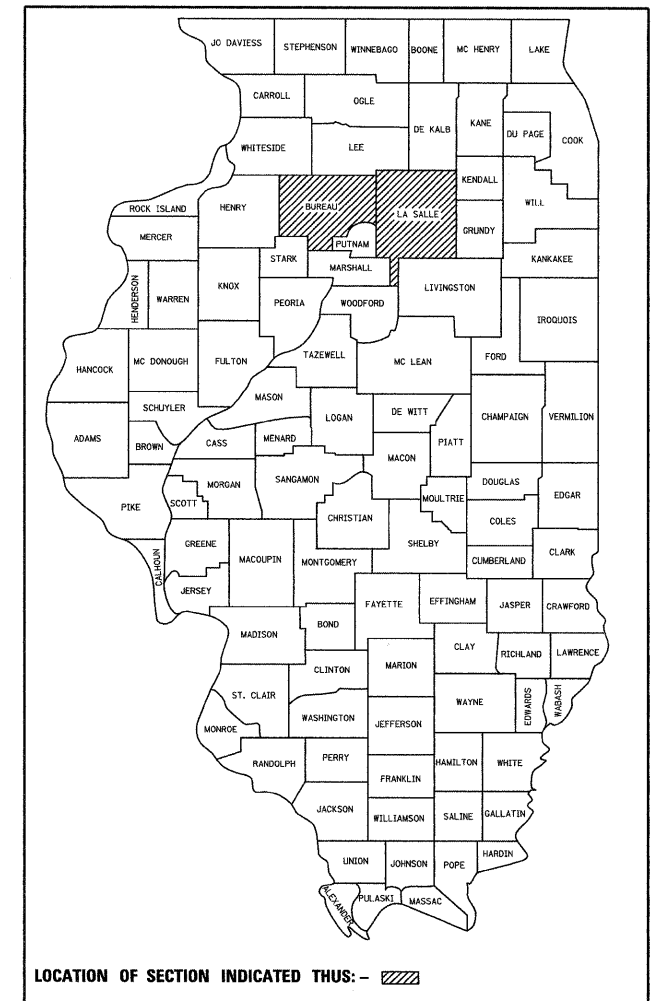

CITIES

- PRINCETON
- SPRING VALLEY
- LASALLE
- MENDOTA
- OTTAWA
- PERU
- STREATOR

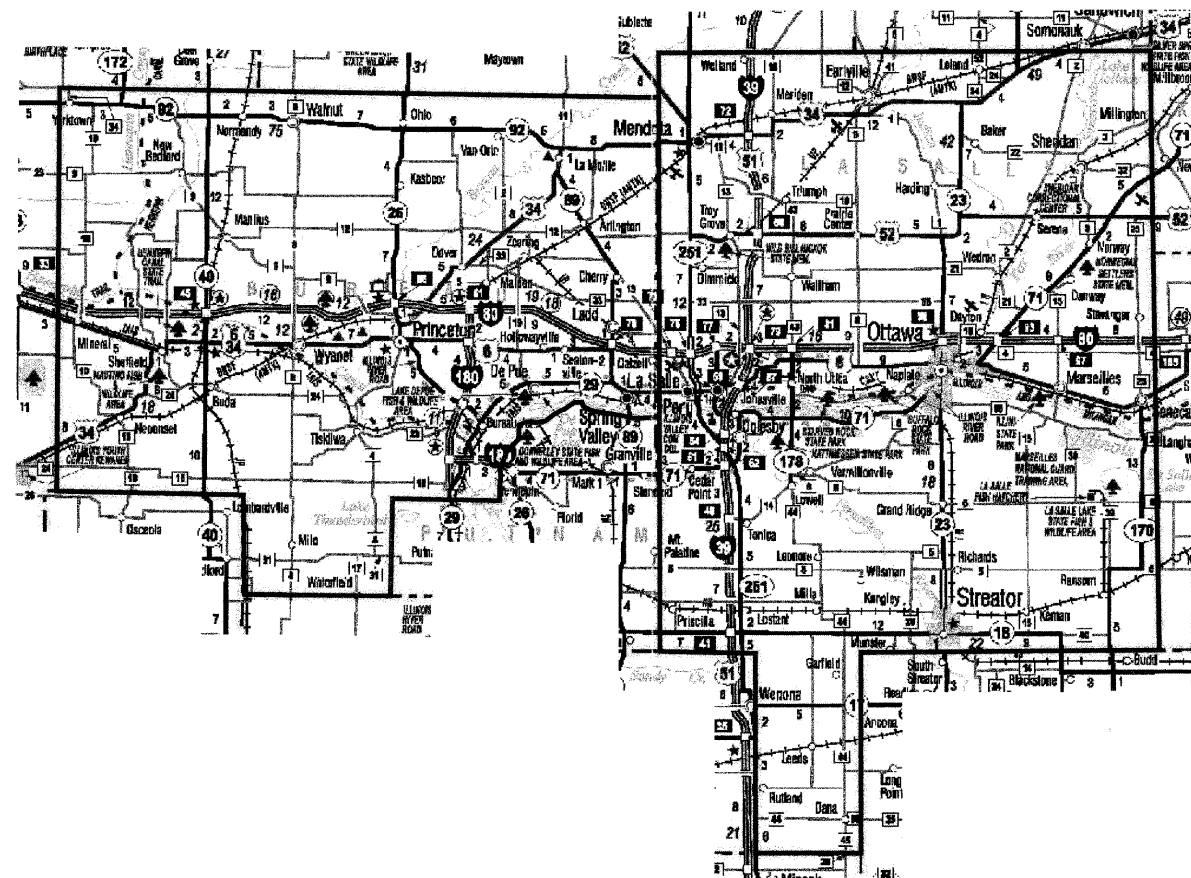

LOCATION MAP

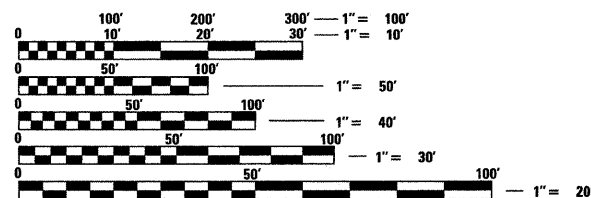
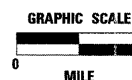

FULL SIZE PLANS HAVE BEEN PREPARED USING STANDARD ENGINEERING SCALES. REDUCED SIZED PLANS WILL NOT CONFORM TO STANDARD SCALES. IN MAKING MEASUREMENTS ON REDUCED PLANS, THE ABOVE SCALES MAY BE USED.

J.U.L.I.E.
JOINT UTILITY LOCATION INFORMATION FOR EXCAVATION
1-800-892-0123
OR 811

PROJECT ENGINEER: TOM HUFNAGEL, P.E.
UNIT CHIEF: DAN DEVINE, P.E.

CONTRACT NO. 66B55

10/27/11
date



signature

PROFESSIONAL DESIGN FIRM
LICENSE NO. 154-001717

CHAMLIN ASSOCIATES
PERU ILLINOIS MORRIS

STATE OF ILLINOIS
DEPARTMENT OF TRANSPORTATION
DIVISION OF HIGHWAYS

SUBMITTED 10-28 2011

Eric J. [Signature]
DEPUTY DIRECTOR OF HIGHWAYS, REGION ENGINEER

December 9 2011
Scott E. Stittler, Jr.
acting ENGINEER OF DESIGN AND ENVIRONMENT

December 9 2011
William B. Fleury
DIRECTOR OF HIGHWAYS, CHIEF ENGINEER

PRINTED BY THE AUTHORITY
OF THE STATE OF ILLINOIS

TRAFFIC SIGNAL GENERAL NOTES

- THE CONTRACTOR SHALL CONTACT THE APPROPRIATE CITY A MINIMUM OF 72 HOURS PRIOR TO BEGINNING WORK.
 - PRINCETON 815-875-2631
 - SPRING VALLEY 815-664-4221
 - LASALLE 815-223-7041
 - MENDOTA 815-539-7459
 - OTTAWA 815-431-1579, EXT. 20
 - PERU 815-223-0061
 - STREATOR 815-672-2517
- THE TRAFFIC SIGNAL SECTION AT THE ILLINOIS DEPARTMENT OF TRANSPORTATION, DISTRICT 3, SHALL BE NOTIFIED AT 815-434-8506 AT LEAST 72 HOURS PRIOR TO TURNING ON ANY FLASHER OR CONTROLLER UNITS.
- THE CONTRACTOR SHALL BE RESPONSIBLE FOR PROTECTING UTILITY PROPERTY DURING CONSTRUCTION OPERATIONS AS OUTLINED IN ARTICLE 107.31 OF THE STANDARD SPECIFICATIONS. A MINIMUM OF 48 HOURS ADVANCED NOTICE IS REQUIRED FOR NON-EMERGENCY WORK. THE JULIE NUMBER IS 800-892-0123.
- ALL TRAFFIC CONTROL AND OTHER ADVISORY SIGNS NEEDED FOR CONSTRUCTION ARE TO BE FURNISHED BY THE CONTRACTOR IN ACCORDANCE WITH SECTION 701 OF THE STANDARD SPECIFICATIONS.
- ALL TRAFFIC SIGNAL HEADS SHALL BE 12-INCH POLYCARBONATE.
- TRAFFIC SIGNAL HEADS SHALL BE PROPERLY COVERED PRIOR TO INTERSECTION TURN-ON OR AS DIRECTED BY THE ENGINEER. THIS COST SHALL BE INCLUDED WITH THE COST OF THE ASSOCIATED TRAFFIC SIGNAL PAY ITEMS.
- ALL THREADS OF BOLTS USED IN THE ASSEMBLY OF TRAFFIC SIGNAL COMPONENTS SHALL BE COATED WITH A NON-LEAD BASED ANTI-SEIZE COMPOUND, SIMILAR TO LEAD PLATE, PRIOR TO ASSEMBLY.
- ALL HARDWARE SHALL BE TIGHTENED AND WELL SECURED; CABLES SHALL BE NEATLY WOUND IN HANDHOLES. CABLES SHALL BE NEATLY TRAINED IN THE CONTROLLER CABINET.
- ALL UNINTERRUPTIBLE POWER SUPPLIES SHALL BE EQUIPPED WITH ALPHA GUARD MONITORS.
- CONTRACTOR PERSONNEL AND EQUIPMENT SHALL NOT BE LOCATED WITHIN 50' OF THE CENTERLINE OF ANY RAILROAD TRACK.

APPROVED PROVIDERS FOR LED SIGNAL MODULES ARE:
GENERAL ELECTRIC
DIALIGHT

SEE TABLE FOR PART NUMBERS

DIALIGHT

	PART NO.		PART NO.
RED BALL	433-1210-003XL 433-1270-003XL	RED ARROW	432-1314-001XOD 432-1374-001XOD
YELLOW BALL	433-3230-901XL 433-3270-901XL	YELLOW ARROW	431-3334-901XOD 431-3374-901XOD
GREEN BALL	433-2220-001XL 433-2270-001XL	GREEN ARROW	432-2324-001XOD 432-2374-001XOD
COUNTDOWN PEDESTRIAN	430-6479-001X		

GENERAL ELECTRIC

	PART NO.		PART NO.
RED BALL	DR6-RTFB-77A DR6-RCFB-77A	RED ARROW	DR6-RTAAN-17A
YELLOW BALL	DR6-YTFB-77A DR6-YCFB-77A	YELLOW ARROW	DR6-YTAAN-17A DR6-YTAAN-17A-YX
GREEN BALL	DR6-GTFB-77A DR6-GCFB-77A	GREEN ARROW	DR6-GTAAN-17A DR6-GCAAN-17A
COUNTDOWN PEDESTRIAN	PS7-CFF1-26A-J PS7-CFF1-46A-J		

R10-3E SIGN SCHEDULE

COUNTY	CITY	INTERSECTION	NUMBER OF R10-3E SIGNS REQUIRED
LASALLE	PERU	US 6 (FOURTH ST.) & PEORIA ST.	8
	PERU	US 6 (FOURTH ST.) & WEST ST.	8
	STREATOR	IL 23 (BLOOMINGTON ST.) & NORTHLAWN JUNIOR HIGH	2
	STREATOR	IL 18 WB (MAIN ST.) & WASSON ST.	4
TOTAL			22

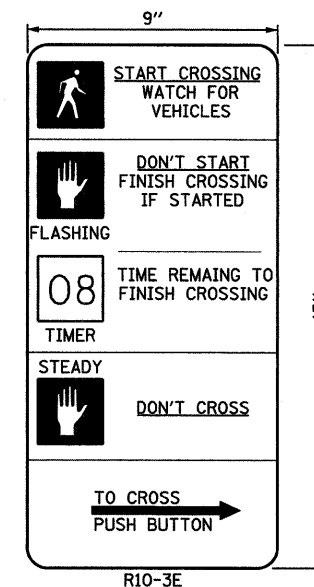

THE CONTRACTOR SHALL SUPPLY AND MOUNT ONE SIGN AT EACH EXISTING PEDESTRIAN PUSH-BUTTON AND THIS SHALL BE INCLUDED IN THE COST OF PEDESTRIAN SIGNAL HEAD PAY ITEM.

STATE OF ILLINOIS
DEPARTMENT OF TRANSPORTATION
DISTRICT THREE

REVIEWED BY: *Anna C. Weber*
DISTRICT OPERATIONS ENGINEER

DATE: OCTOBER 28, 2011

EXAMINED BY: *Heidi Jung*
DISTRICT CONSTRUCTION ENGINEER

Wanya Phillips
DISTRICT MATERIALS ENGINEER

Tom Brown
DISTRICT STUDIES & PLANS ENGINEER

				BUREAU CO.				LASALLE COUNTY									
				PRINCETON		SPRING VALLEY		LASALLE		MENDOTA	OTTAWA		PERU		STREATOR		STATE
ITEM NO.	DESCRIPTION	UNIT	TOTAL QUANTITY	95% STATE/ 5% CITY 0021	97.5% STATE/ 2.5% CITY 0021	95% STATE/ 5% CITY 0021	97.5% STATE/ 2.5% CITY 0021	95% STATE/ 5% CITY 0021	97.5% STATE/ 2.5% CITY 0021	95% STATE/ 5% CITY 0021	95% STATE/ 5% CITY 0021	96.7% STATE/ 3.3% CITY 0021	95% STATE/ 5% CITY 0021	96.7% STATE/ 3.3% CITY 0021	95% STATE/ 5% CITY 0021	97.5% STATE/ 2.5% CITY 0021	100% STATE/ 0% CITY 0021
67100100	MOBILIZATION	L SUM	1	--	--	--	--	--	--	--	--	--	--	--	--	--	1
70102620	TRAFFIC CONTROL AND PROTECTION, STANDARD 701501	L SUM	1	--	--	--	--	--	--	--	--	--	--	--	--	--	1
70102622	TRAFFIC CONTROL AND PROTECTION, STANDARD 701502	L SUM	1	--	--	--	--	--	--	--	--	--	--	--	--	--	1
70102630	TRAFFIC CONTROL AND PROTECTION, STANDARD 701601	L SUM	1	--	--	--	--	--	--	--	--	--	--	--	--	--	1
* 86200300	UNINTERRUPTABLE POWER SUPPLY, EXTENDED	EACH	39	4	1	1	1	4	2	1	7	1	5	1	3	--	8
* 88040150	SIGNAL HEAD, POLYCARBONATE, LED, 1-FACE, 5-SECTION, BRACKET MOUNTED	EACH	10	--	--	--	--	--	--	--	--	--	10	--	--	--	--
* 88040160	SIGNAL HEAD, POLYCARBONATE, LED, 1-FACE, 5-SECTION, MAST ARM MOUNTED	EACH	10	--	--	--	--	--	--	--	--	--	10	--	--	--	--
* 88102825	PEDESTRIAN SIGNAL HEAD, POLYCARBONATE, LED, 1-FACE, BRACKET MOUNTED WITH COUNT <i>DOWN TIMER</i>	EACH	106	--	--	--	--	--	--	--	--	--	16	--	50	8	32
* 88200410	TRAFFIC SIGNAL BACKPLATE, LOUVERED, FORMED PLASTIC	EACH	20	--	--	--	--	--	--	--	--	--	20	--	--	--	--
* 89501250	RELOCATE EXISTING TRAFFIC SIGNAL EQUIPMENT	EACH	2	--	--	--	--	--	--	--	--	--	2	--	--	--	--
* 89502210	MODIFY EXISTING CONTROLLER CABINET	EACH	39	4	1	1	1	4	2	1	7	1	5	1	3	--	8
* 89502375	REMOVE EXISTING TRAFFIC SIGNAL EQUIPMENT	EACH	14	--	--	--	--	--	--	--	--	--	2	--	7	1	4

07001,01 07001,01 07001,03 07001,04 07001,01 07001,05 07001,03 07001,04 07001,05 07001,06 07001,07 07001,08

* BUREAU & LASALLE

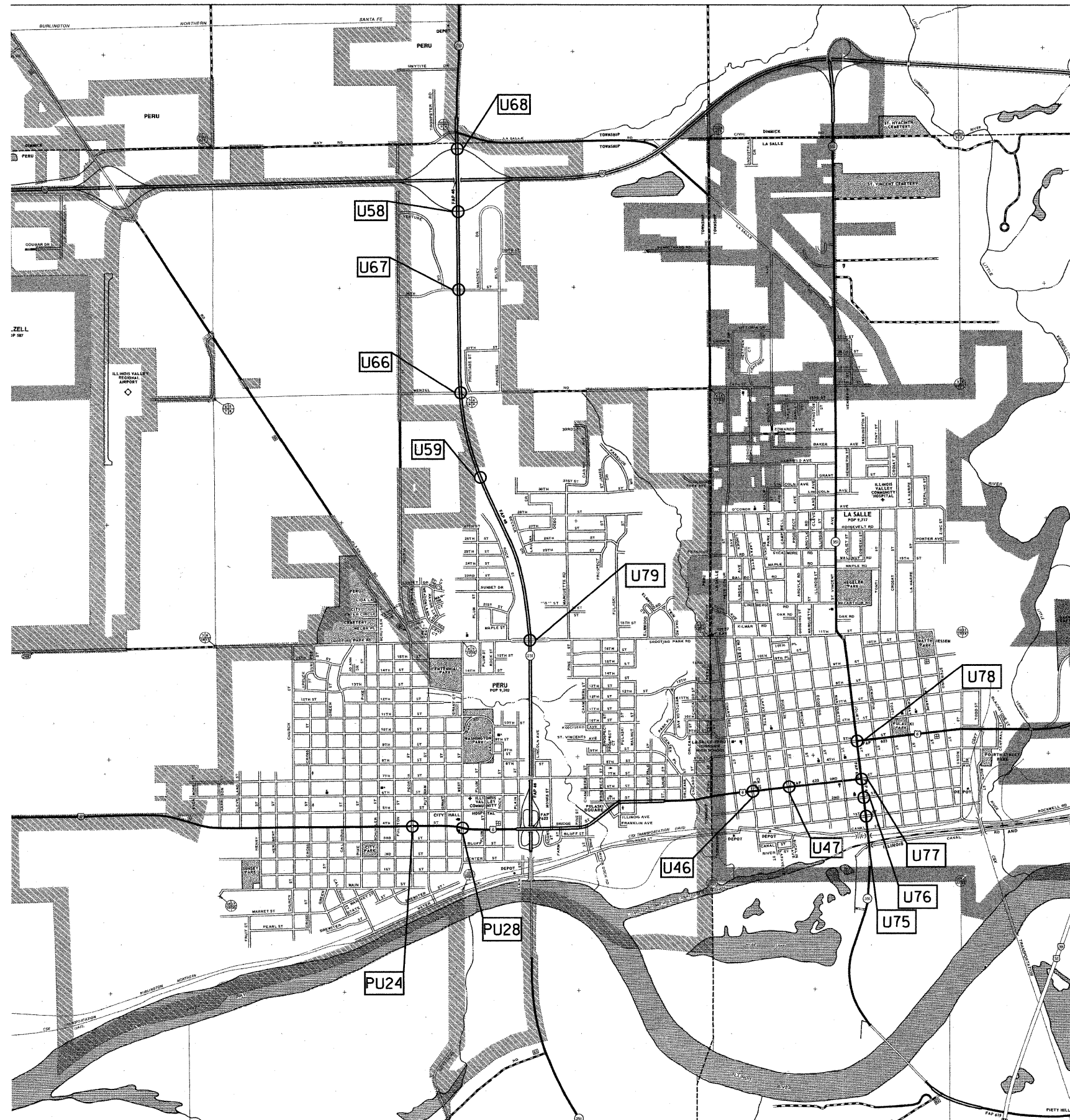

LEGEND NOTES

- I = INTERSECTION WILL BE RETROFITTING INCANDESCENT BULBS WITH LEDS AND IF NEEDED INSTALLING UNINTERRUPTABLE POWER SUPPLY UNIT, AND PEDESTRIAN COUNTDOWN HEADS
- P = INTERSECTION WILL BE REPLACING EXISTING FLASHING PEDESTRIAN HEADS WITH COUNTDOWN PEDESTRIAN HEADS
- U = INTERSECTION WILL BE INSTALLING UNINTERRUPTABLE POWER SUPPLY UNIT
- PU = INTERSECTION WILL BE INSTALLING UNINTERRUPTABLE POWER SUPPLY UNIT AND REPLACING EXISTING FLASHING PEDESTRIAN HEADS WITH COUNTDOWN PEDESTRIAN HEADS
- E = INTERSECTION WILL BE REPLACING 8" SIGNAL HEADS WITH 12" SIGNAL HEADS
- * = DENOTES INTERSECTION WILL BE INSTALLING ONE OR MORE NEW SIGNAL HEADS

LEGEND

- U75 - IL 351 (JOLIET ST.) & FIRST ST.
- U76 - IL 351 (JOLIET ST.) & SECOND ST.
- U77 - US 6 (THIRD ST.) & IL 351 (JOLIET ST.)
- U78 - US 6 (FIFTH ST.) & IL 351 (JOLIET ST.)
- PU24- US 6 (FOURTH ST.) & PEORIA ST.
- U79 - IL 251 & SHOOTING PARK RD.
- PU28- US 6 (FOURTH ST.) & WEST ST.
- U46 - US 6 (THIRD ST.) & CREVE COEUR ST.
- U47 - US 6 (THIRD ST.) & BUCKLIN ST.
- U58 - IL 251 & I-80 SOUTH RAMP
- U59 - IL 251 & MIDTOWN RD.
- U66 - IL 251 & 36TH ST. (WENZEL RD.)
- U67 - IL 251 & 38TH ST.
- U68 - IL 251 & I-80 NORTH RAMP

FILE NAME = D366B55-SHT-LOCATION-MAPS.DGN

USER NAME = ---

DESIGNED - ---

REVISED - ---

PLOT SCALE = N/A

DRAWN - ARR/NV

REVISED - ---

PLOT DATE = 10/11

CHECKED - JKC

REVISED - ---

DATE - 10/11

REVISED - ---

**STATE OF ILLINOIS
DEPARTMENT OF TRANSPORTATION**

**INTERSECTION LOCATION MAP
LASALLE - PERU**

SCALE: N/A

SHEET NO. ___ OF ___ SHEETS STA. _____ TO STA. _____

• BUREAU & LASALLE

F.A. RTE.	SECTION	COUNTY	TOTAL SHEETS	SHEET NO.
---	D-3 LED RETROFIT 2012-2	•	14	4
				CONTRACT NO. 66B55
ILLINOIS FED. AID PROJECT				

LEGEND NOTES

- I = INTERSECTION WILL BE RETROFITTING INCANDESCENT BULBS WITH LEDS AND IF NEEDED INSTALLING UNINTERRUPTABLE POWER SUPPLY UNIT, AND PEDESTRIAN COUNTDOWN HEADS
- P = INTERSECTION WILL BE REPLACING EXISTING FLASHING PEDESTRIAN HEADS WITH COUNTDOWN PEDESTRIAN HEADS
- U = INTERSECTION WILL BE INSTALLING UNINTERRUPTABLE POWER SUPPLY UNIT
- PU = INTERSECTION WILL BE INSTALLING UNINTERRUPTABLE POWER SUPPLY UNIT AND REPLACING EXISTING FLASHING PEDESTRIAN HEADS WITH COUNTDOWN PEDESTRIAN HEADS
- E = INTERSECTION WILL BE REPLACING 8" SIGNAL HEADS WITH 12" SIGNAL HEADS
- = DENOTES INTERSECTION WILL BE INSTALLING ONE OR MORE NEW SIGNAL HEADS

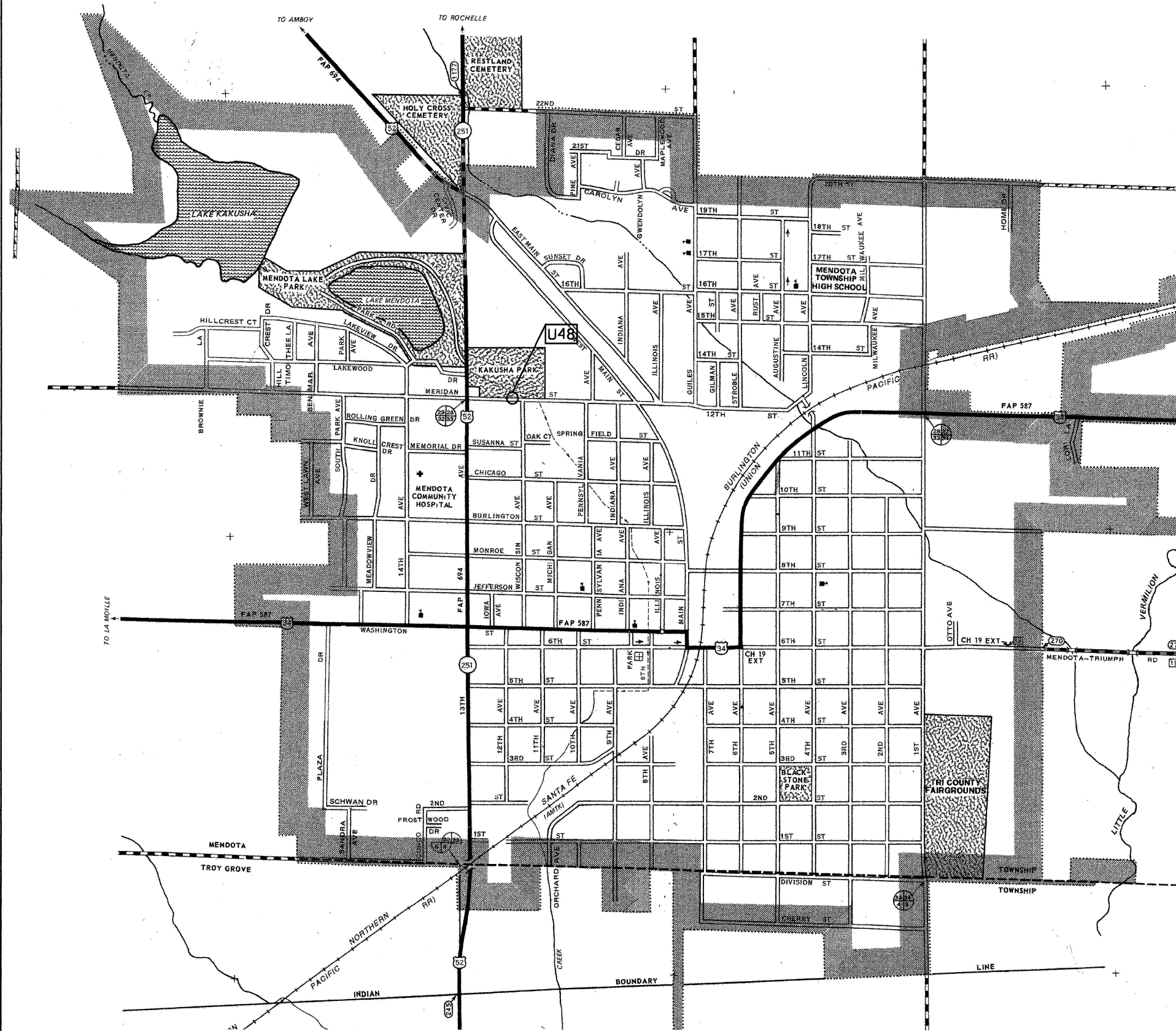

LEGEND

U48 - IL 251 (13TH ST.) & MERIDAN ST.

FILE NAME = 036685-SHT-LOCATION-MAPS.DGN

USER NAME = ---

DESIGNED - ---

REVISED - ---

PLOT SCALE = N/A

DRAWN - ARR/NV

REVISED - ---

PLOT DATE = 10/11

CHECKED - JKC

REVISED - ---

DATE = 10/11

REVISED - ---

**STATE OF ILLINOIS
DEPARTMENT OF TRANSPORTATION**

**INTERSECTION LOCATION MAP
MENDOTA**

SCALE: N/A

SHEET NO. ___ OF ___ SHEETS

STA. _____ TO STA. _____

• BUREAU & LASALLE

F.A. RTE.	SECTION	COUNTY	TOTAL SHEETS	SHEET NO.
---	D-3 LED RETROFIT 2012-2	•	14	5
				CONTRACT NO. 66B55

ILLINOIS FED. AID PROJECT

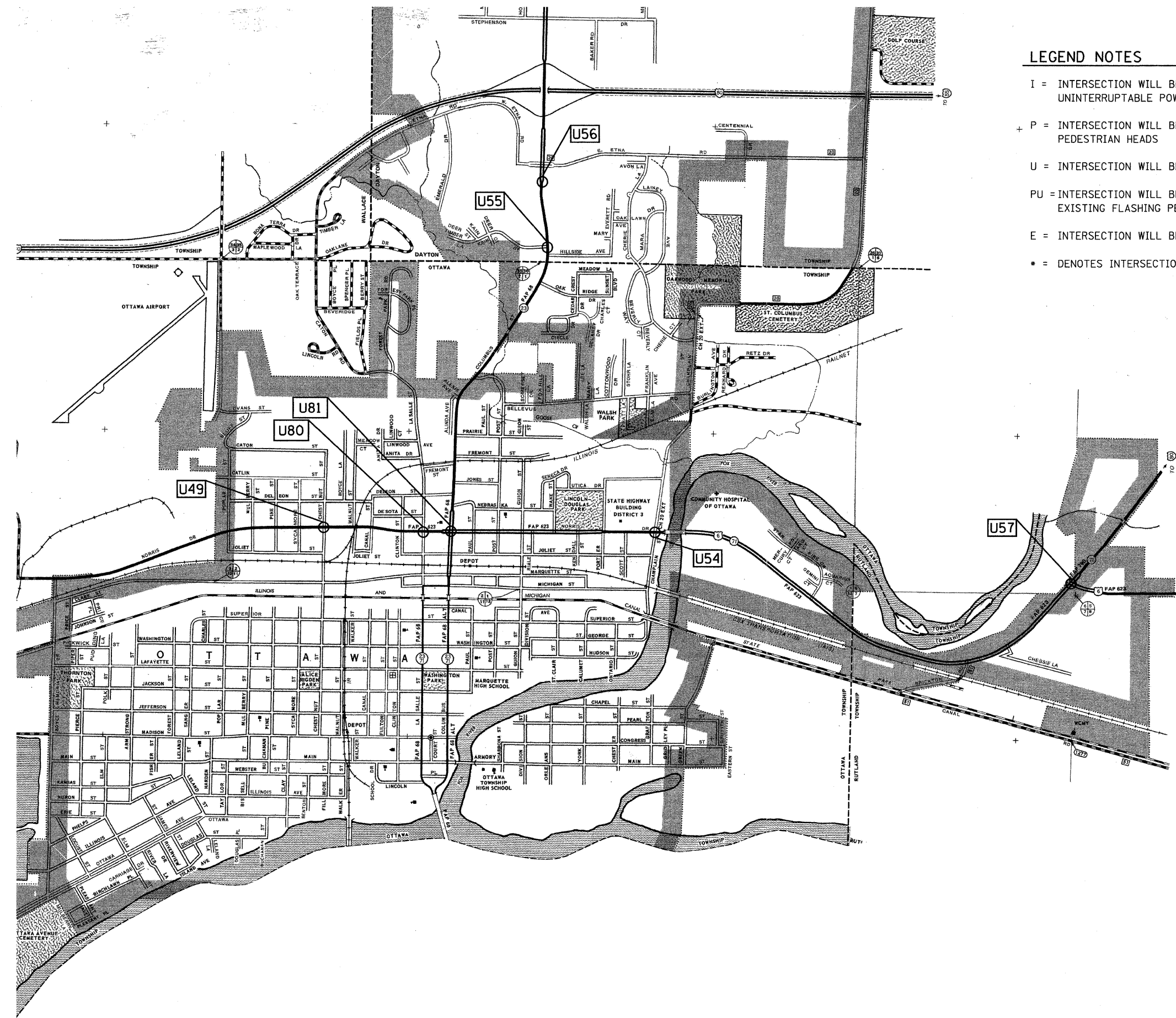

LEGEND NOTES

- I = INTERSECTION WILL BE RETROFITTING INCANDESCENT BULBS WITH LEDS AND IF NEEDED INSTALLING UNINTERRUPTABLE POWER SUPPLY UNIT, AND PEDESTRIAN COUNTDOWN HEADS
- + P = INTERSECTION WILL BE REPLACING EXISTING FLASHING PEDESTRIAN HEADS WITH COUNTDOWN PEDESTRIAN HEADS
- U = INTERSECTION WILL BE INSTALLING UNINTERRUPTABLE POWER SUPPLY UNIT
- PU = INTERSECTION WILL BE INSTALLING UNINTERRUPTABLE POWER SUPPLY UNIT AND REPLACING EXISTING FLASHING PEDESTRIAN HEADS WITH COUNTDOWN PEDESTRIAN HEADS
- E = INTERSECTION WILL BE REPLACING 8" SIGNAL HEADS WITH 12" SIGNAL HEADS
- = DENOTES INTERSECTION WILL BE INSTALLING ONE OR MORE NEW SIGNAL HEADS

LEGEND

- U80 - US 6 (NORRIS DR.) & LASALLE ST.
- U81 - US 6 (NORRIS DR.) & IL 23/IL 71 (COLUMBUS ST.)
- U49 - US 6 (NORRIS DR.) & CHESTNUT ST.
- U54 - US 6 & CHAMPLAIN ST.
- U55 - IL 23 & SOUTH TOWNE MALL ENTRANCE
- U56 - IL 23 (COLUMBUS ST.) & BP/SUNFIELD REST. ENTRANCE
- U57 - US 6 & IL 71

FILE NAME = 0366855-SHT-LOCATION-MAPS.DGN

USER NAME = ---

DESIGNED - --

REVISED - ---

PLOT SCALE = N/A

DRAWN - ARR/NV

REVISED - ---

PLOT DATE = 10/11

CHECKED - JKC

REVISED - ---

DATE - 10/11

REVISED - ---

**STATE OF ILLINOIS
DEPARTMENT OF TRANSPORTATION**

**INTERSECTION LOCATION MAP
OTTAWA - NORTH OF ILLINOIS RIVER**

SCALE: N/A

SHEET NO. -- OF -- SHEETS

STA. ----- TO STA. -----

F.A. RTE.	SECTION	COUNTY	TOTAL SHEETS	SHEET NO.
---	D-3 LED RETROFIT 2012-2	*	14	6
CONTRACT NO. 66B55				

* BUREAU & LASALLE

ILLINOIS FED. AID PROJECT

LEGEND NOTES

- I = INTERSECTION WILL BE RETROFITTING INCANDESCENT BULBS WITH LEDS AND IF NEEDED INSTALLING UNINTERRUPTABLE POWER SUPPLY UNIT, AND PEDESTRIAN COUNTDOWN HEADS
- P = INTERSECTION WILL BE REPLACING EXISTING FLASHING PEDESTRIAN HEADS WITH COUNTDOWN PEDESTRIAN HEADS
- U = INTERSECTION WILL BE INSTALLING UNINTERRUPTABLE POWER SUPPLY UNIT
- PU = INTERSECTION WILL BE INSTALLING UNINTERRUPTABLE POWER SUPPLY UNIT AND REPLACING EXISTING FLASHING PEDESTRIAN HEADS WITH COUNTDOWN PEDESTRIAN HEADS
- E = INTERSECTION WILL BE REPLACING 8" SIGNAL HEADS WITH 12" SIGNAL HEADS
- = DENOTES INTERSECTION WILL BE INSTALLING ONE OR MORE NEW SIGNAL HEADS

LEGEND

- U50 - IL 23 (FIRST AVE.) & MCKINLEY RD.
- U51 - IL 23 (STATE ST.) & STATE ST. CONNECTION
- U52 - IL 23 (STATE ST.) & CENTER ST.
- U53 - IL 23 (STATE ST.) & IL 71 (COURTNEY ST. / HITT ST.)

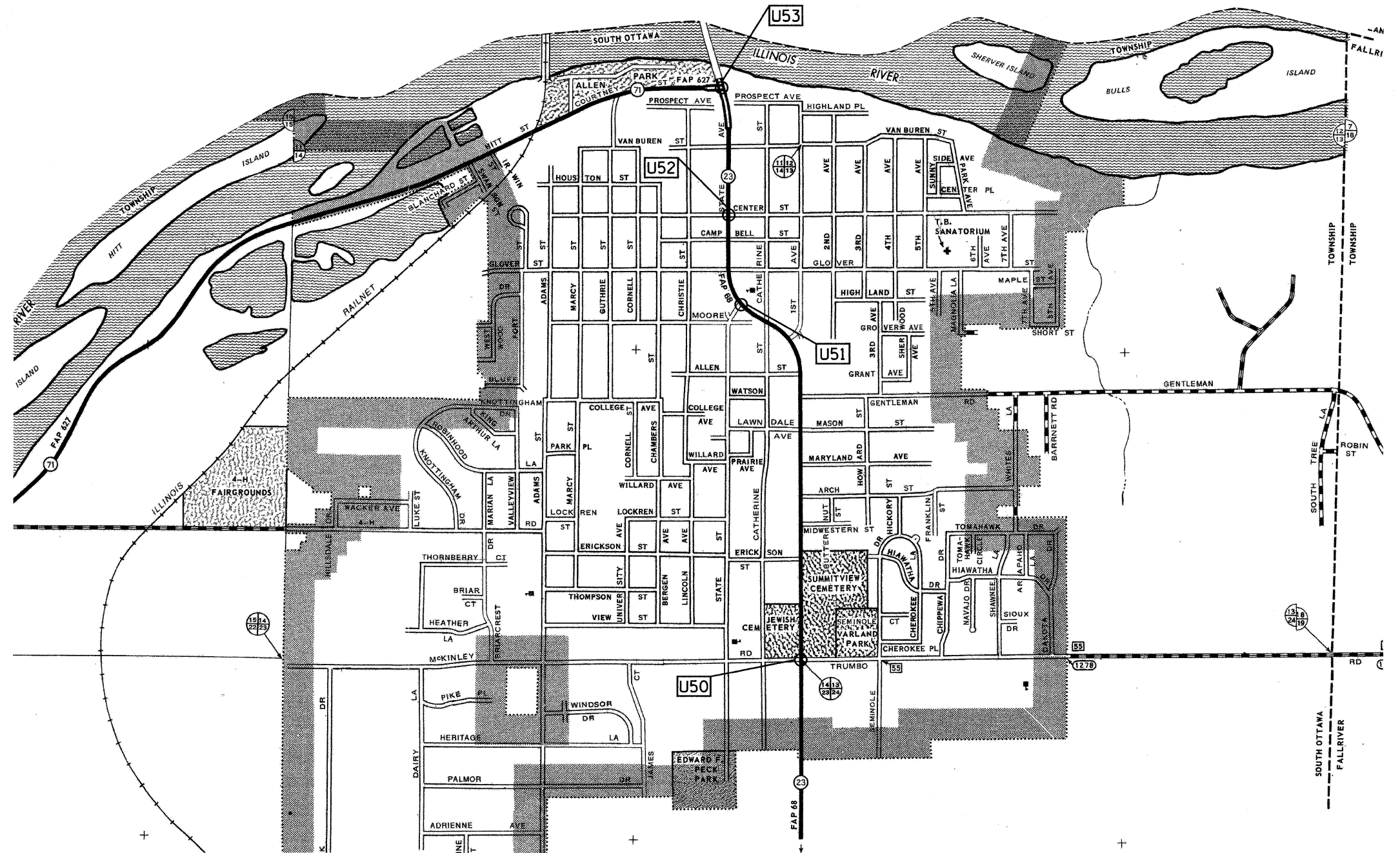

FILE NAME = 0366895-SHT-LOCATION-MAPS.DGN	USER NAME = ---	DESIGNED - --	REVISED - ---	STATE OF ILLINOIS DEPARTMENT OF TRANSPORTATION	INTERSECTION LOCATION MAP OTTAWA - SOUTH OF ILLINOIS RIVER	F.A. RTE. ---	SECTION D-3 LED RETROFIT 2012-2	COUNTY •	TOTAL SHEETS 14	SHEET NO. 7	
PLOT SCALE = N/A	CHECKED - JKC	REVISIED - ---	REVISED - ---			SCALE: N/A SHEET NO. -- OF -- SHEETS STA. ----- TO STA. -----					
PLOT DATE = 10/11	DATE - 10/11	REVISED - ---	REVISED - ---			CONTRACT NO. 66B55					
• BUREAU & LASALLE ILLINOIS FED. AID PROJECT											

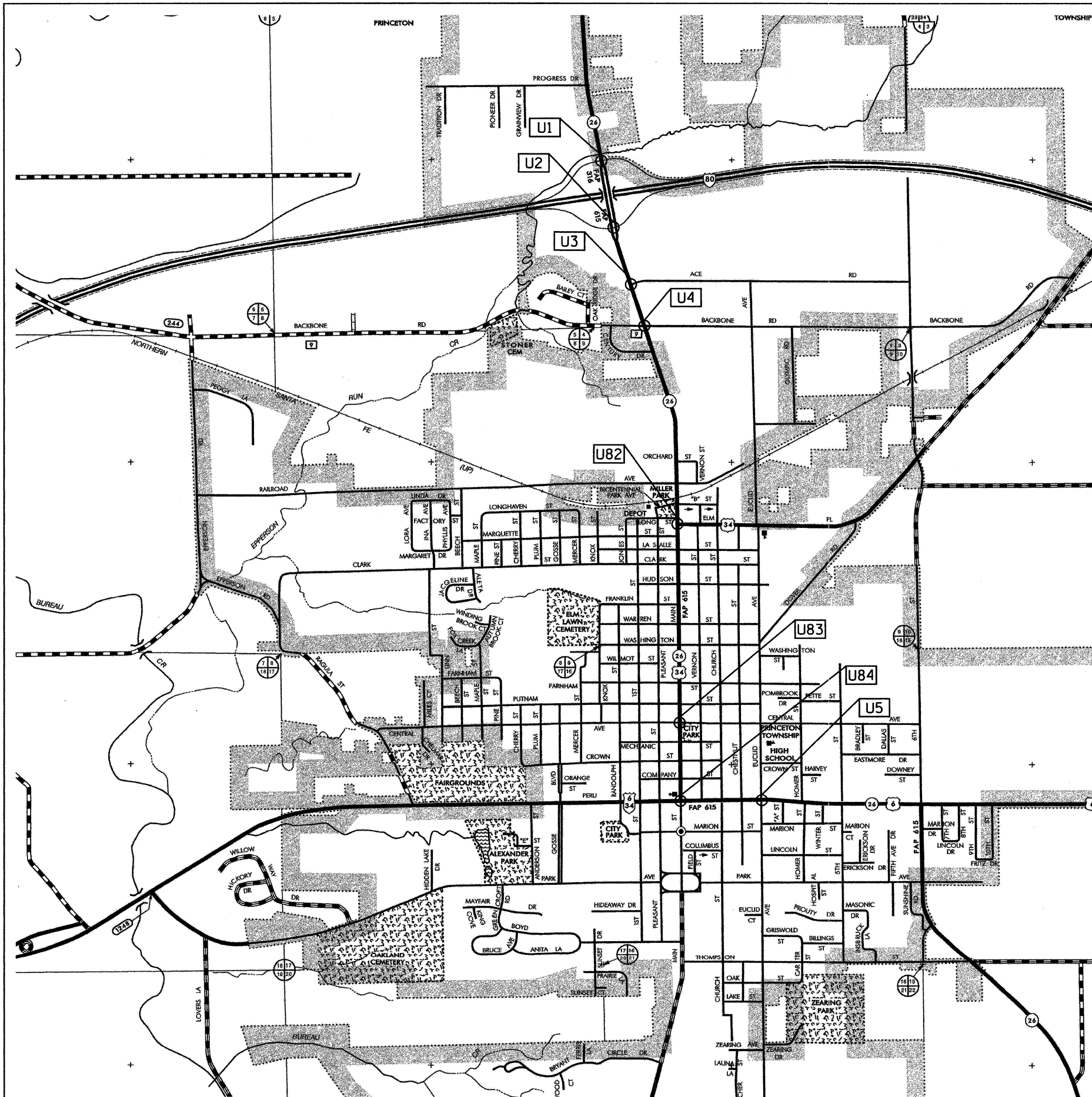

LEGEND NOTES

- I = INTERSECTION WILL BE RETROFITTING INCANDESCENT BULBS WITH LEDS AND IF NEEDED INSTALLING UNINTERRUPTABLE POWER SUPPLY UNIT, AND PEDESTRIAN COUNTDOWN HEADS
- P = INTERSECTION WILL BE REPLACING EXISTING FLASHING PEDESTRIAN HEADS WITH COUNTDOWN PEDESTRIAN HEADS
- U = INTERSECTION WILL BE INSTALLING UNINTERRUPTABLE POWER SUPPLY UNIT
- PU = INTERSECTION WILL BE INSTALLING UNINTERRUPTABLE POWER SUPPLY UNIT AND REPLACING EXISTING FLASHING PEDESTRIAN HEADS WITH COUNTDOWN PEDESTRIAN HEADS
- E = INTERSECTION WILL BE REPLACING 8" SIGNAL HEADS WITH 12" SIGNAL HEADS
- = DENOTES INTERSECTION WILL BE INSTALLING ONE OR MORE NEW SIGNAL HEADS

LEGEND

- U82 - IL 26 & US 34 (ELM PLACE)
- U83 - US 34 / IL 26 & CENTRAL AVE.
- U84 - US 34 / IL 26 (MAIN ST.) & US 6 (PERU ST.)
- U1 - IL 26 & I-80 WESTBOUND RAMP
- U2 - IL 26 & I-80 EASTBOUND RAMP
- U3 - IL 26 & ACE RD. (WAL-MART ENTRANCE)
- U4 - IL 26 & BACKBONE RD.
- U5 - US 6 & EUCLID ST.

FILE NAME = 0366855-SHT-LOCATION-MAPS.DGN

USER NAME = --

DESIGNED - --

REVISED - --

PLOT SCALE = N/A

DRAWN - ARR/NV

REVISED - --

PLOT DATE = 10/11

CHECKED - JKC

REVISED - --

DATE - 10/11

REVISED - --

**STATE OF ILLINOIS
DEPARTMENT OF TRANSPORTATION**

**INTERSECTION LOCATION MAP
PRINCETON**

SCALE: N/A

SHEET NO. -- OF -- SHEETS STA. ----- TO STA. -----

• BUREAU & LASALLE

F.A. RTE.	SECTION	COUNTY	TOTAL SHEETS	SHEET NO.
--	D-3 LED RETROFIT 2012-2	•	14	8
CONTRACT NO. 66B55				

ILLINOIS FED. AID PROJECT

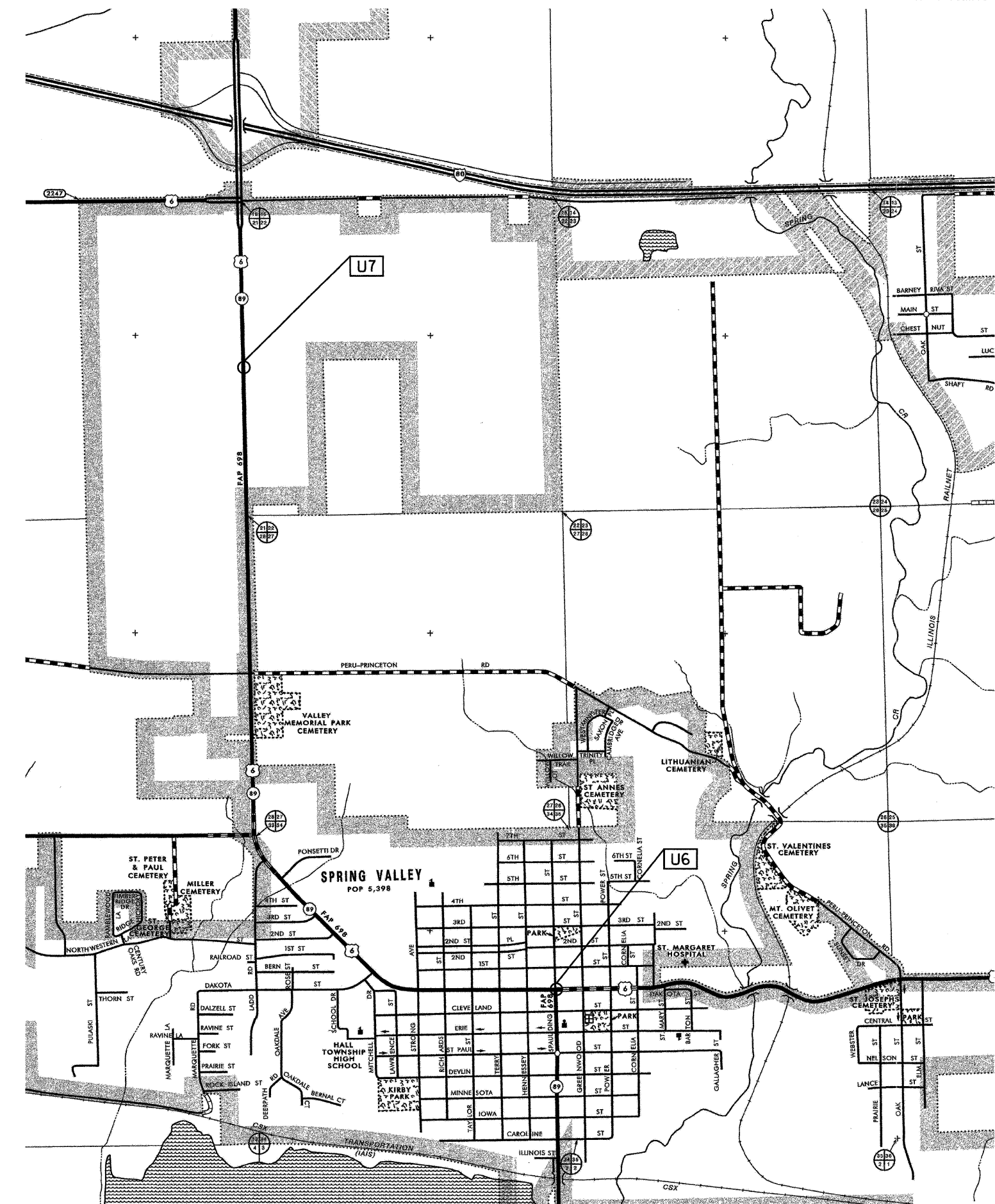

LEGEND NOTES

- I = INTERSECTION WILL BE RETROFITTING INCANDESCENT BULBS WITH LEDS AND IF NEEDED INSTALLING UNINTERRUPTABLE POWER SUPPLY UNIT, AND PEDESTRIAN COUNTDOWN HEADS
- P = INTERSECTION WILL BE REPLACING EXISTING FLASHING PEDESTRIAN HEADS WITH COUNTDOWN PEDESTRIAN HEADS
- U = INTERSECTION WILL BE INSTALLING UNINTERRUPTABLE POWER SUPPLY UNIT
- PU = INTERSECTION WILL BE INSTALLING UNINTERRUPTABLE POWER SUPPLY UNIT AND REPLACING EXISTING FLASHING PEDESTRIAN HEADS WITH COUNTDOWN PEDESTRIAN HEADS
- E = INTERSECTION WILL BE REPLACING 8" SIGNAL HEADS WITH 12" SIGNAL HEADS
- * = DENOTES INTERSECTION WILL BE INSTALLING ONE OR MORE NEW SIGNAL HEADS

LEGEND

- U6 - US 6 & IL 89 (SPALDING ST.)
- U7 - U6 / IL 89 & WAL-MART WAREHOUSE ENTRANCE

FILE NAME = 0366855-SHT-LOCATION-MAPS.DGN
 USER NAME = ---
 PLOT SCALE = N/A
 PLOT DATE = 10/11

DESIGNED - ---
 DRAWN - ARR/NV
 CHECKED - JKC
 DATE - 10/11

REVISED - ---
 REVISED - ---
 REVISED - ---
 REVISED - ---

**STATE OF ILLINOIS
 DEPARTMENT OF TRANSPORTATION**

**INTERSECTION LOCATION MAP
 SPRING VALLEY**

SCALE: N/A SHEET NO. -- OF -- SHEETS STA. ----- TO STA. -----

F.A. RTE.	SECTION	COUNTY	TOTAL SHEETS	SHEET NO.
--	D-3 LED RETROFIT 2012-2	*	14	9
CONTRACT NO. 66B55				
ILLINOIS FED. AID PROJECT				

* BUREAU & LASALLE

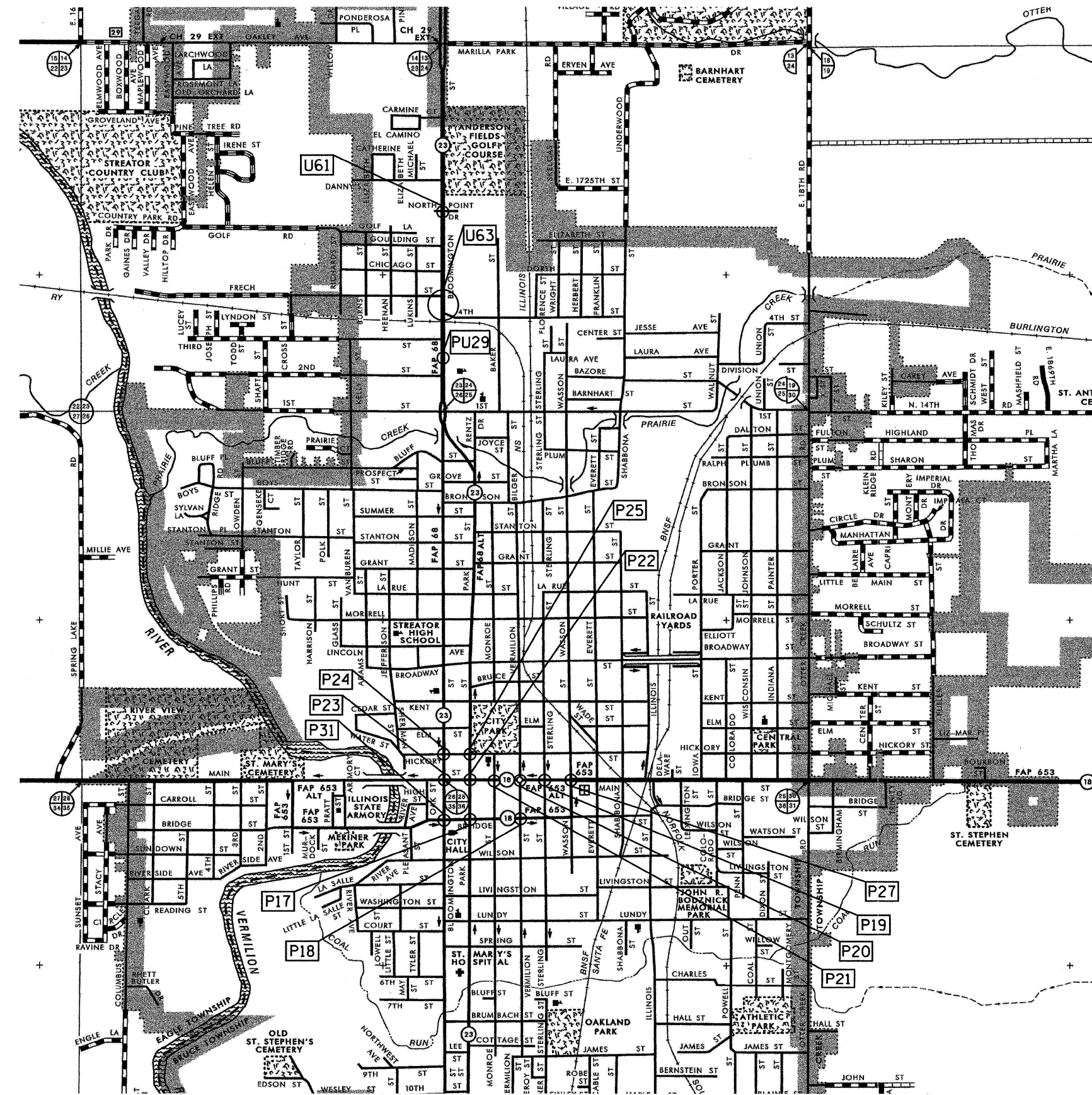

LEGEND NOTES

- I = INTERSECTION WILL BE RETROFITTING INCANDESCENT BULBS WITH LEDS AND IF NEEDED INSTALLING UNINTERRUPTABLE POWER SUPPLY UNIT, AND PEDESTRIAN COUNTDOWN HEADS
- P = INTERSECTION WILL BE REPLACING EXISTING FLASHING PEDESTRIAN HEADS WITH COUNTDOWN PEDESTRIAN HEADS
- U = INTERSECTION WILL BE INSTALLING UNINTERRUPTABLE POWER SUPPLY UNIT
- PU = INTERSECTION WILL BE INSTALLING UNINTERRUPTABLE POWER SUPPLY UNIT AND REPLACING EXISTING FLASHING PEDESTRIAN HEADS WITH COUNTDOWN PEDESTRIAN HEADS
- E = INTERSECTION WILL BE REPLACING 8" SIGNAL HEADS WITH 12" SIGNAL HEADS
- = DENOTES INTERSECTION WILL BE INSTALLING ONE OR MORE NEW SIGNAL HEADS

LEGEND

- P17 - IL 18 (BRIDGE ST.) & IL 23 (PARK ST.)
- P18 - IL 18 (BRIDGE ST.) & VERMILION ST.
- P19 - IL 18 (MAIN ST.) & STERLING ST.
- P20 - IL 18 (MAIN ST.) & VERMILION ST.
- P21 - IL 18 (MAIN ST.) & MONROE ST.
- P22 - IL 18 (MAIN ST.) & IL 23 (PARK ST.)
- P23 - IL 18 (MAIN ST.) & IL 23 (BLOOMINGTON ST.)
- P24 - IL 23 (BLOOMINGTON ST.) & HICKORY ST.
- P25 - IL 23 (PARK ST.) & HICKORY ST.
- P27 - IL 18 WB (MAIN ST.) & WASSON ST.
- P31 - IL 18 (BRIDGE ST.) & IL 23 (BLOOMINGTON ST.)
- PU29 - IL 23 (BLOOMINGTON ST.) & NORTHLAWN JUNIOR HIGH
- U61 - IL 23 (BLOOMINGTON ST.) & NORTHPOINT MALL ROAD
- U63 - IL 23 & 4TH / FRECH ST.

FILE NAME = 0366895-SHT-LOCATION-MAPS.DGN

USER NAME = ---

DESIGNED - ---

REVISED - ---

PLOT SCALE = N/A

DRAWN - ARR/NV

REVISED - ---

PLOT DATE = 10/11

CHECKED - JKC

REVISED - ---

DATE - 10/11

REVISED - ---

**STATE OF ILLINOIS
DEPARTMENT OF TRANSPORTATION**

**INTERSECTION LOCATION MAP
STREATOR**

• BUREAU & LASALLE

SCALE: N/A SHEET NO. ___ OF ___ SHEETS STA. _____ TO STA. _____

F.A. RTE.	SECTION	COUNTY	TOTAL SHEETS	SHEET NO.
---	D-3 LED RETROFIT 2012-2	•	14	10
CONTRACT NO. 66B55				
[ILLINOIS] FED. AID PROJECT				

		89502375				
		REMOVE EXISTING TRAFFIC SIGNAL EQUIPMENT				
		95% STATE 5% CITY	100% STATE 0% CITY	97.5% STATE 2.5% CITY	96.7% STATE 3.3% CITY	
COUNTY	CITY	INTERSECTION & LIST OF EQUIPMENT TO BE REMOVED	EACH	EACH	EACH	
LASALLE	STREATOR	IL 18 (BRIDGE ST.) & IL 23 (BLOOMINGTON ST.) - EXISTING PEDESTRIAN HEADS - 8 EACH	--	1	--	
	STREATOR	IL 18 (BRIDGE ST.) & IL 23 (PARK ST.) - EXISTING PEDESTRIAN HEADS - 8 EACH	--	1	--	
	STREATOR	IL 18 (BRIDGE ST.) & VERMILION ST. - EXISTING PEDESTRIAN HEADS - 8 EACH	1	--	--	
	STREATOR	IL 18 (MAIN ST.) & STERLING ST. - EXISTING PEDESTRIAN HEADS - 8 EACH	1	--	--	
	STREATOR	IL 18 (MAIN ST.) & VERMILLION ST. - EXISTING PEDESTRIAN HEADS - 8 EACH	1	--	--	
	STREATOR	IL 18 (MAIN ST.) & MONROE ST. - EXISTING PEDESTRIAN HEADS - 8 EACH	1	--	--	
	STREATOR	IL 18 (MAIN ST.) & IL 23 (PARK ST.) - EXISTING PEDESTRIAN HEADS - 8 EACH	--	1	--	
	STREATOR	IL 18 (MAIN ST.) & IL 23 (BLOOMINGTON ST.) - EXISTING PEDESTRIAN HEADS - 8 EACH	--	1	--	
	STREATOR	IL 23 (BLOOMINGTON ST.) & HICKORY ST. - EXISTING PEDESTRIAN HEADS - 8 EACH	1	--	--	
	STREATOR	IL 23 (PARK ST.) & HICKORY ST. - EXISTING PEDESTRIAN HEADS - 8 EACH	1	--	--	
	STREATOR	IL 23 (BLOOMINGTON ST.) & NORTHLAWN JUNIOR HIGH - EXISTING PEDESTRIAN HEADS - 2 EACH	1	--	--	
	STREATOR	IL 18 WB (MAIN ST.) & WASSON ST. - EXISTING PEDESTRIAN HEADS - 8 EACH	--	--	1	
			TOTAL	7	4	1
						0
						12

		88102825			
		PEDESTRIAN SIGNAL HEAD, POLYCARBONATE, LED, 1-FACE BRACKET MOUNTED WITH COUNT DOWN TIMER			
		95% STATE 5% CITY	100% STATE 0% CITY	97.5% STATE 2.5% CITY	96.7% STATE 3.3% CITY
COUNTY	CITY	INTERSECTION	EACH	EACH	EACH
LASALLE	STREATOR	IL 18 (BRIDGE ST.) & IL 23 (BLOOMINGTON ST.)	--	8	--
	STREATOR	IL 18 (BRIDGE ST.) & IL 23 (PARK ST.)	--	8	--
	STREATOR	IL 18 (BRIDGE ST.) & VERMILION ST.	8	--	--
	STREATOR	IL 18 (MAIN ST.) & STERLING ST.	8	--	--
	STREATOR	IL 18 (MAIN ST.) & VERMILLION ST.	8	--	--
	STREATOR	IL 18 (MAIN ST.) & MONROE ST.	8	--	--
	STREATOR	IL 18 (MAIN ST.) & IL 23 (PARK ST.)	--	8	--
	STREATOR	IL 18 (MAIN ST.) & IL 23 (BLOOMINGTON ST.)	--	8	--
	STREATOR	IL 23 (BLOOMINGTON ST.) & HICKORY ST.	8	--	--
	STREATOR	IL 23 (PARK ST.) & HICKORY ST.	8	--	--
	STREATOR	IL 23 (BLOOMINGTON ST.) & NORTHLAWN JUNIOR HIGH	2	--	--
	STREATOR	IL 18 WB (MAIN ST.) & WASSON ST.	--	--	8
			TOTAL	50	32
					0
					90

COUNTY	CITY	INTERSECTION	86200300				89502210				
			UNINTERRUPTABLE POWER SUPPLY, EXTENDED				MODIFY EXISTING CONTROLLER CABINET				
			95% STATE 5% CITY	100% STATE 0% CITY	97.5% STATE 2.5% CITY	96.7% STATE 3.3% CITY	95% STATE 5% CITY	100% STATE 0% CITY	97.5% STATE 2.5% CITY	96.7% STATE 3.3% CITY	
EACH	EACH	EACH	EACH	EACH	EACH	EACH	EACH				
BUREAU	PRINCETON	IL 26 & 1-80 WESTBOUND EXIT RAMP	-	1	-	-	-	1	-	-	
	PRINCETON	IL 26 & 1-80 EASTBOUND EXIT RAMP	-	1	-	-	-	1	-	-	
	PRINCETON	IL 26 & US 34 (ELM PLACE)	-	1	-	-	-	1	-	-	
	PRINCETON	IL 26 & ACE RD. WAL-MART ENTRANCE	1	-	-	-	1	-	-	-	
	PRINCETON	IL 26 & BACKBONE RD.	1	-	-	-	1	-	-	-	
	PRINCETON	US 34 / IL 26 & CENTRAL AVE.	1	-	-	-	1	-	-	-	
	PRINCETON	US 34 / IL 26 (MAIN ST.) & US 6 (PERU ST.)	-	-	1	-	-	-	1	-	
	PRINCETON	US 6 & EUCLID ST.	1	-	-	-	1	-	-	-	
			SUBTOTAL	4	3	1	0	4	3	1	0
	SPRING VALLEY	US 6 & IL 89 (SPAULDING)	-	-	1	-	-	-	-	1	-
SPRING VALLEY	US 6/IL 89 & WAL-MART ENTRANCE	1	-	-	-	1	-	-	-	-	
		SUBTOTAL	1	0	1	0	1	0	1	0	
LASALLE	LASALLE	IL 351 (JOLIET ST.) & FIRST ST.	1	-	-	-	1	-	-	-	
	LASALLE	IL 351 (JOLIET ST.) & SECOND ST.	1	-	-	-	1	-	-	-	
	LASALLE	US 6 (THIRD ST.) & IL 351 (JOLIET ST.)	-	-	1	-	-	-	1	-	
	LASALLE	US 6 (FIFTH ST.) & IL 351 (JOLIET ST.)	-	-	1	-	-	-	1	-	
	LASALLE	US 6 (THIRD ST.) & CREVE COEUR ST.	1	-	-	-	1	-	-	-	
	LASALLE	US 6 (THIRD ST.) & BUCKLIN ST.	1	-	-	-	1	-	-	-	
			SUBTOTAL	4	0	2	0	4	0	2	0
	MENDOTA	IL 251 (13TH ST.) & MERDAN ST.	1	-	-	-	1	-	-	-	
			SUBTOTAL	1	0	0	0	1	0	0	0
	OTTAWA	US 6 (NORRIS DR.) & CHESTNUT ST.	1	-	-	-	1	-	-	-	
	OTTAWA	US 6 (NORRIS DR.) & LASALLE ST.	1	-	-	-	1	-	-	-	
	OTTAWA	US 6 (NORRIS DR.) & IL 23 / IL 71 (COLUMBUS ST.)	-	1	-	-	-	1	-	-	
	OTTAWA	IL 23 (FIRST AVE.) & MCKINLEY ROAD	1	-	-	-	1	-	-	-	
	OTTAWA	IL 23 (STATE ST.) & STATE ST. CONNECTION	-	-	-	1	-	-	-	1	
	OTTAWA	IL 23 (STATE ST.) & CENTER ST.	1	-	-	-	1	-	-	-	
	OTTAWA	IL 23 (STATE ST.) & IL 71 (COURTNEY ST. / HITT ST.)	-	1	-	-	-	1	-	-	
	OTTAWA	US 6 & CHAMPLAIN ST.	1	-	-	-	1	-	-	-	
	OTTAWA	IL 23 & SOUTH TOWNE MALL ENTRANCE	1	-	-	-	1	-	-	-	
	OTTAWA	IL 23 (COLUMBUS ST.) & BP AMOCO/SUNFIELD REST. ENTRANCE	1	-	-	-	1	-	-	-	
	OTTAWA	US 6 & IL 71	-	1	-	-	-	1	-	-	
		SUBTOTAL	7	3	0	1	7	3	0	1	
PERU	IL 251 & SHOOTING PARK RD.	1	-	-	-	1	-	-	-		
PERU	IL 251 & 36TH ST. (WENZEL ROAD)	1	-	-	-	1	-	-	-		
PERU	IL 251 & I-80 SOUTH RAMP	-	1	-	-	-	1	-	-		
PERU	IL 251 & I-80 NORTH RAMP	-	1	-	-	-	1	-	-		
PERU	IL 251 & 38TH ST.	1	-	-	-	1	-	-	-		
PERU	IL 251 & MIDTOWN RD.	-	-	-	1	-	-	-	1		
		SUBTOTAL	3	2	0	1	3	2	0	1	
STREATOR	IL 23 (BLOOMINGTON ST.) & NORTHLAWN JUNIOR HIGH	1	-	-	-	1	-	-	-		
STREATOR	IL 23 (BLOOMINGTON ST.) & NORTHPOINT MALL RD.	1	-	-	-	1	-	-	-		
STREATOR	IL 23 & 4TH/FRECH ST.	1	-	-	-	1	-	-	-		
		SUBTOTAL	3	0	0	0	3	0	0	0	
		COLUMN TOTAL	23	8	4	2	23	8	4	2	
		TOTAL				37				37	

TRAFFIC CONTROL FOR ONE OR MORE LEGS AT EACH INTERSECTION SHALL BE IN ACCORDANCE WITH THE HIGHWAY STANDARD INDICATED			FUNDING		HIGHWAY STANDARD		
COUNTY	CITY	INTERSECTION	STATE	CITY	701501	701502	701601
LASALLE	PERU	US 6 (FOURTH ST.) & PEORIA ST.	100.0	0.0	-	X	-
		US 6 (FOURTH ST.) & WEST ST.	100.0	0.0	-	X	-
	STREATOR	IL 18 (BRIDGE ST.) & IL 23 (BLOOMINGTON ST.)	100.0	0.0	-	-	X
		IL 18 (BRIDGE ST.) & IL 23 (PARK ST.)	100.0	0.0	-	-	X
		IL 18 (BRIDGE ST.) & VERMILION ST.	100.0	0.0	-	-	X
		IL 18 (MAIN ST.) & STERLING ST.	100.0	0.0	X	-	X
		IL 18 (MAIN ST.) & VERMILION ST.	100.0	0.0	-	-	X
		IL 18 (MAIN ST.) & MONROE ST.	100.0	0.0	-	-	X
		IL 18 (MAIN ST.) & IL 23 (PARK ST.)	100.0	0.0	-	-	X
		IL 18 (MAIN ST.) & IL 23 (BLOOMINGTON ST.)	100.0	0.0	-	-	X
		IL 23 (BLOOMINGTON ST.) & HICKORY ST.	100.0	0.0	X	-	X
		IL 23 (PARK ST.) & HICKORY ST.	100.0	0.0	X	-	X
	IL 23 (BLOOMINGTON ST.) & NORTHLAWN JUNIOR HIGH	100.0	0.0	-	-	X	
	IL 18 WB (MAIN ST.) & WASSON ST.	100.0	0.0	X	X	X	

ELECTRICAL LOAD FOR INTERSECTION				
STREET NAME	COMPONENT	NUMBER	WATTAGE EACH	BURNTIME %
US 6	RED	8	7	35
	YELLOW	8	12	5
	GREEN	8	9.5	60
	YELLOW ARROW LT.	4	6	5
	GREEN ARROW LT.	4	6	10
	YELLOW ARROW RT.	4	6	5
	GREEN ARROW RT.	4	6	10
		4	11/10	50/50
	4	8	50	
PEORIA STREET	RED	6	7	60
	YELLOW	6	12	5
	GREEN	6	9.5	35
	YELLOW ARROW LT.	4	6	5
	GREEN ARROW LT.	4	6	10
		4	11/10	50/50
	4	8	50	
TRAFFIC SIGNAL CABINET	CONTROLLER	1	6	100
	UPS	1	50	100

THERE MAY BE ADDITIONAL ELECTRICAL LOADS DUE TO LIGHTING AND EMERGENCY VEHICLE DETECTION EQUIPMENT.
 AGENCY RESPONSIBLE FOR TRAFFIC SIGNAL ENERGY CHARGES:
 CITY OF PERU

CONSTRUCTION NOTES:

MODIFY EXISTING CONTROLLER CABINET.
 INSTALL UNINTERRUPTABLE POWER SUPPLY.
 REMOVE AND REPLACE TWELVE (12) 4-SECTION HEADS WITH LED SIGNAL HEADS.
 REMOVE AND REPLACE EIGHT (8) PEDESTRIAN HEADS WITH LED PEDESTRIAN HEADS WITH COUNT DOWN TIMERS.
 REMOVAL OF THE FOLLOWING ITEMS SHALL BE PAID FOR AS REMOVE EXISTING TRAFFIC SIGNAL EQUIPMENT:
 6 EACH - SIGNAL HEAD, 1-FACE, 4-SECTION, BRACKET MOUNTED
 6 EACH - SIGNAL HEAD, 1-FACE, 4-SECTION, MAST ARM MOUNTED
 8 EACH - PEDESTRIAN SIGNAL HEAD, 1-FACE, BRACKET MOUNTED
 THE RED BALLS OF THE NEW MAST ARM MOUNTED 5-SECTION SIGNAL HEADS SHALL BE POSITIONED TO MATCH THE EXISTING LOCATION OR TO PROVIDE 16' MINIMUM VERTICAL CLEARANCE, WHICHEVER IS GREATER.
 BRACKET MOUNTED SIGNAL HEADS SHALL MATCH EXISTING LOCATION.
 THE EXISTING MAST ARM MOUNTED 3-SECTION SIGNAL HEAD FOR NORTHBOUND PEORIA STREET TRAFFIC SHALL BE ADJUSTED VERTICALLY SO THAT IT'S RED BALL WILL LINE UP WITH THE RED BALL OF THE NEW 5-SECTION SIGNAL HEAD. THIS WORK WILL REQUIRE ALTERATION OR REPLACEMENT OF COMPONENTS OF THE MOUNTING SYSTEM TO ALLOW FOR AND TO CLOSE OPENINGS FOR WIRING. THIS WORK WILL BE PAID FOR AS RELOCATE EXISTING TRAFFIC SIGNAL EQUIPMENT.
 HOLES IN TRAFFIC SIGNAL POSTS OR MAST ARM POLES RESULTING FROM REMOVAL OF 4-SECTION SIGNAL HEADS SHALL BE COVERED WITH STAINLESS STEEL PLATES AND MOUNTING HARDWARE. THIS WORK SHALL BE CONSIDERED INCLUDED IN THE COST OF REMOVE EXISTING TRAFFIC SIGNAL EQUIPMENT.

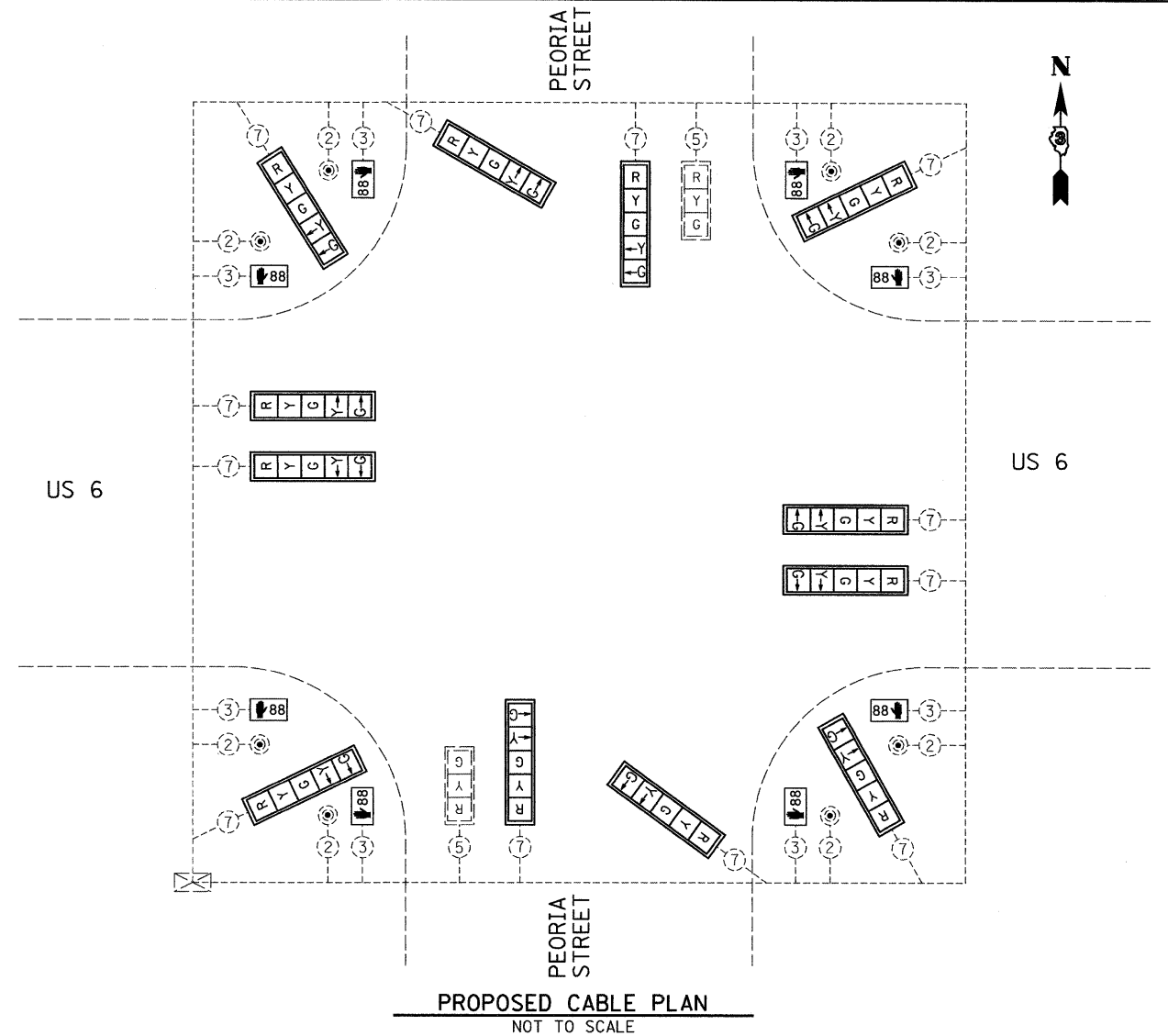

SCHEDULE OF QUANTITIES (95% STATE / 5% CITY)

PERU	US 6 (FOURTH ST.) & PEORIA ST.		
ITEM NO.	DESCRIPTION	UNIT	TOTAL QUANTITY
86200300	UNINTERRUPTABLE POWER SUPPLY, EXTENDED	EACH	1
88040150	SIGNAL HEAD, POLYCARBONATE, LED, 1-FACE, 5-SECTION, BRACKET MOUNTED	EACH	6
88040160	SIGNAL HEAD, POLYCARBONATE, LED, 1-FACE, 5-SECTION, MAST ARM MOUNTED	EACH	6
88102825	PEDESTRIAN SIGNAL HEAD, POLYCARBONATE, LED, 1-FACE, BRACKET MOUNTED WITH COUNT DOWN TIMER	EACH	8
88200410	TRAFFIC SIGNAL BACKPLATE, LOUVERED, FORMED PLASTIC	EACH	12
89501250	RELOCATE EXISTING TRAFFIC SIGNAL EQUIPMENT	EACH	1
89502210	MODIFY EXISTING CONTROLLER CABINET	EACH	1
89502375	REMOVE EXISTING TRAFFIC SIGNAL EQUIPMENT	EACH	1

TRAFFIC SIGNALS LEGEND

	DENOTES NUMBER OF EXISTING CONDUCTORS
	EXISTING CONTROLLER AND CABINET
	SIGNAL SECTION 12"
	EXISTING LED SIGNAL SECTION 12"
	LEFT TURN YELLOW
	LEFT TURN GREEN
	RIGHT TURN YELLOW
	RIGHT TURN GREEN
	EXISTING PEDESTRIAN PUSH BUTTON
	PROPOSED WALK/DON'T WALK WITH COUNT DOWN TIMER
	TRAFFIC SIGNAL BACKPLATE
	EXISTING LED TRAFFIC SIGNAL

FILE NAME = 0366885-SHT-TS-CABLE-PERU-US6-PEORIA.DGN

USER NAME = ---

DESIGNED - ---

REVISED - ---

PLOT SCALE = 1" = 20'

DRAWN - ARR/NV

REVISED - ---

PLOT DATE = 10/11

CHECKED - JKC

REVISED - ---

DATE - 10/11

REVISED - ---

STATE OF ILLINOIS
 DEPARTMENT OF TRANSPORTATION

TRAFFIC SIGNAL CABLE PLAN
 PERU - US 6 (FOURTH ST.) & PEORIA STREET

SCALE: 1" = 20'

SHEET NO. ___ OF ___ SHEETS

STA. _____ TO STA. _____

F.A.R.T.E.	SECTION	COUNTY	TOTAL SHEETS	SHEET NO.
---	D-3 LED RETROFIT 2012-2	*	14	13
			CONTRACT NO. 66B55	
ILLINOIS FED. AID PROJECT				

* BUREAU & LASALLE

ELECTRICAL LOAD FOR INTERSECTION				
STREET NAME	COMPONENT	NUMBER	WATTAGE EACH	BURNTIME %
US 6	RED	8	7	35
	YELLOW	8	12	5
	GREEN	8	9.5	60
	YELLOW ARROW LT.	4	6	5
	GREEN ARROW LT.	4	6	10
		4	11/10	50/50
WEST STREET	RED	6	7	60
	YELLOW	6	12	5
	GREEN	6	9.5	35
	YELLOW ARROW RT.	4	6	5
	GREEN ARROW RT.	4	6	10
		4	11/10	50/50
TRAFFIC SIGNAL CABINET	CONTROLLER	1	6	100
	UPS	1	50	100

THERE MAY BE ADDITIONAL ELECTRICAL LOADS DUE TO LIGHTING AND EMERGENCY VEHICLE DETECTION EQUIPMENT.
 AGENCY RESPONSIBLE FOR TRAFFIC SIGNAL ENERGY CHARGES:
 CITY OF PERU

CONSTRUCTION NOTES:

MODIFY EXISTING CONTROLLER CABINET.
 INSTALL UNINTERRUPTABLE POWER SUPPLY.
 REMOVE AND REPLACE EIGHT (8) 4-SECTION HEADS WITH LED SIGNAL HEADS.
 REMOVE AND REPLACE EIGHT (8) PEDESTRIAN HEADS WITH LED PEDESTRIAN HEADS WITH COUNT DOWN TIMERS.
 REMOVAL OF THE FOLLOWING ITEMS SHALL BE PAID FOR AS REMOVE EXISTING TRAFFIC SIGNAL EQUIPMENT:
 4 EACH - SIGNAL HEAD, 1-FACE, 4-SECTION, BRACKET MOUNTED
 4 EACH - SIGNAL HEAD, 1-FACE, 4-SECTION, MAST ARM MOUNTED
 8 EACH - PEDESTRIAN SIGNAL HEAD, 1-FACE, BRACKET MOUNTED
 THE RED BALLS OF THE NEW MAST ARM MOUNTED 5-SECTION SIGNAL HEADS SHALL BE POSITIONED TO MATCH THE EXISTING LOCATION OR TO PROVIDE 16' MINIMUM VERTICAL CLEARANCE, WHICHEVER IS GREATER.
 BRACKET MOUNTED SIGNAL HEADS SHALL MATCH EXISTING LOCATION.
 THE EXISTING MAST ARM MOUNTED 3-SECTION SIGNAL HEAD FOR EASTBOUND US 6 STREET TRAFFIC SHALL BE ADJUSTED VERTICALLY SO THAT IT'S RED BALL WILL LINE UP WITH THE RED BALL OF THE NEW 5-SECTION SIGNAL HEAD. THIS WORK WILL REQUIRE ALTERATION OR REPLACEMENT OF COMPONENTS OF THE MOUNTING SYSTEM TO ALLOW FOR AND TO CLOSE OPENINGS FOR WIRING. THIS WORK WILL BE PAID FOR AS RELOCATE EXISTING TRAFFIC SIGNAL EQUIPMENT.
 HOLES IN TRAFFIC SIGNAL POSTS OR MAST ARM POLES RESULTING FROM REMOVAL OF 4-SECTION SIGNAL HEADS SHALL BE COVERED WITH STAINLESS STEEL PLATES AND MOUNTING HARDWARE. THIS WORK SHALL BE CONSIDERED INCLUDED IN THE COST OF REMOVE EXISTING TRAFFIC SIGNAL EQUIPMENT.

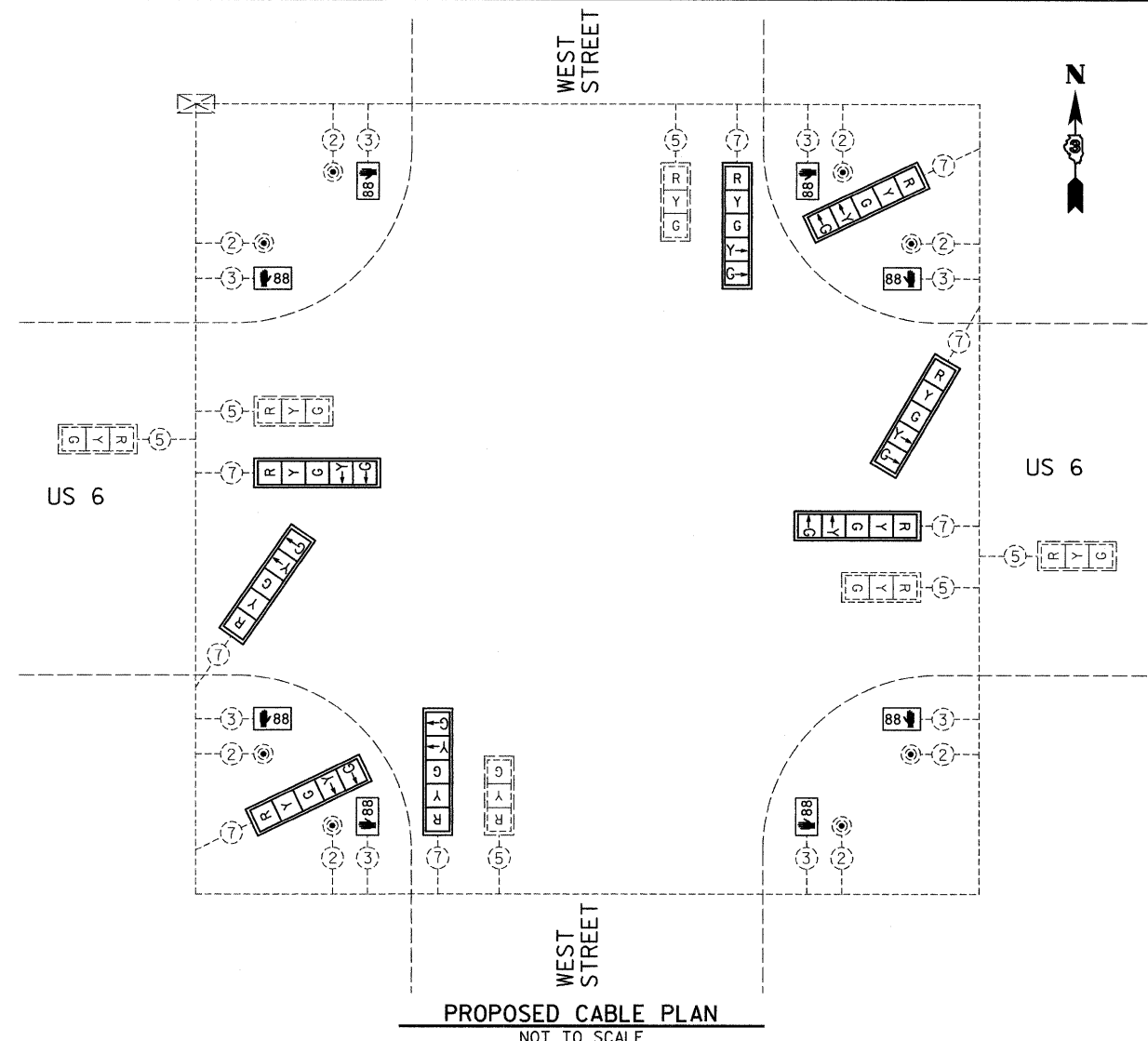

SCHEDULE OF QUANTITIES (95% STATE / 5% CITY)

ITEM NO.	DESCRIPTION	UNIT	TOTAL QUANTITY
86200300	UNINTERRUPTABLE POWER SUPPLY, EXTENDED	EACH	1
88040150	SIGNAL HEAD, POLYCARBONATE, LED, 1-FACE, 5-SECTION, BRACKET MOUNTED	EACH	4
88040160	SIGNAL HEAD, POLYCARBONATE, LED, 1-FACE, 5-SECTION, MAST ARM MOUNTED	EACH	4
88102825	PEDESTRIAN SIGNAL HEAD, POLYCARBONATE, LED, 1-FACE, BRACKET MOUNTED WITH COUNT DOWN TIMER	EACH	8
88200410	TRAFFIC SIGNAL BACKPLATE, LOUVERED, FORMED PLASTIC	EACH	8
89501250	RELOCATE EXISTING TRAFFIC SIGNAL EQUIPMENT	EACH	1
89502210	MODIFY EXISTING CONTROLLER CABINET	EACH	1
89502375	REMOVE EXISTING TRAFFIC SIGNAL EQUIPMENT	EACH	1

TRAFFIC SIGNALS LEGEND	
	DENOTES NUMBER OF EXISTING CONDUCTORS
	EXISTING CONTROLLER AND CABINET
	SIGNAL SECTION 12"
	EXISTING LED SIGNAL SECTION 12"
	LEFT TURN YELLOW
	LEFT TURN GREEN
	RIGHT TURN YELLOW
	RIGHT TURN GREEN
	EXISTING PEDESTRIAN PUSH BUTTON
	PROPOSED WALK/DON'T WALK WITH COUNT DOWN TIMER
	TRAFFIC SIGNAL BACKPLATE
	EXISTING LED TRAFFIC SIGNAL