

ELECTRICAL LOAD FOR INTERSECTION				
STREET NAME	COMPONENT	NUMBER	WATTAGE EACH	BURNTIME %
US 45/52	RED	6	7	35
	YELLOW	6	12	5
	GREEN	6	9.5	60
	RED ARROW LT.	2	6	85
	YELLOW ARROW LT.	2	6	5
SOUTH TEC ROAD	RED	3	7	60
	YELLOW	3	12	5
	GREEN	3	9.5	35
	YELLOW ARROW RT.	2	6	5
	GREEN ARROW RT.	2	6	10
TRAFFIC SIGNAL CABINET	CONTROLLER	1	6	100
	UPS	1	50	100

THERE MAY BE ADDITIONAL ELECTRICAL LOADS DUE TO LIGHTING AND EMERGENCY VEHICLE DETECTION EQUIPMENT.
 AGENCY RESPONSIBLE FOR TRAFFIC SIGNAL ENERGY CHARGES:
 CITY OF KANKAKEE

CONSTRUCTION NOTES:

MODIFY EXISTING CONTROLLER CABINET.
 INSTALL UNINTERRUPTABLE POWER SUPPLY.
 REMOVE AND REPLACE THE TWO (2) 8" LED 3-SECTION HEADS WITH 12" LED 3-SECTION HEADS LOCATED AT THE NORTHEAST AND SOUTHEAST CORNERS.
 REMOVAL OF THE FOLLOWING ITEMS SHALL BE PAID FOR AS REMOVE EXISTING TRAFFIC SIGNAL EQUIPMENT:
 2 EACH - SIGNAL HEAD, 1-FACE, 3-SECTION, BRACKET MOUNTED
 HOLES IN TRAFFIC SIGNAL POSTS OR MAST ARM POLES RESULTING FROM REMOVAL OF 3-SECTION SIGNAL HEADS SHALL BE COVERED WITH STAINLESS STEEL PLATES AND MOUNTING HARDWARE. THIS WORK SHALL BE CONSIDERED INCLUDED IN THE COST OF REMOVE EXISTING TRAFFIC SIGNAL EQUIPMENT.

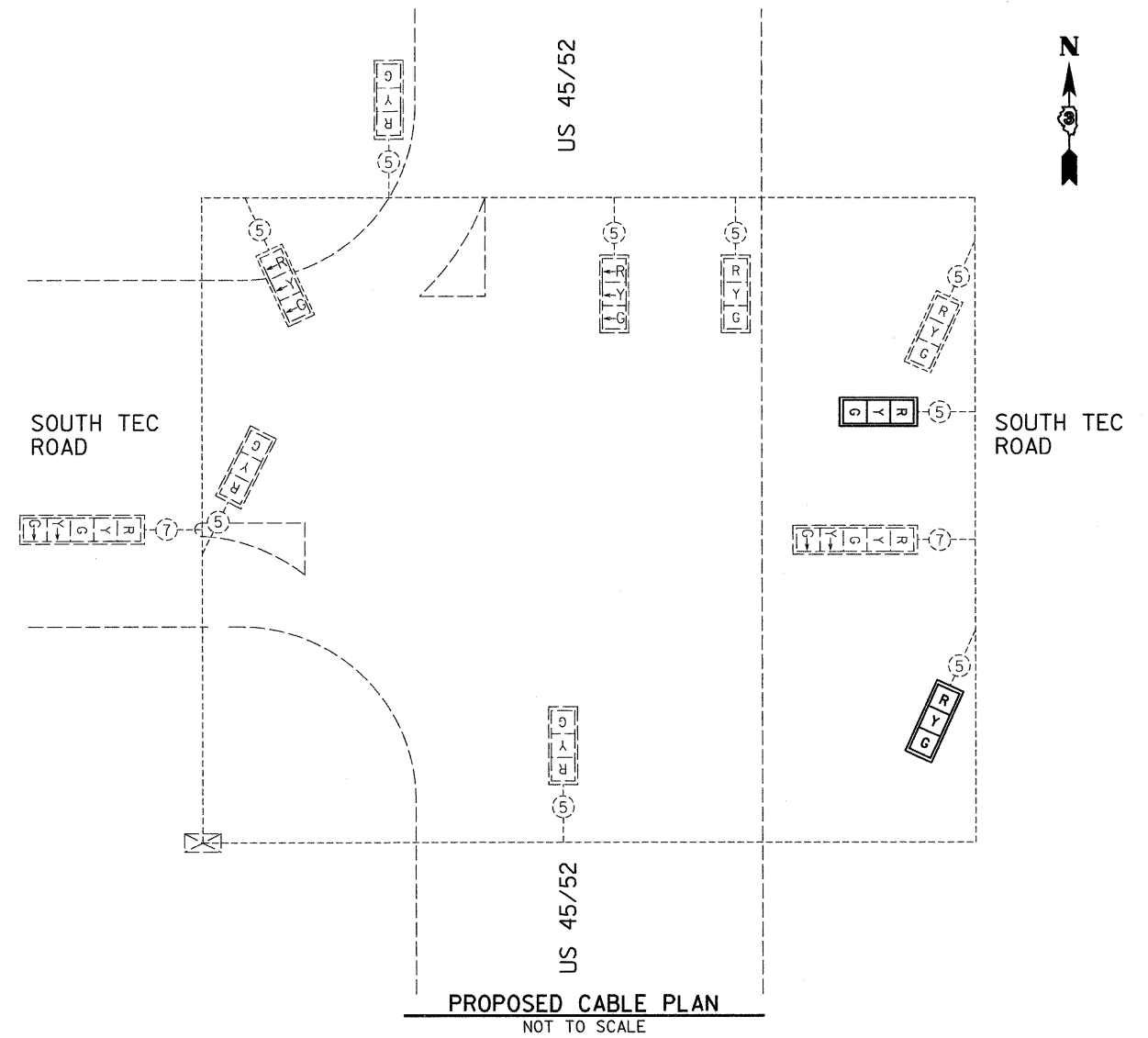

SCHEDULE OF QUANTITIES (96.7% STATE / 3.3% CITY)

KANKAKEE US 45/52 & SOUTH TEC ROAD			
ITEM NO.	DESCRIPTION	UNIT	TOTAL QUANTITY
86200300	UNINTERRUPTABLE POWER SUPPLY, EXTENDED	EACH	1
88040070	SIGNAL HEAD, POLYCARBONATE, LED, 1-FACE, 3-SECTION, BRACKET MOUNTED	EACH	2
88200410	TRAFFIC SIGNAL BACKPLATE, LOUVERED, FORMED PLASTIC	EACH	2
89502210	MODIFY EXISTING CONTROLLER CABINET	EACH	1
89502375	REMOVE EXISTING TRAFFIC SIGNAL EQUIPMENT	EACH	1

TRAFFIC SIGNALS LEGEND

	DENOTES NUMBER OF EXISTING CONDUCTORS
	EXISTING CONTROLLER AND CABINET
	SIGNAL SECTION 12"
	EXISTING SIGNAL SECTION 12"
	EXISTING LEFT TURN RED
	EXISTING LEFT TURN YELLOW
	EXISTING LEFT TURN GREEN
	EXISTING RIGHT TURN YELLOW
	EXISTING RIGHT TURN GREEN
	EXISTING TRAFFIC SIGNAL BACKPLATE
	TRAFFIC SIGNAL BACKPLATE

FILE NAME = 0366896-SHT-TS-CABLE-KANKAKEE-US45-SOUTH-TEC.DGN

USER NAME = ---
 PLOT SCALE = 1" = 20'
 PLOT DATE = 10/11

DESIGNED - --
 DRAWN - ARR/NV
 CHECKED - JKC
 DATE - 10/11

REVISED - ---
 REVISED - ---
 REVISED - ---
 REVISED - ---

**STATE OF ILLINOIS
 DEPARTMENT OF TRANSPORTATION**

**TRAFFIC SIGNAL CABLE PLAN
 KANKAKEE - US 45/52 & SOUTH TEC ROAD**

SCALE: 1" = 20' SHEET NO. ___ OF ___ SHEETS STA. _____ TO STA. _____

* IROQUOIS & KANKAKEE				
F.A. RTE.	SECTION	COUNTY	TOTAL SHEETS	SHEET NO.
--	D-3 LED RETROFIT 2012-4	•	17	14
			CONTRACT NO. 66B57	
[ILLINOIS] FED. AID PROJECT				