

B.M. #122 on bottle cap in fence post 178' Rt.  
 E. FAI 57 Sta. 403+44.25 Elev. 722.62.  
 No existing structures.

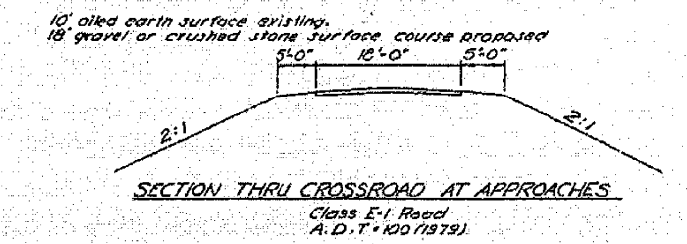
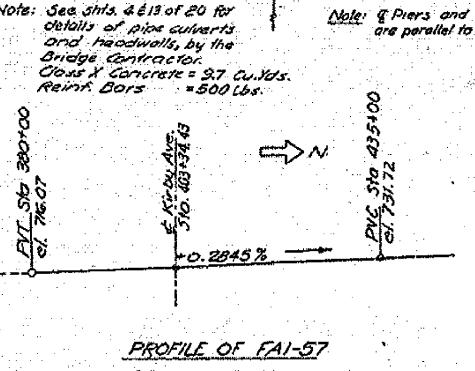
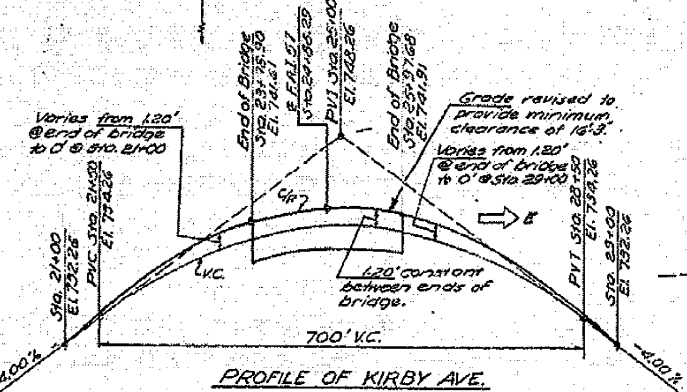
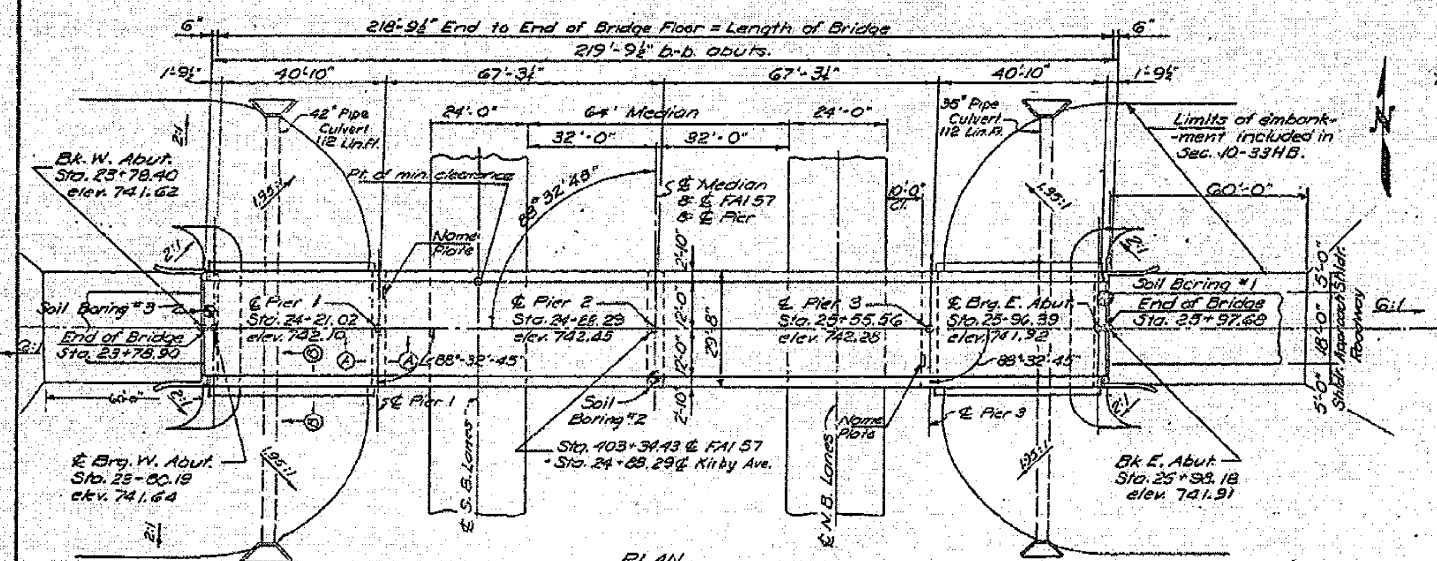
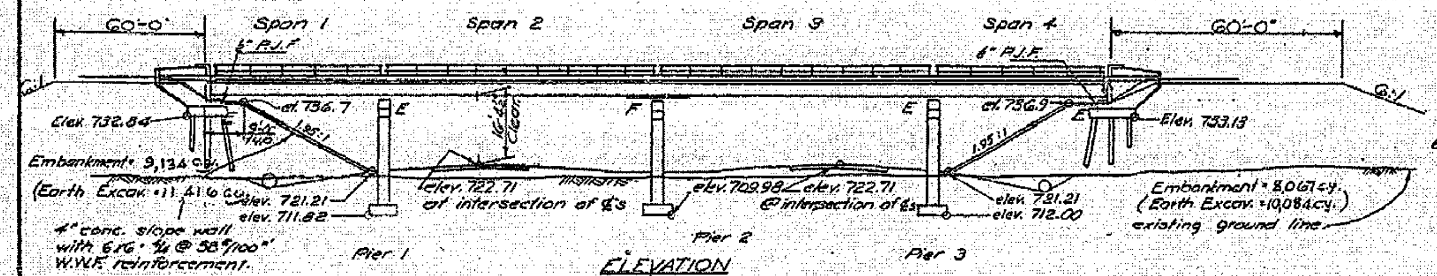

**DESIGN STRESSES**  
 $f_c = 4000$  psi  
 $f_s = 20,000$  psi (reinforcement)  
 $f_b = 18,000$  psi (structure)  
 $n = 10$   
 $v = 75$  psi (footings)

**LOADING**  
 H15 - S12-44

**BORING DATA**

Station	N	Qu	W	Notes
710	13	2.4	21.2	BROWN SILTY CLAY FIRM
	18	4.6	15.1	BROWN MOTTLED CLAY STIFF
	22	5.3	12.6	WATER ELEVATION AFTER 24 HOURS
	26	7.3	11.0	BROWN MOTTLED CLAY TILL
	30	7.7	11.0	VERY STIFF
700	22	7.7	11.1	BROWN MOTTLED CLAY TILL
	26	4.8	11.8	VERY STIFF
690	24	-	-	HARD GRAY CLAY TILL
	28	5.1	12.3	VERY STIFF
710	15	4.6	13.9	BROWN SILTY CLAY FIRM
	25	6.8	14.2	BROWN MOTTLED CLAY STIFF
	29	5.5	12.0	WATER ELEVATION AFTER 24 HOURS
	18	5.8	12.0	BROWN MOTTLED CLAY TILL
	23	4.6	12.6	VERY STIFF
700	18	5.1	12.3	GRAY CLAY TILL
	18	3.4	12.3	VERY STIFF

NOTE:  
 H = BLOWS PER FOOT OF PENETRATION OF SAMPLING SPOON, HAMMER WEIGHT 170 LBS. 0.888-21'-0".  
 QU = UNCONFINED COMPRESSIVE STRENGTH IN TONS PER SQUARE FOOT.  
 W = PERCENTAGE MOISTURE

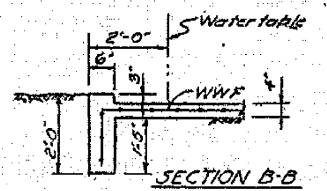
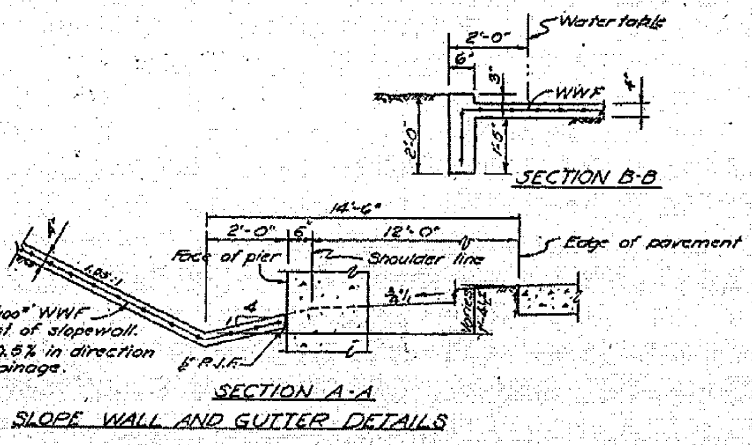
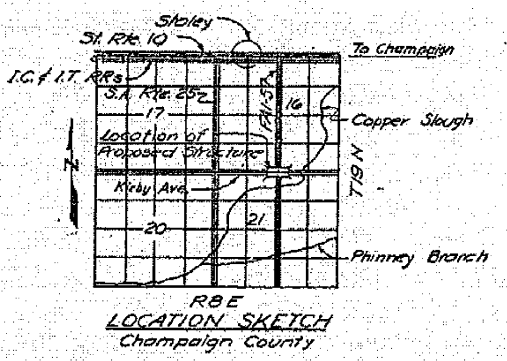

SHEET NO. 7	ROUTE NO. 10-33HB	COUNTY CHAMPAIGN	DATE 7-9-58	SHEET 6
F.A.I. 57 PROJECT I-57-5(12) CHAMPAIGN COUNTY				

- GENERAL NOTES**
- SPECIFICATIONS: THE STATE OF ILLINOIS STANDARD SPECIFICATIONS FOR ROAD AND BRIDGE CONSTRUCTION, ADOPTED JANUARY 2, 1956, SHALL APPLY.
  - CONCRETE: CLASS X CONCRETE SHALL BE USED THROUGHOUT. THE CONCRETE FLOOR SLAB SHALL BE FINISHED IN ACCORDANCE WITH ARTICLE 60.15 OF THE STANDARD SPECIFICATIONS. COURSE SAGREGRATE WHICH IS TO BE USED IN END PILES MUST BE ABSOLUTELY FREE OF CHERT, FLINT, LIMONITE, LIGHTITE, AND SOFT SAND STONE.
  - METAL HANDRAIL: ALL RAIL POSTS, ANCHOR DEVICES AND LEAD PLATES SHALL BE INCLUDED IN PAYMENT FOR LIN. FT. OF METAL HANDRAIL. THE LENGTH PAID FOR SHALL BE THE OVERALL LENGTH ALONG THE TOP LONGITUDINAL RAILING MEMBER THROUGH ALL POSTS AND GAPS.
  - CONCRETE PILES: SEE SPECIAL PROVISIONS FOR OPTIONAL TYPES AND BASIS OF PAYMENT.
  - TEST PILES: THE CONTRACTOR SHALL DRIVE ONE TEST PILE AT EACH ABUTMENT IN PERMANENT LOCATION IN ACCORDANCE WITH ARTICLE 60.15 OF THE STANDARD SPECIFICATIONS BEFORE ORDERING THE REMAINDER OF THE PILES.
  - EMBANKMENT: MATERIAL FOR CONSTRUCTING THE EMBANKMENT AT EACH ABUTMENT SHALL BE OBTAINED FROM WITHIN THE LIMITS OF THE RIGHT-OF-WAY BETWEEN STATIONS 348 AND 355 AND IS INCLUDED FOR PAYMENT AS EARTH EXCAVATION.
  - PRE-CORING: HOLES SHALL BE PRECURED FOR THE ABUTMENT PILES IN ACCORDANCE WITH ARTICLE 60.9 (C) OF THE STANDARD SPECIFICATIONS.
  - PAINT: EXCEPT AS OTHERWISE PROVIDED, ALL STRUCTURAL STEEL AND METAL HANDRAIL SHALL RECEIVE ONE SHOP COAT OF RED LEAD PAINT AND TWO FIELD COATS OF ALUMINUM PAINT IN ACCORDANCE WITH ARTICLES 55.1 THROUGH 55.5. ALL PAINT SHALL BE FURNISHED AND APPLIED BY THE CONTRACTOR.

STATION 403+34.43  
 BUILT BY  
 STATE OF ILLINOIS  
 F.A.I. 57 SEC. 10-33HB  
 PROJECT I-57-5(12)  
 LOADING H15-S12

**NAME PLATE DATA**  
 See Standard 2113  
 Locate as shown on Sht. 9 of 21.

**TOTAL BILL OF MATERIAL**

ITEM	UNIT	SUPER	SUBSTR.	TOTAL
Class X Concrete	Cu. Yds.	173.6	217.2	390.8
Reinforcement Bars	Lbs.	32,393	16,869	49,262
Structural Steel	Lbs.	144,230	-	144,230
Metal Handrail	Lin. Ft.	435	-	435
Name Plates	Ea.	-	2	2
Slope Wall	Sq. Yds.	-	340	340
Class A Excav. for Structs.	Cu. Yds.	-	328	328
Concrete Piles	Lin. Ft.	-	610	610
Test Piles (Concrete)	Ea.	-	1	1
Pipe Culverts 72" dia.	36' Lin. Ft.	-	112	112
Pipe Culverts 42" dia.	32' Lin. Ft.	-	112	112
Earth Excavation	Cu. Yds.	2,500	-	2,500

STATE OF ILLINOIS  
 DEPARTMENT OF PUBLIC WORKS AND BUILDINGS  
 DIVISION OF HIGHWAYS

1	Vertical clearance and handrail	CBP 5-25-20
NO.	REVISION	BY DATE
GENERAL PLAN AND ELEVATION		
SECTION 10-33HB	STATION 403+34.43	
F.A.I. 57	PROJECT I-57-5(12)	
CHAMPAIGN COUNTY		
CLARK, DAILY & DIETZ CONSULTING ENGINEERS URBANA, ILLINOIS		
DESIGNED CBP	SCALE AS NOTED	SHEET 1
DRAWN RWA	CHECKED CBP	DATE 9-15-58
CD & D. NO. 394-V7		OF 7

Revised Bridge Data 11-22-51 (H&I/ML)  
 Rev. Bill of Material Pipe Culverts to Type 2A J03 9-28-61