

LOCATION 4 WB KIRBY AVE; KIRBY & DUNCAN

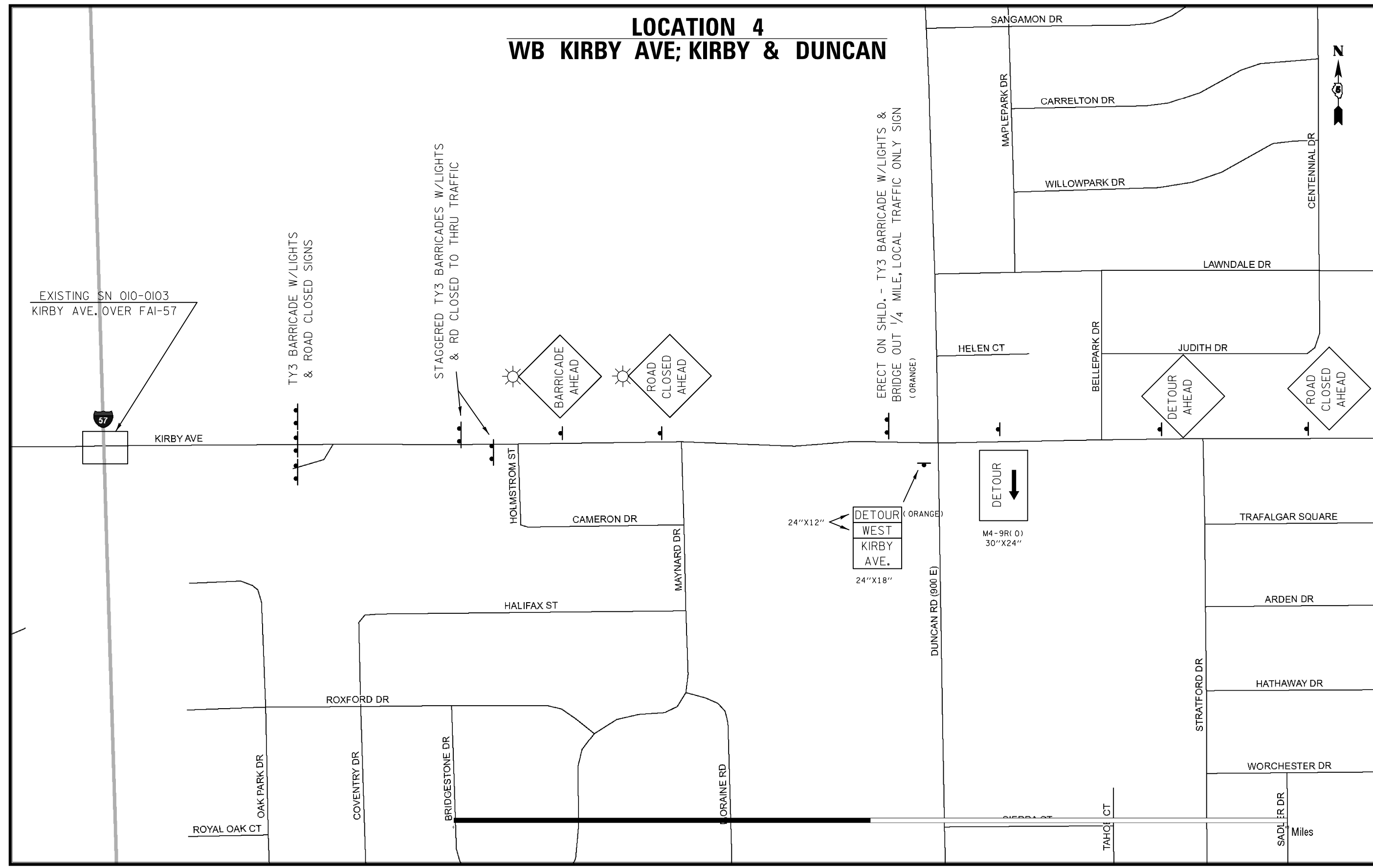

EXISTING SN 010-0103
KIRBY AVE. OVER FAI-57

TY3 BARRICADE W/LIGHTS
& ROAD CLOSED SIGNS

STAGGERED TY3 BARRICADES W/LIGHTS
& RD CLOSED TO THRU TRAFFIC

ERECT ON SHLD. - TY3 BARRICADE W/LIGHTS &
BRIDGE OUT 1/4 MILE, LOCAL TRAFFIC ONLY SIGN
(ORANGE)

24"x12" DETOUR WEST KIRBY AVE. 24"x18" (ORANGE)

DETOUR
M4-9R(0)
30"x24"

FILE NAME =	USER NAME = bucklesjj	DESIGNED -	REVISED -
et:\pw\work\p\dot\bucklesjj\d0265817\0570924-sht-Details.dgn		DRAWN -	REVISED -
PLOT SCALE = 40.0000' / in.		CHECKED -	REVISED -
PLOT DATE = 10/5/2011		DATE -	REVISED -

**STATE OF ILLINOIS
DEPARTMENT OF TRANSPORTATION**

DETOUR SIGNING

SCALE: SHEET NO. 5 OF 5 SHEETS STA. TO STA.

F.A.I. RTE.	SECTION	COUNTY	TOTAL SHEETS	SHEET NO.
57	(10-33HB)BDR	Champaign	27	27
CONTRACT NO. 70924				
ILLINOIS FED. AID PROJECT				