

PROJECT NO.	SECTION	DATE	BY	CHKD.
FA 34	2 BR	MENARD MASON	57	21
Sheet 15 of 35				

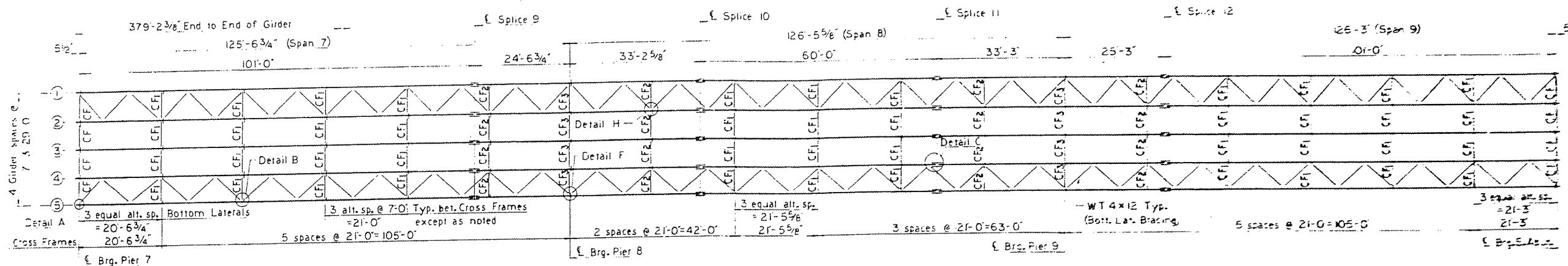

All Structural Steel shall be AASHTO M-183 except as noted.
NTR-Designates Notch Toughness Requirements.

*Plate shall be AASHTO M-223, Grade 50 Steel.

1. See Sheet 16 for details of CF & CF1.
2. See Sheet 17 for details of CF2, CF3 & Details A, B, C, F & H.
3. See Sheet 17 for Moment & Reaction table.

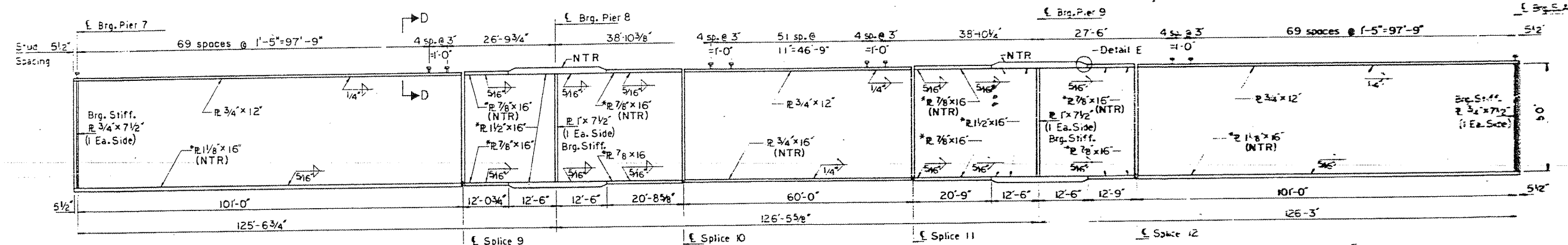

All Web plates to be 1/2" x 50" (NTR).

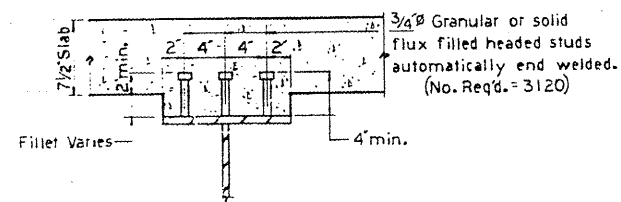

SECTION D-D

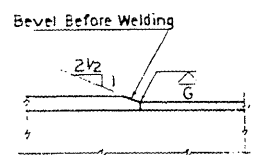

DETAIL E

TOP OF GIRDER WEB ELEVATIONS

	G 1 or 5	G 2 or 4	G 3
€ Brq Pier 7	482.92	483.05	483.16
€ Splice 9	483.48	483.61	483.72
€ Brq Pier 8	483.45	483.58	483.69
€ Splice 10	483.42	483.55	483.66
€ Splice 11	483.41	483.54	483.65
€ Brq Pier 9	483.43	483.56	483.67
€ Splice 12	483.44	483.57	483.68
€ Brq S Abut	482.86	482.99	483.10

Elevations at Splices have been adjusted for dead load deflections.
The above Elevations are for fabrication only.

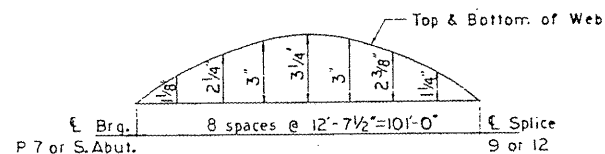

CAMBER DIAGRAM

No camber between € Splice 9 & € Splice 12.

GIRDER ELEVATION

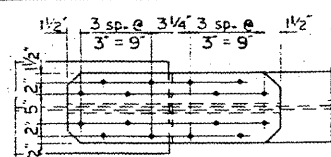

FIELD SPICE DETAIL

For Splices 9 & 12
Use 3/8" H.S. Bolts

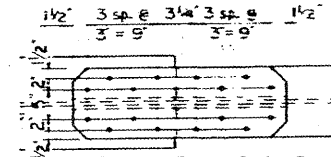

FIELD SPICE DETAIL

For Splices 10 & 11
Use 3/8" H.S. Bolts

Est. 2. #1
M-183 - 272 140 lbs. (incl. Bearings)
M-223 - 40 110 lbs.

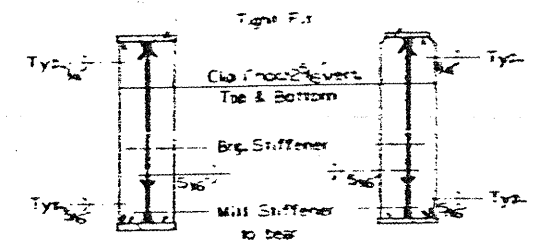

SECTION AT PIERS 8 & 9
SECTION AT S. ABUTMENT & PIER 7

UNIT III
STRUCTURAL STEEL
PART 34 SEC 2 BR
MASON-MENARD COUNTY
STA 730+40.73

EXISTING PLANS, SN 065-0002
VARIOUS ROUTES
D6REHAB BDGE PAINTING 2012
MENARD, SANGAMON COUNTIES

FOR INFORMATION ONLY