

PC STA 141+12.78
MAG NAIL W/ WASHER

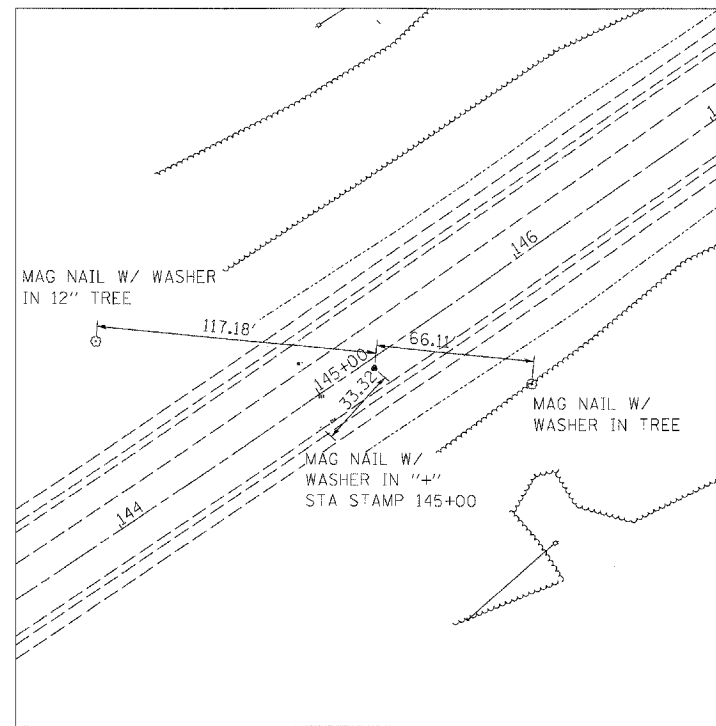

PI STA 145+25.13
MAG NAIL W/ WASHER

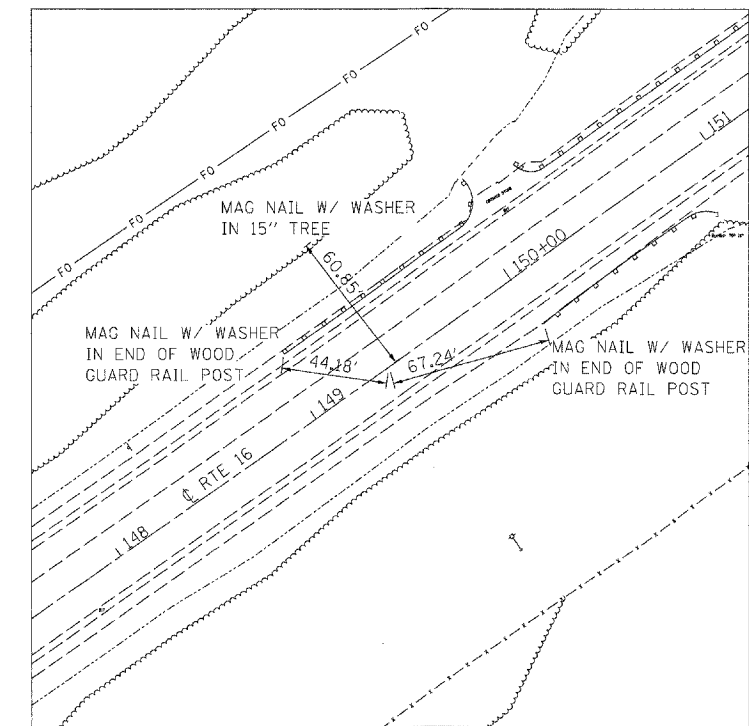

PT STA 149+37.40
MAG NAIL W/ WASHER

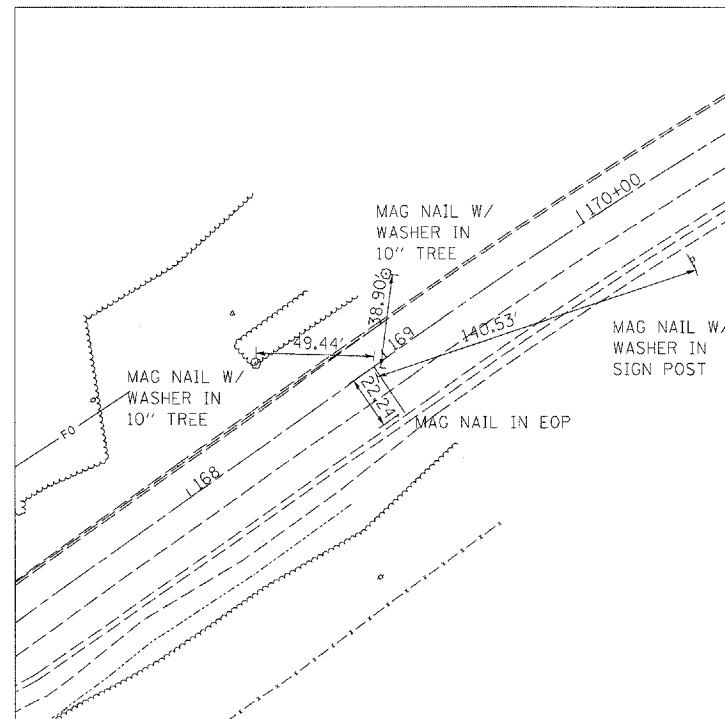

PT STA 168+93.53
MAG NAIL W/ WASHER

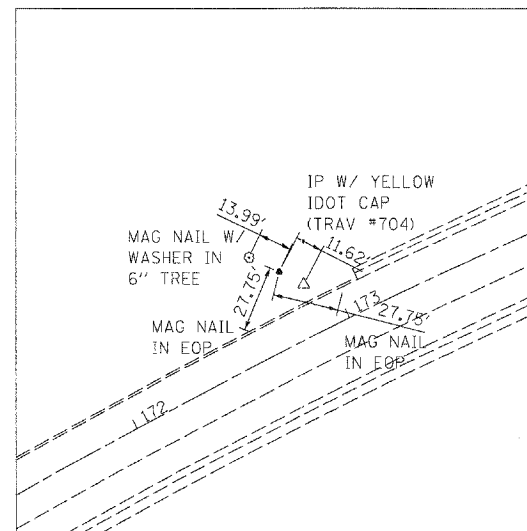

PT STA 172+85.38
IP W/ YELLOW CAP

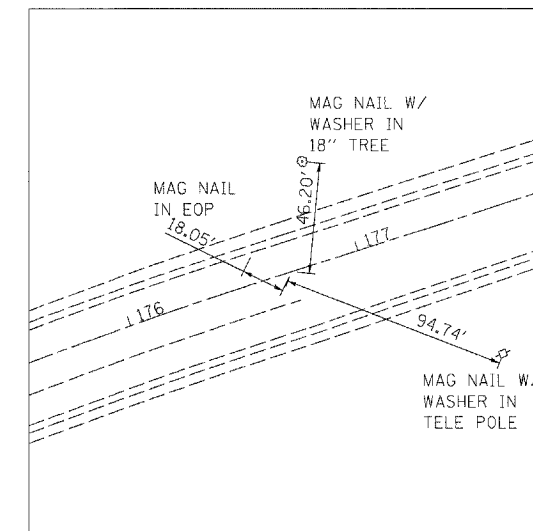

PT STA 176+70.96
MAG NAIL

BENCHMARK DATA:

- BM1 TO REACH FROM THE INTERSECTION OF IL16 AND MADISON AVE GO EAST ON IL16 FOR 0.45 MILES TO MARK ON THE RIGHT. MARK IS LOCATED IN THE NE QUAD OF 1880E RD AND IL16. SAID MARK IS A CHISELED SQUARE ON THE TOP OF THE NORTH END OF THE EAST HEADWALL OF AR CULVERT. ELEV = 667.444
- BM2 TO REACH FROM THE INTERSECTION OF MADISON AVE AND IL16 GO EAST ON IL16 FOR 1.3 MILES TO MARK ON THE LEFT. SAID MARK IS A CHISELED SQUARE LOCATED ON THE TOP OF THE NE WINGWALL OF BRIDGE OVER THE EMBARRASS. ELEV = 597.427
- BM3 TO REACH FROM THE INTERSECTION OF IL 16 AND 1990E GO WEST ON IL 16 FOR 150' TO MARK ON THE LEFT. SAID MARK IS A CHISELED SQUARE LOCATED ON THE NW CORNER OF CONCRETE FOUNDATION OF A TELEPHONE PEDESTAL. 8' NORTH OF A POWER POLE. ELEV = 672.109

PRINTED DATE: 5/11/2011
FILE NAME: m:\projects\148\item 25 - 07\various design\work order_07\add\drawings\Sheet\11.Less.Bench.dwg



USER NAME = suser@	DESIGNED - JEH	REVISED -
PLOT SCALE = 40.0000' / IN.	DRAWN - JEH	REVISED -
PLOT DATE = 5/11/2011	CHECKED - PAT	REVISED -
	DATE - 05-11-2011	REVISED -

**STATE OF ILLINOIS
DEPARTMENT OF TRANSPORTATION**

**ALIGNMENT TIES AND
BENCHMARKS**

SHEET NO. 1 OF 1 SHEETS

F.A.P. RTE.	SECTION	COUNTY	TOTAL SHEETS	SHEET NO
91	(5BR)B-1	COLES	91	11
CONTRACT NO 74244				
ILLINOIS FED. AID PROJECT				