

**STAGE I REMOVAL**

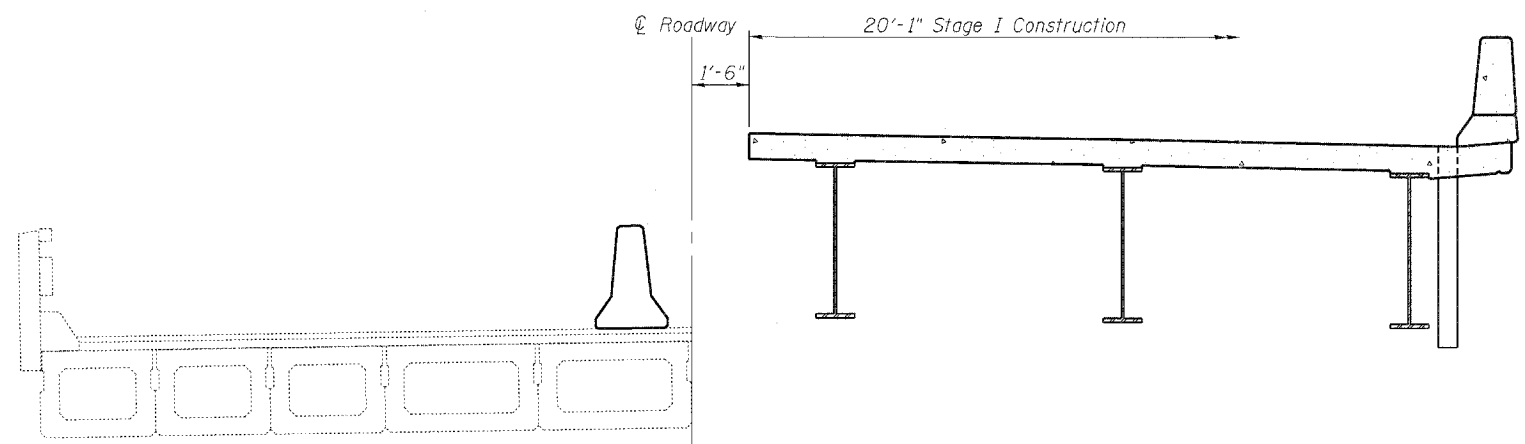

**STAGE I CONSTRUCTION**

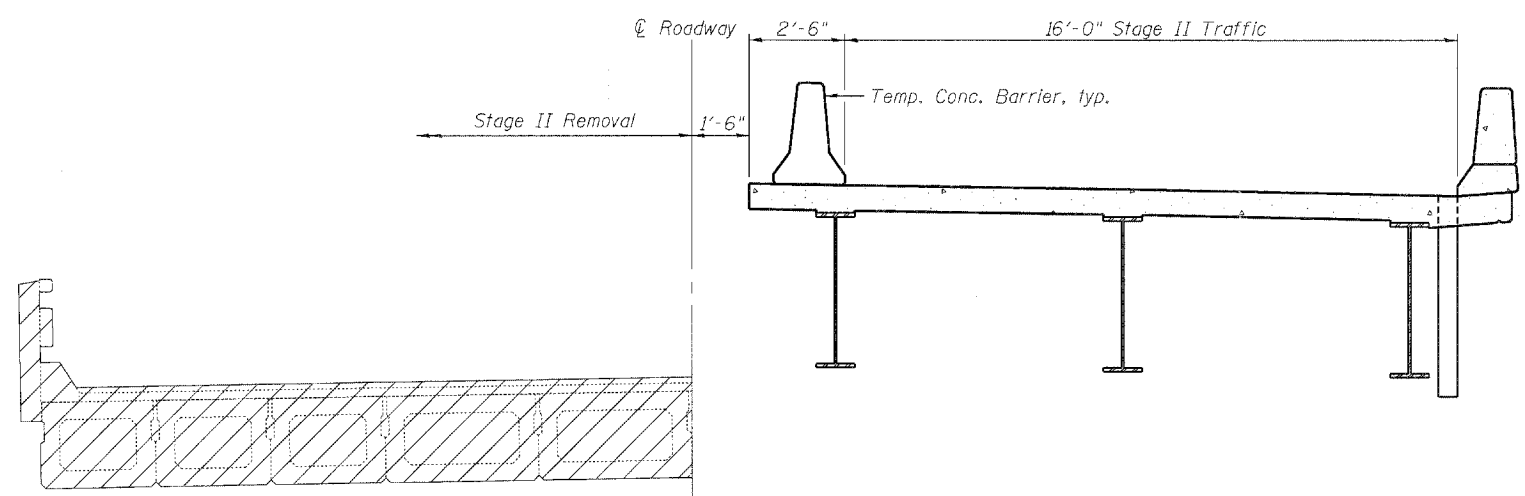

**STAGE II REMOVAL**

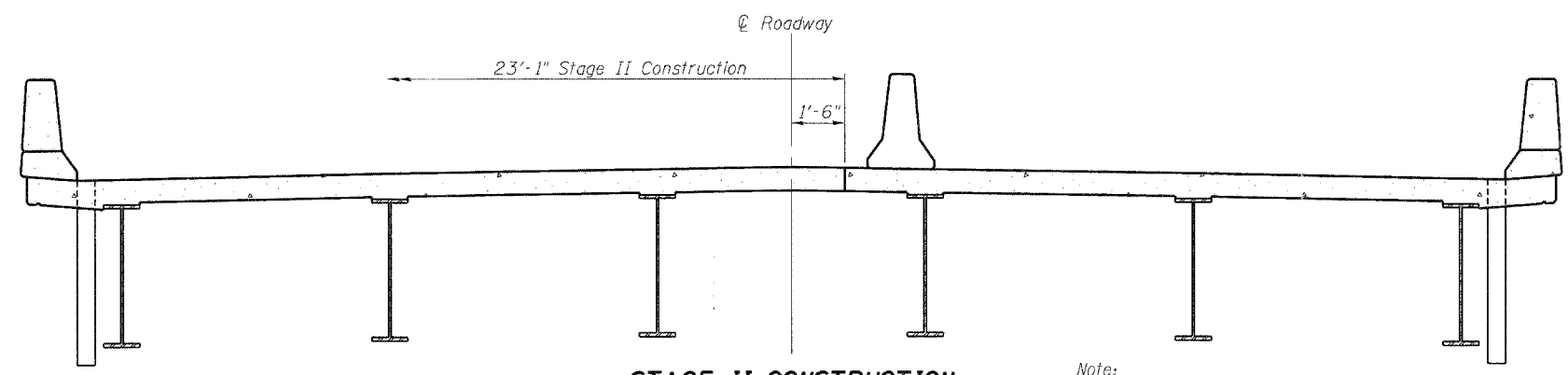

**STAGE II CONSTRUCTION**

(All staging cross sections are looking east.)

Note:  
Hatched area indicates Removal of Existing Structures.  
For quantity of Temporary Concrete Barriers see Roadway Plans.

**GENERAL NOTES**

Fasteners shall be AASHTO M164 Type 1, mechanically galvanized bolts in painted areas and M164 Type 3 in unpainted areas. Bolts 7/8-in.  $\phi$ , holes 15/16-in.  $\phi$ , unless otherwise noted.  
 Calculated weight of Structural Steel = 381,100 lbs.  
 All structural steel shall be AASHTO M 270 Grade 50W. All structural steel shall be cleaned as specified in the Special Provision for "Surface Preparation and Painting Requirements for Weathering Steel".  
 No field welding is permitted except as specified in the contract documents.  
 Reinforcement bars shall conform to the requirements of ASTM A 706 Gr 60. See Special Provisions.  
 Reinforcement bars designated (E) shall be epoxy coated.  
 Bearing seat surfaces shall be constructed or adjusted to the designated elevations within a tolerance of 1/8 inch (0.01 ft.). Adjustment shall be made either by grinding the surface or by shimming the bearings.  
 Structural steel shall only be painted for a distance equal to the depth of embedment into the concrete cap plus 3 inches. Painted areas shall be primed in the shop with a Department approved zinc rich primer. Field painting will not be required.  
 Layout of slope protection system may be varied to suit ground conditions in the field as directed by the Engineer.  
 The embankment configuration shown shall be the minimum that must be placed and compacted prior to construction of the abutments.  
 The Contractor is advised that the existing PPC Deck Beams are in a deteriorated condition with reduced load carrying capacity. It is the contractor's responsibility to account for the condition of the beams when developing construction procedures for and removal and replacement of the superstructure.  
 Slipforming of the parapets is not allowed.

**TOTAL BILL OF MATERIAL**

ITEM	UNIT	SUPER	SUB	TOTAL
Structure Excavation	Cu. Yd.	-	154.9	154.9
Floor Drains	Each	10	-	10
Concrete Structures	Cu. Yd.	-	213.0	213.0
Concrete Superstructure	Cu. Yd.	586.6	-	586.6
Bridge Deck Grooving	Sq. Yd.	1,574	-	1,574
Porous Granular Embankment (Special)	Cu. Yd.	-	160.4	160.4
Concrete Encasement	Cu Yd	-	5.6	5.6
Protective Coat	Sq. Yd.	1,943	-	1,943
Stone Riprap, Class A4	Sq. Yd.	-	-	2,098
Furnishing and Erecting Structural Steel	L. Sum	1	-	1
Stud Shear Connectors	Each	5,544	-	5,544
Reinforcement Bars	Pound	-	14,220	14,220
Reinforcement Bars, Epoxy Coated	Pound	151,650	25,610	177,260
Bar Splicers	Each	1,432	342	1,774
Filter Fabric	Sq. Yd.	-	-	2,098
Furnishing Steel Piles HP 12x63	Foot	-	448	448
Driving Piles	Foot	-	448	448
Test Pile Steel HP 12x63	Each	-	2	2
Pile Shoes	Each	-	16	16
Name Plates	Each	-	-	1
Drilled Shaft in Soil	Cu. Yd.	-	44.0	44.0
Removal of Existing Structures	Each	-	-	1
Drilled Shaft in Rock	Cu. Yd.	-	14.6	14.6
Anchor Bolt 1"	Each	-	24	24
Anchor Bolt 1/4"	Each	-	24	24
Geocomposite Wall Drain	Sq. Yd.	-	95.6	95.6
Pipe Underdrains for Structures, 4"	Foot	-	121.0	121.0
Underwater Structure Excavation Protection, Location 1	Each	-	1	1
Underwater Structure Excavation Protection, Location 2	Each	-	1	1
Temporary Soil Retention System	Sq. Ft.	-	-	918.5
Mechanical Splicers	Each	-	96	96
Asbestos Bearing Pad Removal	Each	140	-	140

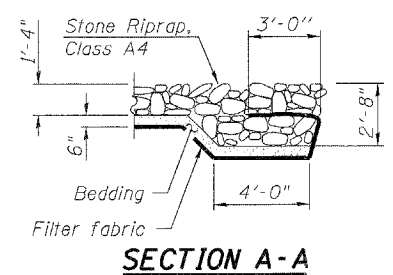

**SECTION A-A**

(Sheet 1 of 2)

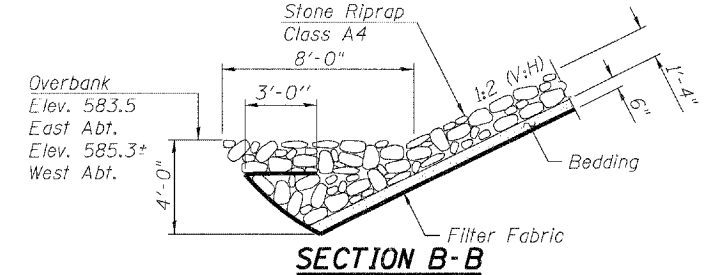

**SECTION B-B**

PRINTED DATE: 10/10/2011  
 FILE NAME: N:\PROJECTS\DOT\PTB 148, Item 25 - 07, Various Design\Work Order 87\CAD\Drawings\Sheets\37\_P116\_GPE\_2.dgn



DESIGNED - DF	REVISED -
CHECKED - ADG, SA	REVISED -
DRAWN - ADG	REVISED -
CHECKED - DF	REVISED -

DESIGNED - DF	REVISED -
CHECKED - ADG, SA	REVISED -
DRAWN - ADG	REVISED -
CHECKED - DF	REVISED -

**STATE OF ILLINOIS  
DEPARTMENT OF TRANSPORTATION**

**GENERAL DATA & STAGE CONSTRUCTION DETAILS  
STRUCTURE NO. 015-0075**

SHEET NO. 02 OF 24 SHEETS

F.A.P. RTE. 91	SECTION (5BR)B-1	COUNTY COLES	TOTAL SHEETS 91	SHEET NO. 37
FED. ROAD DIST. NO. ILLINOIS FED. AID PROJECT			CONTRACT NO. 74244	