

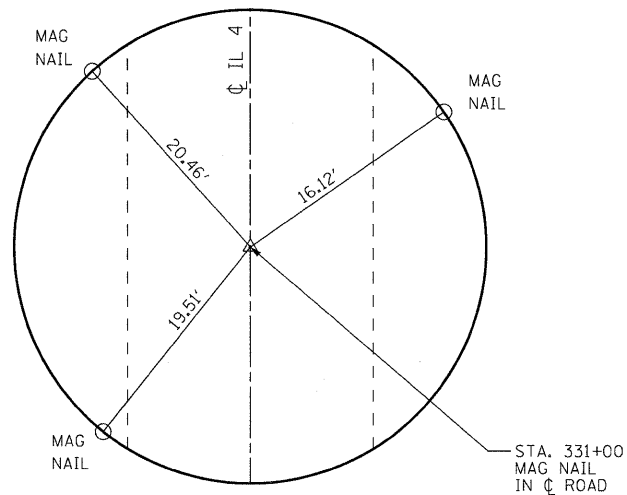

BM 1: RR SPIKE IN POWER POLE (IN EAST SIDE OF POLE), 300'± NORTH OF SN 082-0082 ON THE WEST SIDE OF IL 4.
STATION 340+62, OFFSET 29.5' LT, ELEVATION 418.70

TBM 1: CHISELED "□" IN THE CENTER OF A CONCRETE HEADWALL IN THE SOUTHWEST QUADRANT OF IL 4 AND DARMSTADT ROAD.
36' WEST OF CENTERLINE IL 4, ELEVATION 436.08.

TBM 2: CUT "□" ON THE SOUTHWEST WINGWALL OF EXISTING BRIDGE ON IL 4 OVER LITTLE MUD CREEK, SN 082-0082.
STATION 337+53, OFFSET 16.8' LEFT, ELEVATION 419.25.



EXISTING ALIGNMENT - STATION 331+00

N. 605,737.3277 E. 2,424,148.2338

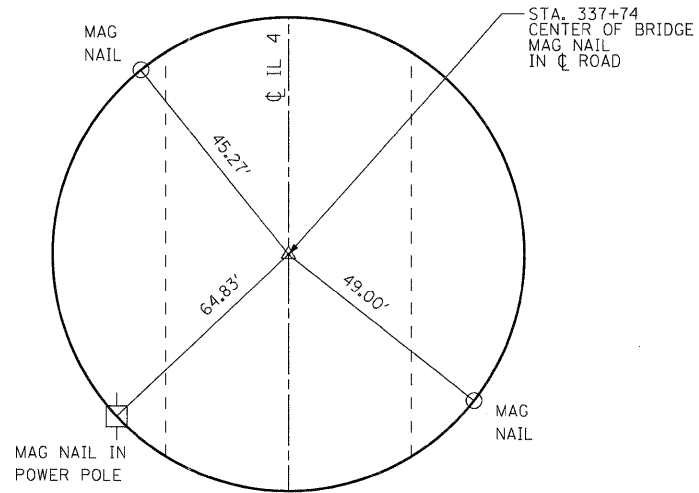

EXISTING ALIGNMENT - STATION 337+74

N. 606,411.2841 E. 2,424,140.5622

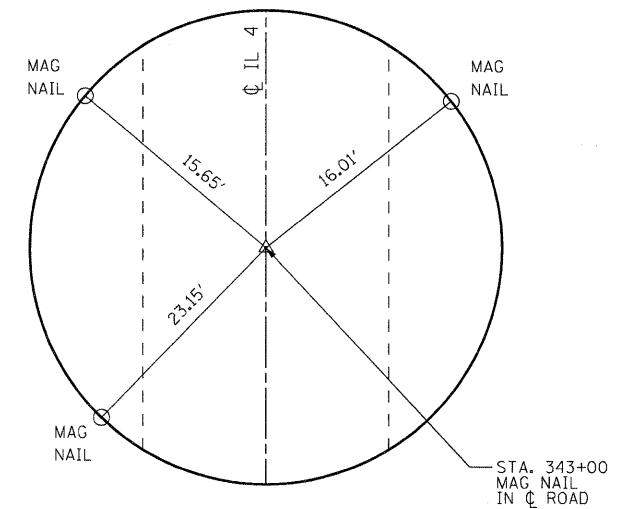

EXISTING ALIGNMENT - STATION 343+00

N. 606,937.2500 E. 2,424,134.5751

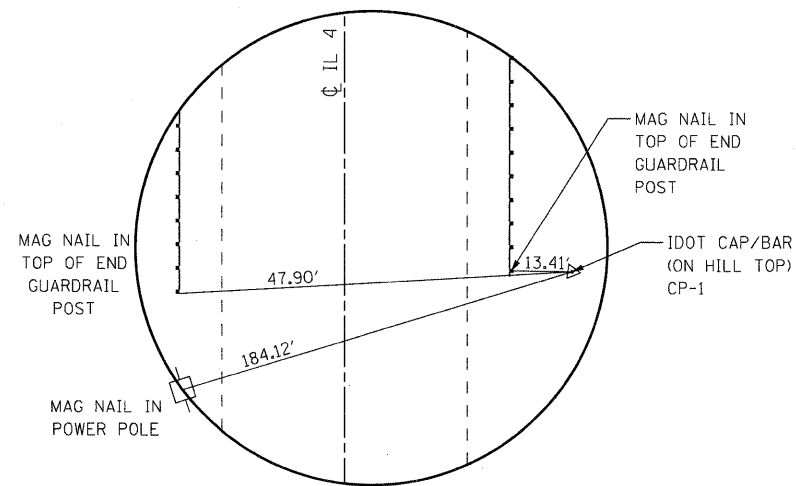

CONTROL POINT 1

STA. 335+38.28
OFFSET 30.43' RT
N. 606,175.9209 E. 2,424,173.6743

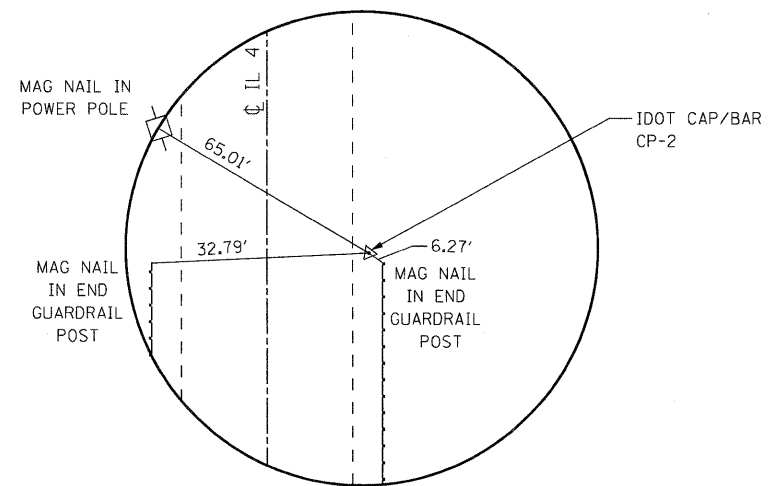

CONTROL POINT 2

STA. 340+15.64
OFFSET 14.96' RT
N. 606,653.0801 E. 2,424,152.7712

NOTES:
NOT TO SCALE.
ALL TIES ARE PULLED DIRECT.

FILE NAME =	USER NAME = therpr1	DESIGNED -	REVISED -
es:\pw_work\pwwork\therpr1\dms84268\0876888-sht-ATB.dgn		DRAWN -	REVISED -
		CHECKED -	REVISED -
		DATE -	REVISED -

**STATE OF ILLINOIS
DEPARTMENT OF TRANSPORTATION**

TIES & BENCHMARKS	
SCALE: NONE	SHEET NO. 1 OF 1 SHEETS
STA.	TO STA.

F.A.P. RTE.	SECTION	COUNTY	TOTAL SHEETS	SHEET NO.
680	47-1BR	ST. CLAIR	44	4
FED. ROAD DIST. NO.			ILLINOIS FED. AID PROJECT	
CONTRACT NO. 76388				