

NORTH EDGE OF SHOULDER

Location	Station	Offset	Theoretical Grade Elevations
W. End West Appr. Pav't	704+89.84	14.00	495.65
A1	704+99.84	14.00	495.75
A2	705+09.84	14.00	495.84
E. End West Appr. Pav't	705+19.84	14.00	495.93

EASTBOUND PGL & NORTH EDGE OF PAVEMENT

Location	Station	Offset	Theoretical Grade Elevations
W. End West Appr. Pav't	704+93.30	20.00	495.81
A1	705+03.30	20.00	495.91
A2	705+13.30	20.00	496.00
E. End West Appr. Pav't	705+23.30	20.00	496.09

CL ROADWAY

Location	Station	Offset	Theoretical Grade Elevations
W. End West Appr. Pav't	705+00.23	32.00	496.06
A1	705+10.23	32.00	496.15
A2	705+20.23	32.00	496.24
E. End West Appr. Pav't	705+30.23	32.00	496.33

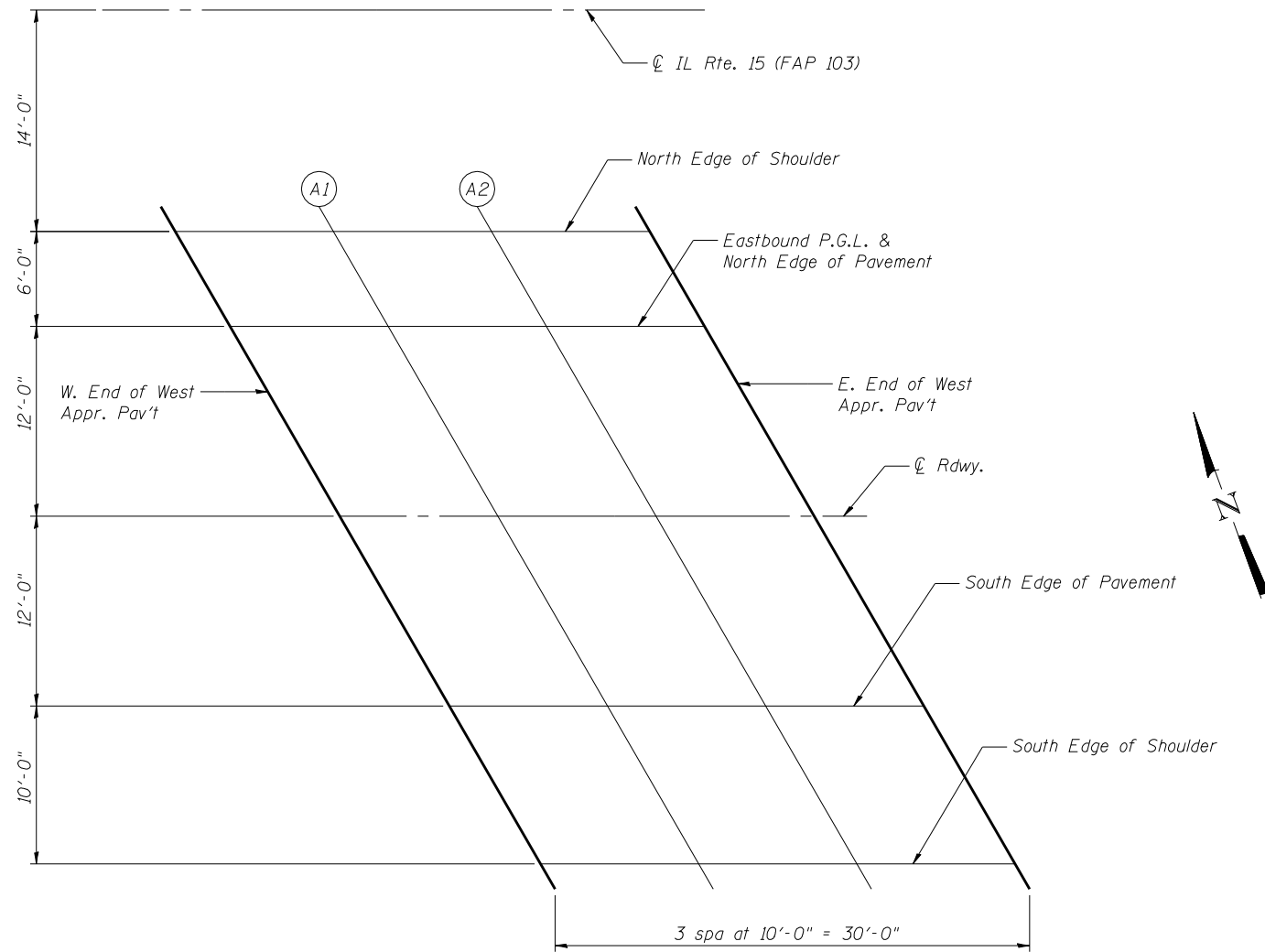

SOUTH EDGE OF PAVEMENT

Location	Station	Offset	Theoretical Grade Elevations
W. End West Appr. Pav't	705+07.16	44.00	495.94
A1	705+17.16	44.00	496.04
A2	705+27.16	44.00	496.12
E. End West Appr. Pav't	705+37.16	44.00	496.20

SOUTH EDGE OF SHOULDER

Location	Station	Offset	Theoretical Grade Elevations
W. End West Appr. Pav't	705+12.93	54.00	495.79
A1	705+22.93	54.00	495.88
A2	705+32.93	54.00	495.96
E. End West Appr. Pav't	705+42.93	54.00	496.04

PLAN
West Approach (E.B.)

E-AS1

FILE NAME = 0820117-0118-76884-013-East-Appr-Elv-EB.dgn



USER NAME = brazzera	DESIGNED - RAB	REVISED -
	CHECKED - BTO	REVISED -
PLOT SCALE = 0x2.0000 '1' / IN.	DRAWN - RAB	REVISED -
PLOT DATE = 10/19/2011	CHECKED - JAN	REVISED -

STATE OF ILLINOIS
DEPARTMENT OF TRANSPORTATION

WEST E.B. APPROACH SLAB ELEVATIONS
STRUCTURE NO. 082-0117 (E.B.) & 082-0118 (W.B.)

SHEET NO. 5-13 OF 5-62 SHEETS

F.A.P. RTE.	SECTION	COUNTY	TOTAL SHEETS	SHEET NO.
103	27-1-VHB-1	ST. CLAIR	277	128
CONTRACT NO. 76884				
ILLINOIS FED. AID PROJECT				