

NORTH EDGE OF SHOULDER

Location	Station	Offset	Theoretical Grade Elevations
W. End East Appr. Pav't	708+69.60	14.00	495.50
A3	708+79.60	14.00	495.39
A4	708+89.60	14.00	495.28
E. End East Appr. Pav't	708+99.60	14.00	495.16

EASTBOUND PGL & NORTH EDGE OF PAVEMENT

Location	Station	Offset	Theoretical Grade Elevations
W. End East Appr. Pav't	708+73.06	20.00	495.39
A3	708+83.06	20.00	495.26
A4	708+93.06	20.00	495.12
E. End East Appr. Pav't	709+03.06	20.00	494.98

CL ROADWAY

Location	Station	Offset	Theoretical Grade Elevations
W. End East Appr. Pav't	708+79.99	32.00	495.06
A3	708+89.99	32.00	494.90
A4	708+99.99	32.00	494.73
E. End East Appr. Pav't	709+09.99	32.00	494.56

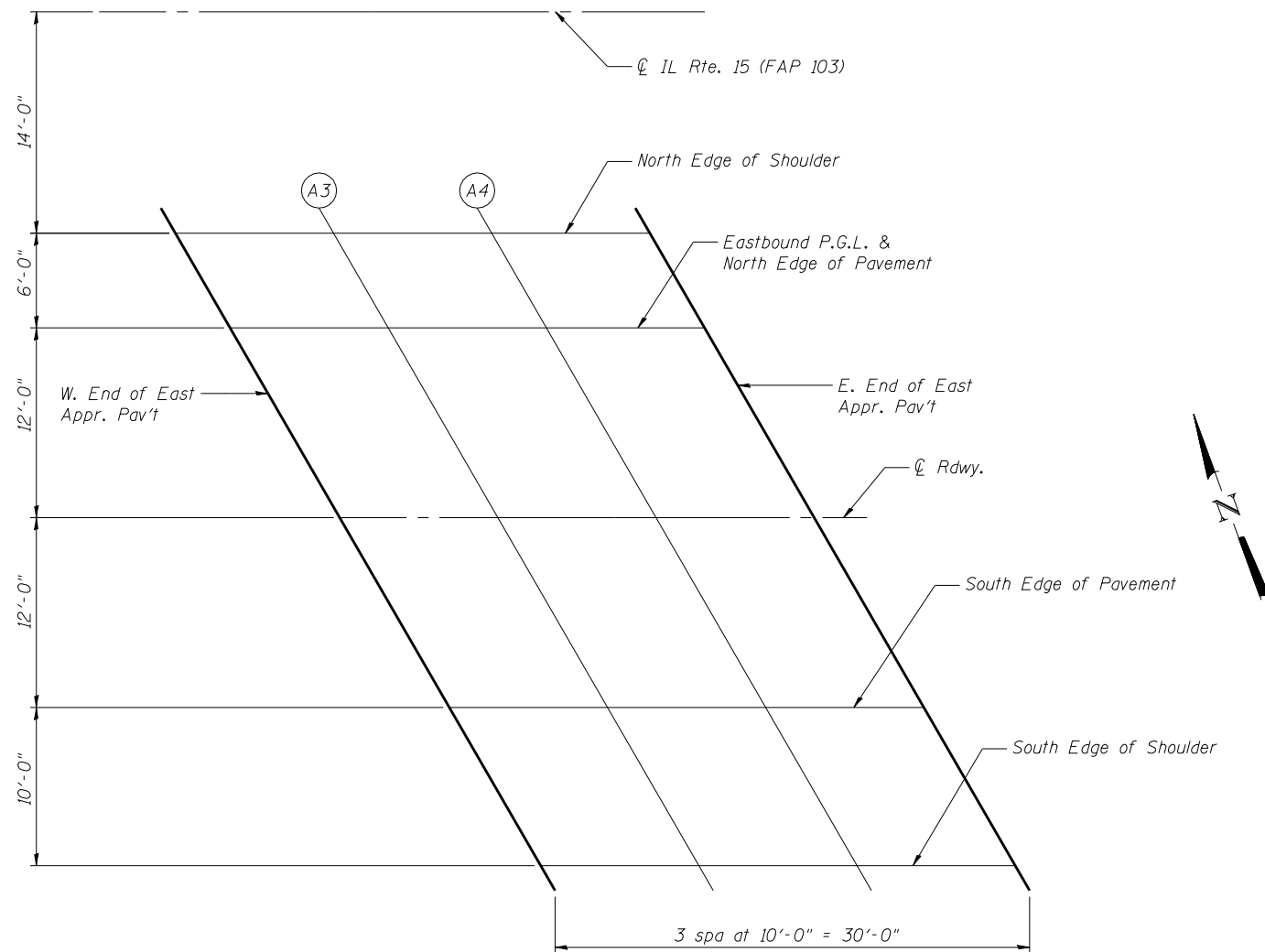

SOUTH EDGE OF PAVEMENT

Location	Station	Offset	Theoretical Grade Elevations
W. End East Appr. Pav't	708+86.92	44.00	494.69
A3	708+96.92	44.00	494.50
A4	709+06.92	44.00	494.30
E. End East Appr. Pav't	709+16.92	44.00	494.09

SOUTH EDGE OF SHOULDER

Location	Station	Offset	Theoretical Grade Elevations
W. End East Appr. Pav't	708+92.69	54.00	494.31
A3	709+02.69	54.00	494.10
A4	709+12.69	54.00	493.87
E. End East Appr. Pav't	709+22.69	54.00	493.64

PLAN
East Approach (E.B.)

E-ASI



USER NAME = brazzera	DESIGNED - RAB	REVISED -
	CHECKED - BTO	REVISED -
PLOT SCALE = 0x2.0000 '1' / IN.	DRAWN - RAB	REVISED -
PLOT DATE = 10/19/2011	CHECKED - JAN	REVISED -

STATE OF ILLINOIS
DEPARTMENT OF TRANSPORTATION

EAST E.B. APPROACH SLAB ELEVATIONS
STRUCTURE NO. 082-0117 (E.B.) & 082-0118 (W.B.)

SHEET NO. 5-14 OF 5-62 SHEETS

F.A.P. RTE.	SECTION	COUNTY	TOTAL SHEETS	SHEET NO.
103	27-1-VHB-1	ST. CLAIR	277	129
CONTRACT NO. 76884				
ILLINOIS FED. AID PROJECT				

FILE NAME = 082017-0118-76884-014-WestAppr-ElevEB.dgn