

BEAM 1

| Location | Station | Offset | Theoretical Grade Elevations | Theoretical Grade Elevations Adjusted For Dead Load Deflection |
|------------------|-----------|--------|------------------------------|--|
| Back of W. Abut. | 709+26.42 | -53.64 | 495.93 | 495.93 |
| ⊘ Brg. W. Abut. | 709+29.09 | -53.58 | 495.90 | 495.90 |
| A | 709+38.94 | -53.37 | 495.79 | 495.81 |
| B | 709+48.80 | -53.19 | 495.66 | 495.72 |
| C | 709+58.65 | -53.03 | 495.53 | 495.60 |
| D | 709+68.50 | -52.90 | 495.31 | 495.40 |
| E | 709+78.36 | -52.80 | 495.09 | 495.19 |
| F | 709+88.21 | -52.73 | 494.86 | 494.96 |
| G | 709+98.06 | -52.68 | 494.63 | 494.73 |
| H | 710+07.92 | -52.67 | 494.39 | 494.48 |
| I | 710+17.77 | -52.68 | 494.15 | 494.23 |
| J | 710+27.63 | -52.71 | 493.90 | 493.96 |
| K | 710+37.48 | -52.78 | 493.65 | 493.69 |
| L | 710+47.34 | -52.87 | 493.39 | 493.40 |
| ⊘ Brg. E. Abut. | 710+52.28 | -52.93 | 493.26 | 493.26 |
| Back of E. Abut. | 710+54.96 | -52.96 | 493.19 | 493.19 |

BEAM 2

| Location | Station | Offset | Theoretical Grade Elevations | Theoretical Grade Elevations Adjusted For Dead Load Deflection |
|------------------|-----------|--------|------------------------------|--|
| Back of W. Abut. | 709+29.34 | -48.24 | 495.74 | 495.74 |
| ⊘ Brg. W. Abut. | 709+32.01 | -48.18 | 495.70 | 495.70 |
| A | 709+41.88 | -47.98 | 495.57 | 495.59 |
| B | 709+51.75 | -47.80 | 495.43 | 495.48 |
| C | 709+61.61 | -47.65 | 495.25 | 495.32 |
| D | 709+71.48 | -47.54 | 495.03 | 495.12 |
| E | 709+81.35 | -47.44 | 494.81 | 494.91 |
| F | 709+91.22 | -47.38 | 494.58 | 494.68 |
| G | 710+01.09 | -47.34 | 494.34 | 494.44 |
| H | 710+10.96 | -47.33 | 494.11 | 494.20 |
| I | 710+20.83 | -47.35 | 493.86 | 493.94 |
| J | 710+30.70 | -47.40 | 493.61 | 493.67 |
| K | 710+40.57 | -47.47 | 493.36 | 493.40 |
| L | 710+50.43 | -47.57 | 493.10 | 493.11 |
| ⊘ Brg. E. Abut. | 710+55.39 | -47.63 | 492.97 | 492.97 |
| Back of E. Abut. | 710+58.07 | -47.67 | 492.90 | 492.90 |

BEAM 3

| Location | Station | Offset | Theoretical Grade Elevations | Theoretical Grade Elevations Adjusted For Dead Load Deflection |
|------------------|-----------|--------|------------------------------|--|
| Back of W. Abut. | 709+32.26 | -42.84 | 495.53 | 495.53 |
| ⊘ Brg. W. Abut. | 709+34.94 | -42.78 | 495.49 | 495.49 |
| A | 709+44.82 | -42.59 | 495.34 | 495.36 |
| B | 709+54.71 | -42.42 | 495.18 | 495.23 |
| C | 709+64.59 | -42.28 | 494.98 | 495.05 |
| D | 709+74.47 | -42.17 | 494.76 | 494.84 |
| E | 709+84.35 | -42.09 | 494.53 | 494.63 |
| F | 709+94.24 | -42.03 | 494.30 | 494.40 |
| G | 710+04.12 | -42.00 | 494.06 | 494.16 |
| H | 710+14.01 | -42.00 | 493.82 | 493.91 |
| I | 710+23.89 | -42.03 | 493.58 | 493.66 |
| J | 710+33.77 | -42.08 | 493.33 | 493.39 |
| K | 710+43.66 | -42.17 | 493.07 | 493.11 |
| L | 710+53.54 | -42.28 | 492.81 | 492.82 |
| ⊘ Brg. E. Abut. | 710+58.50 | -42.34 | 492.68 | 492.68 |
| Back of E. Abut. | 710+61.18 | -42.38 | 492.61 | 492.61 |

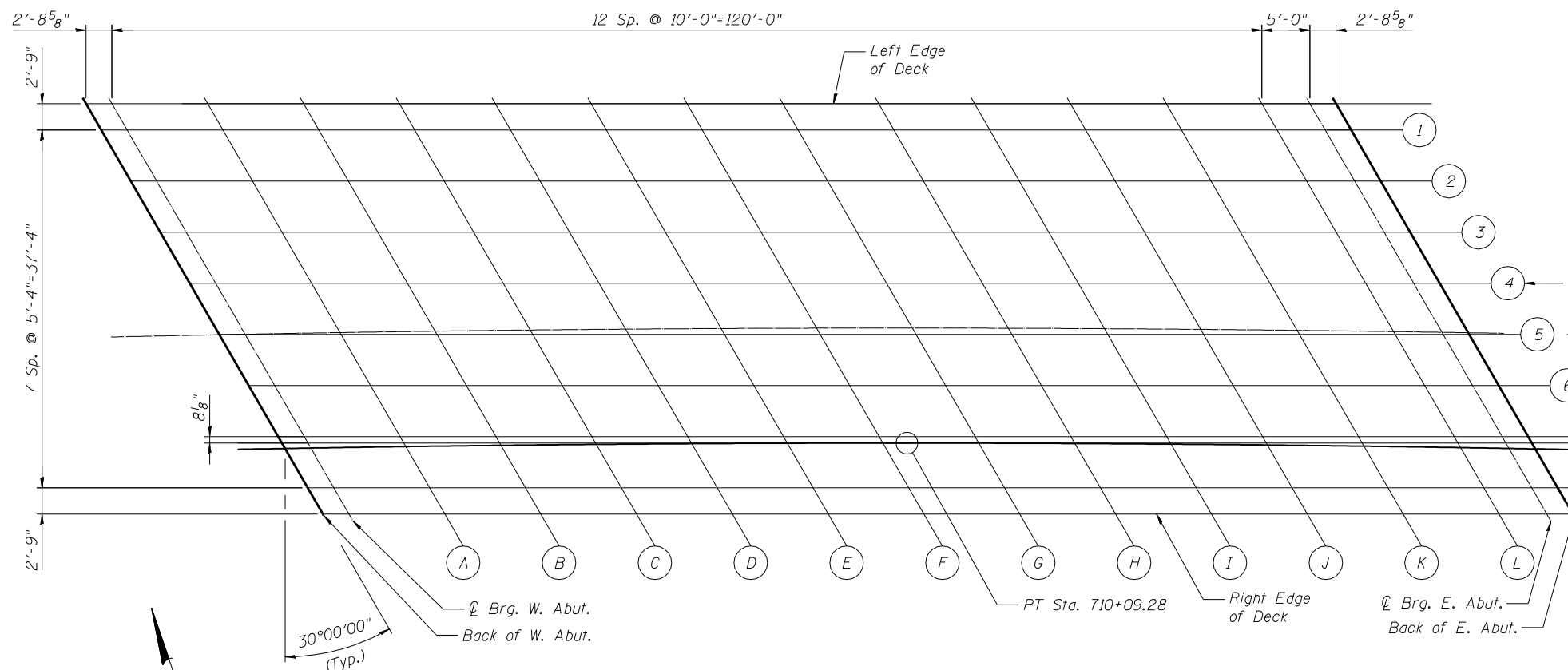

SCREED PLAN - WESTBOUND

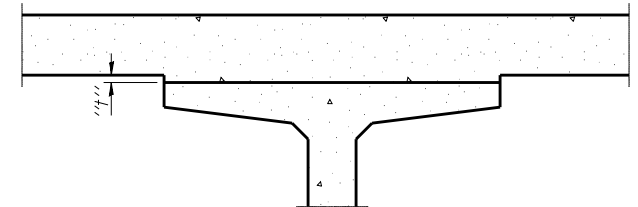

To determine "t": After all precast prestressed beams have been erected, elevations of the top flanges of the beams shall be taken at intervals shown below. These elevations subtracted from the "Theoretical Grade Elevations Adjusted for Dead Load Deflections" shown above, minus slab thickness, equals the fillet heights "t" above top flanges of beams.

FILLET HEIGHTS

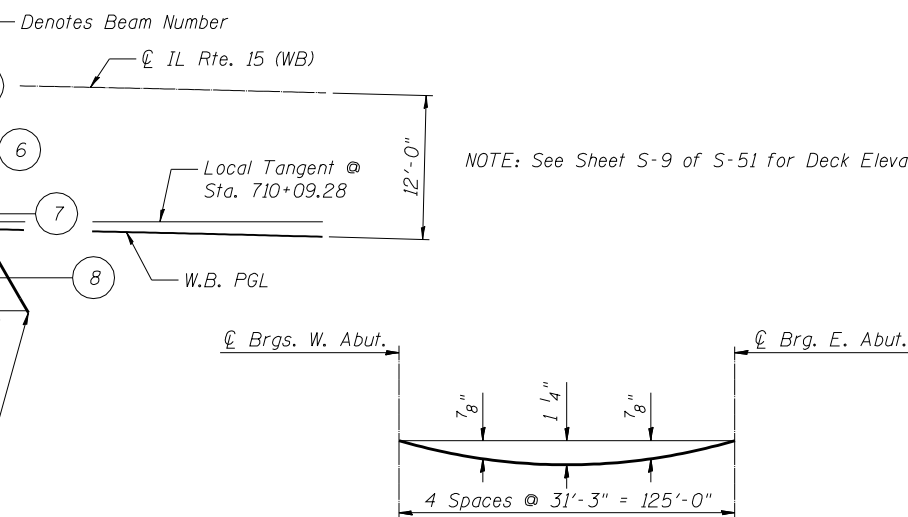

DEAD LOAD DEFLECTION DIAGRAM

(Includes weight of concrete, excluding beams).

Note:
The above deflections are not to be used in the field if the engineer is working from the grade elevations adjusted for dead load deflections as shown above.

FILE NAME = 0820119-0120-76884-008-DeckElevWB.dgn



| | | |
|-------------------------|----------------|-------------|
| USER NAME = brazzera | DESIGNED - MJK | REVISED - - |
| PLOT SCALE = 1/8"=1'-0" | CHECKED - JAN | REVISED - - |
| PLOT DATE = 10/19/2011 | DRAWN - MJK | REVISED - - |
| | CHECKED - JAN | REVISED - - |

**STATE OF ILLINOIS
DEPARTMENT OF TRANSPORTATION**

**DECK ELEVATION PLAN WESTBOUND
STRUCTURE NO. 082-0119 (E.B.) & 082-0120 (W.B.)**

SHEET NO. S-8 OF S-51 SHEETS

| | | | | |
|---------------------------|------------|-----------|--------------------|-----------|
| F.A.P. RTE. | SECTION | COUNTY | TOTAL SHEETS | SHEET NO. |
| 103 | 27-1-VHB-1 | ST. CLAIR | 277 | 185 |
| ILLINOIS FED. AID PROJECT | | | CONTRACT NO. 76884 | |