

**NORTH EDGE OF SHOULDER**

Location	Station	Offset	Theoretical Grade Elevations
W. End East Appr. Pav't	710+53.22	-54.30	493.29
A5	710+63.04	-54.30	493.02
A6	710+72.85	-54.30	492.74
E. End East Appr. Pav't	710+82.68	-54.30	492.46

**NORTH EDGE OF PAVEMENT**

Location	Station	Offset	Theoretical Grade Elevations
W. End East Appr. Pav't	710+59.27	-44.00	492.72
A5	710+69.13	-44.00	492.45
A6	710+78.98	-44.00	492.17
E. End East Appr. Pav't	710+88.84	-44.00	491.88

**CL IL RTE. 15 (WB)**

Location	Station	Offset	Theoretical Grade Elevations
W. End East Appr. Pav't	710+66.37	-32.00	492.06
A5	710+76.27	-32.00	491.78
A6	710+86.17	-32.00	491.49
E. End East Appr. Pav't	710+96.07	-32.00	491.20

**W.B. PGL AND SOUTH EDGE OF PAVEMENT**

Location	Station	Offset	Theoretical Grade Elevations
W. End East Appr. Pav't	710+73.52	-20.00	491.39
A5	710+83.47	-20.00	491.10
A6	710+93.41	-20.00	490.81
E. End East Appr. Pav't	711+03.36	-20.00	490.52

**SOUTH EDGE OF SHOULDER**

Location	Station	Offset	Theoretical Grade Elevations
W. End East Appr. Pav't	710+76.71	-14.68	491.09
A5	710+86.68	-14.68	490.80
A6	710+96.64	-14.68	490.51
E. End East Appr. Pav't	711+06.61	-14.68	490.21

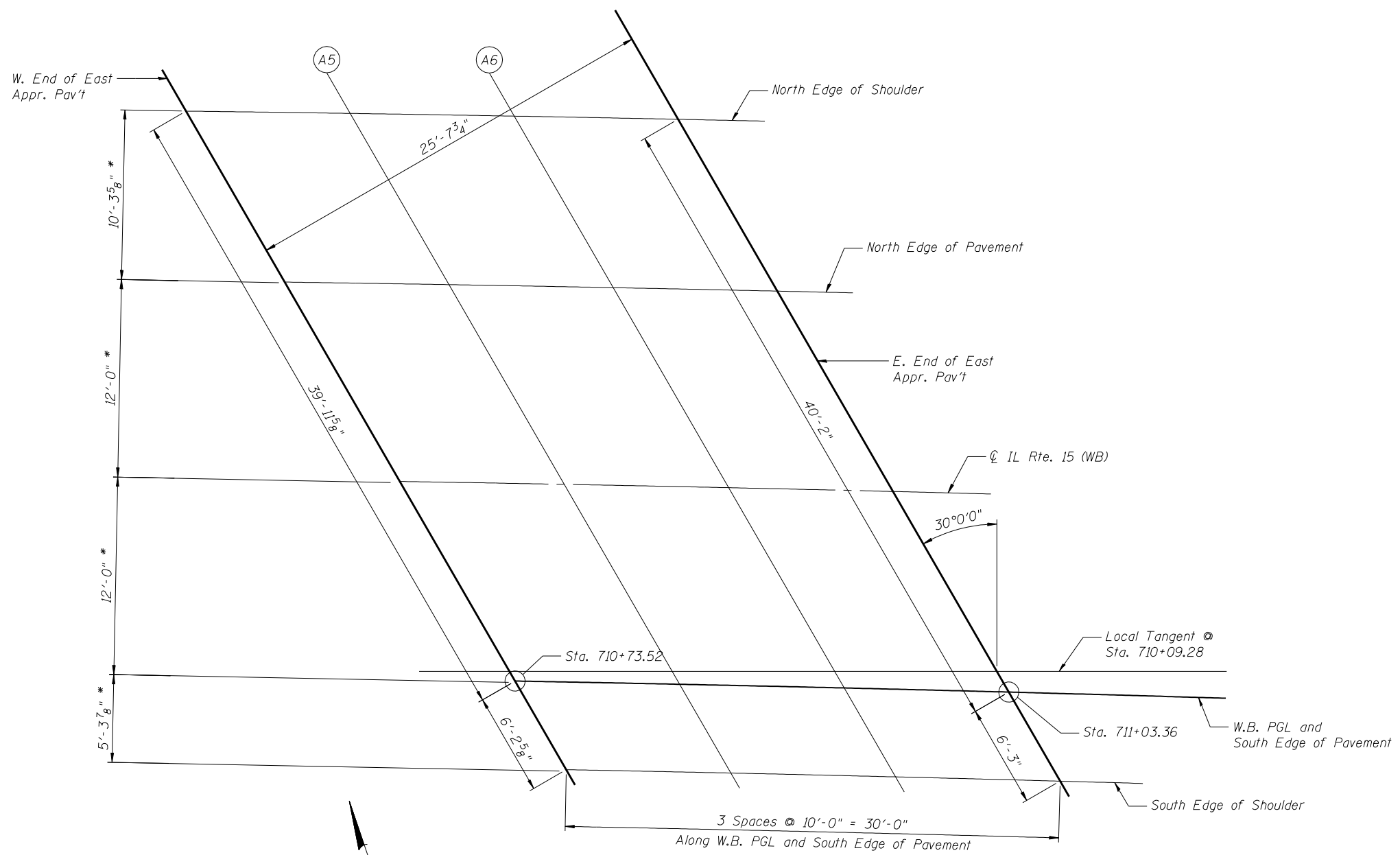

\*Measured radially to W.B. PGL

**PLAN**  
(East Approach W.B.)

FILE NAME = 0820119-0120-76884-012-EastAppr-ElevWB.dgn



USER NAME = brazzera	DESIGNED - MJK	REVISED - -
	CHECKED - BTO	REVISED - -
PLOT SCALE = 8x0' 1\"/>		

**STATE OF ILLINOIS  
DEPARTMENT OF TRANSPORTATION**

**EAST W.B. BRIDGE APPROACH SLAB ELEVATIONS  
STRUCTURE NO. 082-0119 (E.B.) & 082-0120 (W.B.)**

SHEET NO. 5-12 OF 5-51 SHEETS

F.A.P. RTE. 103	SECTION 27-1-VHB-1	COUNTY ST. CLAIR	TOTAL SHEETS 277	SHEET NO. 189
			CONTRACT NO. 76884	
ILLINOIS FED. AID PROJECT				