

Notes:  
 See sheet S-24 of S-51 for Sections C-C & D-D and View E-E.  
 a10(E) and a11(E) bar spacings measured along  $\hat{C}$  Rdwy.  
 \* Tilt #9 b11(E) bars as required to maintain clearance.  
 \*\*\* Cost included with Concrete Superstructure.

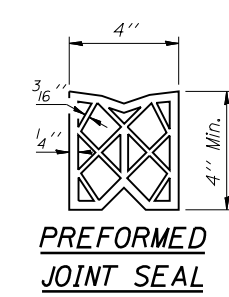

**DETAIL A**

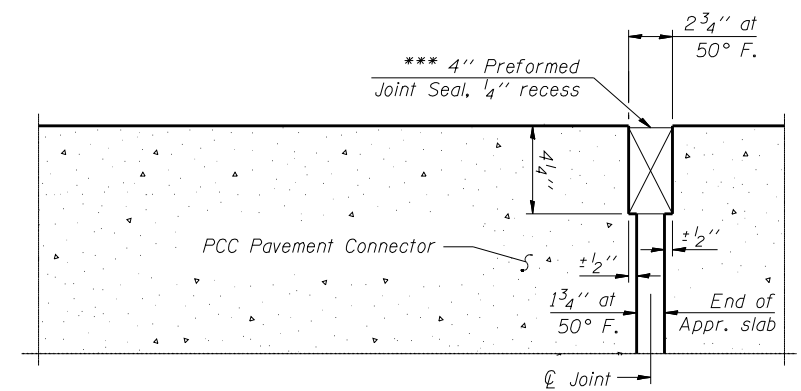
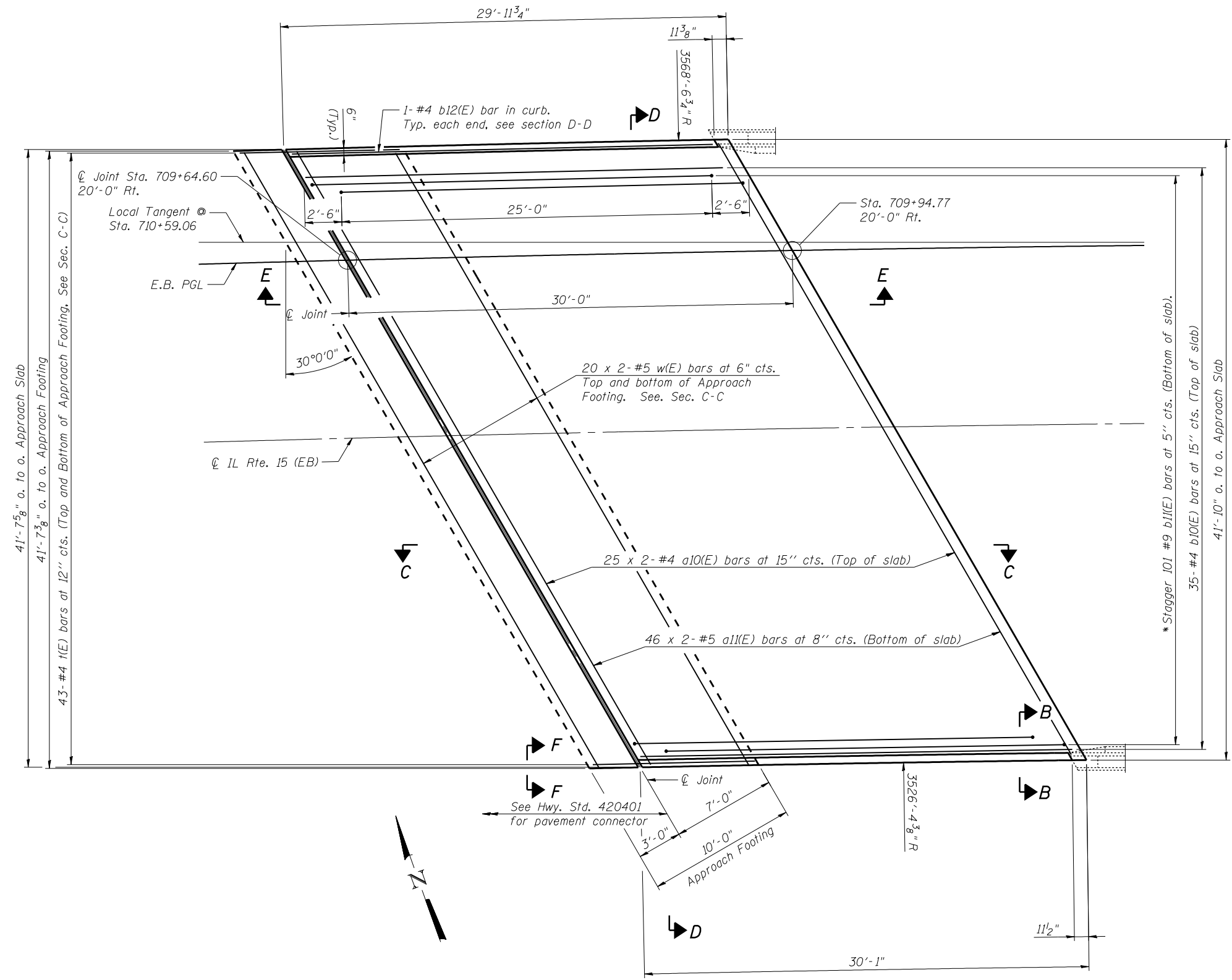
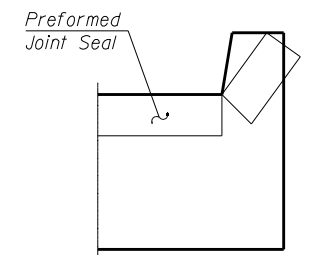

**VIEW F-F**

Angle Preformed Joint Seal at 45° at curbs when req'd for drainage.

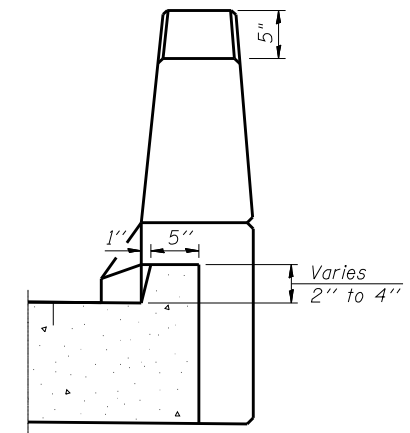

**VIEW B-B**

**MINIMUM BAR LAP**

#4 Bars = 1'-10"  
 #5 Bars = 2'-7"

**WEST EASTBOUND APPROACH SLAB PLAN**

FILE NAME = 0820119-0120-76884-023-WestApprPlanEB.dgn



USER NAME = brazzera	DESIGNED - MJK	REVISED - -
PLOT SCALE = 8.00' / IN.	CHECKED - BTO	REVISED - -
PLOT DATE = 10/19/2011	DRAWN - MJK	REVISED - -
	CHECKED - BTO	REVISED - -

**STATE OF ILLINOIS  
 DEPARTMENT OF TRANSPORTATION**

**WEST E.B. BRIDGE APPROACH SLAB PLAN  
 STRUCTURE NO. 082-0119 (E.B.) & 082-0120 (W.B.)**

SHEET NO. S-23 OF S-51 SHEETS

F.A.P. RTE.	SECTION	COUNTY	TOTAL SHEETS	SHEET NO.
103	27-1-VHB-1	ST. CLAIR	277	200
CONTRACT NO. 76884				
ILLINOIS FED. AID PROJECT				