

BENCHMARK: Existing chiseled square on south end of northwest wingwall, on SN 082-0051, El. 493.11.

EXISTING STRUCTURE: Structure numbers 082-0051 and 082-0052 were constructed in 1956. These structures consist of dual 8 span built-up steel girder spans: one three-span continuous, one simple span and two, two-span continuous. The riveted girders are supported on pile supported abutments and piers. The overall length of SN 082-0051 (Westbound) is 808 feet and SN 082-0052 (Eastbound) is 746 feet. Each structure provides 35'-8" out-to-out of deck with 30' of roadway width. Both structures were rehabilitated in 1985. Traffic will be maintained on SN 082-0051 while the new eastbound structures are constructed; traffic will then be moved to the new eastbound structures until the westbound structures are complete.

Salvage: None

STATION 11+71.71
BUILT BY
STATE OF ILLINOIS
F.A.P. RTE. 103 SEC. 27-1-VHB-1
STRUCTURE NO. 082-W312

NAME PLATE
See Std. 515001

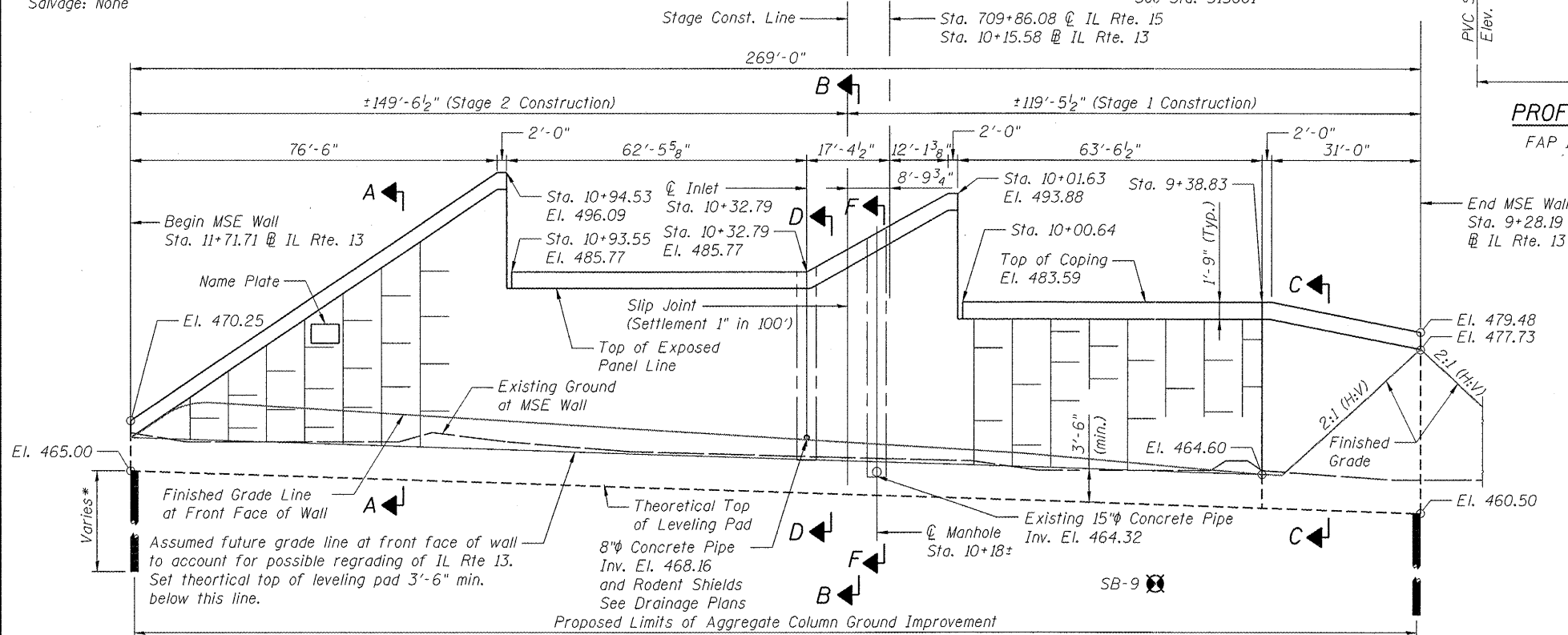
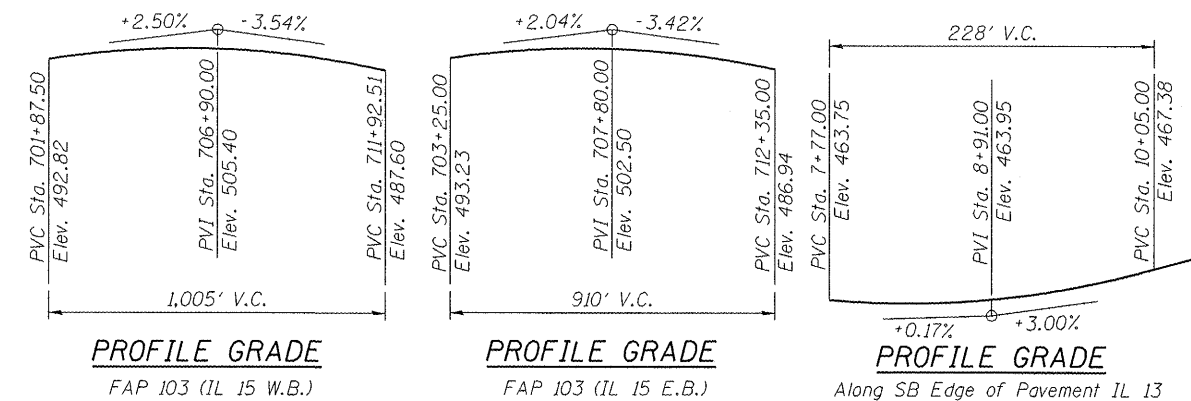

- NOTES ON GROUND IMPROVEMENT:**
1. Install anywhere with 10 feet or more of new fill.
 2. Extend 5 feet beyond toes of fill slopes taller than 10 feet.
 3. Extend 5 feet in front of face of MSE walls, except within 5 feet of existing deep foundations.
 4. Ground improvement elements need to be maintained a minimum of 3 feet away from any new pile locations.

- INDEX OF SHEETS**
1. General Plan
 2. Typical Sections & Bill of Material
 3. Sections at Drainage Structures
 4. Boring Logs 1
 5. Boring Logs 2
 6. Boring Logs 3
 7. Boring Logs 4

DESIGN SPECIFICATIONS
2002 AASHTO Std. Specifications for Highway Bridges, 17th Edition

DESIGN STRESSES
FIELD UNITS
f'c = 3,500 psi (Concrete)
fy = 60,000 psi (Reinforcement)
PRECAST CONCRETE UNITS
f'c = 4,500 psi (Panels)

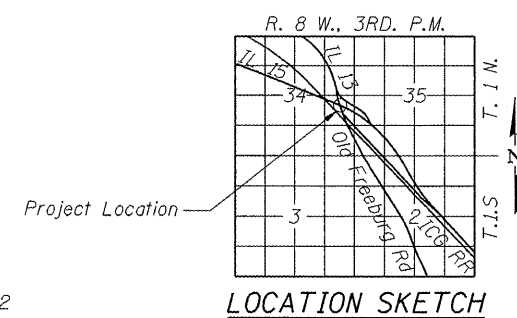

Signature: *Dan A. Jordan* 12-8-11
Date: November 30, 2012
Expires: November 30, 2012

APPROVED
For Structural Adequacy Only
L. Carl Pappas
Engineer of Bridges & Structures

CURVE DATA

(IL Rte. 15)	(IL Rte. 13)
Δ = 37° 55' 48" (RT)	Δ = 17° 42' 18" (RT)
D = 1° 36' 00"	D = 3° 49' 11"
T = 1,230.59'	T = 233.62'
L = 2,370.64'	L = 463.52'
E = 205.54'	E = 18.08'
R = 3,581.00'	R = 1,500.00'
S.E. = 3.9%	S.E. = 3.0%
P.C. = Sta. 709+26.15	P.C. = Sta. 8+72.98
P.T. = Sta. 732+96.79	P.T. = Sta. 13+36.50
P.I. = Sta. 721+56.75	P.I. = Sta. 11+06.60

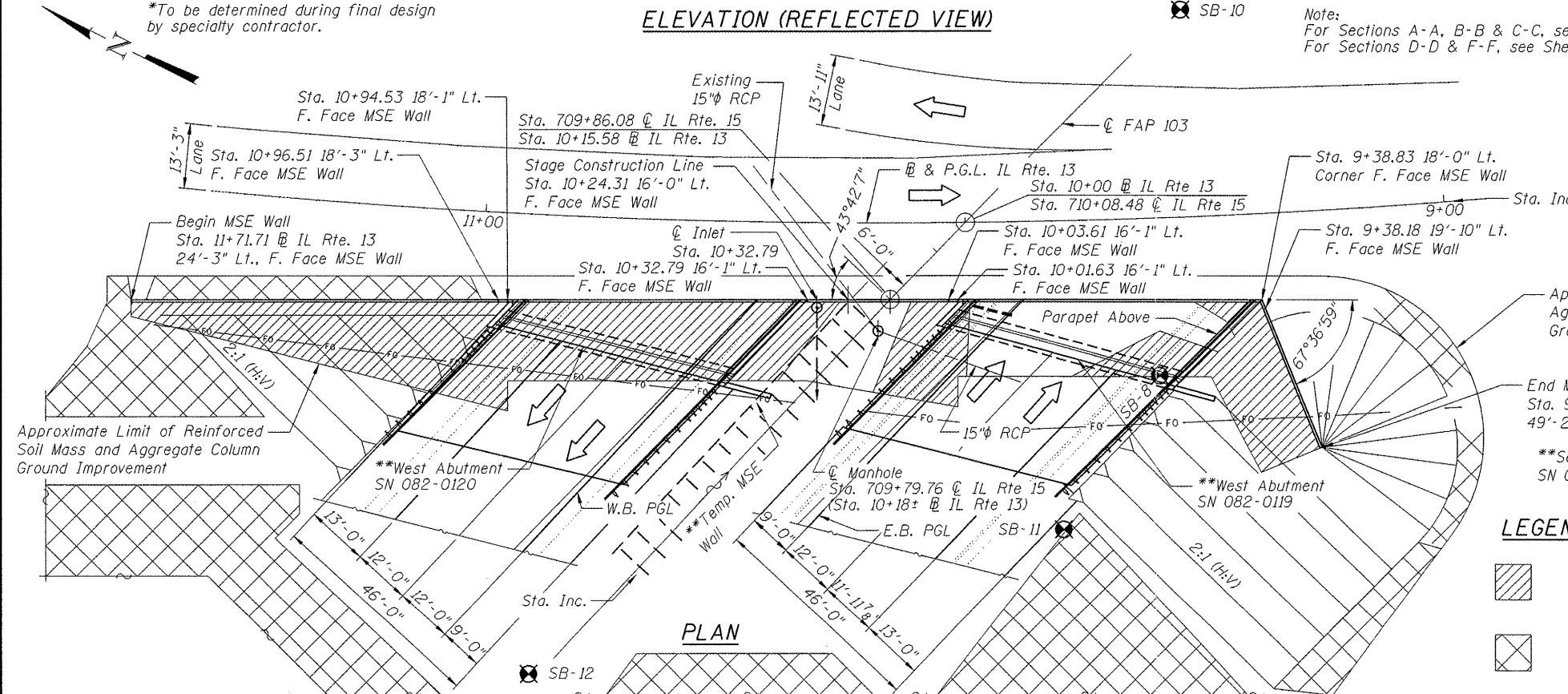

Approximate Limit of Aggregate Column Ground Improvement

End MSE Wall
Sta. 9+28.19 @ IL Rte. 13
49'-2" Lt., F. Face MSE Wall

**See structure plans for SN 082-0119 & SN 082-0120

- LEGEND:**
- Approximate Limit of Reinforced Soil Mass and Aggregate Column Ground Improvement
 - Approximate Limit of Aggregate Column Ground Improvement

GENERAL PLAN
ILLINOIS ROUTE 15 OVER ILLINOIS ROUTE 13
F.A.P. RTE. 103 - SEC. 27-1-VHB-1
ST. CLAIR COUNTY
STA. 11+71.71 TO STA. 9+28.19
STRUCTURE NO. 082-W312

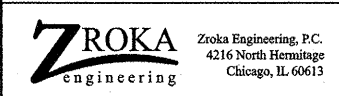

USER NAME = Scott Whitney
DESIGNED - PMM
CHECKED - DAZ
PLOT SCALE = 32:0.0000 "/>

REVISIED -
REVISIED -
REVISIED -
REVISIED -

STATE OF ILLINOIS
DEPARTMENT OF TRANSPORTATION

GENERAL PLAN
STRUCTURE NO. 082-W312
SHEET NO. 1 OF 7 SHEETS

F.A.P. RTE.	SECTION	COUNTY	TOTAL SHEETS	SHEET NO.
103	27-1-VHB-1	ST. CLAIR	277	234

CONTRACT NO. 76884
ILLINOIS FED. AID PROJECT