

DATE	
BY	
SURVEYED	
PLOTTED	
TEMPLATE	
NOTE BOOK	
AREAS CHECKED	
NO.	

DATE	
BY	
SURVEYED	
PLOTTED	
TEMPLATE	
NOTE BOOK	
AREAS CHECKED	
NO.	

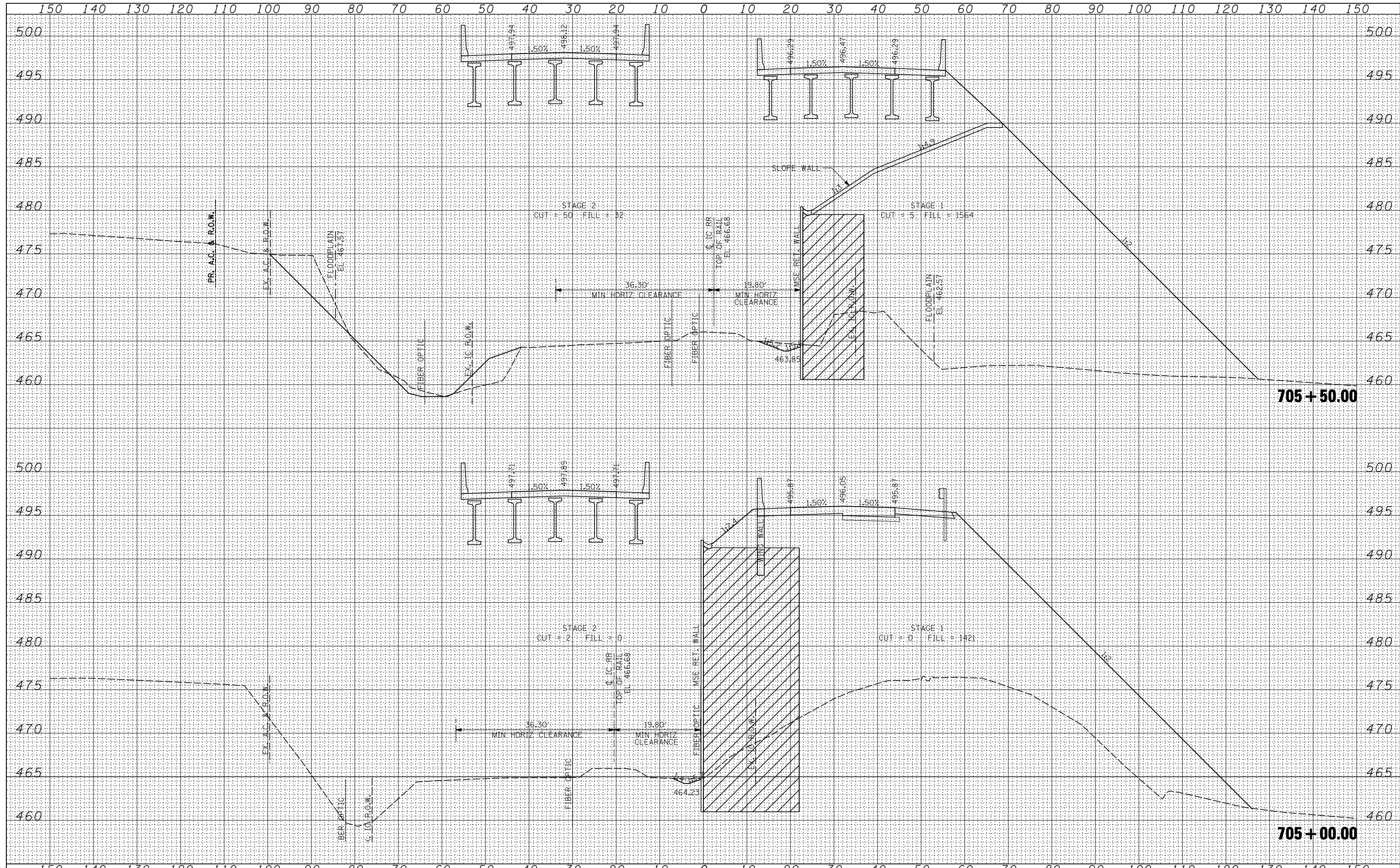

FILE NAME = D876884-IL15-sht-xssht.dgn

USER NAME = thompson	DESIGNED - RDT	REVISED -
	DRAWN - RDT	REVISED -
PLOT SCALE = 20.0000' / IN.	CHECKED - GC	REVISED -
PLOT DATE = 10/20/2011	DATE - 10-19-11	REVISED -

**STATE OF ILLINOIS  
DEPARTMENT OF TRANSPORTATION**

**IL ROUTE 15 CROSS SECTIONS**

SCALE: SHEET NO. 8 OF 28 SHEETS STA. 705+00.00 TO STA. 705+50.00

F.A.P. RTE.	SECTION	COUNTY	TOTAL SHEETS	SHEET NO.
103	27-1-VHB-1	ST. CLAIR	277	253
			CONTRACT NO. 76884	
ILLINOIS FED. AID PROJECT				