

SEE DETAIL SHEET NO. 60 & 61 FOR SIDEROAD AND ENTRANCE TRANSITIONS.

EXIST. CURVE C2  
 PI STA. = 480+71.78  
 $\Delta = 18^\circ 25' 07''$  (LT)  
 $D = 1^\circ 29' 39''$   
 $R = 3,834.59'$   
 $T = 621.71'$   
 $L = 1,232.70'$   
 $E = 50.07'$   
 $e = \text{-----}$   
 $T.R. = \text{-----}$   
 $S.E. \text{ RUN} = \text{-----}$   
 $P.C. \text{ STA.} = 474+50.07$   
 $P.T. \text{ STA.} = 486+82.76$

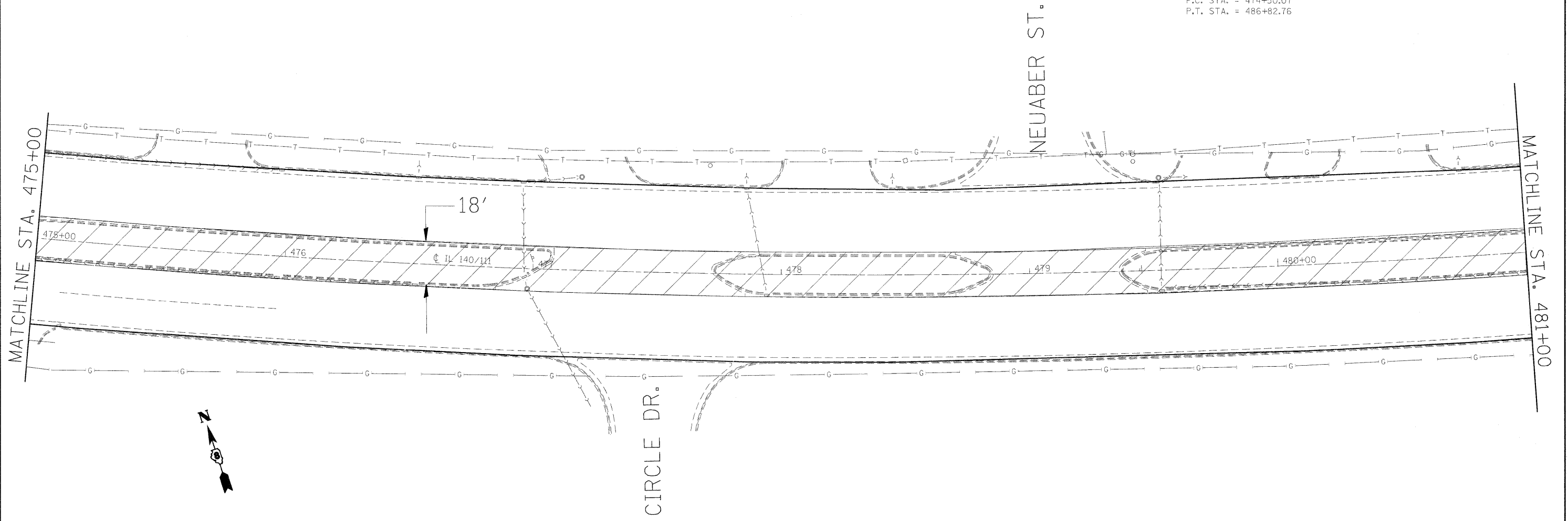

SEE SCHEDULES FOR STORM SEWER RELATED QUANTITIES.

REMOVAL  
 CURB, MEDIAN, &  
 PAVEMENT REMOVAL  
 PROPOSED  
 PCC PAVEMENT 10" (JOINTED)  
 4" AGGREGATE SUBBASE

REVISSED SHEET 4/13/11

SCALE 1"=20'

FILE NAME =	USER NAME = #USER#	DESIGNED - ___	REVISED - ___
#FILE#		DRAWN - ___	REVISED - ___
	PLOT SCALE = #SCALE#	CHECKED - ___	REVISED - ___
	PLOT DATE = #DATE#	DATE - _____	REVISED - ___

STATE OF ILLINOIS  
 DEPARTMENT OF TRANSPORTATION

PLAN SHEET

SCALE: \_\_\_\_\_ SHEET NO. \_\_\_ OF \_\_\_ SHEETS STA. \_\_\_\_\_ TO STA. \_\_\_\_\_

F.A.P. RTE.	SECTION	COUNTY	TOTAL SHEETS	SHEET NO.
785	(132-2,3,4, 133-1)RS	MADISON	122	48
CONTRACT NO. 76B80				
FED. ROAD DIST. NO. ILLINOIS FED. AID PROJECT				