

DETECTOR LOOP REQUIREMENTS AND CALCULATIONS

| LOOP             | LOOP SIZE(FT) | REQUIRED # OF TURNS | CALCULATED INDUCTANCE MICROHENRIES (μH) | CALCULATED RESISTANCE OHMS (Ω) |
|------------------|---------------|---------------------|---|--------------------------------|
| SB LT TURN LN-CD | 6x50          | 3-6-3               | 829                                     | 2.57                           |
| SB LT TURN LN-CD | 6x50          | 3-6-3               | 829                                     | 2.57                           |
| SB RT TURN LN-CD | 6x50          | 3-6-3               | 840                                     | 2.81                           |
| EB RT TURN LN-CD | 6x50          | 3-6-3               | 871                                     | 3.53                           |
| EB RT TURN LN-CD | 6x50          | 3-6-3               | 871                                     | 3.53                           |

THE ABOVE VALUES ARE CALCULATED OF COMBINED LOOP AND LEAD-IN INDUCTANCE AND RESISTANCE. ACTUAL MEASURED VALUES SHOULD BE WITHIN +/- 20% OF THESE VALUES.

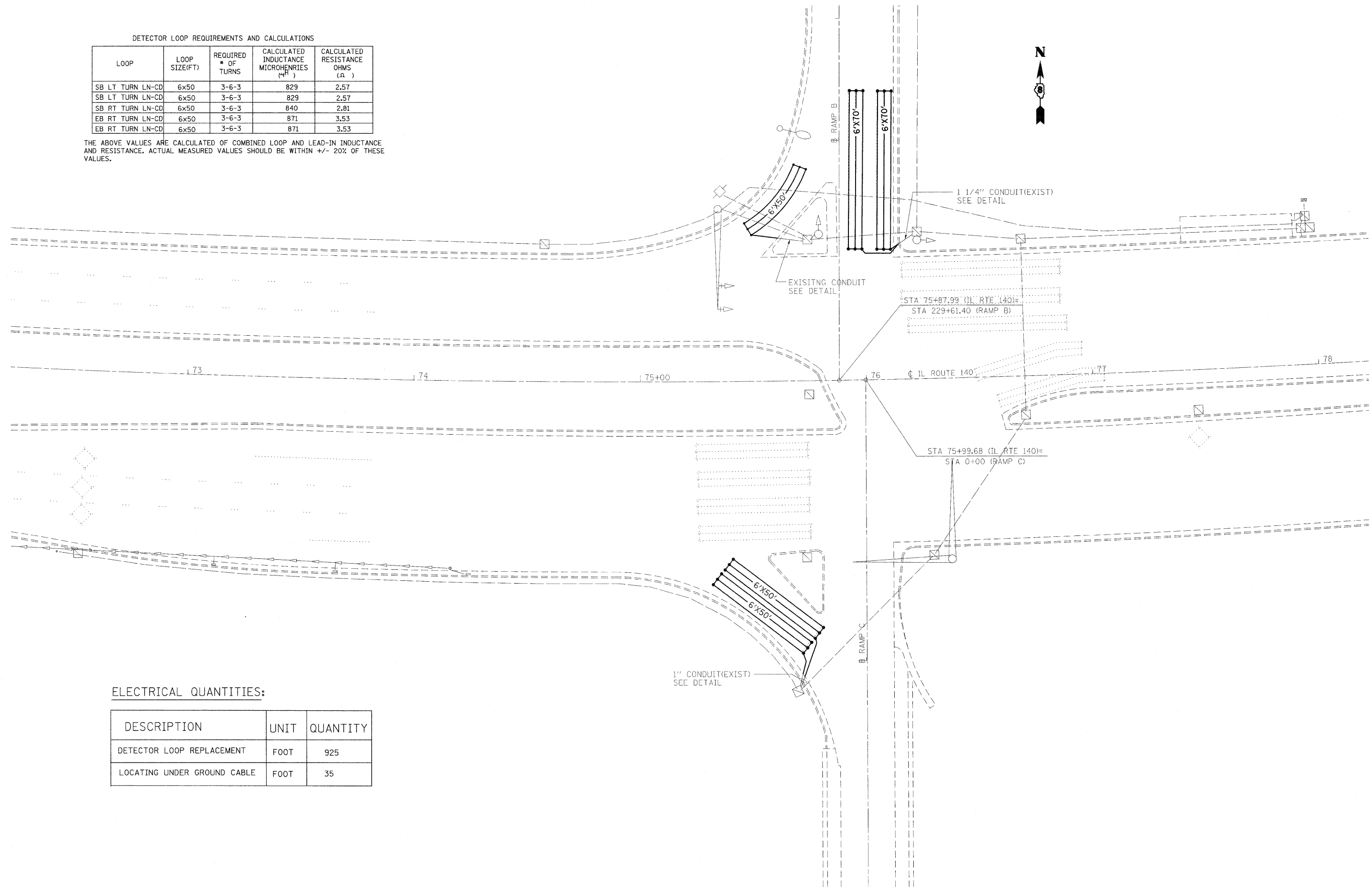

ELECTRICAL QUANTITIES:

| DESCRIPTION                 | UNIT | QUANTITY |
|-----------------------------|------|----------|
| DETECTOR LOOP REPLACEMENT   | FOOT | 925      |
| LOCATING UNDER GROUND CABLE | FOOT | 35       |