







**LEGEND**

-  PERIMETER EROSION BARRIER
-  TEMPORARY DITCH CHECK
-  STANDARD DITCH - FLOW LINE AND DIRECTION
-  SPECIAL DITCH - FLOW LINE AND DIRECTION
-  PROPOSED RIPRAP/AGGREGATE DITCH PLACEMENT
-  INLET & PIPE PROTECTION
-  EROSION CONTROL BLANKET

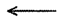
T 5 S, R 6 W, 4th PM  
SECTION 22

T 5 S, R 6 W, 4th PM  
SECTION 23

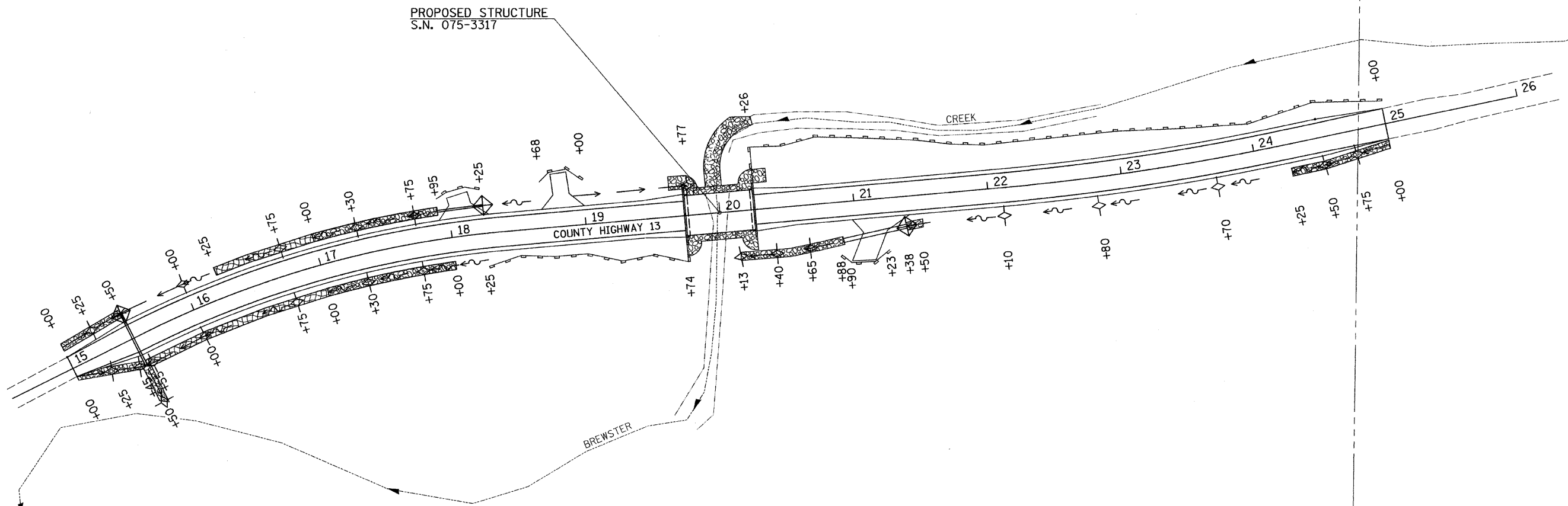

NOTE: TEMPORARY EROSION CONTROL SEEDING SHALL BE DONE IN ACCORDANCE WITH ARTICLE 280.04 OF THE STANDARD SPECIFICATIONS.

T 5 S, R 6 W, 4th PM  
SECTION 22

T 5 S, R 6 W, 4th PM  
SECTION 23

FILE NAME = Y:\Bridge\2698-Pike\2698S001.dgn	USER NAME = cthomas	DESIGNED -	REVISED -
		DRAWN -	REVISED -
	PLOT SCALE = 40.0000' / IN.	CHECKED -	REVISED -
	PLOT DATE = 3/28/2011	DATE -	REVISED -

**PIKE COUNTY  
COUNTY HIGHWAY 13  
OVER BREWSTER CREEK**

**STORM WATER POLLUTION PREVENTION PLAN**

SCALE: 1" = 40' SHEET NO. 1 OF 1 SHEETS STA. 15+00.00 TO STA. 25+00.00

F.A.S. RTE.	SECTION	COUNTY	TOTAL SHEETS	SHEET NO.
597	09-00083-00-BR	PIKE	26	5
CONTRACT NO. 93550				
FED. ROAD DIST. NO. 7 ILLINOIS FED. AID PROJECT BR5-0597(103)				