

NUMBER	ROADWAY	STATION	OFFSET	ELEVATION
1	OLD VINCENNES TRAIL	115+31.93	21.0' LT	546.16
2	OLD VINCENNES TRAIL	115+45.32	21.2' LT	546.26
3	OLD VINCENNES TRAIL	115+54.51	22.3' LT	546.33
4	OLD VINCENNES TRAIL	115+60.25	23.4' LT	546.37
5	OLD VINCENNES TRAIL	115+69.21	25.9' LT	546.57
6	OLD VINCENNES TRAIL	115+77.85	29.3' LT	546.77
7	OLD VINCENNES TRAIL	116+07.28	49.3' LT	547.14
8	OLD VINCENNES TRAIL	115+31.93	8.0' LT	546.42
9	OLD VINCENNES TRAIL	115+46.74	8.0' LT	546.55
10	OLD VINCENNES TRAIL	115+56.64	8.0' LT	546.63
11	OLD VINCENNES TRAIL	115+63.41	8.0' LT	546.68
12	OLD VINCENNES TRAIL	115+74.14	9.2' LT	546.83
13	OLD VINCENNES TRAIL	115+84.52	12.0' LT	547.14
14	OLD VINCENNES TRAIL	115+31.96	0.0'	546.58
15	OLD VINCENNES TRAIL	115.46.53	0.0'	546.65
16	OLD VINCENNES TRAIL	115+56.63	0.1' RT	546.74
17	OLD VINCENNES TRAIL	115+69.38	2.2' RT	546.96
18	OLD VINCENNES TRAIL	115+81.96	6.7' RT	547.14
19	OLD VINCENNES TRAIL	115+31.96	13.0' RT	546.32
20	OLD VINCENNES TRAIL	115+43.38	14.0' RT	546.38
21	OLD VINCENNES TRAIL	115+53.64	16.2' RT	546.44
22	OLD VINCENNES TRAIL	115+62.11	19.1' RT	546.59
23	OLD VINCENNES TRAIL	115+71.69	23.6' RT	546.75
24	OLD VINCENNES TRAIL	115+86.67	34.1' RT	547.01

NUMBER	ROADWAY	STATION	OFFSET	ELEVATION
70	OLD VINCENNES TRAIL	117+12.56	11.4' LT	547.14
71	OLD VINCENNES TRAIL	117+25.24	6.98' LT	546.64
72	OLD VINCENNES TRAIL	117+37.85	4.6' LT	546.11
73	OLD VINCENNES TRAIL	117+47.93	4.0' LT	545.92
74	OLD VINCENNES TRAIL	117+55.32	4.0' LT	545.72
75	OLD VINCENNES TRAIL	117+65.70	3.8' LT	545.25
76	OLD VINCENNES TRAIL	117+76.29	3.7' LT	544.77
77	OLD VINCENNES TRAIL	117+86.47	3.5' LT	544.31
78	OLD VINCENNES TRAIL	117+96.20	3.3' LT	543.87
79	OLD VINCENNES TRAIL	118+06.77	3.2' LT	543.38
80	OLD VINCENNES TRAIL	118+17.56	3.0' LT	542.87
81	OLD VINCENNES TRAIL	118+17.56	16.0' LT	542.61
82	OLD VINCENNES TRAIL	118+06.99	16.2' LT	543.12
83	OLD VINCENNES TRAIL	117+96.42	16.3' LT	543.61
84	OLD VINCENNES TRAIL	117+86.69	16.5' LT	544.05
85	OLD VINCENNES TRAIL	117+76.51	16.7' LT	544.51
86	OLD VINCENNES TRAIL	117+65.92	16.8' LT	544.99
87	OLD VINCENNES TRAIL	117+55.32	17.0' LT	545.46
88	OLD VINCENNES TRAIL	117+51.22	17.1' LT	545.67
89	OLD VINCENNES TRAIL	117+40.99	18.4' LT	545.86
90	OLD VINCENNES TRAIL	117+30.89	21.3' LT	546.33
91	OLD VINCENNES TRAIL	117+21.12	25.6' LT	546.69
92	OLD VINCENNES TRAIL	117+02.09	40.3' LT	547.14
147	OLD VINCENNES TRAIL	116+94.38	0.0'	547.50
148	OLD VINCENNES TRAIL	117+12.44	0.0'	547.14

NUMBER	ROADWAY	STATION	OFFSET	ELEVATION
143	OLD VINCENNES TRAIL	116+00.34	0.0'	547.50
144	OLD VINCENNES TRAIL	115+82.28	0.0'	547.14
151	OLD VINCENNES TRAIL	113+50.00	13.5' LT	549.61
152	OLD VINCENNES TRAIL	113+75.00	14.5' LT	549.52
153	OLD VINCENNES TRAIL	114+00.00	15.6' LT	549.28
154	OLD VINCENNES TRAIL	114+25.00	16.6' LT	548.89
155	OLD VINCENNES TRAIL	114+50.00	17.6' LT	548.14
156	OLD VINCENNES TRAIL	114+75.00	18.7' LT	547.31
157	OLD VINCENNES TRAIL	115+00.00	19.7' LT	546.67
158	OLD VINCENNES TRAIL	113+50.00	13.7' RT	548.52
159	OLD VINCENNES TRAIL	113+75.00	13.5' RT	548.40
160	OLD VINCENNES TRAIL	114+00.00	13.3' RT	548.13
161	OLD VINCENNES TRAIL	114+25.00	13.0' RT	547.70
162	OLD VINCENNES TRAIL	114+50.00	13.0' RT	547.17
163	OLD VINCENNES TRAIL	114+75.00	13.0' RT	546.66
164	OLD VINCENNES TRAIL	115+00.00	13.0' RT	546.37

NUMBER	ROADWAY	STATION	OFFSET	ELEVATION
47	OLD VINCENNES TRAIL	116+94.58	41.7' RT	547.17
48	OLD VINCENNES TRAIL	117+17.38	23.8' RT	546.61
49	OLD VINCENNES TRAIL	117+28.14	19.7' RT	546.24
50	OLD VINCENNES TRAIL	117+39.28	17.4' RT	545.71
51	OLD VINCENNES TRAIL	117+48.63	17.0' RT	545.51
52	OLD VINCENNES TRAIL	117+55.32	17.0' RT	545.22
53	OLD VINCENNES TRAIL	117+65.89	16.8' RT	544.71
54	OLD VINCENNES TRAIL	117+76.48	16.7' RT	544.28
55	OLD VINCENNES TRAIL	117+86.72	16.5' RT	543.86
56	OLD VINCENNES TRAIL	117+96.39	16.3' RT	543.47
57	OLD VINCENNES TRAIL	118+06.97	16.2' RT	543.04
58	OLD VINCENNES TRAIL	118+17.56	16.0' RT	542.61
59	OLD VINCENNES TRAIL	118+17.56	3.0' RT	542.87
60	OLD VINCENNES TRAIL	118+06.77	3.2' RT	543.30
61	OLD VINCENNES TRAIL	117+96.20	3.3' RT	543.73
62	OLD VINCENNES TRAIL	117+86.52	3.5' RT	544.12
63	OLD VINCENNES TRAIL	117+76.29	3.7' RT	544.54
64	OLD VINCENNES TRAIL	117+65.69	3.8' RT	544.97
65	OLD VINCENNES TRAIL	117+55.32	4.0' RT	545.48
66	OLD VINCENNES TRAIL	117+47.62	4.0' RT	545.86
67	OLD VINCENNES TRAIL	117+37.70	4.0' RT	546.06
68	OLD VINCENNES TRAIL	117+24.28	5.2' RT	546.59
69	OLD VINCENNES TRAIL	117+10.93	9.1' RT	547.14

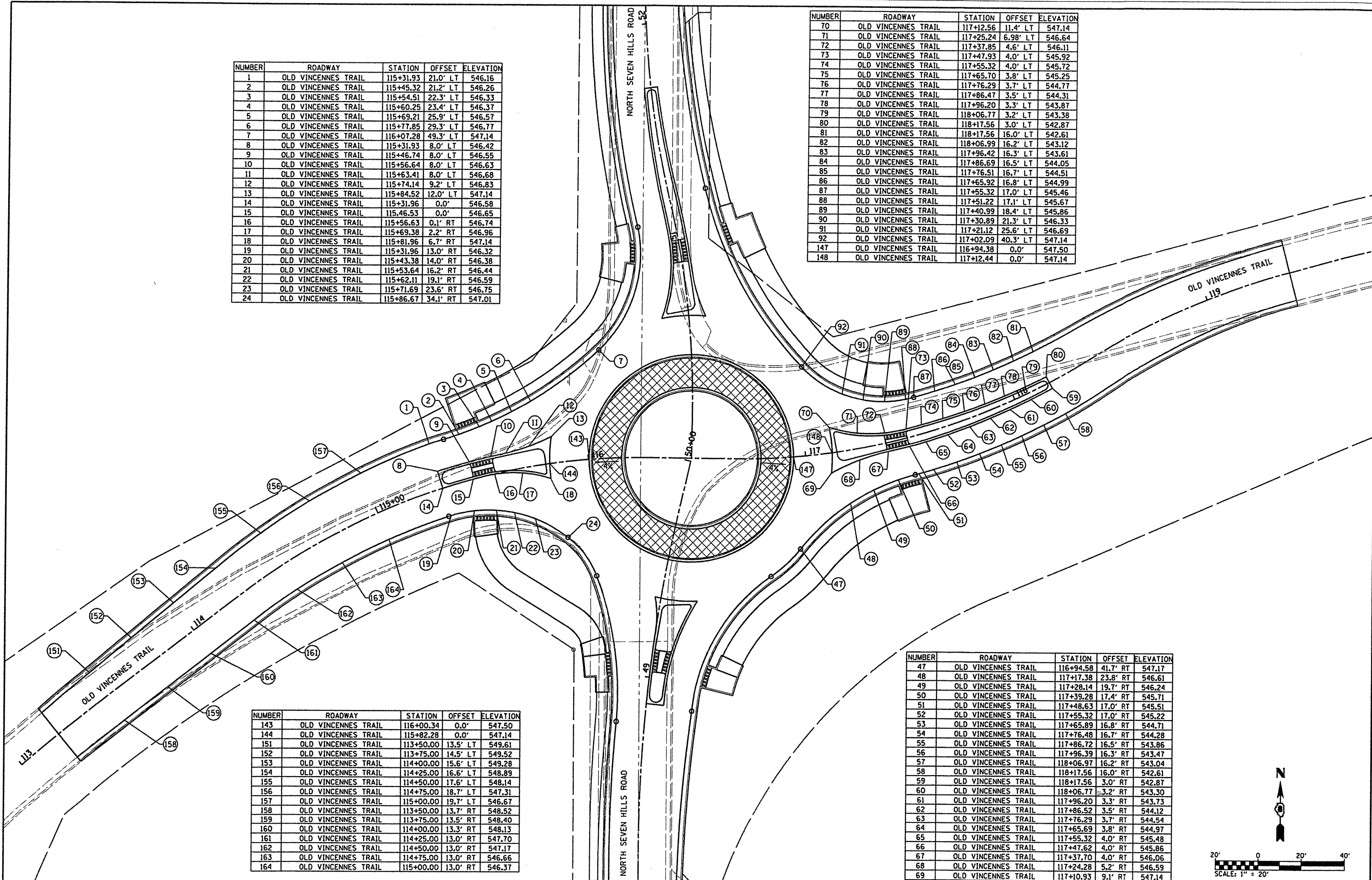

FILE NAME =	USER NAME = joelitaliano	DESIGNED -	REVISED -
H:\P\29051\Microstation\CADD Sheets\082	081-shr-intersec.dgn	DRAWN -	REVISED -
	PLOT SCALE = 48.0000' / IN.	CHECKED -	REVISED -
	PLOT DATE = 10/5/2011	DATE -	REVISED -

CITY OF O'FALLON

INTERSECTION DETAILS	
SCALE: 1"=20'	SHEET NO. 01 OF 02 SHEETS
STA.	TO STA.

F.A.U. RTE.	SECTION	COUNTY	TOTAL SHEETS	SHEET NO.
9172	10-00036-03-PV	ST. CLAIR	51	27
CONTRACT NO. 97478				