

ROUTE	SECTION	COUNTY	TOWNSHIP	TOTAL SHEETS	SHEET NUMBER
FAS 1019	06-00144-00-WR	JACKSON	MAKANDA	91	17
JOB NO. C-99-579-06				PROJECT NO. SR-1019(106)	
BOSKYDELL ROAD				CONTRACT NO. 99338	

78+00

79+00

80+00

81+00

82+00

83+00

84+00

LEGEND

- | | | | |
|--------|---------------------------|-------|----------------------------------|
| □ | POWER POLE | —x—x— | FENCE LINE |
| ○ | POLE ANCHOR | —PL— | PROPERTY LINE |
| ○ | TELEPHONE POLE | —ROW— | EXISTING RIGHT-OF-WAY LINE |
| TP □ | TELEPHONE PEDESTAL | —ROW— | PROPOSED RIGHT-OF-WAY LINE |
| ● | TELEPHONE WARNING SIGN | —ROW— | PROPOSED TEMPORARY USE PERMIT |
| CATV □ | CABLE TELEVISION PEDESTAL | ●●●● | SURVEY MONUMENTS (FOUND) |
| FH | FIRE HYDRANT | ■ | EXISTING RIGHT-OF-WAY MARKER |
| WVO | WATER VALVE | — | SIGN |
| WMO | WATER METER | MB ● | MAILBOX |
| W | WATER LINE | RCP | REINFORCED CONCRETE PIPE CULVERT |
| GV | GAS VALVE | CMP | CORRUGATED METAL PIPE CULVERT |
| G | GAS LINE | TC | TOP OF CASTING / TOP OF CURB |
| FO | FIBER OPTIC LINE | INV. | INVERT |
| — | TREE/BRUSH LINE | FL | FLOWLINE |

SCALE: 1" = 20'

SE 1/4 SW 1/4 SEC 2

19-02-376-003
AUDREY A. SCHOELLHORN, TRUSTEE
824/454

19-02-451-010
DOUGLAS L. GATES
AND
BRENDA L. GATES
PARCEL 1 2004/18382

19-02-376-003
AUDREY A. SCHOELLHORN,
TRUSTEE
824/454

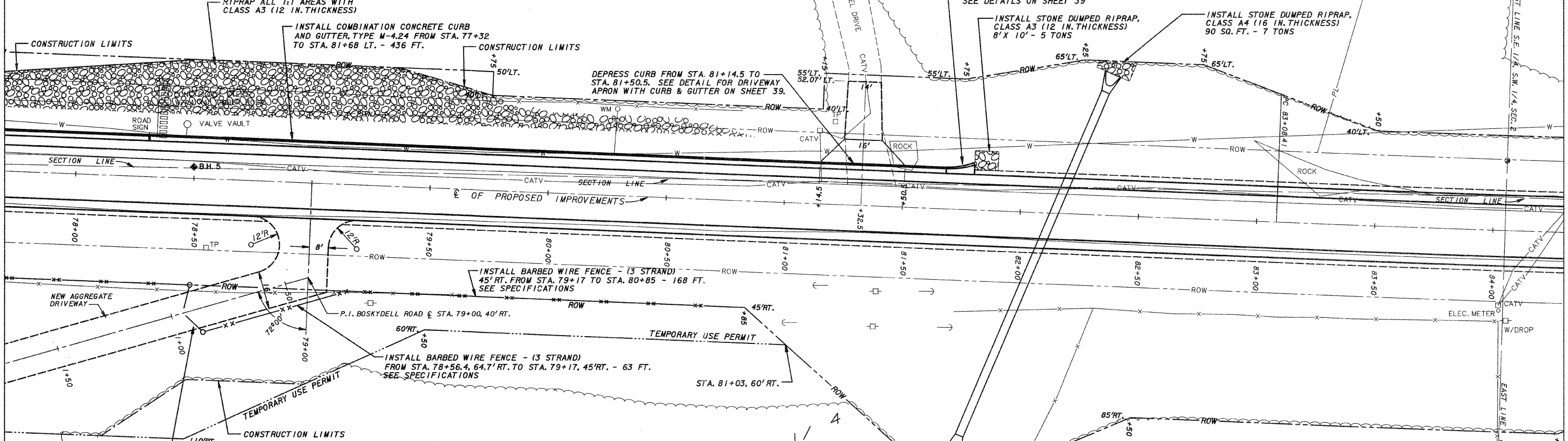

- NOTES
1. THE EXISTENCE, POSITION, SIZE AND TYPE OF ALL UNDERGROUND UTILITIES ARE APPROXIMATE AS SHOWN, BEING LOCATED BY ELECTRONIC DETECTION EQUIPMENT, BY VISUAL OBSERVATION, FROM UTILITY COMPANY MAPS AND BY VERBAL TESTIMONY OF EMPLOYEES FROM APPROPRIATE UTILITY COMPANY. VERIFICATION OF THE EXISTENCE, POSITION, SIZE AND TYPE SHOULD BE REQUESTED THROUGH "JULIE", 1-800-892-0126 PRIOR TO ANY CONSTRUCTION.
 2. ALL PHYSICAL FEATURES DEPICTED BY THIS SURVEY WERE CONDITIONS AS OF OCTOBER, 2006.

NE 1/4 NW 1/4 SEC 11

19-11-100-004
EDWARD CHARLES VARSA
AND SALLY JANE VARSA
397/267

CURVE NO. 6

Δ - 01°30'34" P.C. - 83+08.41

R - 11,388.30' P.I. - 84+58.42

L - 300.00' P.R.C. - 86+08.41

T - 150.01'

